



Chipsmall Limited consists of a professional team with an average of over 10 year of expertise in the distribution of electronic components. Based in Hongkong, we have already established firm and mutual-benefit business relationships with customers from,Europe,America and south Asia,supplying obsolete and hard-to-find components to meet their specific needs.

With the principle of “Quality Parts,Customers Priority,Honest Operation,and Considerate Service”,our business mainly focus on the distribution of electronic components. Line cards we deal with include Microchip,ALPS,ROHM,Xilinx,Pulse,ON,Everlight and Freescale. Main products comprise IC,Modules,Potentiometer,IC Socket,Relay,Connector.Our parts cover such applications as commercial,industrial, and automotives areas.

We are looking forward to setting up business relationship with you and hope to provide you with the best service and solution. Let us make a better world for our industry!



Contact us

Tel: +86-755-8981 8866 Fax: +86-755-8427 6832

Email & Skype: info@chipsmall.com Web: www.chipsmall.com

Address: A1208, Overseas Decoration Building, #122 Zhenhua RD., Futian, Shenzhen, China



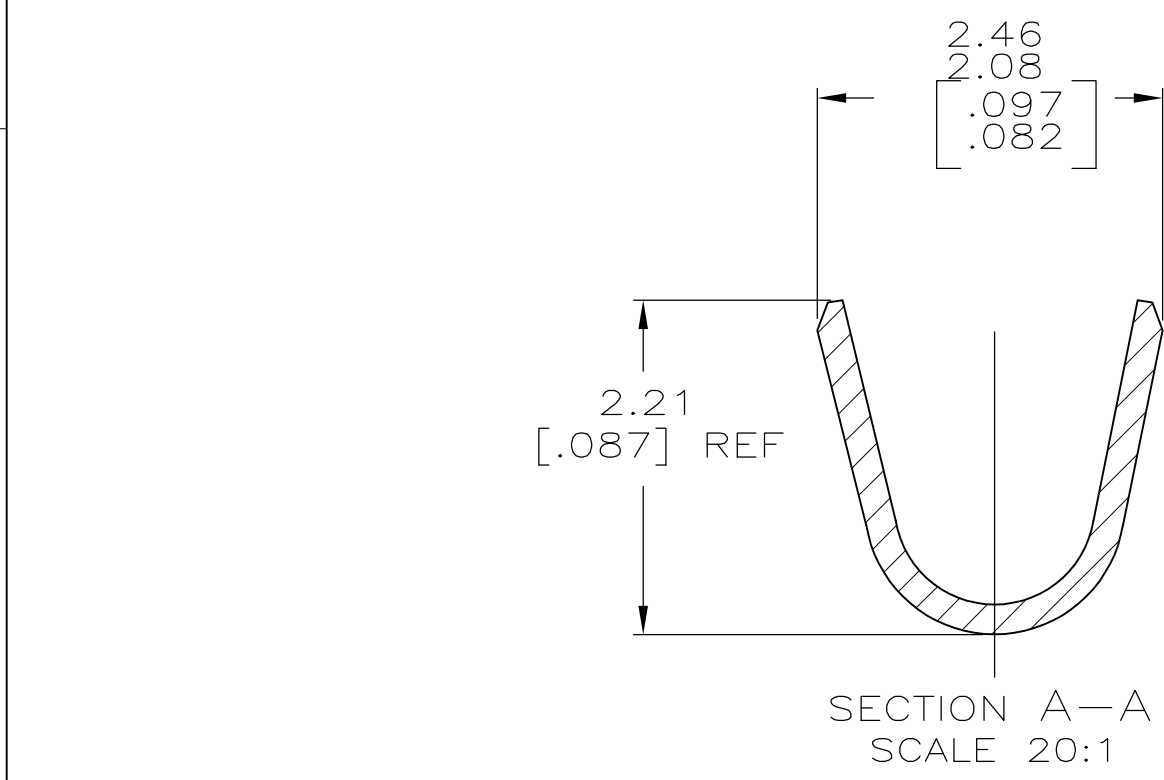
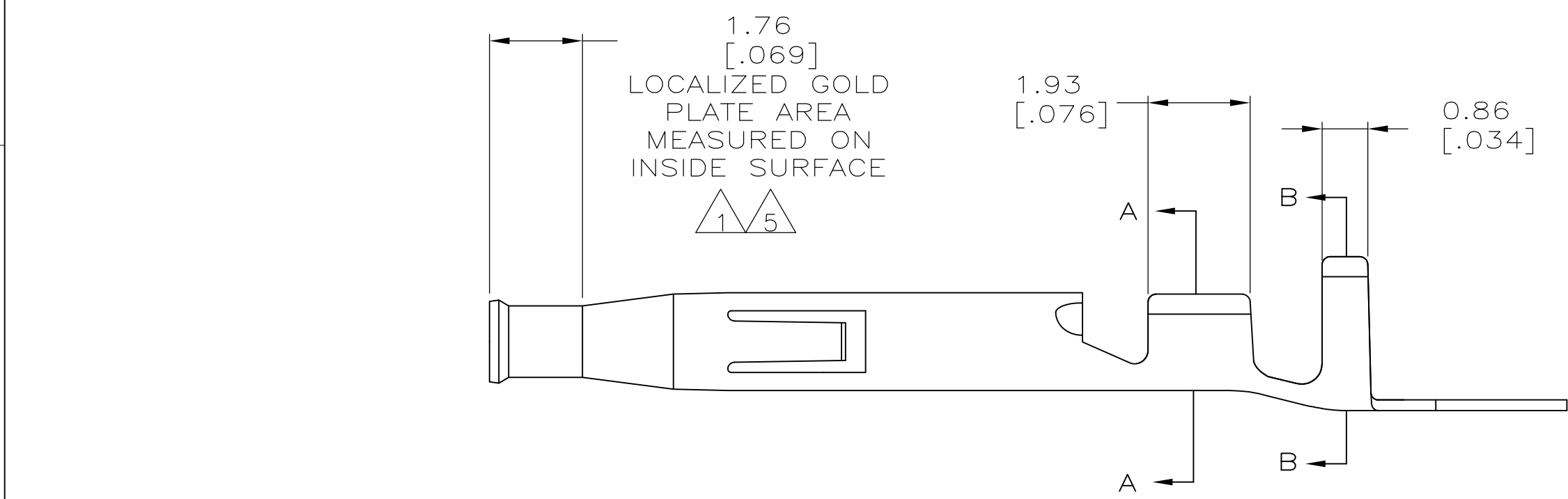
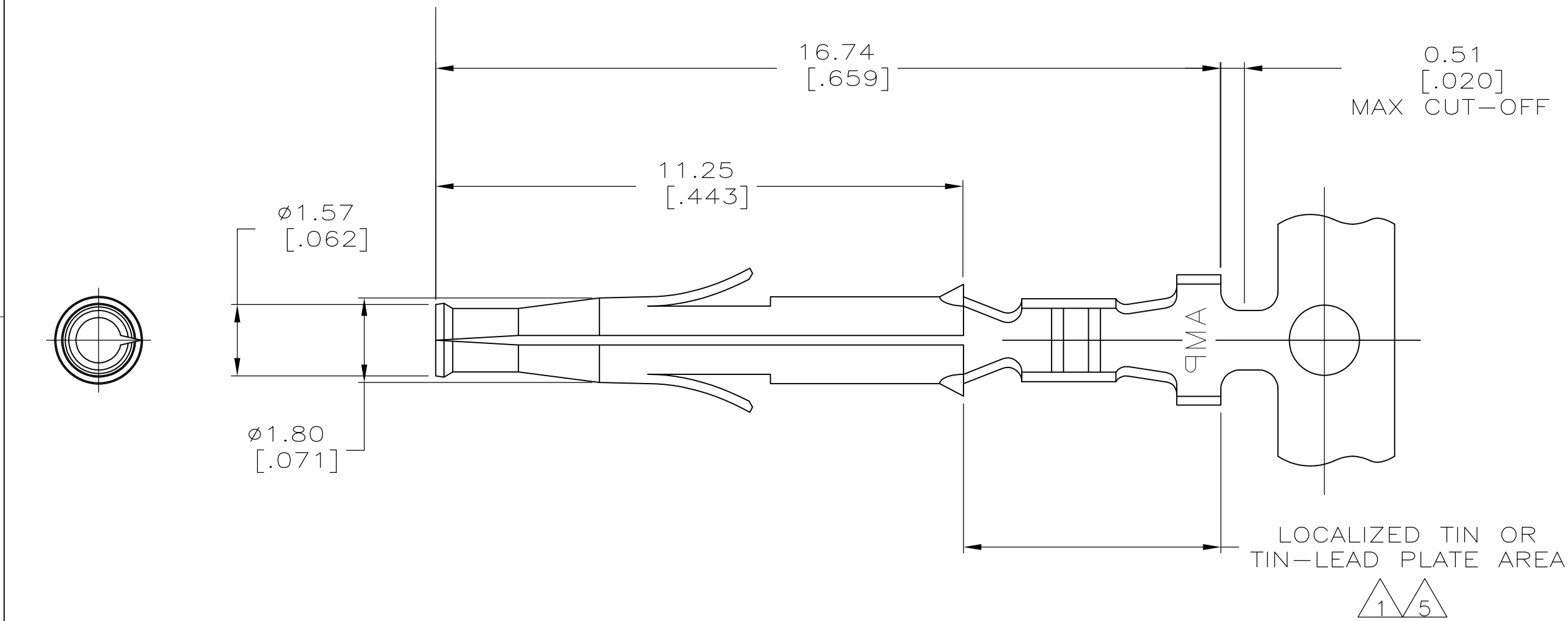

1. 0.00076 [.000030] MIN GOLD IN LOCALIZED GOLD PLATE AREA AND 0.00254 [.000100] MIN BRIGHT TIN-LEAD IN LOCALIZED TIN-LEAD PLATE AREA OVER 0.0013 [.000050] MIN NICKEL.
2. DIMENSIONS IN BRACKETS ARE IN INCHES.
3. INSULATION RANGE :1.50-2.40[.060-.094] DIA.
4. WIRE RANGE: 0.3 - 0.9mm² (22-18 AWG).
5. 0.00076 [.000030] MIN GOLD IN LOCALIZED GOLD PLATE AREA AND 0.00254 [.000100] MIN MATTE TIN IN LOCALIZED TIN PLATE AREA OVER 0.0013 [.000050] MIN NICKEL.

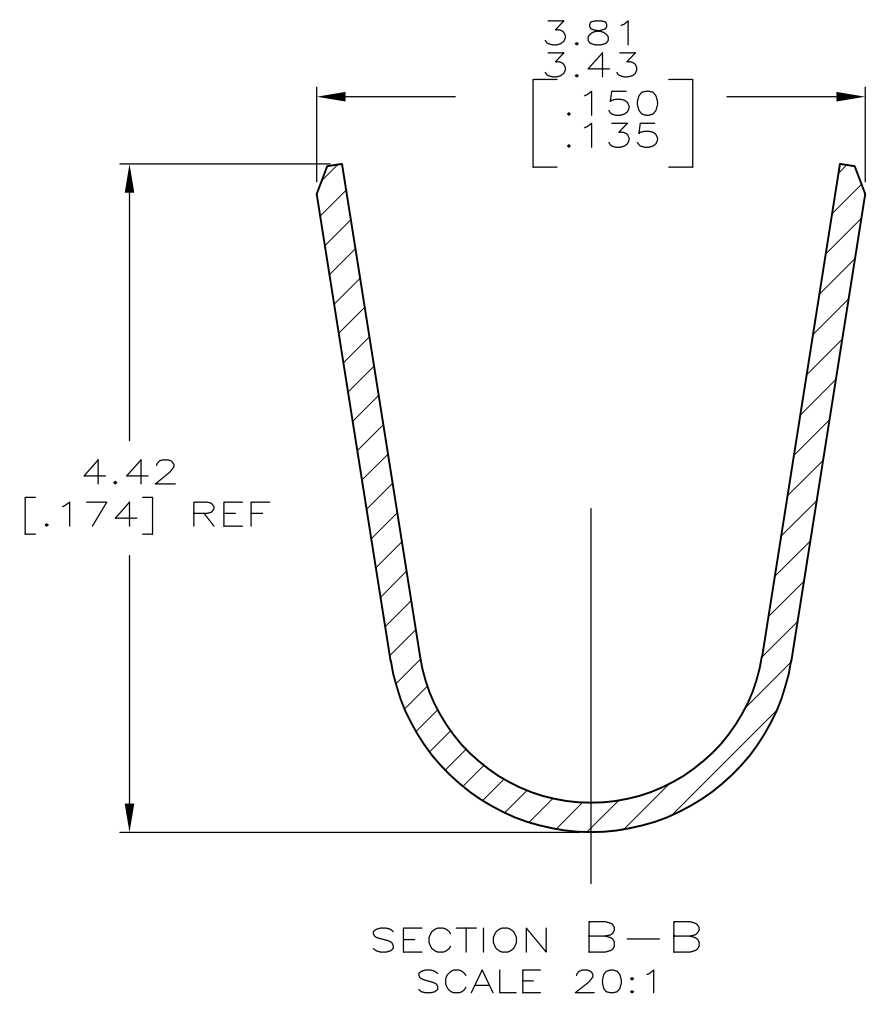

5	0.20 [.008] BRASS	1-794137-0
1	0.20 [.008] BRASS	794137-3
PRE-TIN	0.20 [.008] BRASS	794137-1
FINISH	MATERIAL	PART NUMBER

THIS DRAWING IS A CONTROLLED DOCUMENT.

DIMENSIONS:
mm [INCHES]

MATERIAL
SEE TABLE

TOLERANCES UNLESS OTHERWISE SPECIFIED:

0 PLC	± -
1 PLC	± -
2 PLC	± -
3 PLC	± 0.15[.006]
4 PLC	± -
ANGLES	± 1°

FINISH
SEE TABLE

DWN
R.VESTAL
17OCT96

CHK
R.SWING
17OCT96

APVD
R.OSTAD
17OCT96

PRODUCT SPEC

APPLICATION SPEC

WEIGHT
-

CUSTOMER DRAWING

TE Connectivity

NAME
SOCKET,
MINI UNIVERSAL MATE-N-LOK(TM)

SIZE
A2

CAGE CODE
00779

DRAWING NO
C=794137

RESTRICTED TO
-

SCALE
10:1

SHEET
1 OF 1

REV
C