



Chipsmall Limited consists of a professional team with an average of over 10 year of expertise in the distribution of electronic components. Based in Hongkong, we have already established firm and mutual-benefit business relationships with customers from,Europe,America and south Asia,supplying obsolete and hard-to-find components to meet their specific needs.

With the principle of "Quality Parts,Customers Priority,Honest Operation,and Considerate Service",our business mainly focus on the distribution of electronic components. Line cards we deal with include Microchip,ALPS,ROHM,Xilinx,Pulse,ON,Everlight and Freescale. Main products comprise IC,Modules,Potentiometer,IC Socket,Relay,Connector.Our parts cover such applications as commercial,industrial, and automotives areas.

We are looking forward to setting up business relationship with you and hope to provide you with the best service and solution. Let us make a better world for our industry!



Contact us

Tel: +86-755-8981 8866 Fax: +86-755-8427 6832

Email & Skype: info@chipsmall.com Web: www.chipsmall.com

Address: A1208, Overseas Decoration Building, #122 Zhenhua RD., Futian, Shenzhen, China



INTERCONNECTS

SERIES 800, 801, 802, 803 • .100" GRID SOLDER CUP HEADERS AND SOCKETS • SINGLE AND DOUBLE ROW STRIPS

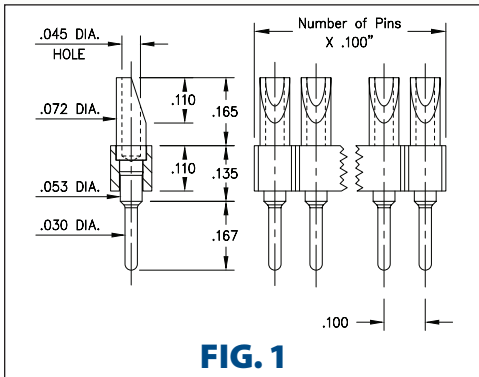

FIG. 1

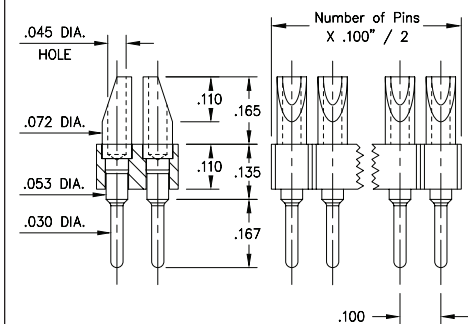

FIG. 2

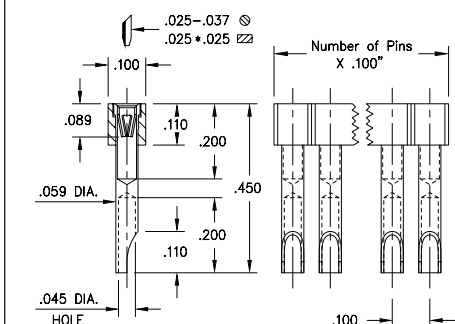

FIG. 3

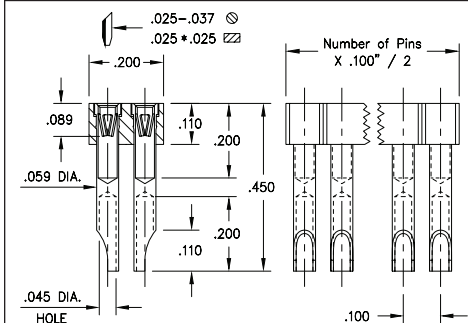
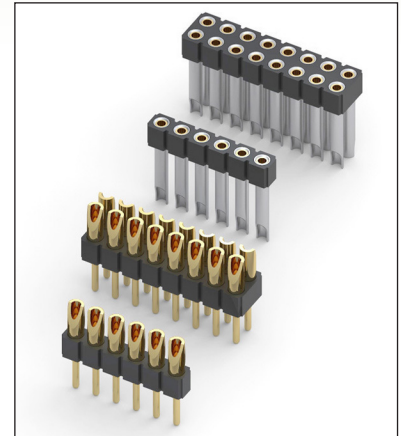

FIG. 4

- Series 800 and 802 use MM #1107 pins. See page 218 for details
- Series 801 and 803 use MM #1134 pin receptacles and accept pin diameters from .025"-.037" and .025" square pins. See page 177 for details
- Series 801 and 803 receptacles use Hi-Rel, 4-finger BeCu #47 contact rated at 4.5 amps. See page 256 for details
- Solder cups are pre-aligned and accept up to 20 AWG wire
- Insulators are high temperature thermoplastic, suitable for all soldering operations



ORDERING INFORMATION

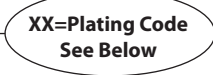





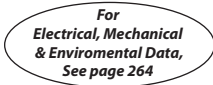



FIG. 1	Series 800...007	Single Row Solder Cup / Solder Tail	
	800-XX-0	-10-007000	02-64
Specify number of pins			
FIG. 2	Series 802...007	Double Row Solder Cup / Solder Tail	
	802-XX-0	-10-007000	02-64
Specify number of pins			
  			
SPECIFY PLATING CODE XX=		10 	40 
Pin Plating 		10 μ" Au	200 μ" Sn

FIG. 3	Series 801...007	Single Row Solder Cup Sockets	
	801-13-0	-10-007000	02-64
Specify number of pins			
FIG. 4	Series 803...007	Double Row Solder Cup Sockets	
	803-13-0	-10-007000	02-64
Specify number of pins			
  			
SPECIFY PLATING CODE XX=		13 	
Sleeve (Pin) 		10 μ" Au	
Contact (Clip) 		30 μ" Au	

