



Chipsmall Limited consists of a professional team with an average of over 10 year of expertise in the distribution of electronic components. Based in Hongkong, we have already established firm and mutual-benefit business relationships with customers from,Europe,America and south Asia,supplying obsolete and hard-to-find components to meet their specific needs.

With the principle of “Quality Parts,Customers Priority,Honest Operation,and Considerate Service”,our business mainly focus on the distribution of electronic components. Line cards we deal with include Microchip,ALPS,ROHM,Xilinx,Pulse,ON,Everlight and Freescale. Main products comprise IC,Modules,Potentiometer,IC Socket,Relay,Connector.Our parts cover such applications as commercial,industrial, and automotives areas.

We are looking forward to setting up business relationship with you and hope to provide you with the best service and solution. Let us make a better world for our industry!



Contact us

Tel: +86-755-8981 8866 Fax: +86-755-8427 6832

Email & Skype: info@chipsmall.com Web: www.chipsmall.com

Address: A1208, Overseas Decoration Building, #122 Zhenhua RD., Futian, Shenzhen, China



Series 82

Characteristics

The compact Series 82 is especially suited for:

- Flush design

The robust construction and the metal housing allow a high vandal resistant, which approximate a mechanical front protection of IK10.

Functions

The Series 82 incorporates the following functions:

- Indicator
- Pushbutton
- Illuminated pushbutton

Market segments

The EAO series 82 is used in the following segments:

- Machinery and Automation
- Building technology
- Panel building

Please refer to the EAO website to obtain detailed information regarding this series www.products.eao.com
Configure a product to your exact needs and request a quotation.



Overview**Flush design**

Indicator Ø 16 mm, silver contact	4
Indicator Ø 19 mm, silver contact	14
Indicator Ø 22 mm, silver contact	24
Pushbutton Ø 16 mm, silver contact	34
Pushbutton Ø 16 mm, gold-plated silver contact	39
Pushbutton Ø 19 mm, silver contact	44
Pushbutton Ø 19 mm, gold-plated silver contact	49
Pushbutton Ø 22 mm, silver contact	54
Pushbutton Ø 22 mm, gold-plated silver contact	59
Illuminated pushbutton Ø 16 mm, silver contact	64
Illuminated pushbutton Ø 16 mm, gold-plated silver contact	83
Illuminated pushbutton Ø 19 mm, silver contact	102
Illuminated pushbutton Ø 19 mm, gold-plated silver contact	121
Illuminated pushbutton Ø 22 mm, silver contact	140
Illuminated pushbutton Ø 22 mm, gold-plated silver contact	159

Drawings**181****Technical data****182****Marking****184****Order examples****185****Application guidelines****187****Index****188**

82 Flush design

Indicator Ø 16 mm, Silver contact, IP 65 & IP 67



Product can differ from the current configuration.

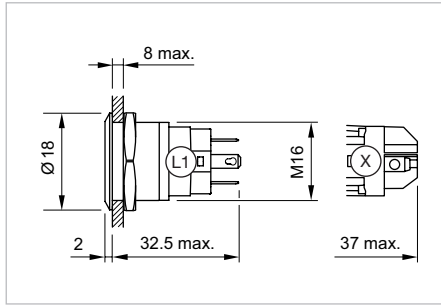

Dimensions [mm]
L1 = Solder/Plug-in terminal 2.8 x 0.5 mm,
X = Screw terminal

Equipment consisting of (schematic overview)

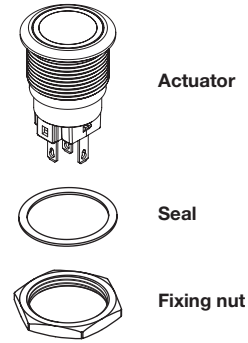

Additional Information

- The laser 2D-technology can mark all stainless steel versions with flush lenses – flush-mounting as well as raised versions.

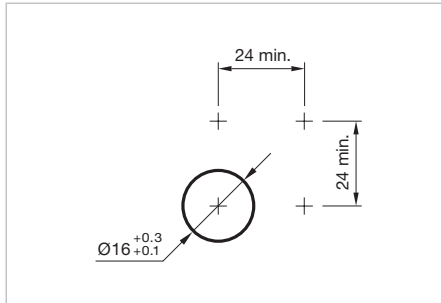

Mounting cut-outs [mm]

Each Part Number listed below includes all the black pcomponents shown in the 3D-drawing.

Illumination	Operating voltage	Operating current	Front ring shape	Lens	Terminal	Part No.	Component layout	Wiring diagram	Weight
 <p>Indicator 16 mm Stainless-steel, Front dimension Ø 18 mm</p>									
Ring with red LED	6 VAC/DC	15 mA	flush	flat / level with front ring	Solder 2.8 x 0.5 mm	82-4151.0112	1	1	0.018 kg
	12 VAC/DC	14 mA	flush	flat / level with front ring	Solder 2.8 x 0.5 mm	82-4151.0113	1	1	0.018 kg
	24 VAC/DC	10 mA	flush	flat / level with front ring	Solder 2.8 x 0.5 mm	82-4151.0114	1	1	0.018 kg
	110 VAC	2 mA	flush	flat / level with front ring	Solder 2.8 x 0.5 mm	82-4151.0115	1	1	0.018 kg
	230 VAC	1.3 mA	flush	flat / level with front ring	Solder 2.8 x 0.5 mm	82-4151.0116	1	1	0.018 kg
Ring with blue LED	6 VAC/DC	15 mA	flush	flat / level with front ring	Solder 2.8 x 0.5 mm	82-4151.0122	1	1	0.018 kg
	12 VAC/DC	14 mA	flush	flat / level with front ring	Solder 2.8 x 0.5 mm	82-4151.0123	1	1	0.018 kg
	24 VAC/DC	10 mA	flush	flat / level with front ring	Solder 2.8 x 0.5 mm	82-4151.0124	1	1	0.018 kg
	110 VAC	2 mA	flush	flat / level with front ring	Solder 2.8 x 0.5 mm	82-4151.0125	1	1	0.018 kg
	230 VAC	1.3 mA	flush	flat / level with front ring	Solder 2.8 x 0.5 mm	82-4151.0126	1	1	0.018 kg
Ring with green LED	6 VAC/DC	15 mA	flush	flat / level with front ring	Solder 2.8 x 0.5 mm	82-4151.0132	1	1	0.018 kg
	12 VAC/DC	14 mA	flush	flat / level with front ring	Solder 2.8 x 0.5 mm	82-4151.0133	1	1	0.018 kg
	24 VAC/DC	10 mA	flush	flat / level with front ring	Solder 2.8 x 0.5 mm	82-4151.0134	1	1	0.018 kg
	110 VAC	2 mA	flush	flat / level with front ring	Solder 2.8 x 0.5 mm	82-4151.0135	1	1	0.018 kg
	230 VAC	1.3 mA	flush	flat / level with front ring	Solder 2.8 x 0.5 mm	82-4151.0136	1	1	0.018 kg
Ring with yellow LED	6 VAC/DC	15 mA	flush	flat / level with front ring	Solder 2.8 x 0.5 mm	82-4151.0142	1	1	0.018 kg
	12 VAC/DC	14 mA	flush	flat / level with front ring	Solder 2.8 x 0.5 mm	82-4151.0143	1	1	0.018 kg
	24 VAC/DC	10 mA	flush	flat / level with front ring	Solder 2.8 x 0.5 mm	82-4151.0144	1	1	0.018 kg

illumination	Operating voltage	Operating current	Front ring shape	Lens	Terminal	Part No.	Component layout	Wiring diagram	Weight
Ring with white LED	6 VAC/DC	15 mA	flush	flat / level with front ring	Solder 2.8 x 0.5 mm	82-4151.0152	1	1	0.018 kg
	12 VAC/DC	14 mA	flush	flat / level with front ring	Solder 2.8 x 0.5 mm	82-4151.0153	1	1	0.018 kg
	24 VAC/DC	10 mA	flush	flat / level with front ring	Solder 2.8 x 0.5 mm	82-4151.0154	1	1	0.018 kg
	110 VAC	2 mA	flush	flat / level with front ring	Solder 2.8 x 0.5 mm	82-4151.0155	1	1	0.018 kg
	230 VAC	1.3 mA	flush	flat / level with front ring	Solder 2.8 x 0.5 mm	82-4151.0156	1	1	0.018 kg

Indicator 16 mm Stainless-steel, Front dimension Ø 18 mm

Dot with red LED	6 VAC/DC	15 mA	flush	flat / level with front ring	Solder 2.8 x 0.5 mm	82-4151.0212	1	1	0.021 kg
	12 VAC/DC	14 mA	flush	flat / level with front ring	Solder 2.8 x 0.5 mm	82-4151.0213	1	1	0.021 kg
	24 VAC/DC	10 mA	flush	flat / level with front ring	Solder 2.8 x 0.5 mm	82-4151.0214	1	1	0.021 kg
	110 VAC	2 mA	flush	flat / level with front ring	Solder 2.8 x 0.5 mm	82-4151.0215	1	1	0.021 kg
	230 VAC	1.3 mA	flush	flat / level with front ring	Solder 2.8 x 0.5 mm	82-4151.0216	1	1	0.021 kg
Dot with blue LED	6 VAC/DC	15 mA	flush	flat / level with front ring	Solder 2.8 x 0.5 mm	82-4151.0222	1	1	0.021 kg
	12 VAC/DC	14 mA	flush	flat / level with front ring	Solder 2.8 x 0.5 mm	82-4151.0223	1	1	0.021 kg
	24 VAC/DC	10 mA	flush	flat / level with front ring	Solder 2.8 x 0.5 mm	82-4151.0224	1	1	0.021 kg
	110 VAC	2 mA	flush	flat / level with front ring	Solder 2.8 x 0.5 mm	82-4151.0225	1	1	0.021 kg
	230 VAC	1.3 mA	flush	flat / level with front ring	Solder 2.8 x 0.5 mm	82-4151.0226	1	1	0.021 kg
Dot with green LED	6 VAC/DC	15 mA	flush	flat / level with front ring	Solder 2.8 x 0.5 mm	82-4151.0232	1	1	0.021 kg
	12 VAC/DC	14 mA	flush	flat / level with front ring	Solder 2.8 x 0.5 mm	82-4151.0233	1	1	0.021 kg
	24 VAC/DC	10 mA	flush	flat / level with front ring	Solder 2.8 x 0.5 mm	82-4151.0234	1	1	0.021 kg
	110 VAC	2 mA	flush	flat / level with front ring	Solder 2.8 x 0.5 mm	82-4151.0235	1	1	0.021 kg
	230 VAC	1.3 mA	flush	flat / level with front ring	Solder 2.8 x 0.5 mm	82-4151.0236	1	1	0.021 kg
Dot with yellow LED	6 VAC/DC	15 mA	flush	flat / level with front ring	Solder 2.8 x 0.5 mm	82-4151.0242	1	1	0.021 kg
	12 VAC/DC	14 mA	flush	flat / level with front ring	Solder 2.8 x 0.5 mm	82-4151.0243	1	1	0.021 kg
	24 VAC/DC	10 mA	flush	flat / level with front ring	Solder 2.8 x 0.5 mm	82-4151.0244	1	1	0.021 kg
Dot with white LED	6 VAC/DC	15 mA	flush	flat / level with front ring	Solder 2.8 x 0.5 mm	82-4151.0252	1	1	0.021 kg
	12 VAC/DC	14 mA	flush	flat / level with front ring	Solder 2.8 x 0.5 mm	82-4151.0253	1	1	0.021 kg
	24 VAC/DC	10 mA	flush	flat / level with front ring	Solder 2.8 x 0.5 mm	82-4151.0254	1	1	0.021 kg
	110 VAC	2 mA	flush	flat / level with front ring	Solder 2.8 x 0.5 mm	82-4151.0255	1	1	0.021 kg
	230 VAC	1.3 mA	flush	flat / level with front ring	Solder 2.8 x 0.5 mm	82-4151.0256	1	1	0.021 kg

Indicator 16 mm Stainless-steel chrome-coloured, Front dimension Ø 18 mm

Ring with red LED	6 VAC/DC	15 mA	flush	flat / level with front ring	Solder 2.8 x 0.5 mm	82-4251.0112	1	1	0.018 kg
	12 VAC/DC	14 mA	flush	flat / level with front ring	Solder 2.8 x 0.5 mm	82-4251.0113	1	1	0.018 kg
	24 VAC/DC	10 mA	flush	flat / level with front ring	Solder 2.8 x 0.5 mm	82-4251.0114	1	1	0.018 kg
	110 VAC	2 mA	flush	flat / level with front ring	Solder 2.8 x 0.5 mm	82-4251.0115	1	1	0.018 kg
	230 VAC	1.3 mA	flush	flat / level with front ring	Solder 2.8 x 0.5 mm	82-4251.0116	1	1	0.018 kg
Ring with blue LED	6 VAC/DC	15 mA	flush	flat / level with front ring	Solder 2.8 x 0.5 mm	82-4251.0122	1	1	0.018 kg
	12 VAC/DC	14 mA	flush	flat / level with front ring	Solder 2.8 x 0.5 mm	82-4251.0123	1	1	0.018 kg
	24 VAC/DC	10 mA	flush	flat / level with front ring	Solder 2.8 x 0.5 mm	82-4251.0124	1	1	0.018 kg
	110 VAC	2 mA	flush	flat / level with front ring	Solder 2.8 x 0.5 mm	82-4251.0125	1	1	0.018 kg
	230 VAC	1.3 mA	flush	flat / level with front ring	Solder 2.8 x 0.5 mm	82-4251.0126	1	1	0.018 kg
Ring with green LED	6 VAC/DC	15 mA	flush	flat / level with front ring	Solder 2.8 x 0.5 mm	82-4251.0132	1	1	0.018 kg
	12 VAC/DC	14 mA	flush	flat / level with front ring	Solder 2.8 x 0.5 mm	82-4251.0133	1	1	0.018 kg
	24 VAC/DC	10 mA	flush	flat / level with front ring	Solder 2.8 x 0.5 mm	82-4251.0134	1	1	0.018 kg
	110 VAC	2 mA	flush	flat / level with front ring	Solder 2.8 x 0.5 mm	82-4251.0135	1	1	0.018 kg
	230 VAC	1.3 mA	flush	flat / level with front ring	Solder 2.8 x 0.5 mm	82-4251.0136	1	1	0.018 kg

82 Flush design

Illumination	Operating voltage	Operating current	Front ring shape	Lens	Terminal	Part No.	Component layout	Wiring diagram	Weight
Ring with yellow LED	6 VAC/DC	15 mA	flush	flat / level with front ring	Solder 2.8 x 0.5 mm	82-4251.0142	1	1	0.018 kg
	12 VAC/DC	14 mA	flush	flat / level with front ring	Solder 2.8 x 0.5 mm	82-4251.0143	1	1	0.018 kg
	24 VAC/DC	10 mA	flush	flat / level with front ring	Solder 2.8 x 0.5 mm	82-4251.0144	1	1	0.018 kg
Ring with white LED	6 VAC/DC	15 mA	flush	flat / level with front ring	Solder 2.8 x 0.5 mm	82-4251.0152	1	1	0.018 kg
	12 VAC/DC	14 mA	flush	flat / level with front ring	Solder 2.8 x 0.5 mm	82-4251.0153	1	1	0.018 kg
	24 VAC/DC	10 mA	flush	flat / level with front ring	Solder 2.8 x 0.5 mm	82-4251.0154	1	1	0.018 kg
	110 VAC	2 mA	flush	flat / level with front ring	Solder 2.8 x 0.5 mm	82-4251.0155	1	1	0.018 kg
	230 VAC	1.3 mA	flush	flat / level with front ring	Solder 2.8 x 0.5 mm	82-4251.0156	1	1	0.018 kg



Indicator 16 mm Stainless-steel chrome-colour, Front dimension Ø 18 mm

Dot with red LED	6 VAC/DC	15 mA	flush	flat / level with front ring	Solder 2.8 x 0.5 mm	82-4251.0212	1	1	0.021 kg
	12 VAC/DC	14 mA	flush	flat / level with front ring	Solder 2.8 x 0.5 mm	82-4251.0213	1	1	0.021 kg
	24 VAC/DC	10 mA	flush	flat / level with front ring	Solder 2.8 x 0.5 mm	82-4251.0214	1	1	0.021 kg
	110 VAC	2 mA	flush	flat / level with front ring	Solder 2.8 x 0.5 mm	82-4251.0215	1	1	0.021 kg
	230 VAC	1.3 mA	flush	flat / level with front ring	Solder 2.8 x 0.5 mm	82-4251.0216	1	1	0.021 kg
Dot with blue LED	6 VAC/DC	15 mA	flush	flat / level with front ring	Solder 2.8 x 0.5 mm	82-4251.0222	1	1	0.021 kg
	12 VAC/DC	14 mA	flush	flat / level with front ring	Solder 2.8 x 0.5 mm	82-4251.0223	1	1	0.021 kg
	24 VAC/DC	10 mA	flush	flat / level with front ring	Solder 2.8 x 0.5 mm	82-4251.0224	1	1	0.021 kg
	110 VAC	2 mA	flush	flat / level with front ring	Solder 2.8 x 0.5 mm	82-4251.0225	1	1	0.021 kg
	230 VAC	1.3 mA	flush	flat / level with front ring	Solder 2.8 x 0.5 mm	82-4251.0226	1	1	0.021 kg
Dot with green LED	6 VAC/DC	15 mA	flush	flat / level with front ring	Solder 2.8 x 0.5 mm	82-4251.0232	1	1	0.021 kg
	12 VAC/DC	14 mA	flush	flat / level with front ring	Solder 2.8 x 0.5 mm	82-4251.0233	1	1	0.021 kg
	24 VAC/DC	10 mA	flush	flat / level with front ring	Solder 2.8 x 0.5 mm	82-4251.0234	1	1	0.021 kg
	110 VAC	2 mA	flush	flat / level with front ring	Solder 2.8 x 0.5 mm	82-4251.0235	1	1	0.021 kg
	230 VAC	1.3 mA	flush	flat / level with front ring	Solder 2.8 x 0.5 mm	82-4251.0236	1	1	0.021 kg
Dot with yellow LED	6 VAC/DC	15 mA	flush	flat / level with front ring	Solder 2.8 x 0.5 mm	82-4251.0242	1	1	0.021 kg
	12 VAC/DC	14 mA	flush	flat / level with front ring	Solder 2.8 x 0.5 mm	82-4251.0243	1	1	0.021 kg
	24 VAC/DC	10 mA	flush	flat / level with front ring	Solder 2.8 x 0.5 mm	82-4251.0244	1	1	0.021 kg
Dot with white LED	6 VAC/DC	15 mA	flush	flat / level with front ring	Solder 2.8 x 0.5 mm	82-4251.0252	1	1	0.021 kg
	12 VAC/DC	14 mA	flush	flat / level with front ring	Solder 2.8 x 0.5 mm	82-4251.0253	1	1	0.021 kg
	24 VAC/DC	10 mA	flush	flat / level with front ring	Solder 2.8 x 0.5 mm	82-4251.0254	1	1	0.021 kg
	110 VAC	2 mA	flush	flat / level with front ring	Solder 2.8 x 0.5 mm	82-4251.0255	1	1	0.021 kg
	230 VAC	1.3 mA	flush	flat / level with front ring	Solder 2.8 x 0.5 mm	82-4251.0256	1	1	0.021 kg

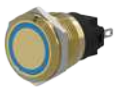

Indicator 16 mm Messing, Front dimension Ø 18 mm

Ring with red LED	6 VAC/DC	15 mA	flush	flat / level with front ring	Solder 2.8 x 0.5 mm	82-4351.0112	1	1	0.018 kg
	12 VAC/DC	14 mA	flush	flat / level with front ring	Solder 2.8 x 0.5 mm	82-4351.0113	1	1	0.018 kg
	24 VAC/DC	10 mA	flush	flat / level with front ring	Solder 2.8 x 0.5 mm	82-4351.0114	1	1	0.018 kg
	110 VAC	2 mA	flush	flat / level with front ring	Solder 2.8 x 0.5 mm	82-4351.0115	1	1	0.018 kg
	230 VAC	1.3 mA	flush	flat / level with front ring	Solder 2.8 x 0.5 mm	82-4351.0116	1	1	0.018 kg
Ring with blue LED	6 VAC/DC	15 mA	flush	flat / level with front ring	Solder 2.8 x 0.5 mm	82-4351.0122	1	1	0.018 kg
	12 VAC/DC	14 mA	flush	flat / level with front ring	Solder 2.8 x 0.5 mm	82-4351.0123	1	1	0.018 kg
	24 VAC/DC	10 mA	flush	flat / level with front ring	Solder 2.8 x 0.5 mm	82-4351.0124	1	1	0.018 kg
	110 VAC	2 mA	flush	flat / level with front ring	Solder 2.8 x 0.5 mm	82-4351.0125	1	1	0.018 kg
	230 VAC	1.3 mA	flush	flat / level with front ring	Solder 2.8 x 0.5 mm	82-4351.0126	1	1	0.018 kg



illumination	Operating voltage	Operating current	Front ring shape	Lens	Terminal	Part No.	Component layout	Wiring diagram	Weight
Ring with green LED	6 VAC/DC	15 mA	flush	flat / level with front ring	Solder 2.8 x 0.5 mm	82-4351.0132	1	1	0.018 kg
	12 VAC/DC	14 mA	flush	flat / level with front ring	Solder 2.8 x 0.5 mm	82-4351.0133	1	1	0.018 kg
	24 VAC/DC	10 mA	flush	flat / level with front ring	Solder 2.8 x 0.5 mm	82-4351.0134	1	1	0.018 kg
	110 VAC	2 mA	flush	flat / level with front ring	Solder 2.8 x 0.5 mm	82-4351.0135	1	1	0.018 kg
	230 VAC	1.3 mA	flush	flat / level with front ring	Solder 2.8 x 0.5 mm	82-4351.0136	1	1	0.018 kg
Ring with yellow LED	6 VAC/DC	15 mA	flush	flat / level with front ring	Solder 2.8 x 0.5 mm	82-4351.0142	1	1	0.018 kg
	12 VAC/DC	14 mA	flush	flat / level with front ring	Solder 2.8 x 0.5 mm	82-4351.0143	1	1	0.018 kg
	24 VAC/DC	10 mA	flush	flat / level with front ring	Solder 2.8 x 0.5 mm	82-4351.0144	1	1	0.018 kg
Ring with white LED	6 VAC/DC	15 mA	flush	flat / level with front ring	Solder 2.8 x 0.5 mm	82-4351.0152	1	1	0.018 kg
	12 VAC/DC	14 mA	flush	flat / level with front ring	Solder 2.8 x 0.5 mm	82-4351.0153	1	1	0.018 kg
	24 VAC/DC	10 mA	flush	flat / level with front ring	Solder 2.8 x 0.5 mm	82-4351.0154	1	1	0.018 kg
	110 VAC	2 mA	flush	flat / level with front ring	Solder 2.8 x 0.5 mm	82-4351.0155	1	1	0.018 kg
	230 VAC	1.3 mA	flush	flat / level with front ring	Solder 2.8 x 0.5 mm	82-4351.0156	1	1	0.018 kg



Indicator 16 mm Messing, Front dimension Ø 18 mm

Dot with red LED	6 VAC/DC	15 mA	flush	flat / level with front ring	Solder 2.8 x 0.5 mm	82-4351.0212	1	1	0.021 kg
	12 VAC/DC	14 mA	flush	flat / level with front ring	Solder 2.8 x 0.5 mm	82-4351.0213	1	1	0.021 kg
	24 VAC/DC	10 mA	flush	flat / level with front ring	Solder 2.8 x 0.5 mm	82-4351.0214	1	1	0.021 kg
	110 VAC	2 mA	flush	flat / level with front ring	Solder 2.8 x 0.5 mm	82-4351.0215	1	1	0.021 kg
	230 VAC	1.3 mA	flush	flat / level with front ring	Solder 2.8 x 0.5 mm	82-4351.0216	1	1	0.021 kg
Dot with blue LED	6 VAC/DC	15 mA	flush	flat / level with front ring	Solder 2.8 x 0.5 mm	82-4351.0222	1	1	0.021 kg
	12 VAC/DC	14 mA	flush	flat / level with front ring	Solder 2.8 x 0.5 mm	82-4351.0223	1	1	0.021 kg
	24 VAC/DC	10 mA	flush	flat / level with front ring	Solder 2.8 x 0.5 mm	82-4351.0224	1	1	0.021 kg
	110 VAC	2 mA	flush	flat / level with front ring	Solder 2.8 x 0.5 mm	82-4351.0225	1	1	0.021 kg
	230 VAC	1.3 mA	flush	flat / level with front ring	Solder 2.8 x 0.5 mm	82-4351.0226	1	1	0.021 kg
Dot with green LED	6 VAC/DC	15 mA	flush	flat / level with front ring	Solder 2.8 x 0.5 mm	82-4351.0232	1	1	0.021 kg
	12 VAC/DC	14 mA	flush	flat / level with front ring	Solder 2.8 x 0.5 mm	82-4351.0233	1	1	0.021 kg
	24 VAC/DC	10 mA	flush	flat / level with front ring	Solder 2.8 x 0.5 mm	82-4351.0234	1	1	0.021 kg
	110 VAC	2 mA	flush	flat / level with front ring	Solder 2.8 x 0.5 mm	82-4351.0235	1	1	0.021 kg
	230 VAC	1.3 mA	flush	flat / level with front ring	Solder 2.8 x 0.5 mm	82-4351.0236	1	1	0.021 kg
Dot with yellow LED	6 VAC/DC	15 mA	flush	flat / level with front ring	Solder 2.8 x 0.5 mm	82-4351.0242	1	1	0.021 kg
	12 VAC/DC	14 mA	flush	flat / level with front ring	Solder 2.8 x 0.5 mm	82-4351.0243	1	1	0.021 kg
	24 VAC/DC	10 mA	flush	flat / level with front ring	Solder 2.8 x 0.5 mm	82-4351.0244	1	1	0.021 kg
Dot with white LED	6 VAC/DC	15 mA	flush	flat / level with front ring	Solder 2.8 x 0.5 mm	82-4351.0252	1	1	0.021 kg
	12 VAC/DC	14 mA	flush	flat / level with front ring	Solder 2.8 x 0.5 mm	82-4351.0253	1	1	0.021 kg
	24 VAC/DC	10 mA	flush	flat / level with front ring	Solder 2.8 x 0.5 mm	82-4351.0254	1	1	0.021 kg
	110 VAC	2 mA	flush	flat / level with front ring	Solder 2.8 x 0.5 mm	82-4351.0255	1	1	0.021 kg
	230 VAC	1.3 mA	flush	flat / level with front ring	Solder 2.8 x 0.5 mm	82-4351.0256	1	1	0.021 kg

82 Flush design

illumination	Operating voltage	Operating current	Front ring shape	Lens	Terminal	Part No.	Component layout	Wiring diagram	Weight
 <p>Indicator 16 mm Aluminium, Front dimension Ø 18 mm</p>									
Ring with red LED	6 VAC/DC	15 mA	flush	flat / level with front ring	Solder 2.8 x 0.5 mm	82-4551.0112	1	1	0.018 kg
	12 VAC/DC	14 mA	flush	flat / level with front ring	Solder 2.8 x 0.5 mm	82-4551.0113	1	1	0.018 kg
	24 VAC/DC	10 mA	flush	flat / level with front ring	Solder 2.8 x 0.5 mm	82-4551.0114	1	1	0.018 kg
	110 VAC	2 mA	flush	flat / level with front ring	Solder 2.8 x 0.5 mm	82-4551.0115	1	1	0.018 kg
	230 VAC	1.3 mA	flush	flat / level with front ring	Solder 2.8 x 0.5 mm	82-4551.0116	1	1	0.018 kg
Ring with blue LED	6 VAC/DC	15 mA	flush	flat / level with front ring	Solder 2.8 x 0.5 mm	82-4551.0122	1	1	0.018 kg
	12 VAC/DC	14 mA	flush	flat / level with front ring	Solder 2.8 x 0.5 mm	82-4551.0123	1	1	0.018 kg
	24 VAC/DC	10 mA	flush	flat / level with front ring	Solder 2.8 x 0.5 mm	82-4551.0124	1	1	0.018 kg
	110 VAC	2 mA	flush	flat / level with front ring	Solder 2.8 x 0.5 mm	82-4551.0125	1	1	0.018 kg
	230 VAC	1.3 mA	flush	flat / level with front ring	Solder 2.8 x 0.5 mm	82-4551.0126	1	1	0.018 kg
Ring with green LED	6 VAC/DC	15 mA	flush	flat / level with front ring	Solder 2.8 x 0.5 mm	82-4551.0132	1	1	0.018 kg
	12 VAC/DC	14 mA	flush	flat / level with front ring	Solder 2.8 x 0.5 mm	82-4551.0133	1	1	0.018 kg
	24 VAC/DC	10 mA	flush	flat / level with front ring	Solder 2.8 x 0.5 mm	82-4551.0134	1	1	0.018 kg
	110 VAC	2 mA	flush	flat / level with front ring	Solder 2.8 x 0.5 mm	82-4551.0135	1	1	0.018 kg
	230 VAC	1.3 mA	flush	flat / level with front ring	Solder 2.8 x 0.5 mm	82-4551.0136	1	1	0.018 kg
Ring with yellow LED	6 VAC/DC	15 mA	flush	flat / level with front ring	Solder 2.8 x 0.5 mm	82-4551.0142	1	1	0.018 kg
	12 VAC/DC	14 mA	flush	flat / level with front ring	Solder 2.8 x 0.5 mm	82-4551.0143	1	1	0.018 kg
	24 VAC/DC	10 mA	flush	flat / level with front ring	Solder 2.8 x 0.5 mm	82-4551.0144	1	1	0.018 kg
Ring with white LED	6 VAC/DC	15 mA	flush	flat / level with front ring	Solder 2.8 x 0.5 mm	82-4551.0152	1	1	0.018 kg
	12 VAC/DC	14 mA	flush	flat / level with front ring	Solder 2.8 x 0.5 mm	82-4551.0153	1	1	0.018 kg
	24 VAC/DC	10 mA	flush	flat / level with front ring	Solder 2.8 x 0.5 mm	82-4551.0154	1	1	0.018 kg
	110 VAC	2 mA	flush	flat / level with front ring	Solder 2.8 x 0.5 mm	82-4551.0155	1	1	0.018 kg
	230 VAC	1.3 mA	flush	flat / level with front ring	Solder 2.8 x 0.5 mm	82-4551.0156	1	1	0.018 kg
 <p>Indicator 16 mm Aluminium, Front dimension Ø 18 mm</p>									
Dot with red LED	6 VAC/DC	15 mA	flush	flat / level with front ring	Solder 2.8 x 0.5 mm	82-4551.0212	1	1	0.021 kg
	12 VAC/DC	14 mA	flush	flat / level with front ring	Solder 2.8 x 0.5 mm	82-4551.0213	1	1	0.021 kg
	24 VAC/DC	10 mA	flush	flat / level with front ring	Solder 2.8 x 0.5 mm	82-4551.0214	1	1	0.021 kg
	110 VAC	2 mA	flush	flat / level with front ring	Solder 2.8 x 0.5 mm	82-4551.0215	1	1	0.021 kg
	230 VAC	1.3 mA	flush	flat / level with front ring	Solder 2.8 x 0.5 mm	82-4551.0216	1	1	0.021 kg
Dot with blue LED	6 VAC/DC	15 mA	flush	flat / level with front ring	Solder 2.8 x 0.5 mm	82-4551.0222	1	1	0.021 kg
	12 VAC/DC	14 mA	flush	flat / level with front ring	Solder 2.8 x 0.5 mm	82-4551.0223	1	1	0.021 kg
	24 VAC/DC	10 mA	flush	flat / level with front ring	Solder 2.8 x 0.5 mm	82-4551.0224	1	1	0.021 kg
	110 VAC	2 mA	flush	flat / level with front ring	Solder 2.8 x 0.5 mm	82-4551.0225	1	1	0.021 kg
	230 VAC	1.3 mA	flush	flat / level with front ring	Solder 2.8 x 0.5 mm	82-4551.0226	1	1	0.021 kg
Dot with green LED	6 VAC/DC	15 mA	flush	flat / level with front ring	Solder 2.8 x 0.5 mm	82-4551.0232	1	1	0.021 kg
	12 VAC/DC	14 mA	flush	flat / level with front ring	Solder 2.8 x 0.5 mm	82-4551.0233	1	1	0.021 kg
	24 VAC/DC	10 mA	flush	flat / level with front ring	Solder 2.8 x 0.5 mm	82-4551.0234	1	1	0.021 kg
	110 VAC	2 mA	flush	flat / level with front ring	Solder 2.8 x 0.5 mm	82-4551.0235	1	1	0.021 kg
	230 VAC	1.3 mA	flush	flat / level with front ring	Solder 2.8 x 0.5 mm	82-4551.0236	1	1	0.021 kg
Dot with yellow LED	6 VAC/DC	15 mA	flush	flat / level with front ring	Solder 2.8 x 0.5 mm	82-4551.0242	1	1	0.021 kg
	12 VAC/DC	14 mA	flush	flat / level with front ring	Solder 2.8 x 0.5 mm	82-4551.0243	1	1	0.021 kg
	24 VAC/DC	10 mA	flush	flat / level with front ring	Solder 2.8 x 0.5 mm	82-4551.0244	1	1	0.021 kg

illumination	Operating voltage	Operating current	Front ring shape	Lens	Terminal	Part No.	Component layout	Wiring diagram	Weight
Dot with white LED	6 VAC/DC	15 mA	flush	flat / level with front ring	Solder 2.8 x 0.5 mm	82-4551.0252	1	1	0.021 kg
	12 VAC/DC	14 mA	flush	flat / level with front ring	Solder 2.8 x 0.5 mm	82-4551.0253	1	1	0.021 kg
	24 VAC/DC	10 mA	flush	flat / level with front ring	Solder 2.8 x 0.5 mm	82-4551.0254	1	1	0.021 kg
	110 VAC	2 mA	flush	flat / level with front ring	Solder 2.8 x 0.5 mm	82-4551.0255	1	1	0.021 kg
	230 VAC	1.3 mA	flush	flat / level with front ring	Solder 2.8 x 0.5 mm	82-4551.0256	1	1	0.021 kg



Indicator 16 mm Stainless-steel, Front dimension Ø 18 mm

Ring with red LED	6 VAC/DC	15 mA	flush	flat / level with front ring	Screw	82-4152.0112	4	1	0.018 kg
	12 VAC/DC	14 mA	flush	flat / level with front ring	Screw	82-4152.0113	4	1	0.018 kg
	24 VAC/DC	10 mA	flush	flat / level with front ring	Screw	82-4152.0114	4	1	0.018 kg
	110 VAC	2 mA	flush	flat / level with front ring	Screw	82-4152.0115	4	1	0.018 kg
	230 VAC	1.3 mA	flush	flat / level with front ring	Screw	82-4152.0116	4	1	0.018 kg
Ring with blue LED	6 VAC/DC	15 mA	flush	flat / level with front ring	Screw	82-4152.0122	4	1	0.018 kg
	12 VAC/DC	14 mA	flush	flat / level with front ring	Screw	82-4152.0123	4	1	0.018 kg
	24 VAC/DC	10 mA	flush	flat / level with front ring	Screw	82-4152.0124	4	1	0.018 kg
	110 VAC	2 mA	flush	flat / level with front ring	Screw	82-4152.0125	4	1	0.018 kg
	230 VAC	1.3 mA	flush	flat / level with front ring	Screw	82-4152.0126	4	1	0.018 kg
Ring with green LED	6 VAC/DC	15 mA	flush	flat / level with front ring	Screw	82-4152.0132	4	1	0.018 kg
	12 VAC/DC	14 mA	flush	flat / level with front ring	Screw	82-4152.0133	4	1	0.018 kg
	24 VAC/DC	10 mA	flush	flat / level with front ring	Screw	82-4152.0134	4	1	0.018 kg
	110 VAC	2 mA	flush	flat / level with front ring	Screw	82-4152.0135	4	1	0.018 kg
	230 VAC	1.3 mA	flush	flat / level with front ring	Screw	82-4152.0136	4	1	0.018 kg
Ring with yellow LED	6 VAC/DC	15 mA	flush	flat / level with front ring	Screw	82-4152.0142	4	1	0.018 kg
	12 VAC/DC	14 mA	flush	flat / level with front ring	Screw	82-4152.0143	4	1	0.018 kg
	24 VAC/DC	10 mA	flush	flat / level with front ring	Screw	82-4152.0144	4	1	0.018 kg
Ring with white LED	6 VAC/DC	15 mA	flush	flat / level with front ring	Screw	82-4152.0152	4	1	0.018 kg
	12 VAC/DC	14 mA	flush	flat / level with front ring	Screw	82-4152.0153	4	1	0.018 kg
	24 VAC/DC	10 mA	flush	flat / level with front ring	Screw	82-4152.0154	4	1	0.018 kg
	110 VAC	2 mA	flush	flat / level with front ring	Screw	82-4152.0155	4	1	0.018 kg
	230 VAC	1.3 mA	flush	flat / level with front ring	Screw	82-4152.0156	4	1	0.018 kg



Indicator 16 mm Stainless-steel, Front dimension Ø 18 mm

Dot with red LED	6 VAC/DC	15 mA	flush	flat / level with front ring	Screw	82-4152.0212	4	1	0.021 kg
	12 VAC/DC	14 mA	flush	flat / level with front ring	Screw	82-4152.0213	4	1	0.021 kg
	24 VAC/DC	10 mA	flush	flat / level with front ring	Screw	82-4152.0214	4	1	0.021 kg
	110 VAC	2 mA	flush	flat / level with front ring	Screw	82-4152.0215	4	1	0.021 kg
	230 VAC	1.3 mA	flush	flat / level with front ring	Screw	82-4152.0216	4	1	0.021 kg
Dot with blue LED	6 VAC/DC	15 mA	flush	flat / level with front ring	Screw	82-4152.0222	4	1	0.021 kg
	12 VAC/DC	14 mA	flush	flat / level with front ring	Screw	82-4152.0223	4	1	0.021 kg
	24 VAC/DC	10 mA	flush	flat / level with front ring	Screw	82-4152.0224	4	1	0.021 kg
	110 VAC	2 mA	flush	flat / level with front ring	Screw	82-4152.0225	4	1	0.021 kg
	230 VAC	1.3 mA	flush	flat / level with front ring	Screw	82-4152.0226	4	1	0.021 kg
Dot with green LED	6 VAC/DC	15 mA	flush	flat / level with front ring	Screw	82-4152.0232	4	1	0.021 kg
	12 VAC/DC	14 mA	flush	flat / level with front ring	Screw	82-4152.0233	4	1	0.021 kg
	24 VAC/DC	10 mA	flush	flat / level with front ring	Screw	82-4152.0234	4	1	0.021 kg
	110 VAC	2 mA	flush	flat / level with front ring	Screw	82-4152.0235	4	1	0.021 kg
	230 VAC	1.3 mA	flush	flat / level with front ring	Screw	82-4152.0236	4	1	0.021 kg

82 Flush design

Illumination	Operating voltage	Operating current	Front ring shape	Lens	Terminal	Part No.	Component layout	Wiring diagram	Weight
Dot with yellow LED	6 VAC/DC	15 mA	flush	flat / level with front ring	Screw	82-4152.0242	4	1	0.021 kg
	12 VAC/DC	14 mA	flush	flat / level with front ring	Screw	82-4152.0243	4	1	0.021 kg
	24 VAC/DC	10 mA	flush	flat / level with front ring	Screw	82-4152.0244	4	1	0.021 kg
Dot with white LED	6 VAC/DC	15 mA	flush	flat / level with front ring	Screw	82-4152.0252	4	1	0.021 kg
	12 VAC/DC	14 mA	flush	flat / level with front ring	Screw	82-4152.0253	4	1	0.021 kg
	24 VAC/DC	10 mA	flush	flat / level with front ring	Screw	82-4152.0254	4	1	0.021 kg
	110 VAC	2 mA	flush	flat / level with front ring	Screw	82-4152.0255	4	1	0.021 kg
	230 VAC	1.3 mA	flush	flat / level with front ring	Screw	82-4152.0256	4	1	0.021 kg



Indicator 16 mm Stainless-steel chrome-colour, Front dimension Ø 18 mm

Ring with red LED	6 VAC/DC	15 mA	flush	flat / level with front ring	Screw	82-4252.0112	4	1	0.018 kg
	12 VAC/DC	14 mA	flush	flat / level with front ring	Screw	82-4252.0113	4	1	0.018 kg
	24 VAC/DC	10 mA	flush	flat / level with front ring	Screw	82-4252.0114	4	1	0.018 kg
	110 VAC	2 mA	flush	flat / level with front ring	Screw	82-4252.0115	4	1	0.018 kg
	230 VAC	1.3 mA	flush	flat / level with front ring	Screw	82-4252.0116	4	1	0.018 kg
Ring with blue LED	6 VAC/DC	15 mA	flush	flat / level with front ring	Screw	82-4252.0122	4	1	0.018 kg
	12 VAC/DC	14 mA	flush	flat / level with front ring	Screw	82-4252.0123	4	1	0.018 kg
	24 VAC/DC	10 mA	flush	flat / level with front ring	Screw	82-4252.0124	4	1	0.018 kg
	110 VAC	2 mA	flush	flat / level with front ring	Screw	82-4252.0125	4	1	0.018 kg
	230 VAC	1.3 mA	flush	flat / level with front ring	Screw	82-4252.0126	4	1	0.018 kg
Ring with green LED	6 VAC/DC	15 mA	flush	flat / level with front ring	Screw	82-4252.0132	4	1	0.018 kg
	12 VAC/DC	14 mA	flush	flat / level with front ring	Screw	82-4252.0133	4	1	0.018 kg
	24 VAC/DC	10 mA	flush	flat / level with front ring	Screw	82-4252.0134	4	1	0.018 kg
	110 VAC	2 mA	flush	flat / level with front ring	Screw	82-4252.0135	4	1	0.018 kg
	230 VAC	1.3 mA	flush	flat / level with front ring	Screw	82-4252.0136	4	1	0.018 kg
Ring with yellow LED	6 VAC/DC	15 mA	flush	flat / level with front ring	Screw	82-4252.0142	4	1	0.018 kg
	12 VAC/DC	14 mA	flush	flat / level with front ring	Screw	82-4252.0143	4	1	0.018 kg
	24 VAC/DC	10 mA	flush	flat / level with front ring	Screw	82-4252.0144	4	1	0.018 kg
Ring with white LED	6 VAC/DC	15 mA	flush	flat / level with front ring	Screw	82-4252.0152	4	1	0.018 kg
	12 VAC/DC	14 mA	flush	flat / level with front ring	Screw	82-4252.0153	4	1	0.018 kg
	24 VAC/DC	10 mA	flush	flat / level with front ring	Screw	82-4252.0154	4	1	0.018 kg
	110 VAC	2 mA	flush	flat / level with front ring	Screw	82-4252.0155	4	1	0.018 kg
	230 VAC	1.3 mA	flush	flat / level with front ring	Screw	82-4252.0156	4	1	0.018 kg



Indicator 16 mm Stainless-steel chrome colour, Front dimension Ø 18 mm

Dot with red LED	6 VAC/DC	15 mA	flush	flat / level with front ring	Screw	82-4252.0212	4	1	0.021 kg
	12 VAC/DC	14 mA	flush	flat / level with front ring	Screw	82-4252.0213	4	1	0.021 kg
	24 VAC/DC	10 mA	flush	flat / level with front ring	Screw	82-4252.0214	4	1	0.021 kg
	110 VAC	2 mA	flush	flat / level with front ring	Screw	82-4252.0215	4	1	0.021 kg
	230 VAC	1.3 mA	flush	flat / level with front ring	Screw	82-4252.0216	4	1	0.021 kg
Dot with blue LED	6 VAC/DC	15 mA	flush	flat / level with front ring	Screw	82-4252.0222	4	1	0.021 kg
	12 VAC/DC	14 mA	flush	flat / level with front ring	Screw	82-4252.0223	4	1	0.021 kg
	24 VAC/DC	10 mA	flush	flat / level with front ring	Screw	82-4252.0224	4	1	0.021 kg
	110 VAC	2 mA	flush	flat / level with front ring	Screw	82-4252.0225	4	1	0.021 kg
	230 VAC	1.3 mA	flush	flat / level with front ring	Screw	82-4252.0226	4	1	0.021 kg



illumination	Operating voltage	Operating current	Front ring shape	Lens	Terminal	Part No.	Component layout	Wiring diagram	Weight
Dot with green LED	6 VAC/DC	15 mA	flush	flat / level with front ring	Screw	82-4252.0232	4	1	0.021 kg
	12 VAC/DC	14 mA	flush	flat / level with front ring	Screw	82-4252.0233	4	1	0.021 kg
	24 VAC/DC	10 mA	flush	flat / level with front ring	Screw	82-4252.0234	4	1	0.021 kg
	110 VAC	2 mA	flush	flat / level with front ring	Screw	82-4252.0235	4	1	0.021 kg
	230 VAC	1.3 mA	flush	flat / level with front ring	Screw	82-4252.0236	4	1	0.021 kg
Dot with yellow LED	6 VAC/DC	15 mA	flush	flat / level with front ring	Screw	82-4252.0242	4	1	0.021 kg
	12 VAC/DC	14 mA	flush	flat / level with front ring	Screw	82-4252.0243	4	1	0.021 kg
	24 VAC/DC	10 mA	flush	flat / level with front ring	Screw	82-4252.0244	4	1	0.021 kg
Dot with white LED	6 VAC/DC	15 mA	flush	flat / level with front ring	Screw	82-4252.0252	4	1	0.021 kg
	12 VAC/DC	14 mA	flush	flat / level with front ring	Screw	82-4252.0253	4	1	0.021 kg
	24 VAC/DC	10 mA	flush	flat / level with front ring	Screw	82-4252.0254	4	1	0.021 kg
	110 VAC	2 mA	flush	flat / level with front ring	Screw	82-4252.0255	4	1	0.021 kg
	230 VAC	1.3 mA	flush	flat / level with front ring	Screw	82-4252.0256	4	1	0.021 kg



Indicator 16 mm Messing, Front dimension Ø 18 mm

Ring with red LED	6 VAC/DC	15 mA	flush	flat / level with front ring	Screw	82-4352.0112	4	1	0.018 kg
	12 VAC/DC	14 mA	flush	flat / level with front ring	Screw	82-4352.0113	4	1	0.018 kg
	24 VAC/DC	10 mA	flush	flat / level with front ring	Screw	82-4352.0114	4	1	0.018 kg
	110 VAC	2 mA	flush	flat / level with front ring	Screw	82-4352.0115	4	1	0.018 kg
	230 VAC	1.3 mA	flush	flat / level with front ring	Screw	82-4352.0116	4	1	0.018 kg
Ring with blue LED	6 VAC/DC	15 mA	flush	flat / level with front ring	Screw	82-4352.0122	4	1	0.018 kg
	12 VAC/DC	14 mA	flush	flat / level with front ring	Screw	82-4352.0123	4	1	0.018 kg
	24 VAC/DC	10 mA	flush	flat / level with front ring	Screw	82-4352.0124	4	1	0.018 kg
	110 VAC	2 mA	flush	flat / level with front ring	Screw	82-4352.0125	4	1	0.018 kg
	230 VAC	1.3 mA	flush	flat / level with front ring	Screw	82-4352.0126	4	1	0.018 kg
Ring with green LED	6 VAC/DC	15 mA	flush	flat / level with front ring	Screw	82-4352.0132	4	1	0.018 kg
	12 VAC/DC	14 mA	flush	flat / level with front ring	Screw	82-4352.0133	4	1	0.018 kg
	24 VAC/DC	10 mA	flush	flat / level with front ring	Screw	82-4352.0134	4	1	0.018 kg
	110 VAC	2 mA	flush	flat / level with front ring	Screw	82-4352.0135	4	1	0.018 kg
	230 VAC	1.3 mA	flush	flat / level with front ring	Screw	82-4352.0136	4	1	0.018 kg
Ring with yellow LED	6 VAC/DC	15 mA	flush	flat / level with front ring	Screw	82-4352.0142	4	1	0.018 kg
	12 VAC/DC	14 mA	flush	flat / level with front ring	Screw	82-4352.0143	4	1	0.018 kg
	24 VAC/DC	10 mA	flush	flat / level with front ring	Screw	82-4352.0144	4	1	0.018 kg
Ring with white LED	6 VAC/DC	15 mA	flush	flat / level with front ring	Screw	82-4352.0152	4	1	0.018 kg
	12 VAC/DC	14 mA	flush	flat / level with front ring	Screw	82-4352.0153	4	1	0.018 kg
	24 VAC/DC	10 mA	flush	flat / level with front ring	Screw	82-4352.0154	4	1	0.018 kg
	110 VAC	2 mA	flush	flat / level with front ring	Screw	82-4352.0155	4	1	0.018 kg
	230 VAC	1.3 mA	flush	flat / level with front ring	Screw	82-4352.0156	4	1	0.018 kg

82 Flush design

Illumination	Operating voltage	Operating current	Front ring shape	Lens	Terminal	Part No.	Component layout	Wiring diagram	Weight
 <p>Indicator 16 mm Messing, Front dimension Ø 18 mm</p>									
Dot with red LED	6 VAC/DC	15 mA	flush	flat / level with front ring	Screw	82-4352.0212	4	1	0.021 kg
	12 VAC/DC	14 mA	flush	flat / level with front ring	Screw	82-4352.0213	4	1	0.021 kg
	24 VAC/DC	10 mA	flush	flat / level with front ring	Screw	82-4352.0214	4	1	0.021 kg
	110 VAC	2 mA	flush	flat / level with front ring	Screw	82-4352.0215	4	1	0.021 kg
	230 VAC	1.3 mA	flush	flat / level with front ring	Screw	82-4352.0216	4	1	0.021 kg
Dot with blue LED	6 VAC/DC	15 mA	flush	flat / level with front ring	Screw	82-4352.0222	4	1	0.021 kg
	12 VAC/DC	14 mA	flush	flat / level with front ring	Screw	82-4352.0223	4	1	0.021 kg
	24 VAC/DC	10 mA	flush	flat / level with front ring	Screw	82-4352.0224	4	1	0.021 kg
	110 VAC	2 mA	flush	flat / level with front ring	Screw	82-4352.0225	4	1	0.021 kg
	230 VAC	1.3 mA	flush	flat / level with front ring	Screw	82-4352.0226	4	1	0.021 kg
Dot with green LED	6 VAC/DC	15 mA	flush	flat / level with front ring	Screw	82-4352.0232	4	1	0.021 kg
	12 VAC/DC	14 mA	flush	flat / level with front ring	Screw	82-4352.0233	4	1	0.021 kg
	24 VAC/DC	10 mA	flush	flat / level with front ring	Screw	82-4352.0234	4	1	0.021 kg
	110 VAC	2 mA	flush	flat / level with front ring	Screw	82-4352.0235	4	1	0.021 kg
	230 VAC	1.3 mA	flush	flat / level with front ring	Screw	82-4352.0236	4	1	0.021 kg
Dot with yellow LED	6 VAC/DC	15 mA	flush	flat / level with front ring	Screw	82-4352.0242	4	1	0.021 kg
	12 VAC/DC	14 mA	flush	flat / level with front ring	Screw	82-4352.0243	4	1	0.021 kg
	24 VAC/DC	10 mA	flush	flat / level with front ring	Screw	82-4352.0244	4	1	0.021 kg
Dot with white LED	6 VAC/DC	15 mA	flush	flat / level with front ring	Screw	82-4352.0252	4	1	0.021 kg
	12 VAC/DC	14 mA	flush	flat / level with front ring	Screw	82-4352.0253	4	1	0.021 kg
	24 VAC/DC	10 mA	flush	flat / level with front ring	Screw	82-4352.0254	4	1	0.021 kg
	110 VAC	2 mA	flush	flat / level with front ring	Screw	82-4352.0255	4	1	0.021 kg
	230 VAC	1.3 mA	flush	flat / level with front ring	Screw	82-4352.0256	4	1	0.021 kg
 <p>Indicator 16 mm Aluminium, Front dimension Ø 18 mm</p>									
Ring with red LED	6 VAC/DC	15 mA	flush	flat / level with front ring	Screw	82-4552.0112	4	1	0.018 kg
	12 VAC/DC	14 mA	flush	flat / level with front ring	Screw	82-4552.0113	4	1	0.018 kg
	24 VAC/DC	10 mA	flush	flat / level with front ring	Screw	82-4552.0114	4	1	0.018 kg
	110 VAC	2 mA	flush	flat / level with front ring	Screw	82-4552.0115	4	1	0.018 kg
	230 VAC	1.3 mA	flush	flat / level with front ring	Screw	82-4552.0116	4	1	0.018 kg
Ring with blue LED	6 VAC/DC	15 mA	flush	flat / level with front ring	Screw	82-4552.0122	4	1	0.018 kg
	12 VAC/DC	14 mA	flush	flat / level with front ring	Screw	82-4552.0123	4	1	0.018 kg
	24 VAC/DC	10 mA	flush	flat / level with front ring	Screw	82-4552.0124	4	1	0.018 kg
	110 VAC	2 mA	flush	flat / level with front ring	Screw	82-4552.0125	4	1	0.018 kg
	230 VAC	1.3 mA	flush	flat / level with front ring	Screw	82-4552.0126	4	1	0.018 kg
Ring with green LED	6 VAC/DC	15 mA	flush	flat / level with front ring	Screw	82-4552.0132	4	1	0.018 kg
	12 VAC/DC	14 mA	flush	flat / level with front ring	Screw	82-4552.0133	4	1	0.018 kg
	24 VAC/DC	10 mA	flush	flat / level with front ring	Screw	82-4552.0134	4	1	0.018 kg
	110 VAC	2 mA	flush	flat / level with front ring	Screw	82-4552.0135	4	1	0.018 kg
	230 VAC	1.3 mA	flush	flat / level with front ring	Screw	82-4552.0136	4	1	0.018 kg
Ring with yellow LED	6 VAC/DC	15 mA	flush	flat / level with front ring	Screw	82-4552.0142	4	1	0.018 kg
	12 VAC/DC	14 mA	flush	flat / level with front ring	Screw	82-4552.0143	4	1	0.018 kg
	24 VAC/DC	10 mA	flush	flat / level with front ring	Screw	82-4552.0144	4	1	0.018 kg
	230 VAC	1.3 mA	flush	flat / level with front ring	Screw	82-4552.0146	4	1	0.018 kg

illumination	Operating voltage	Operating current	Front ring shape	lens	Terminal	Part No.	Component layout	Wiring diagram	Weight
Ring with white LED	6 VAC/DC	15 mA	flush	flat / level with front ring	Screw	82-4552.0152	4	1	0.018 kg
	12 VAC/DC	14 mA	flush	flat / level with front ring	Screw	82-4552.0153	4	1	0.018 kg
	24 VAC/DC	10 mA	flush	flat / level with front ring	Screw	82-4552.0154	4	1	0.018 kg
	110 VAC	2 mA	flush	flat / level with front ring	Screw	82-4552.0155	4	1	0.018 kg
	230 VAC	1.3 mA	flush	flat / level with front ring	Screw	82-4552.0156	4	1	0.018 kg



Indicator 16 mm Aluminium, Front dimension Ø 18 mm

Dot with red LED	6 VAC/DC	15 mA	flush	flat / level with front ring	Screw	82-4552.0212	4	1	0.021 kg
	12 VAC/DC	14 mA	flush	flat / level with front ring	Screw	82-4552.0213	4	1	0.021 kg
	24 VAC/DC	10 mA	flush	flat / level with front ring	Screw	82-4552.0214	4	1	0.021 kg
	110 VAC	2 mA	flush	flat / level with front ring	Screw	82-4552.0215	4	1	0.021 kg
	230 VAC	1.3 mA	flush	flat / level with front ring	Screw	82-4552.0216	4	1	0.021 kg
Dot with blue LED	6 VAC/DC	15 mA	flush	flat / level with front ring	Screw	82-4552.0222	4	1	0.021 kg
	12 VAC/DC	14 mA	flush	flat / level with front ring	Screw	82-4552.0223	4	1	0.021 kg
	24 VAC/DC	10 mA	flush	flat / level with front ring	Screw	82-4552.0224	4	1	0.021 kg
	110 VAC	2 mA	flush	flat / level with front ring	Screw	82-4552.0225	4	1	0.021 kg
	230 VAC	1.3 mA	flush	flat / level with front ring	Screw	82-4552.0226	4	1	0.021 kg
Dot with green LED	6 VAC/DC	15 mA	flush	flat / level with front ring	Screw	82-4552.0232	4	1	0.021 kg
	12 VAC/DC	14 mA	flush	flat / level with front ring	Screw	82-4552.0233	4	1	0.021 kg
	24 VAC/DC	10 mA	flush	flat / level with front ring	Screw	82-4552.0234	4	1	0.021 kg
	110 VAC	2 mA	flush	flat / level with front ring	Screw	82-4552.0235	4	1	0.021 kg
	230 VAC	1.3 mA	flush	flat / level with front ring	Screw	82-4552.0236	4	1	0.021 kg
Dot with yellow LED	6 VAC/DC	15 mA	flush	flat / level with front ring	Screw	82-4552.0242	4	1	0.021 kg
	12 VAC/DC	14 mA	flush	flat / level with front ring	Screw	82-4552.0243	4	1	0.021 kg
	24 VAC/DC	10 mA	flush	flat / level with front ring	Screw	82-4552.0244	4	1	0.021 kg
Dot with white LED	6 VAC/DC	15 mA	flush	flat / level with front ring	Screw	82-4552.0252	4	1	0.021 kg
	12 VAC/DC	14 mA	flush	flat / level with front ring	Screw	82-4552.0253	4	1	0.021 kg
	24 VAC/DC	10 mA	flush	flat / level with front ring	Screw	82-4552.0254	4	1	0.021 kg
	110 VAC	2 mA	flush	flat / level with front ring	Screw	82-4552.0255	4	1	0.021 kg
	230 VAC	1.3 mA	flush	flat / level with front ring	Screw	82-4552.0256	4	1	0.021 kg

The component layouts you will find from page 181

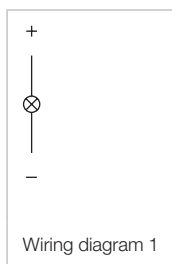

82 Flush design

Indicator 19 mm, Silver contact, IP 65 & IP 67



Product can differ from the current configuration.

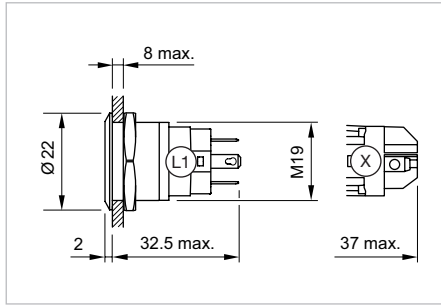

Dimensions [mm]
L1 = Solder/Plug-in terminal 2.8 x 0.5 mm,
X = Screw terminal

Equipment consisting of (schematic overview)

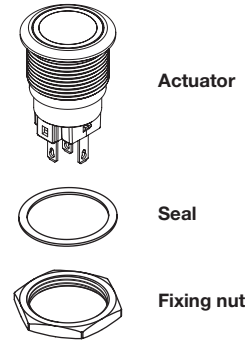

Additional Information

- The laser 2D-technology can mark all stainless steel versions with flush lenses – flush-mounting as well as raised versions.

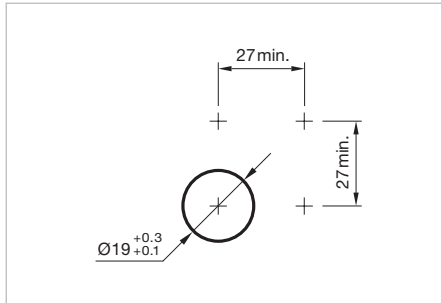

Mounting cut-outs [mm]

Each Part Number listed below includes all the black pcomponents shown in the 3D-drawing.

Illumination	Operating voltage	Operating current	Front ring shape	Lens	Terminal	Part No.	Component layout	Wiring diagram	Weight
 <p>Indicator 19 mm Stainless-steel, Front dimension Ø 22 mm</p>									
Ring with red LED	6 VAC/DC	15 mA	flush	flat / level with front ring	Solder 2.8 x 0.5 mm	82-5151.0112	1	1	0.018 kg
	12 VAC/DC	14 mA	flush	flat / level with front ring	Solder 2.8 x 0.5 mm	82-5151.0113	1	1	0.018 kg
	24 VAC/DC	10 mA	flush	flat / level with front ring	Solder 2.8 x 0.5 mm	82-5151.0114	1	1	0.018 kg
	110 VAC	2 mA	flush	flat / level with front ring	Solder 2.8 x 0.5 mm	82-5151.0115	1	1	0.018 kg
	230 VAC	1.3 mA	flush	flat / level with front ring	Solder 2.8 x 0.5 mm	82-5151.0116	1	1	0.018 kg
Ring with blue LED	6 VAC/DC	15 mA	flush	flat / level with front ring	Solder 2.8 x 0.5 mm	82-5151.0122	1	1	0.018 kg
	12 VAC/DC	14 mA	flush	flat / level with front ring	Solder 2.8 x 0.5 mm	82-5151.0123	1	1	0.018 kg
	24 VAC/DC	10 mA	flush	flat / level with front ring	Solder 2.8 x 0.5 mm	82-5151.0124	1	1	0.018 kg
	110 VAC	2 mA	flush	flat / level with front ring	Solder 2.8 x 0.5 mm	82-5151.0125	1	1	0.018 kg
	230 VAC	1.3 mA	flush	flat / level with front ring	Solder 2.8 x 0.5 mm	82-5151.0126	1	1	0.018 kg
Ring with green LED	6 VAC/DC	15 mA	flush	flat / level with front ring	Solder 2.8 x 0.5 mm	82-5151.0132	1	1	0.018 kg
	12 VAC/DC	14 mA	flush	flat / level with front ring	Solder 2.8 x 0.5 mm	82-5151.0133	1	1	0.018 kg
	24 VAC/DC	10 mA	flush	flat / level with front ring	Solder 2.8 x 0.5 mm	82-5151.0134	1	1	0.018 kg
	110 VAC	2 mA	flush	flat / level with front ring	Solder 2.8 x 0.5 mm	82-5151.0135	1	1	0.018 kg
	230 VAC	1.3 mA	flush	flat / level with front ring	Solder 2.8 x 0.5 mm	82-5151.0136	1	1	0.018 kg
Ring with yellow LED	6 VAC/DC	15 mA	flush	flat / level with front ring	Solder 2.8 x 0.5 mm	82-5151.0142	1	1	0.018 kg
	12 VAC/DC	14 mA	flush	flat / level with front ring	Solder 2.8 x 0.5 mm	82-5151.0143	1	1	0.018 kg
	24 VAC/DC	10 mA	flush	flat / level with front ring	Solder 2.8 x 0.5 mm	82-5151.0144	1	1	0.018 kg

Illumination	Operating voltage	Operating current	Front ring shape	Lens	Terminal	Part No.	Component layout	Wiring diagram	Weight
Ring with white LED	6 VAC/DC	15 mA	flush	flat / level with front ring	Solder 2.8 x 0.5 mm	82-5151.0152	1	1	0.018 kg
	12 VAC/DC	14 mA	flush	flat / level with front ring	Solder 2.8 x 0.5 mm	82-5151.0153	1	1	0.018 kg
	24 VAC/DC	10 mA	flush	flat / level with front ring	Solder 2.8 x 0.5 mm	82-5151.0154	1	1	0.018 kg
	110 VAC	2 mA	flush	flat / level with front ring	Solder 2.8 x 0.5 mm	82-5151.0155	1	1	0.018 kg
	230 VAC	1.3 mA	flush	flat / level with front ring	Solder 2.8 x 0.5 mm	82-5151.0156	1	1	0.018 kg

Indicator 19 mm Stainless-steel, Front dimension Ø 22 mm

Dot with red LED	6 VAC/DC	15 mA	flush	flat / level with front ring	Solder 2.8 x 0.5 mm	82-5151.0212	1	1	0.021 kg
	12 VAC/DC	14 mA	flush	flat / level with front ring	Solder 2.8 x 0.5 mm	82-5151.0213	1	1	0.021 kg
	24 VAC/DC	10 mA	flush	flat / level with front ring	Solder 2.8 x 0.5 mm	82-5151.0214	1	1	0.021 kg
	110 VAC	2 mA	flush	flat / level with front ring	Solder 2.8 x 0.5 mm	82-5151.0215	1	1	0.021 kg
	230 VAC	1.3 mA	flush	flat / level with front ring	Solder 2.8 x 0.5 mm	82-5151.0216	1	1	0.021 kg
Dot with blue LED	6 VAC/DC	15 mA	flush	flat / level with front ring	Solder 2.8 x 0.5 mm	82-5151.0222	1	1	0.021 kg
	12 VAC/DC	14 mA	flush	flat / level with front ring	Solder 2.8 x 0.5 mm	82-5151.0223	1	1	0.021 kg
	24 VAC/DC	10 mA	flush	flat / level with front ring	Solder 2.8 x 0.5 mm	82-5151.0224	1	1	0.021 kg
	110 VAC	2 mA	flush	flat / level with front ring	Solder 2.8 x 0.5 mm	82-5151.0225	1	1	0.021 kg
	230 VAC	1.3 mA	flush	flat / level with front ring	Solder 2.8 x 0.5 mm	82-5151.0226	1	1	0.021 kg
Dot with green LED	6 VAC/DC	15 mA	flush	flat / level with front ring	Solder 2.8 x 0.5 mm	82-5151.0232	1	1	0.021 kg
	12 VAC/DC	14 mA	flush	flat / level with front ring	Solder 2.8 x 0.5 mm	82-5151.0233	1	1	0.021 kg
	24 VAC/DC	10 mA	flush	flat / level with front ring	Solder 2.8 x 0.5 mm	82-5151.0234	1	1	0.021 kg
	110 VAC	2 mA	flush	flat / level with front ring	Solder 2.8 x 0.5 mm	82-5151.0235	1	1	0.021 kg
	230 VAC	1.3 mA	flush	flat / level with front ring	Solder 2.8 x 0.5 mm	82-5151.0236	1	1	0.021 kg
Dot with yellow LED	6 VAC/DC	15 mA	flush	flat / level with front ring	Solder 2.8 x 0.5 mm	82-5151.0242	1	1	0.021 kg
	12 VAC/DC	14 mA	flush	flat / level with front ring	Solder 2.8 x 0.5 mm	82-5151.0243	1	1	0.021 kg
	24 VAC/DC	10 mA	flush	flat / level with front ring	Solder 2.8 x 0.5 mm	82-5151.0244	1	1	0.021 kg
Dot with white LED	6 VAC/DC	15 mA	flush	flat / level with front ring	Solder 2.8 x 0.5 mm	82-5151.0252	1	1	0.021 kg
	12 VAC/DC	14 mA	flush	flat / level with front ring	Solder 2.8 x 0.5 mm	82-5151.0253	1	1	0.021 kg
	24 VAC/DC	10 mA	flush	flat / level with front ring	Solder 2.8 x 0.5 mm	82-5151.0254	1	1	0.021 kg
	110 VAC	2 mA	flush	flat / level with front ring	Solder 2.8 x 0.5 mm	82-5151.0255	1	1	0.021 kg
	230 VAC	1.3 mA	flush	flat / level with front ring	Solder 2.8 x 0.5 mm	82-5151.0256	1	1	0.021 kg

Indicator 19 mm Stainless-steel chrome-coloured, Front dimension Ø 22 mm

Ring with red LED	6 VAC/DC	15 mA	flush	flat / level with front ring	Solder 2.8 x 0.5 mm	82-5251.0112	1	1	0.018 kg
	12 VAC/DC	14 mA	flush	flat / level with front ring	Solder 2.8 x 0.5 mm	82-5251.0113	1	1	0.018 kg
	24 VAC/DC	10 mA	flush	flat / level with front ring	Solder 2.8 x 0.5 mm	82-5251.0114	1	1	0.018 kg
	110 VAC	2 mA	flush	flat / level with front ring	Solder 2.8 x 0.5 mm	82-5251.0115	1	1	0.018 kg
	230 VAC	1.3 mA	flush	flat / level with front ring	Solder 2.8 x 0.5 mm	82-5251.0116	1	1	0.018 kg
Ring with blue LED	6 VAC/DC	15 mA	flush	flat / level with front ring	Solder 2.8 x 0.5 mm	82-5251.0122	1	1	0.018 kg
	12 VAC/DC	14 mA	flush	flat / level with front ring	Solder 2.8 x 0.5 mm	82-5251.0123	1	1	0.018 kg
	24 VAC/DC	10 mA	flush	flat / level with front ring	Solder 2.8 x 0.5 mm	82-5251.0124	1	1	0.018 kg
	110 VAC	2 mA	flush	flat / level with front ring	Solder 2.8 x 0.5 mm	82-5251.0125	1	1	0.018 kg
	230 VAC	1.3 mA	flush	flat / level with front ring	Solder 2.8 x 0.5 mm	82-5251.0126	1	1	0.018 kg
Ring with green LED	6 VAC/DC	15 mA	flush	flat / level with front ring	Solder 2.8 x 0.5 mm	82-5251.0132	1	1	0.018 kg
	12 VAC/DC	14 mA	flush	flat / level with front ring	Solder 2.8 x 0.5 mm	82-5251.0133	1	1	0.018 kg
	24 VAC/DC	10 mA	flush	flat / level with front ring	Solder 2.8 x 0.5 mm	82-5251.0134	1	1	0.018 kg
	110 VAC	2 mA	flush	flat / level with front ring	Solder 2.8 x 0.5 mm	82-5251.0135	1	1	0.018 kg
	230 VAC	1.3 mA	flush	flat / level with front ring	Solder 2.8 x 0.5 mm	82-5251.0136	1	1	0.018 kg

82 Flush design

Illumination	Operating voltage	Operating current	Front ring shape	Lens	Terminal	Part No.	Component layout	Wiring diagram	Weight
Ring with yellow LED	6 VAC/DC	15 mA	flush	flat / level with front ring	Solder 2.8 x 0.5 mm	82-5251.0142	1	1	0.018 kg
	12 VAC/DC	14 mA	flush	flat / level with front ring	Solder 2.8 x 0.5 mm	82-5251.0143	1	1	0.018 kg
	24 VAC/DC	10 mA	flush	flat / level with front ring	Solder 2.8 x 0.5 mm	82-5251.0144	1	1	0.018 kg
Ring with white LED	6 VAC/DC	15 mA	flush	flat / level with front ring	Solder 2.8 x 0.5 mm	82-5251.0152	1	1	0.018 kg
	12 VAC/DC	14 mA	flush	flat / level with front ring	Solder 2.8 x 0.5 mm	82-5251.0153	1	1	0.018 kg
	24 VAC/DC	10 mA	flush	flat / level with front ring	Solder 2.8 x 0.5 mm	82-5251.0154	1	1	0.018 kg
	110 VAC	2 mA	flush	flat / level with front ring	Solder 2.8 x 0.5 mm	82-5251.0155	1	1	0.018 kg
	230 VAC	1.3 mA	flush	flat / level with front ring	Solder 2.8 x 0.5 mm	82-5251.0156	1	1	0.018 kg



Indicator 19 mm Stainless-steel chrome-colour, Front dimension Ø 22 mm

Dot with red LED	6 VAC/DC	15 mA	flush	flat / level with front ring	Solder 2.8 x 0.5 mm	82-5251.0212	1	1	0.021 kg
	12 VAC/DC	14 mA	flush	flat / level with front ring	Solder 2.8 x 0.5 mm	82-5251.0213	1	1	0.021 kg
	24 VAC/DC	10 mA	flush	flat / level with front ring	Solder 2.8 x 0.5 mm	82-5251.0214	1	1	0.021 kg
	110 VAC	2 mA	flush	flat / level with front ring	Solder 2.8 x 0.5 mm	82-5251.0215	1	1	0.021 kg
	230 VAC	1.3 mA	flush	flat / level with front ring	Solder 2.8 x 0.5 mm	82-5251.0216	1	1	0.021 kg
Dot with blue LED	6 VAC/DC	15 mA	flush	flat / level with front ring	Solder 2.8 x 0.5 mm	82-5251.0222	1	1	0.021 kg
	12 VAC/DC	14 mA	flush	flat / level with front ring	Solder 2.8 x 0.5 mm	82-5251.0223	1	1	0.021 kg
	24 VAC/DC	10 mA	flush	flat / level with front ring	Solder 2.8 x 0.5 mm	82-5251.0224	1	1	0.021 kg
	110 VAC	2 mA	flush	flat / level with front ring	Solder 2.8 x 0.5 mm	82-5251.0225	1	1	0.021 kg
	230 VAC	1.3 mA	flush	flat / level with front ring	Solder 2.8 x 0.5 mm	82-5251.0226	1	1	0.021 kg
Dot with green LED	6 VAC/DC	15 mA	flush	flat / level with front ring	Solder 2.8 x 0.5 mm	82-5251.0232	1	1	0.021 kg
	12 VAC/DC	14 mA	flush	flat / level with front ring	Solder 2.8 x 0.5 mm	82-5251.0233	1	1	0.021 kg
	24 VAC/DC	10 mA	flush	flat / level with front ring	Solder 2.8 x 0.5 mm	82-5251.0234	1	1	0.021 kg
	110 VAC	2 mA	flush	flat / level with front ring	Solder 2.8 x 0.5 mm	82-5251.0235	1	1	0.021 kg
	230 VAC	1.3 mA	flush	flat / level with front ring	Solder 2.8 x 0.5 mm	82-5251.0236	1	1	0.021 kg
Dot with yellow LED	6 VAC/DC	15 mA	flush	flat / level with front ring	Solder 2.8 x 0.5 mm	82-5251.0242	1	1	0.021 kg
	12 VAC/DC	14 mA	flush	flat / level with front ring	Solder 2.8 x 0.5 mm	82-5251.0243	1	1	0.021 kg
	24 VAC/DC	10 mA	flush	flat / level with front ring	Solder 2.8 x 0.5 mm	82-5251.0244	1	1	0.021 kg
Dot with white LED	6 VAC/DC	15 mA	flush	flat / level with front ring	Solder 2.8 x 0.5 mm	82-5251.0252	1	1	0.021 kg
	12 VAC/DC	14 mA	flush	flat / level with front ring	Solder 2.8 x 0.5 mm	82-5251.0253	1	1	0.021 kg
	24 VAC/DC	10 mA	flush	flat / level with front ring	Solder 2.8 x 0.5 mm	82-5251.0254	1	1	0.021 kg
	110 VAC	2 mA	flush	flat / level with front ring	Solder 2.8 x 0.5 mm	82-5251.0255	1	1	0.021 kg
	230 VAC	1.3 mA	flush	flat / level with front ring	Solder 2.8 x 0.5 mm	82-5251.0256	1	1	0.021 kg

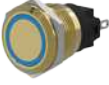
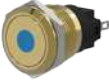
illumination	Operating voltage	Operating current	Front ring shape	Lens	Terminal	Part No.	Component layout	Wiring diagram	Weight
 <p>Indicator 19 mm Messing, Front dimension Ø 22 mm</p>									
Ring with red LED	6 VAC/DC	15 mA	flush	flat / level with front ring	Solder 2.8 x 0.5 mm	82-5351.0112	1	1	0.018 kg
	12 VAC/DC	14 mA	flush	flat / level with front ring	Solder 2.8 x 0.5 mm	82-5351.0113	1	1	0.018 kg
	24 VAC/DC	10 mA	flush	flat / level with front ring	Solder 2.8 x 0.5 mm	82-5351.0114	1	1	0.018 kg
	110 VAC	2 mA	flush	flat / level with front ring	Solder 2.8 x 0.5 mm	82-5351.0115	1	1	0.018 kg
	230 VAC	1.3 mA	flush	flat / level with front ring	Solder 2.8 x 0.5 mm	82-5351.0116	1	1	0.018 kg
Ring with blue LED	6 VAC/DC	15 mA	flush	flat / level with front ring	Solder 2.8 x 0.5 mm	82-5351.0122	1	1	0.018 kg
	12 VAC/DC	14 mA	flush	flat / level with front ring	Solder 2.8 x 0.5 mm	82-5351.0123	1	1	0.018 kg
	24 VAC/DC	10 mA	flush	flat / level with front ring	Solder 2.8 x 0.5 mm	82-5351.0124	1	1	0.018 kg
	110 VAC	2 mA	flush	flat / level with front ring	Solder 2.8 x 0.5 mm	82-5351.0125	1	1	0.018 kg
	230 VAC	1.3 mA	flush	flat / level with front ring	Solder 2.8 x 0.5 mm	82-5351.0126	1	1	0.018 kg
Ring with green LED	6 VAC/DC	15 mA	flush	flat / level with front ring	Solder 2.8 x 0.5 mm	82-5351.0132	1	1	0.018 kg
	12 VAC/DC	14 mA	flush	flat / level with front ring	Solder 2.8 x 0.5 mm	82-5351.0133	1	1	0.018 kg
	24 VAC/DC	10 mA	flush	flat / level with front ring	Solder 2.8 x 0.5 mm	82-5351.0134	1	1	0.018 kg
	110 VAC	2 mA	flush	flat / level with front ring	Solder 2.8 x 0.5 mm	82-5351.0135	1	1	0.018 kg
	230 VAC	1.3 mA	flush	flat / level with front ring	Solder 2.8 x 0.5 mm	82-5351.0136	1	1	0.018 kg
Ring with yellow LED	6 VAC/DC	15 mA	flush	flat / level with front ring	Solder 2.8 x 0.5 mm	82-5351.0142	1	1	0.018 kg
	12 VAC/DC	14 mA	flush	flat / level with front ring	Solder 2.8 x 0.5 mm	82-5351.0143	1	1	0.018 kg
	24 VAC/DC	10 mA	flush	flat / level with front ring	Solder 2.8 x 0.5 mm	82-5351.0144	1	1	0.018 kg
Ring with white LED	6 VAC/DC	15 mA	flush	flat / level with front ring	Solder 2.8 x 0.5 mm	82-5351.0152	1	1	0.018 kg
	12 VAC/DC	14 mA	flush	flat / level with front ring	Solder 2.8 x 0.5 mm	82-5351.0153	1	1	0.018 kg
	24 VAC/DC	10 mA	flush	flat / level with front ring	Solder 2.8 x 0.5 mm	82-5351.0154	1	1	0.018 kg
	110 VAC	2 mA	flush	flat / level with front ring	Solder 2.8 x 0.5 mm	82-5351.0155	1	1	0.018 kg
	230 VAC	1.3 mA	flush	flat / level with front ring	Solder 2.8 x 0.5 mm	82-5351.0156	1	1	0.018 kg
 <p>Indicator 19 mm Messing, Front dimension Ø 22 mm</p>									
Dot with red LED	6 VAC/DC	15 mA	flush	flat / level with front ring	Solder 2.8 x 0.5 mm	82-5351.0212	1	1	0.021 kg
	12 VAC/DC	14 mA	flush	flat / level with front ring	Solder 2.8 x 0.5 mm	82-5351.0213	1	1	0.021 kg
	24 VAC/DC	10 mA	flush	flat / level with front ring	Solder 2.8 x 0.5 mm	82-5351.0214	1	1	0.021 kg
	110 VAC	2 mA	flush	flat / level with front ring	Solder 2.8 x 0.5 mm	82-5351.0215	1	1	0.021 kg
	230 VAC	1.3 mA	flush	flat / level with front ring	Solder 2.8 x 0.5 mm	82-5351.0216	1	1	0.021 kg
Dot with blue LED	6 VAC/DC	15 mA	flush	flat / level with front ring	Solder 2.8 x 0.5 mm	82-5351.0222	1	1	0.021 kg
	12 VAC/DC	14 mA	flush	flat / level with front ring	Solder 2.8 x 0.5 mm	82-5351.0223	1	1	0.021 kg
	24 VAC/DC	10 mA	flush	flat / level with front ring	Solder 2.8 x 0.5 mm	82-5351.0224	1	1	0.021 kg
	110 VAC	2 mA	flush	flat / level with front ring	Solder 2.8 x 0.5 mm	82-5351.0225	1	1	0.021 kg
	230 VAC	1.3 mA	flush	flat / level with front ring	Solder 2.8 x 0.5 mm	82-5351.0226	1	1	0.021 kg
Dot with green LED	6 VAC/DC	15 mA	flush	flat / level with front ring	Solder 2.8 x 0.5 mm	82-5351.0232	1	1	0.021 kg
	12 VAC/DC	14 mA	flush	flat / level with front ring	Solder 2.8 x 0.5 mm	82-5351.0233	1	1	0.021 kg
	24 VAC/DC	10 mA	flush	flat / level with front ring	Solder 2.8 x 0.5 mm	82-5351.0234	1	1	0.021 kg
	110 VAC	2 mA	flush	flat / level with front ring	Solder 2.8 x 0.5 mm	82-5351.0235	1	1	0.021 kg
	230 VAC	1.3 mA	flush	flat / level with front ring	Solder 2.8 x 0.5 mm	82-5351.0236	1	1	0.021 kg
Dot with yellow LED	6 VAC/DC	15 mA	flush	flat / level with front ring	Solder 2.8 x 0.5 mm	82-5351.0242	1	1	0.021 kg
	12 VAC/DC	14 mA	flush	flat / level with front ring	Solder 2.8 x 0.5 mm	82-5351.0243	1	1	0.021 kg
	24 VAC/DC	10 mA	flush	flat / level with front ring	Solder 2.8 x 0.5 mm	82-5351.0244	1	1	0.021 kg

82 Flush design

Illumination	Operating voltage	Operating current	Front ring shape	Lens	Terminal	Part No.	Component layout	Wiring diagram	Weight
Dot with white LED	6 VAC/DC	15 mA	flush	flat / level with front ring	Solder 2.8 x 0.5 mm	82-5351.0252	1	1	0.021 kg
	12 VAC/DC	14 mA	flush	flat / level with front ring	Solder 2.8 x 0.5 mm	82-5351.0253	1	1	0.021 kg
	24 VAC/DC	10 mA	flush	flat / level with front ring	Solder 2.8 x 0.5 mm	82-5351.0254	1	1	0.021 kg
	110 VAC	2 mA	flush	flat / level with front ring	Solder 2.8 x 0.5 mm	82-5351.0255	1	1	0.021 kg
	230 VAC	1.3 mA	flush	flat / level with front ring	Solder 2.8 x 0.5 mm	82-5351.0256	1	1	0.021 kg



Indicator 19 mm Aluminium, Front dimension Ø 22 mm

Ring with red LED	6 VAC/DC	15 mA	flush	flat / level with front ring	Solder 2.8 x 0.5 mm	82-5551.0112	1	1	0.018 kg
	12 VAC/DC	14 mA	flush	flat / level with front ring	Solder 2.8 x 0.5 mm	82-5551.0113	1	1	0.018 kg
	24 VAC/DC	10 mA	flush	flat / level with front ring	Solder 2.8 x 0.5 mm	82-5551.0114	1	1	0.018 kg
	110 VAC	2 mA	flush	flat / level with front ring	Solder 2.8 x 0.5 mm	82-5551.0115	1	1	0.018 kg
	230 VAC	1.3 mA	flush	flat / level with front ring	Solder 2.8 x 0.5 mm	82-5551.0116	1	1	0.018 kg
Ring with blue LED	6 VAC/DC	15 mA	flush	flat / level with front ring	Solder 2.8 x 0.5 mm	82-5551.0122	1	1	0.018 kg
	12 VAC/DC	14 mA	flush	flat / level with front ring	Solder 2.8 x 0.5 mm	82-5551.0123	1	1	0.018 kg
	24 VAC/DC	10 mA	flush	flat / level with front ring	Solder 2.8 x 0.5 mm	82-5551.0124	1	1	0.018 kg
	110 VAC	2 mA	flush	flat / level with front ring	Solder 2.8 x 0.5 mm	82-5551.0125	1	1	0.018 kg
	230 VAC	1.3 mA	flush	flat / level with front ring	Solder 2.8 x 0.5 mm	82-5551.0126	1	1	0.018 kg
Ring with green LED	6 VAC/DC	15 mA	flush	flat / level with front ring	Solder 2.8 x 0.5 mm	82-5551.0132	1	1	0.018 kg
	12 VAC/DC	14 mA	flush	flat / level with front ring	Solder 2.8 x 0.5 mm	82-5551.0133	1	1	0.018 kg
	24 VAC/DC	10 mA	flush	flat / level with front ring	Solder 2.8 x 0.5 mm	82-5551.0134	1	1	0.018 kg
	110 VAC	2 mA	flush	flat / level with front ring	Solder 2.8 x 0.5 mm	82-5551.0135	1	1	0.018 kg
	230 VAC	1.3 mA	flush	flat / level with front ring	Solder 2.8 x 0.5 mm	82-5551.0136	1	1	0.018 kg
Ring with yellow LED	6 VAC/DC	15 mA	flush	flat / level with front ring	Solder 2.8 x 0.5 mm	82-5551.0142	1	1	0.018 kg
	12 VAC/DC	14 mA	flush	flat / level with front ring	Solder 2.8 x 0.5 mm	82-5551.0143	1	1	0.018 kg
	24 VAC/DC	10 mA	flush	flat / level with front ring	Solder 2.8 x 0.5 mm	82-5551.0144	1	1	0.018 kg
Ring with white LED	6 VAC/DC	15 mA	flush	flat / level with front ring	Solder 2.8 x 0.5 mm	82-5551.0152	1	1	0.018 kg
	12 VAC/DC	14 mA	flush	flat / level with front ring	Solder 2.8 x 0.5 mm	82-5551.0153	1	1	0.018 kg
	24 VAC/DC	10 mA	flush	flat / level with front ring	Solder 2.8 x 0.5 mm	82-5551.0154	1	1	0.018 kg
	110 VAC	2 mA	flush	flat / level with front ring	Solder 2.8 x 0.5 mm	82-5551.0155	1	1	0.018 kg
	230 VAC	1.3 mA	flush	flat / level with front ring	Solder 2.8 x 0.5 mm	82-5551.0156	1	1	0.018 kg



Indicator 19 mm Aluminium, Front dimension Ø 22 mm

Dot with red LED	6 VAC/DC	15 mA	flush	flat / level with front ring	Solder 2.8 x 0.5 mm	82-5551.0212	1	1	0.021 kg
	12 VAC/DC	14 mA	flush	flat / level with front ring	Solder 2.8 x 0.5 mm	82-5551.0213	1	1	0.021 kg
	24 VAC/DC	10 mA	flush	flat / level with front ring	Solder 2.8 x 0.5 mm	82-5551.0214	1	1	0.021 kg
	110 VAC	2 mA	flush	flat / level with front ring	Solder 2.8 x 0.5 mm	82-5551.0215	1	1	0.021 kg
	230 VAC	1.3 mA	flush	flat / level with front ring	Solder 2.8 x 0.5 mm	82-5551.0216	1	1	0.021 kg
Dot with blue LED	6 VAC/DC	15 mA	flush	flat / level with front ring	Solder 2.8 x 0.5 mm	82-5551.0222	1	1	0.021 kg
	12 VAC/DC	14 mA	flush	flat / level with front ring	Solder 2.8 x 0.5 mm	82-5551.0223	1	1	0.021 kg
	24 VAC/DC	10 mA	flush	flat / level with front ring	Solder 2.8 x 0.5 mm	82-5551.0224	1	1	0.021 kg
	110 VAC	2 mA	flush	flat / level with front ring	Solder 2.8 x 0.5 mm	82-5551.0225	1	1	0.021 kg
	230 VAC	1.3 mA	flush	flat / level with front ring	Solder 2.8 x 0.5 mm	82-5551.0226	1	1	0.021 kg
Dot with green LED	6 VAC/DC	15 mA	flush	flat / level with front ring	Solder 2.8 x 0.5 mm	82-5551.0232	1	1	0.021 kg
	12 VAC/DC	14 mA	flush	flat / level with front ring	Solder 2.8 x 0.5 mm	82-5551.0233	1	1	0.021 kg
	24 VAC/DC	10 mA	flush	flat / level with front ring	Solder 2.8 x 0.5 mm	82-5551.0234	1	1	0.021 kg
	110 VAC	2 mA	flush	flat / level with front ring	Solder 2.8 x 0.5 mm	82-5551.0235	1	1	0.021 kg
	230 VAC	1.3 mA	flush	flat / level with front ring	Solder 2.8 x 0.5 mm	82-5551.0236	1	1	0.021 kg

Illumination	Operating voltage	Operating current	Front ring shape	Lens	Terminal	Part No.	Component layout	Wiring diagram	Weight
Dot with yellow LED	6 VAC/DC	15 mA	flush	flat / level with front ring	Solder 2.8 x 0.5 mm	82-5551.0242	1	1	0.021 kg
	12 VAC/DC	14 mA	flush	flat / level with front ring	Solder 2.8 x 0.5 mm	82-5551.0243	1	1	0.021 kg
	24 VAC/DC	10 mA	flush	flat / level with front ring	Solder 2.8 x 0.5 mm	82-5551.0244	1	1	0.021 kg
Dot with white LED	6 VAC/DC	15 mA	flush	flat / level with front ring	Solder 2.8 x 0.5 mm	82-5551.0252	1	1	0.021 kg
	12 VAC/DC	14 mA	flush	flat / level with front ring	Solder 2.8 x 0.5 mm	82-5551.0253	1	1	0.021 kg
	24 VAC/DC	10 mA	flush	flat / level with front ring	Solder 2.8 x 0.5 mm	82-5551.0254	1	1	0.021 kg
	110 VAC	2 mA	flush	flat / level with front ring	Solder 2.8 x 0.5 mm	82-5551.0255	1	1	0.021 kg
	230 VAC	1.3 mA	flush	flat / level with front ring	Solder 2.8 x 0.5 mm	82-5551.0256	1	1	0.021 kg



Indicator 19 mm Stainless-steel, Front dimension Ø 22 mm

Ring with red LED	6 VAC/DC	15 mA	flush	flat / level with front ring	Screw	82-5152.0112	4	1	0.018 kg
	12 VAC/DC	14 mA	flush	flat / level with front ring	Screw	82-5152.0113	4	1	0.018 kg
	24 VAC/DC	10 mA	flush	flat / level with front ring	Screw	82-5152.0114	4	1	0.018 kg
	110 VAC	2 mA	flush	flat / level with front ring	Screw	82-5152.0115	4	1	0.018 kg
	230 VAC	1.3 mA	flush	flat / level with front ring	Screw	82-5152.0116	4	1	0.018 kg
Ring with blue LED	6 VAC/DC	15 mA	flush	flat / level with front ring	Screw	82-5152.0122	4	1	0.018 kg
	12 VAC/DC	14 mA	flush	flat / level with front ring	Screw	82-5152.0123	4	1	0.018 kg
	24 VAC/DC	10 mA	flush	flat / level with front ring	Screw	82-5152.0124	4	1	0.018 kg
	110 VAC	2 mA	flush	flat / level with front ring	Screw	82-5152.0125	4	1	0.018 kg
	230 VAC	1.3 mA	flush	flat / level with front ring	Screw	82-5152.0126	4	1	0.018 kg
Ring with green LED	6 VAC/DC	15 mA	flush	flat / level with front ring	Screw	82-5152.0132	4	1	0.018 kg
	12 VAC/DC	14 mA	flush	flat / level with front ring	Screw	82-5152.0133	4	1	0.018 kg
	24 VAC/DC	10 mA	flush	flat / level with front ring	Screw	82-5152.0134	4	1	0.018 kg
	110 VAC	2 mA	flush	flat / level with front ring	Screw	82-5152.0135	4	1	0.018 kg
	230 VAC	1.3 mA	flush	flat / level with front ring	Screw	82-5152.0136	4	1	0.018 kg
Ring with yellow LED	6 VAC/DC	15 mA	flush	flat / level with front ring	Screw	82-5152.0142	4	1	0.018 kg
	12 VAC/DC	14 mA	flush	flat / level with front ring	Screw	82-5152.0143	4	1	0.018 kg
	24 VAC/DC	10 mA	flush	flat / level with front ring	Screw	82-5152.0144	4	1	0.018 kg
Ring with white LED	6 VAC/DC	15 mA	flush	flat / level with front ring	Screw	82-5152.0152	4	1	0.018 kg
	12 VAC/DC	14 mA	flush	flat / level with front ring	Screw	82-5152.0153	4	1	0.018 kg
	24 VAC/DC	10 mA	flush	flat / level with front ring	Screw	82-5152.0154	4	1	0.018 kg
	110 VAC	2 mA	flush	flat / level with front ring	Screw	82-5152.0155	4	1	0.018 kg
	230 VAC	1.3 mA	flush	flat / level with front ring	Screw	82-5152.0156	4	1	0.018 kg



Indicator 19 mm Stainless-steel, Front dimension Ø 22 mm

Dot with red LED	6 VAC/DC	15 mA	flush	flat / level with front ring	Screw	82-5152.0212	4	1	0.021 kg
	12 VAC/DC	14 mA	flush	flat / level with front ring	Screw	82-5152.0213	4	1	0.021 kg
	24 VAC/DC	10 mA	flush	flat / level with front ring	Screw	82-5152.0214	4	1	0.021 kg
	110 VAC	2 mA	flush	flat / level with front ring	Screw	82-5152.0215	4	1	0.021 kg
	230 VAC	1.3 mA	flush	flat / level with front ring	Screw	82-5152.0216	4	1	0.021 kg
Dot with blue LED	6 VAC/DC	15 mA	flush	flat / level with front ring	Screw	82-5152.0222	4	1	0.021 kg
	12 VAC/DC	14 mA	flush	flat / level with front ring	Screw	82-5152.0223	4	1	0.021 kg
	24 VAC/DC	10 mA	flush	flat / level with front ring	Screw	82-5152.0224	4	1	0.021 kg
	110 VAC	2 mA	flush	flat / level with front ring	Screw	82-5152.0225	4	1	0.021 kg
	230 VAC	1.3 mA	flush	flat / level with front ring	Screw	82-5152.0226	4	1	0.021 kg

82 Flush design

Illumination	Operating voltage	Operating current	Front ring shape	Lens	Terminal	Part No.	Component layout	Wiring diagram	Weight
Dot with green LED	6 VAC/DC	15 mA	flush	flat / level with front ring	Screw	82-5152.0232	4	1	0.021 kg
	12 VAC/DC	14 mA	flush	flat / level with front ring	Screw	82-5152.0233	4	1	0.021 kg
	24 VAC/DC	10 mA	flush	flat / level with front ring	Screw	82-5152.0234	4	1	0.021 kg
	110 VAC	2 mA	flush	flat / level with front ring	Screw	82-5152.0235	4	1	0.021 kg
	230 VAC	1.3 mA	flush	flat / level with front ring	Screw	82-5152.0236	4	1	0.021 kg
Dot with yellow LED	6 VAC/DC	15 mA	flush	flat / level with front ring	Screw	82-5152.0242	4	1	0.021 kg
	12 VAC/DC	14 mA	flush	flat / level with front ring	Screw	82-5152.0243	4	1	0.021 kg
	24 VAC/DC	10 mA	flush	flat / level with front ring	Screw	82-5152.0244	4	1	0.021 kg
Dot with white LED	6 VAC/DC	15 mA	flush	flat / level with front ring	Screw	82-5152.0252	4	1	0.021 kg
	12 VAC/DC	14 mA	flush	flat / level with front ring	Screw	82-5152.0253	4	1	0.021 kg
	24 VAC/DC	10 mA	flush	flat / level with front ring	Screw	82-5152.0254	4	1	0.021 kg
	110 VAC	2 mA	flush	flat / level with front ring	Screw	82-5152.0255	4	1	0.021 kg
	230 VAC	1.3 mA	flush	flat / level with front ring	Screw	82-5152.0256	4	1	0.021 kg



Indicator 19 mm Stainless-steel chrome-colour, Front dimension Ø 22 mm

Ring with red LED	6 VAC/DC	15 mA	flush	flat / level with front ring	Screw	82-5252.0112	4	1	0.018 kg
	12 VAC/DC	14 mA	flush	flat / level with front ring	Screw	82-5252.0113	4	1	0.018 kg
	24 VAC/DC	10 mA	flush	flat / level with front ring	Screw	82-5252.0114	4	1	0.018 kg
	110 VAC	2 mA	flush	flat / level with front ring	Screw	82-5252.0115	4	1	0.018 kg
	230 VAC	1.3 mA	flush	flat / level with front ring	Screw	82-5252.0116	4	1	0.018 kg
Ring with blue LED	6 VAC/DC	15 mA	flush	flat / level with front ring	Screw	82-5252.0122	4	1	0.018 kg
	12 VAC/DC	14 mA	flush	flat / level with front ring	Screw	82-5252.0123	4	1	0.018 kg
	24 VAC/DC	10 mA	flush	flat / level with front ring	Screw	82-5252.0124	4	1	0.018 kg
	110 VAC	2 mA	flush	flat / level with front ring	Screw	82-5252.0125	4	1	0.018 kg
	230 VAC	1.3 mA	flush	flat / level with front ring	Screw	82-5252.0126	4	1	0.018 kg
Ring with green LED	6 VAC/DC	15 mA	flush	flat / level with front ring	Screw	82-5252.0132	4	1	0.018 kg
	12 VAC/DC	14 mA	flush	flat / level with front ring	Screw	82-5252.0133	4	1	0.018 kg
	24 VAC/DC	10 mA	flush	flat / level with front ring	Screw	82-5252.0134	4	1	0.018 kg
	110 VAC	2 mA	flush	flat / level with front ring	Screw	82-5252.0135	4	1	0.018 kg
	230 VAC	1.3 mA	flush	flat / level with front ring	Screw	82-5252.0136	4	1	0.018 kg
Ring with yellow LED	6 VAC/DC	15 mA	flush	flat / level with front ring	Screw	82-5252.0142	4	1	0.018 kg
	12 VAC/DC	14 mA	flush	flat / level with front ring	Screw	82-5252.0143	4	1	0.018 kg
	24 VAC/DC	10 mA	flush	flat / level with front ring	Screw	82-5252.0144	4	1	0.018 kg
Ring with white LED	6 VAC/DC	15 mA	flush	flat / level with front ring	Screw	82-5252.0152	4	1	0.018 kg
	12 VAC/DC	14 mA	flush	flat / level with front ring	Screw	82-5252.0153	4	1	0.018 kg
	24 VAC/DC	10 mA	flush	flat / level with front ring	Screw	82-5252.0154	4	1	0.018 kg
	110 VAC	2 mA	flush	flat / level with front ring	Screw	82-5252.0155	4	1	0.018 kg
	230 VAC	1.3 mA	flush	flat / level with front ring	Screw	82-5252.0156	4	1	0.018 kg

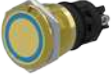
illumination	Operating voltage	Operating current	Front ring shape	Lens	Terminal	Part No.	Component layout	Wiring diagram	Weight
 <p>Indicator 19 mm Stainless-steel chrome-coloured, Front dimension Ø 22 mm</p>									
Dot with red LED	6 VAC/DC	15 mA	flush	flat / level with front ring	Screw	82-5252.0212	4	1	0.021 kg
	12 VAC/DC	14 mA	flush	flat / level with front ring	Screw	82-5252.0213	4	1	0.021 kg
	24 VAC/DC	10 mA	flush	flat / level with front ring	Screw	82-5252.0214	4	1	0.021 kg
	110 VAC	2 mA	flush	flat / level with front ring	Screw	82-5252.0215	4	1	0.021 kg
	230 VAC	1.3 mA	flush	flat / level with front ring	Screw	82-5252.0216	4	1	0.021 kg
Dot with blue LED	6 VAC/DC	15 mA	flush	flat / level with front ring	Screw	82-5252.0222	4	1	0.021 kg
	12 VAC/DC	14 mA	flush	flat / level with front ring	Screw	82-5252.0223	4	1	0.021 kg
	24 VAC/DC	10 mA	flush	flat / level with front ring	Screw	82-5252.0224	4	1	0.021 kg
	110 VAC	2 mA	flush	flat / level with front ring	Screw	82-5252.0225	4	1	0.021 kg
	230 VAC	1.3 mA	flush	flat / level with front ring	Screw	82-5252.0226	4	1	0.021 kg
Dot with green LED	6 VAC/DC	15 mA	flush	flat / level with front ring	Screw	82-5252.0232	4	1	0.021 kg
	12 VAC/DC	14 mA	flush	flat / level with front ring	Screw	82-5252.0233	4	1	0.021 kg
	24 VAC/DC	10 mA	flush	flat / level with front ring	Screw	82-5252.0234	4	1	0.021 kg
	110 VAC	2 mA	flush	flat / level with front ring	Screw	82-5252.0235	4	1	0.021 kg
	230 VAC	1.3 mA	flush	flat / level with front ring	Screw	82-5252.0236	4	1	0.021 kg
Dot with yellow LED	6 VAC/DC	15 mA	flush	flat / level with front ring	Screw	82-5252.0242	4	1	0.021 kg
	12 VAC/DC	14 mA	flush	flat / level with front ring	Screw	82-5252.0243	4	1	0.021 kg
	24 VAC/DC	10 mA	flush	flat / level with front ring	Screw	82-5252.0244	4	1	0.021 kg
Dot with white LED	6 VAC/DC	15 mA	flush	flat / level with front ring	Screw	82-5252.0252	4	1	0.021 kg
	12 VAC/DC	14 mA	flush	flat / level with front ring	Screw	82-5252.0253	4	1	0.021 kg
	24 VAC/DC	10 mA	flush	flat / level with front ring	Screw	82-5252.0254	4	1	0.021 kg
	110 VAC	2 mA	flush	flat / level with front ring	Screw	82-5252.0255	4	1	0.021 kg
	230 VAC	1.3 mA	flush	flat / level with front ring	Screw	82-5252.0256	4	1	0.021 kg
 <p>Indicator 19 mm Messing, Front dimension Ø 22 mm</p>									
Ring with red LED	6 VAC/DC	15 mA	flush	flat / level with front ring	Screw	82-5352.0112	4	1	0.018 kg
	12 VAC/DC	14 mA	flush	flat / level with front ring	Screw	82-5352.0113	4	1	0.018 kg
	24 VAC/DC	10 mA	flush	flat / level with front ring	Screw	82-5352.0114	4	1	0.018 kg
	110 VAC	2 mA	flush	flat / level with front ring	Screw	82-5352.0115	4	1	0.018 kg
	230 VAC	1.3 mA	flush	flat / level with front ring	Screw	82-5352.0116	4	1	0.018 kg
Ring with blue LED	6 VAC/DC	15 mA	flush	flat / level with front ring	Screw	82-5352.0122	4	1	0.018 kg
	12 VAC/DC	14 mA	flush	flat / level with front ring	Screw	82-5352.0123	4	1	0.018 kg
	24 VAC/DC	10 mA	flush	flat / level with front ring	Screw	82-5352.0124	4	1	0.018 kg
	110 VAC	2 mA	flush	flat / level with front ring	Screw	82-5352.0125	4	1	0.018 kg
	230 VAC	1.3 mA	flush	flat / level with front ring	Screw	82-5352.0126	4	1	0.018 kg
Ring with green LED	6 VAC/DC	15 mA	flush	flat / level with front ring	Screw	82-5352.0132	4	1	0.018 kg
	12 VAC/DC	14 mA	flush	flat / level with front ring	Screw	82-5352.0133	4	1	0.018 kg
	24 VAC/DC	10 mA	flush	flat / level with front ring	Screw	82-5352.0134	4	1	0.018 kg
	110 VAC	2 mA	flush	flat / level with front ring	Screw	82-5352.0135	4	1	0.018 kg
	230 VAC	1.3 mA	flush	flat / level with front ring	Screw	82-5352.0136	4	1	0.018 kg
Ring with yellow LED	6 VAC/DC	15 mA	flush	flat / level with front ring	Screw	82-5352.0142	4	1	0.018 kg
	12 VAC/DC	14 mA	flush	flat / level with front ring	Screw	82-5352.0143	4	1	0.018 kg
	24 VAC/DC	10 mA	flush	flat / level with front ring	Screw	82-5352.0144	4	1	0.018 kg

82 Flush design

Illumination	Operating voltage	Operating current	Front ring shape	Lens	Terminal	Part No.	Component layout	Wiring diagram	Weight
Ring with white LED	6 VAC/DC	15 mA	flush	flat / level with front ring	Screw	82-5352.0152	4	1	0.018 kg
	12 VAC/DC	14 mA	flush	flat / level with front ring	Screw	82-5352.0153	4	1	0.018 kg
	24 VAC/DC	10 mA	flush	flat / level with front ring	Screw	82-5352.0154	4	1	0.018 kg
	110 VAC	2 mA	flush	flat / level with front ring	Screw	82-5352.0155	4	1	0.018 kg
	230 VAC	1.3 mA	flush	flat / level with front ring	Screw	82-5352.0156	4	1	0.018 kg



Indicator 19 mm Messing, Front dimension Ø 22 mm

Dot with red LED	6 VAC/DC	15 mA	flush	flat / level with front ring	Screw	82-5352.0212	4	1	0.021 kg
	12 VAC/DC	14 mA	flush	flat / level with front ring	Screw	82-5352.0213	4	1	0.021 kg
	24 VAC/DC	10 mA	flush	flat / level with front ring	Screw	82-5352.0214	4	1	0.021 kg
	110 VAC	2 mA	flush	flat / level with front ring	Screw	82-5352.0215	4	1	0.021 kg
	230 VAC	1.3 mA	flush	flat / level with front ring	Screw	82-5352.0216	4	1	0.021 kg
Dot with blue LED	6 VAC/DC	15 mA	flush	flat / level with front ring	Screw	82-5352.0222	4	1	0.021 kg
	12 VAC/DC	14 mA	flush	flat / level with front ring	Screw	82-5352.0223	4	1	0.021 kg
	24 VAC/DC	10 mA	flush	flat / level with front ring	Screw	82-5352.0224	4	1	0.021 kg
	110 VAC	2 mA	flush	flat / level with front ring	Screw	82-5352.0225	4	1	0.021 kg
	230 VAC	1.3 mA	flush	flat / level with front ring	Screw	82-5352.0226	4	1	0.021 kg
Dot with green LED	6 VAC/DC	15 mA	flush	flat / level with front ring	Screw	82-5352.0232	4	1	0.021 kg
	12 VAC/DC	14 mA	flush	flat / level with front ring	Screw	82-5352.0233	4	1	0.021 kg
	24 VAC/DC	10 mA	flush	flat / level with front ring	Screw	82-5352.0234	4	1	0.021 kg
	110 VAC	2 mA	flush	flat / level with front ring	Screw	82-5352.0235	4	1	0.021 kg
	230 VAC	1.3 mA	flush	flat / level with front ring	Screw	82-5352.0236	4	1	0.021 kg
Dot with yellow LED	6 VAC/DC	15 mA	flush	flat / level with front ring	Screw	82-5352.0242	4	1	0.021 kg
	12 VAC/DC	14 mA	flush	flat / level with front ring	Screw	82-5352.0243	4	1	0.021 kg
	24 VAC/DC	10 mA	flush	flat / level with front ring	Screw	82-5352.0244	4	1	0.021 kg
Dot with white LED	6 VAC/DC	15 mA	flush	flat / level with front ring	Screw	82-5352.0252	4	1	0.021 kg
	12 VAC/DC	14 mA	flush	flat / level with front ring	Screw	82-5352.0253	4	1	0.021 kg
	24 VAC/DC	10 mA	flush	flat / level with front ring	Screw	82-5352.0254	4	1	0.021 kg
	110 VAC	2 mA	flush	flat / level with front ring	Screw	82-5352.0255	4	1	0.021 kg
	230 VAC	1.3 mA	flush	flat / level with front ring	Screw	82-5352.0256	4	1	0.021 kg



Indicator 19 mm Aluminium, Front dimension Ø 22 mm

Ring with red LED	6 VAC/DC	15 mA	flush	flat / level with front ring	Screw	82-5552.0112	4	1	0.018 kg
	12 VAC/DC	14 mA	flush	flat / level with front ring	Screw	82-5552.0113	4	1	0.018 kg
	24 VAC/DC	10 mA	flush	flat / level with front ring	Screw	82-5552.0114	4	1	0.018 kg
	110 VAC	2 mA	flush	flat / level with front ring	Screw	82-5552.0115	4	1	0.018 kg
	230 VAC	1.3 mA	flush	flat / level with front ring	Screw	82-5552.0116	4	1	0.018 kg
Ring with blue LED	6 VAC/DC	15 mA	flush	flat / level with front ring	Screw	82-5552.0122	4	1	0.018 kg
	12 VAC/DC	14 mA	flush	flat / level with front ring	Screw	82-5552.0123	4	1	0.018 kg
	24 VAC/DC	10 mA	flush	flat / level with front ring	Screw	82-5552.0124	4	1	0.018 kg
	110 VAC	2 mA	flush	flat / level with front ring	Screw	82-5552.0125	4	1	0.018 kg
	230 VAC	1.3 mA	flush	flat / level with front ring	Screw	82-5552.0126	4	1	0.018 kg
Ring with green LED	6 VAC/DC	15 mA	flush	flat / level with front ring	Screw	82-5552.0132	4	1	0.018 kg
	12 VAC/DC	14 mA	flush	flat / level with front ring	Screw	82-5552.0133	4	1	0.018 kg
	24 VAC/DC	10 mA	flush	flat / level with front ring	Screw	82-5552.0134	4	1	0.018 kg
	110 VAC	2 mA	flush	flat / level with front ring	Screw	82-5552.0135	4	1	0.018 kg
	230 VAC	1.3 mA	flush	flat / level with front ring	Screw	82-5552.0136	4	1	0.018 kg

Illumination	Operating voltage	Operating current	Front ring shape	Lens	Terminal	Part No.	Component layout	Wiring diagram	Weight
Ring with yellow LED	6 VAC/DC	15 mA	flush	flat / level with front ring	Screw	82-5552.0142	4	1	0.018 kg
	12 VAC/DC	14 mA	flush	flat / level with front ring	Screw	82-5552.0143	4	1	0.018 kg
	24 VAC/DC	10 mA	flush	flat / level with front ring	Screw	82-5552.0144	4	1	0.018 kg
Ring with white LED	6 VAC/DC	15 mA	flush	flat / level with front ring	Screw	82-5552.0152	4	1	0.018 kg
	12 VAC/DC	14 mA	flush	flat / level with front ring	Screw	82-5552.0153	4	1	0.018 kg
	24 VAC/DC	10 mA	flush	flat / level with front ring	Screw	82-5552.0154	4	1	0.018 kg
	110 VAC	2 mA	flush	flat / level with front ring	Screw	82-5552.0155	4	1	0.018 kg
	230 VAC	1.3 mA	flush	flat / level with front ring	Screw	82-5552.0156	4	1	0.018 kg



Indicator 19 mm Aluminium, Front dimension Ø 22 mm

Dot with red LED	6 VAC/DC	15 mA	flush	flat / level with front ring	Screw	82-5552.0212	4	1	0.021 kg
	12 VAC/DC	14 mA	flush	flat / level with front ring	Screw	82-5552.0213	4	1	0.021 kg
	24 VAC/DC	10 mA	flush	flat / level with front ring	Screw	82-5552.0214	4	1	0.021 kg
	110 VAC	2 mA	flush	flat / level with front ring	Screw	82-5552.0215	4	1	0.021 kg
	230 VAC	1.3 mA	flush	flat / level with front ring	Screw	82-5552.0216	4	1	0.021 kg
Dot with blue LED	6 VAC/DC	15 mA	flush	flat / level with front ring	Screw	82-5552.0222	4	1	0.021 kg
	12 VAC/DC	14 mA	flush	flat / level with front ring	Screw	82-5552.0223	4	1	0.021 kg
	24 VAC/DC	10 mA	flush	flat / level with front ring	Screw	82-5552.0224	4	1	0.021 kg
	110 VAC	2 mA	flush	flat / level with front ring	Screw	82-5552.0225	4	1	0.021 kg
	230 VAC	1.3 mA	flush	flat / level with front ring	Screw	82-5552.0226	4	1	0.021 kg
Dot with green LED	6 VAC/DC	15 mA	flush	flat / level with front ring	Screw	82-5552.0232	4	1	0.021 kg
	12 VAC/DC	14 mA	flush	flat / level with front ring	Screw	82-5552.0233	4	1	0.021 kg
	24 VAC/DC	10 mA	flush	flat / level with front ring	Screw	82-5552.0234	4	1	0.021 kg
	110 VAC	2 mA	flush	flat / level with front ring	Screw	82-5552.0235	4	1	0.021 kg
	230 VAC	1.3 mA	flush	flat / level with front ring	Screw	82-5552.0236	4	1	0.021 kg
Dot with yellow LED	6 VAC/DC	15 mA	flush	flat / level with front ring	Screw	82-5552.0242	4	1	0.021 kg
	12 VAC/DC	14 mA	flush	flat / level with front ring	Screw	82-5552.0243	4	1	0.021 kg
	24 VAC/DC	10 mA	flush	flat / level with front ring	Screw	82-5552.0244	4	1	0.021 kg
Dot with white LED	6 VAC/DC	15 mA	flush	flat / level with front ring	Screw	82-5552.0252	4	1	0.021 kg
	12 VAC/DC	14 mA	flush	flat / level with front ring	Screw	82-5552.0253	4	1	0.021 kg
	24 VAC/DC	10 mA	flush	flat / level with front ring	Screw	82-5552.0254	4	1	0.021 kg
	110 VAC	2 mA	flush	flat / level with front ring	Screw	82-5552.0255	4	1	0.021 kg
	230 VAC	1.3 mA	flush	flat / level with front ring	Screw	82-5552.0256	4	1	0.021 kg

The component layouts you will find from page 181

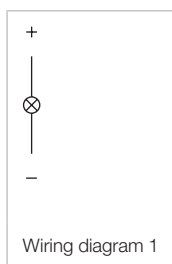

82 Flush design

Indicator 22 mm, Silver contact, IP 65 & IP 67



Product can differ from the current configuration.

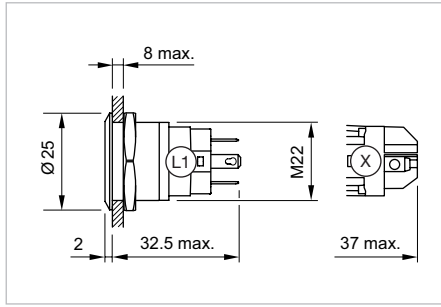

Dimensions [mm]
L1 = Solder/Plug-in terminal 2.8 x 0.5 mm,
X = Screw terminal

Equipment consisting of (schematic overview)

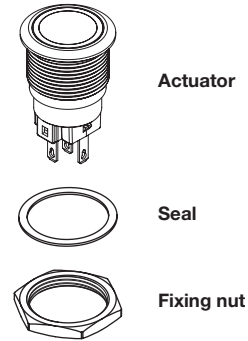

Additional Information

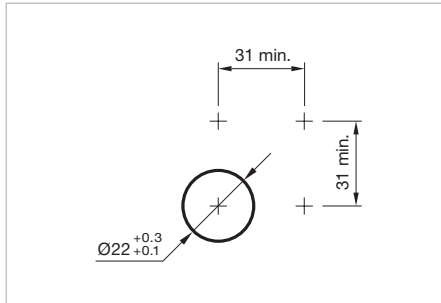

- The laser 2D-technology can mark all stainless steel versions with flush lenses – flush-mounting as well as raised versions.



Mounting cut-outs [mm]

Each Part Number listed below includes all the black components shown in the 3D-drawing.

Illumination	Operating voltage	Operating current	Front ring shape	Lens	Terminal	Part No.	Component layout	Wiring diagram	Weight
 <p>Indicator 22 mm Stainless-steel, Front dimension Ø 25 mm</p>									
Ring with red LED	6 VAC/DC	15 mA	flush	flat / level with front ring	Solder 2.8 x 0.5 mm	82-6151.0112	1	1	0.018 kg
	12 VAC/DC	14 mA	flush	flat / level with front ring	Solder 2.8 x 0.5 mm	82-6151.0113	1	1	0.018 kg
	24 VAC/DC	10 mA	flush	flat / level with front ring	Solder 2.8 x 0.5 mm	82-6151.0114	1	1	0.018 kg
	110 VAC	2 mA	flush	flat / level with front ring	Solder 2.8 x 0.5 mm	82-6151.0115	1	1	0.018 kg
	230 VAC	1.3 mA	flush	flat / level with front ring	Solder 2.8 x 0.5 mm	82-6151.0116	1	1	0.018 kg
Ring with blue LED	6 VAC/DC	15 mA	flush	flat / level with front ring	Solder 2.8 x 0.5 mm	82-6151.0122	1	1	0.018 kg
	12 VAC/DC	14 mA	flush	flat / level with front ring	Solder 2.8 x 0.5 mm	82-6151.0123	1	1	0.018 kg
	24 VAC/DC	10 mA	flush	flat / level with front ring	Solder 2.8 x 0.5 mm	82-6151.0124	1	1	0.018 kg
	110 VAC	2 mA	flush	flat / level with front ring	Solder 2.8 x 0.5 mm	82-6151.0125	1	1	0.018 kg
	230 VAC	1.3 mA	flush	flat / level with front ring	Solder 2.8 x 0.5 mm	82-6151.0126	1	1	0.018 kg
Ring with green LED	6 VAC/DC	15 mA	flush	flat / level with front ring	Solder 2.8 x 0.5 mm	82-6151.0132	1	1	0.018 kg
	12 VAC/DC	14 mA	flush	flat / level with front ring	Solder 2.8 x 0.5 mm	82-6151.0133	1	1	0.018 kg
	24 VAC/DC	10 mA	flush	flat / level with front ring	Solder 2.8 x 0.5 mm	82-6151.0134	1	1	0.018 kg
	110 VAC	2 mA	flush	flat / level with front ring	Solder 2.8 x 0.5 mm	82-6151.0135	1	1	0.018 kg
	230 VAC	1.3 mA	flush	flat / level with front ring	Solder 2.8 x 0.5 mm	82-6151.0136	1	1	0.018 kg
Ring with yellow LED	6 VAC/DC	15 mA	flush	flat / level with front ring	Solder 2.8 x 0.5 mm	82-6151.0142	1	1	0.018 kg
	12 VAC/DC	14 mA	flush	flat / level with front ring	Solder 2.8 x 0.5 mm	82-6151.0143	1	1	0.018 kg
	24 VAC/DC	10 mA	flush	flat / level with front ring	Solder 2.8 x 0.5 mm	82-6151.0144	1	1	0.018 kg

illumination	Operating voltage	Operating current	Front ring shape	Lens	Terminal	Part No.	Component layout	Wiring diagram	Weight
Ring with white LED	6 VAC/DC	15 mA	flush	flat / level with front ring	Solder 2.8 x 0.5 mm	82-6151.0152	1	1	0.018 kg
	12 VAC/DC	14 mA	flush	flat / level with front ring	Solder 2.8 x 0.5 mm	82-6151.0153	1	1	0.018 kg
	24 VAC/DC	10 mA	flush	flat / level with front ring	Solder 2.8 x 0.5 mm	82-6151.0154	1	1	0.018 kg
	110 VAC	2 mA	flush	flat / level with front ring	Solder 2.8 x 0.5 mm	82-6151.0155	1	1	0.018 kg
	230 VAC	1.3 mA	flush	flat / level with front ring	Solder 2.8 x 0.5 mm	82-6151.0156	1	1	0.018 kg
 <p>Indicator 22 mm Stainless-steel, Front dimension Ø 25 mm</p>									
Dot with red LED	6 VAC/DC	15 mA	flush	flat / level with front ring	Solder 2.8 x 0.5 mm	82-6151.0212	1	1	0.021 kg
	12 VAC/DC	14 mA	flush	flat / level with front ring	Solder 2.8 x 0.5 mm	82-6151.0213	1	1	0.021 kg
	24 VAC/DC	10 mA	flush	flat / level with front ring	Solder 2.8 x 0.5 mm	82-6151.0214	1	1	0.021 kg
	110 VAC	2 mA	flush	flat / level with front ring	Solder 2.8 x 0.5 mm	82-6151.0215	1	1	0.021 kg
	230 VAC	1.3 mA	flush	flat / level with front ring	Solder 2.8 x 0.5 mm	82-6151.0216	1	1	0.021 kg
Dot with blue LED	6 VAC/DC	15 mA	flush	flat / level with front ring	Solder 2.8 x 0.5 mm	82-6151.0222	1	1	0.021 kg
	12 VAC/DC	14 mA	flush	flat / level with front ring	Solder 2.8 x 0.5 mm	82-6151.0223	1	1	0.021 kg
	24 VAC/DC	10 mA	flush	flat / level with front ring	Solder 2.8 x 0.5 mm	82-6151.0224	1	1	0.021 kg
	110 VAC	2 mA	flush	flat / level with front ring	Solder 2.8 x 0.5 mm	82-6151.0225	1	1	0.021 kg
	230 VAC	1.3 mA	flush	flat / level with front ring	Solder 2.8 x 0.5 mm	82-6151.0226	1	1	0.021 kg
Dot with green LED	6 VAC/DC	15 mA	flush	flat / level with front ring	Solder 2.8 x 0.5 mm	82-6151.0232	1	1	0.021 kg
	12 VAC/DC	14 mA	flush	flat / level with front ring	Solder 2.8 x 0.5 mm	82-6151.0233	1	1	0.021 kg
	24 VAC/DC	10 mA	flush	flat / level with front ring	Solder 2.8 x 0.5 mm	82-6151.0234	1	1	0.021 kg
	110 VAC	2 mA	flush	flat / level with front ring	Solder 2.8 x 0.5 mm	82-6151.0235	1	1	0.021 kg
	230 VAC	1.3 mA	flush	flat / level with front ring	Solder 2.8 x 0.5 mm	82-6151.0236	1	1	0.021 kg
Dot with yellow LED	6 VAC/DC	15 mA	flush	flat / level with front ring	Solder 2.8 x 0.5 mm	82-6151.0242	1	1	0.021 kg
	12 VAC/DC	14 mA	flush	flat / level with front ring	Solder 2.8 x 0.5 mm	82-6151.0243	1	1	0.021 kg
	24 VAC/DC	10 mA	flush	flat / level with front ring	Solder 2.8 x 0.5 mm	82-6151.0244	1	1	0.021 kg
Dot with white LED	6 VAC/DC	15 mA	flush	flat / level with front ring	Solder 2.8 x 0.5 mm	82-6151.0252	1	1	0.021 kg
	12 VAC/DC	14 mA	flush	flat / level with front ring	Solder 2.8 x 0.5 mm	82-6151.0253	1	1	0.021 kg
	24 VAC/DC	10 mA	flush	flat / level with front ring	Solder 2.8 x 0.5 mm	82-6151.0254	1	1	0.021 kg
	110 VAC	2 mA	flush	flat / level with front ring	Solder 2.8 x 0.5 mm	82-6151.0255	1	1	0.021 kg
	230 VAC	1.3 mA	flush	flat / level with front ring	Solder 2.8 x 0.5 mm	82-6151.0256	1	1	0.021 kg
 <p>Indicator 22 mm Stainless-steel chrome-colour, Front dimension Ø 25 mm</p>									
Ring with red LED	6 VAC/DC	15 mA	flush	flat / level with front ring	Solder 2.8 x 0.5 mm	82-6251.0112	1	1	0.018 kg
	12 VAC/DC	14 mA	flush	flat / level with front ring	Solder 2.8 x 0.5 mm	82-6251.0113	1	1	0.018 kg
	24 VAC/DC	10 mA	flush	flat / level with front ring	Solder 2.8 x 0.5 mm	82-6251.0114	1	1	0.018 kg
	110 VAC	2 mA	flush	flat / level with front ring	Solder 2.8 x 0.5 mm	82-6251.0115	1	1	0.018 kg
	230 VAC	1.3 mA	flush	flat / level with front ring	Solder 2.8 x 0.5 mm	82-6251.0116	1	1	0.018 kg
Ring with blue LED	6 VAC/DC	15 mA	flush	flat / level with front ring	Solder 2.8 x 0.5 mm	82-6251.0122	1	1	0.018 kg
	12 VAC/DC	14 mA	flush	flat / level with front ring	Solder 2.8 x 0.5 mm	82-6251.0123	1	1	0.018 kg
	24 VAC/DC	10 mA	flush	flat / level with front ring	Solder 2.8 x 0.5 mm	82-6251.0124	1	1	0.018 kg
	110 VAC	2 mA	flush	flat / level with front ring	Solder 2.8 x 0.5 mm	82-6251.0125	1	1	0.018 kg
	230 VAC	1.3 mA	flush	flat / level with front ring	Solder 2.8 x 0.5 mm	82-6251.0126	1	1	0.018 kg
Ring with green LED	6 VAC/DC	15 mA	flush	flat / level with front ring	Solder 2.8 x 0.5 mm	82-6251.0132	1	1	0.018 kg
	12 VAC/DC	14 mA	flush	flat / level with front ring	Solder 2.8 x 0.5 mm	82-6251.0133	1	1	0.018 kg
	24 VAC/DC	10 mA	flush	flat / level with front ring	Solder 2.8 x 0.5 mm	82-6251.0134	1	1	0.018 kg
	110 VAC	2 mA	flush	flat / level with front ring	Solder 2.8 x 0.5 mm	82-6251.0135	1	1	0.018 kg
	230 VAC	1.3 mA	flush	flat / level with front ring	Solder 2.8 x 0.5 mm	82-6251.0136	1	1	0.018 kg