



Chipsmall Limited consists of a professional team with an average of over 10 year of expertise in the distribution of electronic components. Based in Hongkong, we have already established firm and mutual-benefit business relationships with customers from,Europe,America and south Asia,supplying obsolete and hard-to-find components to meet their specific needs.

With the principle of “Quality Parts,Customers Priority,Honest Operation,and Considerate Service”,our business mainly focus on the distribution of electronic components. Line cards we deal with include Microchip,ALPS,ROHM,Xilinx,Pulse,ON,Everlight and Freescale. Main products comprise IC,Modules,Potentiometer,IC Socket,Relay,Connector.Our parts cover such applications as commercial,industrial, and automotives areas.

We are looking forward to setting up business relationship with you and hope to provide you with the best service and solution. Let us make a better world for our industry!



Contact us

Tel: +86-755-8981 8866 Fax: +86-755-8427 6832

Email & Skype: info@chipsmall.com Web: www.chipsmall.com

Address: A1208, Overseas Decoration Building, #122 Zhenhua RD., Futian, Shenzhen, China



PIN RECEPTACLES

**FOR .008" - .013" DIAMETER PINS (#04 CONTACT)
AND .012" - .017" DIAMETER PINS (#10 CONTACT)
(SEE SPECIFIC CONTACT RANGE ON PAGE 250)**

8210

8210-0-15-15-04-27-04-0

Press-fit in .024/.027 stepped hole

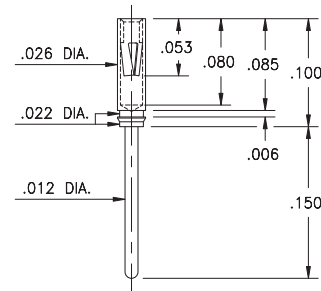

0439

0439-0-15-15-04-27-04-0

Press-fit in .025 mounting hole

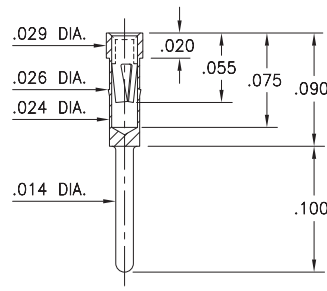

X464

X464-X-15-XX-10-XX-04-0

Solder mount in .016 min. mounting hole

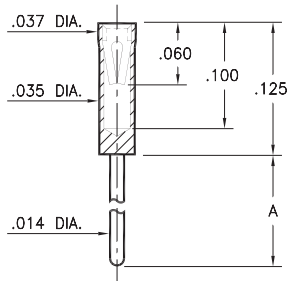

Basic Part Number	Length A
0464-0	.125
0464-1	.250
6464-0	.275

9225

9225-0-15-XX-10-XX-10-0

Press-fit in .039 mounting hole

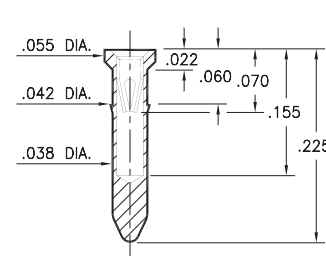

0529

0529-0-15-XX-10-XX-10-0

.040 min. mounting hole

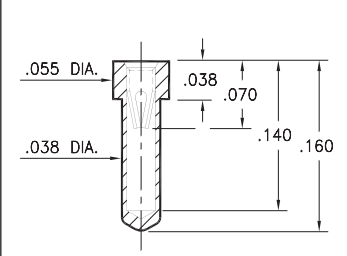

8947

8947-0-15-XX-10-XX-10-0

Solder mount in .040 min. mounting hole

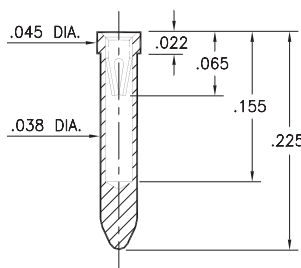

4993

4993-0-15-15-10-27-10-0

Compliant press-fit in .041 - .043 Dia. mounting hole

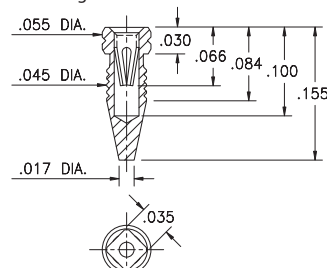

SPECIFICATIONS:

Shell Material: Brass Alloy 360, 1/2 Hard

Contact Material: Beryllium Copper Alloy 172, HT

Dimensions: Inches

Tolerances On: Lengths: ±.005

Diameters: ±.002

Angles: ± 2°



ORDER CODE: XXXX - X - XX - XX - XX - XX - XX - 0

BASIC PART #

SPECIFY SHELL FINISH:

- 01 200 μ" TIN/LEAD OVER NICKEL
- ◆ 80 200 μ" TIN OVER NICKEL (RoHS)
- ◆ 15 10 μ" GOLD OVER NICKEL (RoHS)

SPECIFY CONTACT FINISH:

- 02 100 μ" TIN/LEAD OVER NICKEL
- ◆ 84 100 μ" TIN OVER NICKEL (RoHS)
- ◆ 27 30 μ" GOLD OVER NICKEL (RoHS)

SELECT CONTACT:

#04 or #10 CONTACT (DATA ON PAGE 250)
(CONTACTS #04 & #10 NOT INTERCHANGEABLE)

