



Chipsmall Limited consists of a professional team with an average of over 10 year of expertise in the distribution of electronic components. Based in Hongkong, we have already established firm and mutual-benefit business relationships with customers from,Europe,America and south Asia,supplying obsolete and hard-to-find components to meet their specific needs.

With the principle of “Quality Parts,Customers Priority,Honest Operation,and Considerate Service”,our business mainly focus on the distribution of electronic components. Line cards we deal with include Microchip,ALPS,ROHM,Xilinx,Pulse,ON,Everlight and Freescale. Main products comprise IC,Modules,Potentiometer,IC Socket,Relay,Connector.Our parts cover such applications as commercial,industrial, and automotives areas.

We are looking forward to setting up business relationship with you and hope to provide you with the best service and solution. Let us make a better world for our industry!



## Contact us

Tel: +86-755-8981 8866 Fax: +86-755-8427 6832

Email & Skype: info@chipsmall.com Web: www.chipsmall.com

Address: A1208, Overseas Decoration Building, #122 Zhenhua RD., Futian, Shenzhen, China



LOC		DIST		REVISIONS				DATE	APPD
AG	53	P	F	ZONE	LTR	DESCRIPTION			
		P				REVISED PER 0440-0185-97	9-11-97	RT	
		R				REV PER 051D-0084-00	17JUL00	KW	

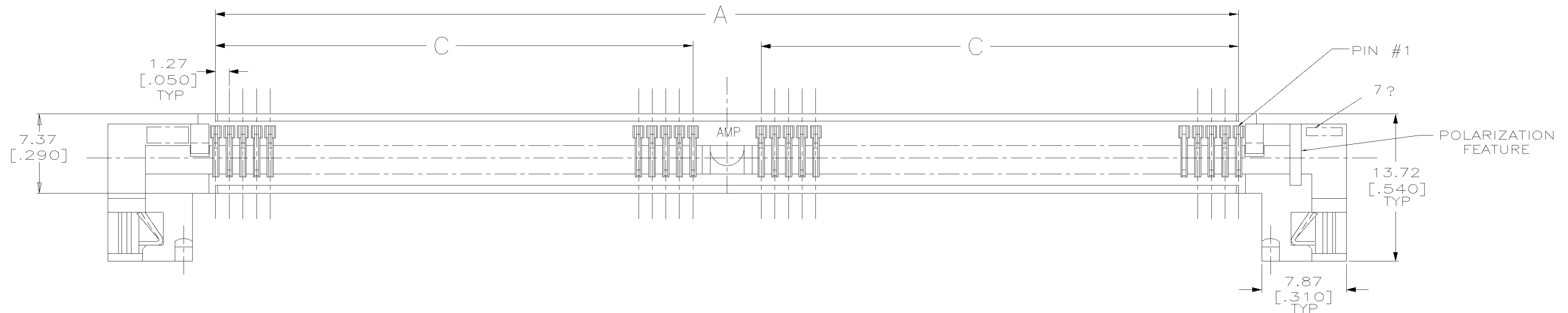

- △ HOUSING-MATERIAL : LIQUID-CRYSTAL-POLYMER.
- △ CONTACT-MATERIAL : PHOS. BRONZE.
- △ LATCH-MATERIAL : STAINLESS STEEL
- △ CONTACT-PLATE: 0.00508[.000200] MIN. TIN/LEAD OVER 0.00127 [.000050] MIN NICKEL.
- 5. IN ADDITION TO THOSE RECOMMENDED "SMM" P.C. BOARD DIMENSIONS AND TOLERANCES SHOWN, ALL JEDEC SPECIFICATIONS APPLY AS SHOWN ON MO-116, ISSUE A.
- 6. RECOMMENDED MATING S.I.M.M. TAB METALLURGY:  
 BASE METAL-COPPER. PLATING TO BE 0.00762[.000300] MIN TIN/LEAD OVER 0.00127[.000050] MIN NICKEL.
- 7? 'S' IDENTIFIER LOCATED APPROXIMATELY AS SHOWN.

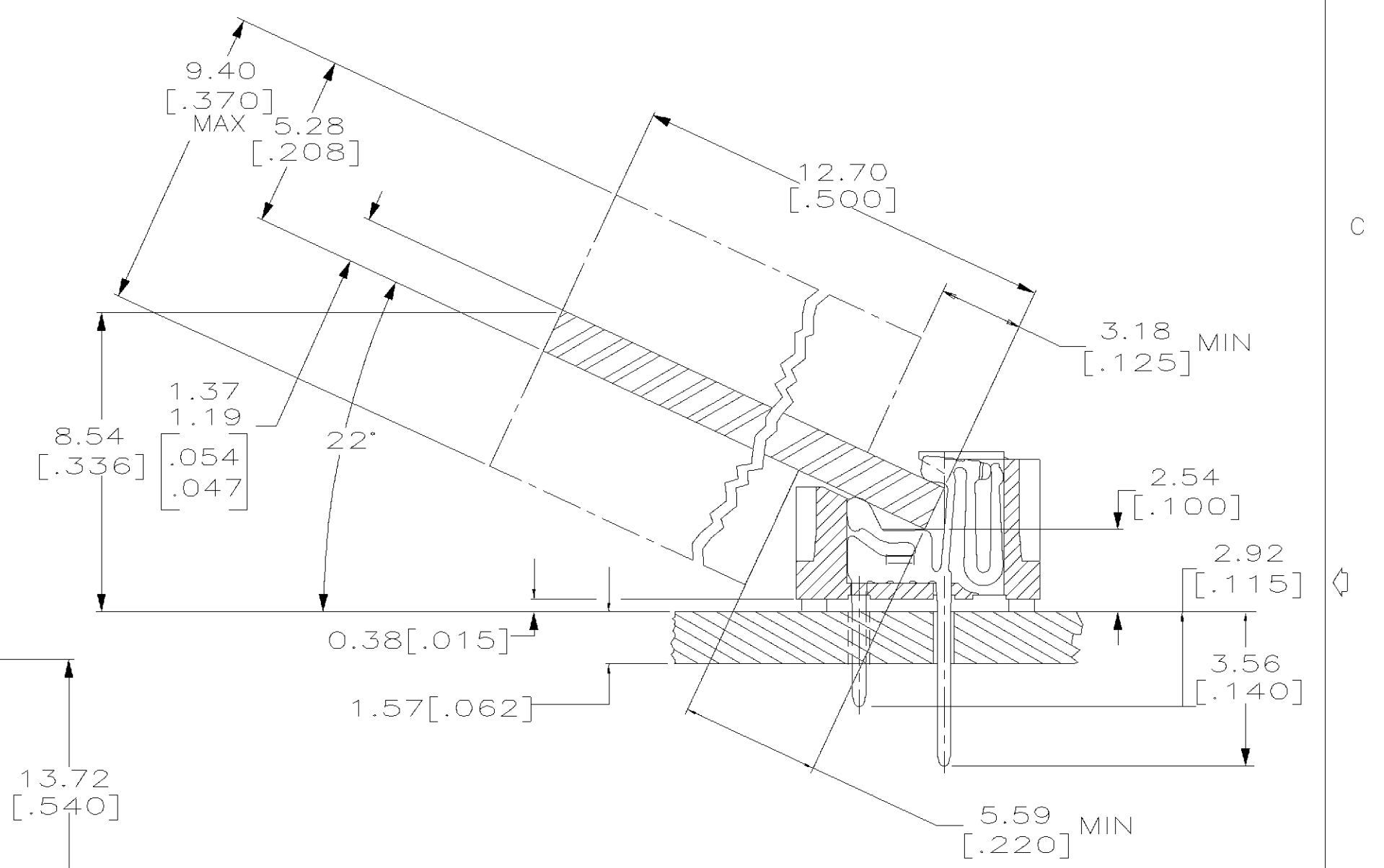
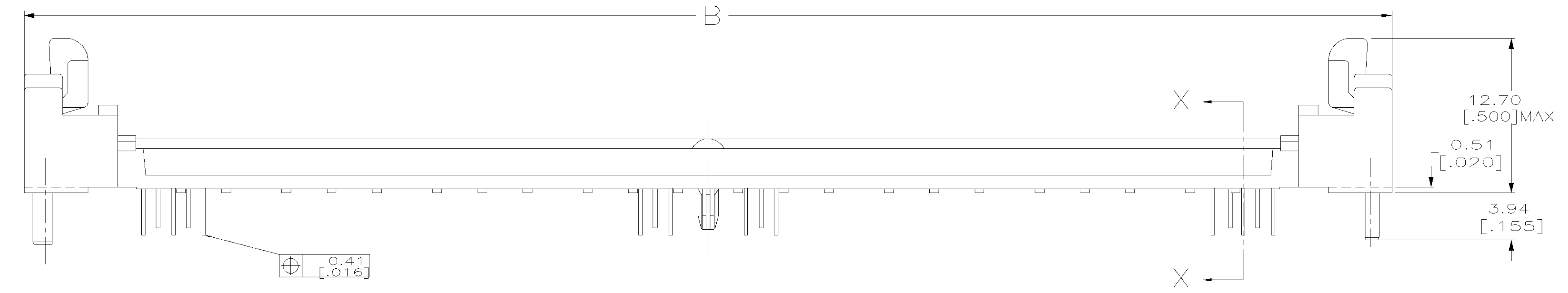

SECTION X-X  
 SCALE 5:1  
 (BOARD SHOWN FOR REF ONLY)

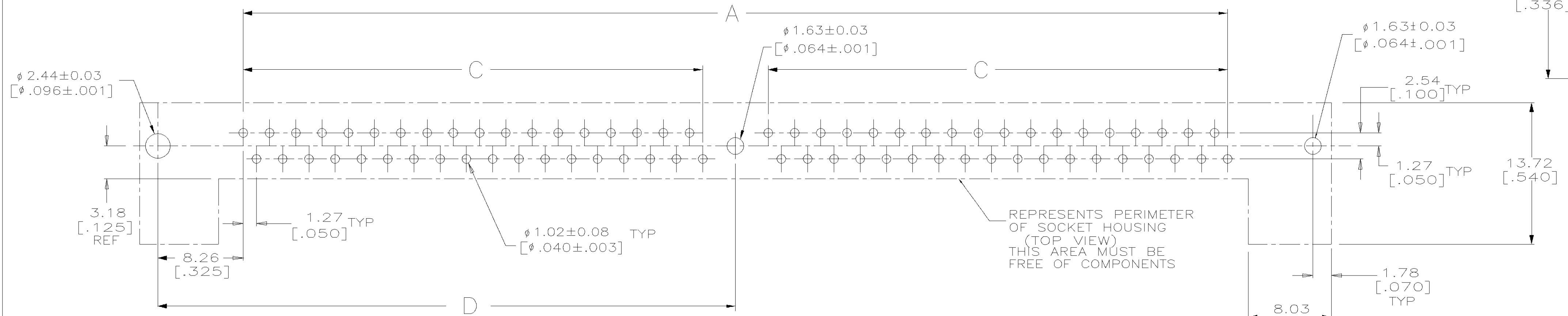

RECOMMENDED P.C. BOARD HOLE PATTERN  
 SOCKET SIDE

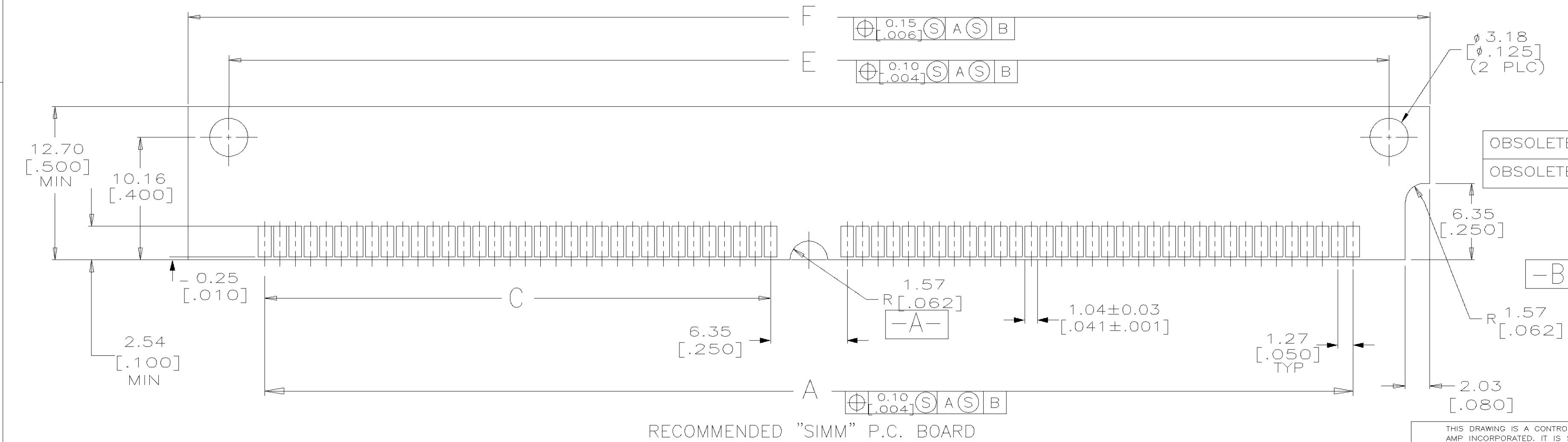

RECOMMENDED "SMM" P.C. BOARD

118.11[4.650]	111.35[4.384]	60.96[2.400]	49.53[1.950]	125.48[4.940]	105.41[4.150]	80	822134-4
107.95[4.250]	101.19[3.984]	55.88[2.200]	44.45[1.750]	115.32[4.540]	95.25[3.750]	72	822134-3
OBSOLETE 102.87[4.050]	OBSOLETE 96.11[3.784]	OBSOLETE 53.34[2.100]	OBSOLETE 41.91[1.650]	OBSOLETE 110.24[4.340]	OBSOLETE 90.17[3.550]	68	822134-2
OBSOLETE 97.79[3.850]	OBSOLETE 91.03[3.584]	OBSOLETE 50.80[2.000]	OBSOLETE 39.37[1.550]	OBSOLETE 105.16[4.140]	OBSOLETE 85.09[3.350]	64	822134-1
F	E	D	C	B	A	NO. OF POS	PART NO

DO NOT SCALE PRINT. UNLESS SPECIFIED DIMENSIONS IN mm [INCHES] TOLERANCES ON : 2 PLC DEC ± 3 PLC DEC ± 0.13[.005] ANGLES ±		DR 2-15-91 K.SALMON	AMP Incorporated Harrisburg, PA 17105-3508
MATERIAL HOUSING... △ CONTACT... △ LATCH... △		CHK 2-18-91 R.MILLER	
FINISH HOUSING... NATURAL CONTACT... △ LATCH... △		APPD 2-18-91 J.LAMBERT	NAME
THIS DRAWING IS A CONTROLLED DOCUMENT FOR AMP INCORPORATED. IT IS SUBJECT TO CHANGE AND THE CONTROLLING ENGINEERING ORGANIZATION SHOULD BE CONTACTED FOR THE LATEST REVISION.		APPD 2-18-91 E.MCCARTHY	PRODUCT SPEC
		APPLICATION SPEC	SIZE
		WEIGHT -	CAGE CODE
			DRAWING NO
			D
			00779
			C=822134
			SCALE
			4:1
			SHEET
			1 OF 1

CONNECTOR, MICRO-EDGE, .050, LP, TIN PL, W/METAL LATCH