



Chipsmall Limited consists of a professional team with an average of over 10 year of expertise in the distribution of electronic components. Based in Hongkong, we have already established firm and mutual-benefit business relationships with customers from,Europe,America and south Asia,supplying obsolete and hard-to-find components to meet their specific needs.

With the principle of “Quality Parts,Customers Priority,Honest Operation,and Considerate Service”,our business mainly focus on the distribution of electronic components. Line cards we deal with include Microchip,ALPS,ROHM,Xilinx,Pulse,ON,Everlight and Freescale. Main products comprise IC,Modules,Potentiometer,IC Socket,Relay,Connector.Our parts cover such applications as commercial,industrial, and automotives areas.

We are looking forward to setting up business relationship with you and hope to provide you with the best service and solution. Let us make a better world for our industry!



## Contact us

Tel: +86-755-8981 8866 Fax: +86-755-8427 6832

Email & Skype: [info@chipsmall.com](mailto:info@chipsmall.com) Web: [www.chipsmall.com](http://www.chipsmall.com)

Address: A1208, Overseas Decoration Building, #122 Zhenhua RD., Futian, Shenzhen, China



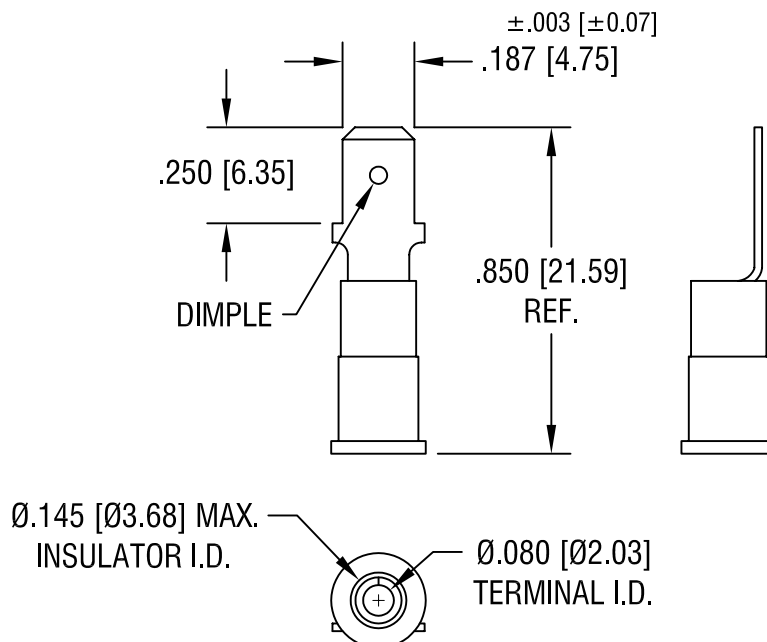

NOTE:

1. TERMINAL: .020 [0.50] TH'K COPPER, TIN PLATE  
INSULATOR: VINYL, BLUE
2. ACCOMMODATES WIRE RANGE 16/14 AWG

			KEYSTONE ELECTRONICS CORP.			
			ASTORIA, N.Y. 11105-2017			
			PART NAME			
			INSULATED QUICK-FIT TERMINAL, MALE			
			MATERIAL			
			AS NOTED			
			FINISH			DRN BY
AS NOTED			BOONE		11.15.07	
			APP'D		SCALE	
			LN		2X	
TOLERANCES		INCH	[MM]	CODE	DWG NO.	
DECIMAL		± .005	[± 0.15]	C/M	8288	
ANGULAR		± 1°				
UNLESS OTHERWISE SPECIFIED						
DATE	DESCRIPTION	REV.				