



Chipsmall Limited consists of a professional team with an average of over 10 year of expertise in the distribution of electronic components. Based in Hongkong, we have already established firm and mutual-benefit business relationships with customers from,Europe,America and south Asia,supplying obsolete and hard-to-find components to meet their specific needs.

With the principle of "Quality Parts,Customers Priority,Honest Operation,and Considerate Service",our business mainly focus on the distribution of electronic components. Line cards we deal with include Microchip,ALPS,ROHM,Xilinx,Pulse,ON,Everlight and Freescale. Main products comprise IC,Modules,Potentiometer,IC Socket,Relay,Connector.Our parts cover such applications as commercial,industrial, and automotives areas.

We are looking forward to setting up business relationship with you and hope to provide you with the best service and solution. Let us make a better world for our industry!



## Contact us

Tel: +86-755-8981 8866 Fax: +86-755-8427 6832

Email & Skype: [info@chipsmall.com](mailto:info@chipsmall.com) Web: [www.chipsmall.com](http://www.chipsmall.com)

Address: A1208, Overseas Decoration Building, #122 Zhenhua RD., Futian, Shenzhen, China



NOTES:

1. MATERIALS AND FINISHES:  
BODY , COUPLING NUT - BRASS, NICKEL PLATING  
CONTACT - BRASS, SILVER PLATING  
INSERT - PTFE, NATURAL
2. ELECTRICAL:  
A. IMPEDANCE: 50 OHM  
B. DIELECTRIC WITHSTANDING VOLTAGE: 1000 VRMS, MIN.
3. MECHANICAL:  
A. DURABILITY: 500 CYCLES MIN.  
B. TEMPERATURE RANGE: -65° C TO +165° C
4. PACKAGING:  
A. QUANTITY: SINGLE PACK  
B. MARKING: BAG TO BE MARKED  
"AMPHENOL RF, 83-822, AND DATE CODE"
5. STAMP COUPLING NUT: AMPHENOL 83-822  
74868 PL-259 49190  
NOTE: NEED A MINIMUM OF 2 SPACES BETWEEN GROUPS OF NUMBERS.
6. \* SHOWS CABLE ENTRY DIMENSIONS.

THIRD ANGLE PROJ. 

REVISIONS

REV	DESCRIPTION	DATE	ECO	APPR
	RELEASE TO MFG.			
Y	REDRAWN IN PRO-E & COD ADDED	18-Mar-14	49831	SH

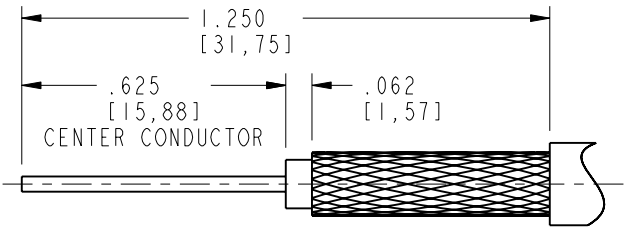

RECOMMENDED CABLE  
STRIPPING DIMENSIONS

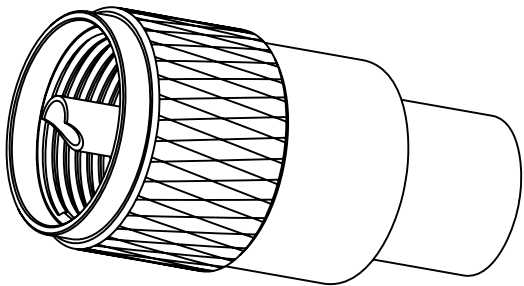

SCALE 1:1.700

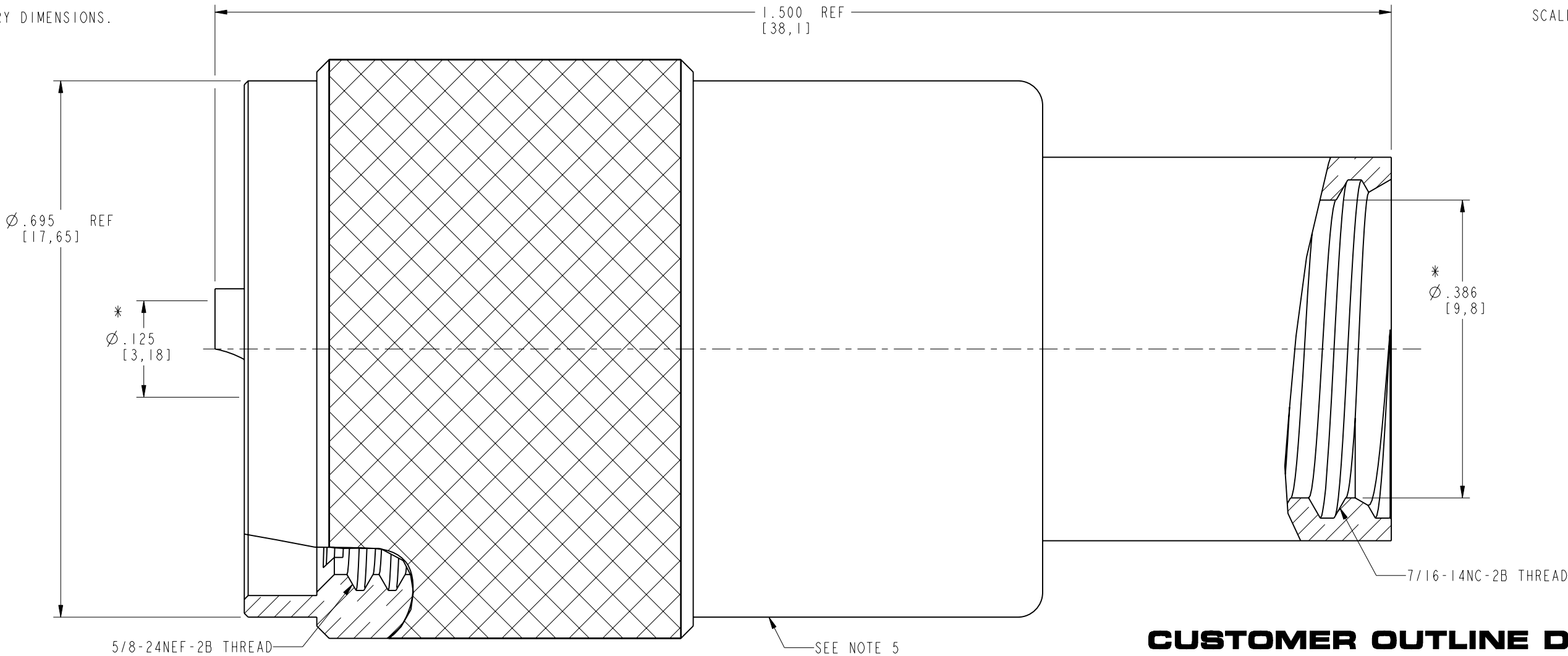

CUSTOMER OUTLINE DRAWING  
ALL OTHER SHEETS ARE FOR INTERNAL USE ONLY

UNLESS OTHERWISE SPECIFIED, DIMENSIONS ARE IN INCHES AND TOLERANCES ARE: 2 PLACE DECIMAL 3 PLACE DECIMAL ANGLES ±.015 (0,381 mm) ±.005 (0,127 mm) ± 1°  NOTICE - These drawings, specifications, or other data (1) are, and remain the property of Amphenol corp. (2) must be returned upon request; and (3) are confidential and not to be disclosed to any person other than those to whom they are given by Amphenol Corp. the furnishing of these drawings, specifications, or other data by Amphenol Corp., or to any other person to anyone for any purpose is not to be regarded by implication or otherwise in any manner licensing, granting rights to permitting such holder or any other person to manufacture, use or sell any product, process or design, patented or otherwise, that may in any way be related to or disclosed by said drawings, specifications, or other data.	MATERIAL	DRAWN	DATE	TITLE UHF PLUG ARMY PL-259 NAVY 49190		Amphenol RF  www.amphenolrf.com		
	SEE NOTES	J.CHENG	03-Mar-14					
		ENGINEER	DATE					
	REFERENCE	APPROVED	DATE	SCALE: 6.5:1.0		SHEET	2 OF 2	DRAWING NO.83-822
	EAR #	S.HSIEH	03-Mar-14					
	CONFIGURATION LEVEL: <input type="checkbox"/> <input type="checkbox"/> <input type="checkbox"/>	CAD FILE		DWG SIZE		REV	Y	ITEM NO.83-822
FINISH			B					
							PART NO.83-822	