



Chipsmall Limited consists of a professional team with an average of over 10 year of expertise in the distribution of electronic components. Based in Hongkong, we have already established firm and mutual-benefit business relationships with customers from,Europe,America and south Asia,supplying obsolete and hard-to-find components to meet their specific needs.

With the principle of “Quality Parts,Customers Priority,Honest Operation,and Considerate Service”,our business mainly focus on the distribution of electronic components. Line cards we deal with include Microchip,ALPS,ROHM,Xilinx,Pulse,ON,Everlight and Freescale. Main products comprise IC,Modules,Potentiometer,IC Socket,Relay,Connector.Our parts cover such applications as commercial,industrial, and automotives areas.

We are looking forward to setting up business relationship with you and hope to provide you with the best service and solution. Let us make a better world for our industry!



Contact us

Tel: +86-755-8981 8866 Fax: +86-755-8427 6832

Email & Skype: info@chipsmall.com Web: www.chipsmall.com

Address: A1208, Overseas Decoration Building, #122 Zhenhua RD., Futian, Shenzhen, China



MICROSWITCHES - SEALED, POSITIVE BREAK

PBX - 8324

- › Double-break snap-action mechanism with electrically separated circuits (form Zb)
- › Positive opening action according to IEC 60947-5-1 Annex K
- › Long overtravel, also after the positive opening position
- › Protection of mechanism: IP67/IP65, or IP40 with sealed plunger
- › Operating temperature -50 °C to +85 °C
- › Ratings from 1 mA 4 V_{DC} to 6 A 250 V_{AC} - Rating codes: A300, Q150
- › Very long mechanical life
- › Choice of connections - Mounting plates and roller lever (pre-assembled or retrofittable)
- › cURus and CCC approved - Meet applicable railway standards



Main specifications

| | | Standard 83240 | High force 83242 | Dual-current 83244 | Dual-current High force 83245 |
|--|--------------------|-------------------|---------------------|-----------------------|-------------------------------------|
| Degree of protection | Connections | | | | |
| IP40 | W3 | 83240000 | 83242000 | 83244000 | 83245000 |
| IP40 | W3/90B | 83240010 | 83242010 | ● | ● |
| IP40 | W5 | 83240020 | 83242020 | 83244020 | 83245020 |
| IP40 | W5/IP20 | 83240030 | 83242030 | 83244030 | 83245030 |
| IP40 | W1 | ● | ● | ● | ● |
| IP67 | W3 | 83240200 | 83242200 | 83244200 | 83245200 |
| IP67 | W3/90B | 83240210 | ● | 83244210 | ● |
| IP67 | W5 | 83240220 | 83242220 | 83244220 | 83245220 |
| IP67 | W5/IP20 | 83240230 | 83242230 | 83244230 | 83245230 |
| IP 67 | W1 | ● | ● | ● | ● |
| Electrical characteristics | | | | | |
| Positive opening action | | → | → | → | → |
| Rating nominal / 250 V _{AC} (A) | | 6 | 6 | 6* | 6* |
| Rating nominal / 250 V _{DC} (A) | | 0.6 | 0.6 | 0.6* | 0.6* |
| Rating Thermal (A) | | 10 | 10 | 10 | 10 |
| Mechanical characteristics | | | | | |
| Maximum operating force (N) | | 4.5 | 6.5 | 4.5 | 6.5 |
| Minimum release force (N) | | 0.6 | 2.5 | 0.6 | 2.5 |
| Minimum positive opening force (N) | | 28 | 28 | 28 | 28 |
| Maximum rest position (mm) | | 8.9 | 8.9 | 8.9 | 8.9 |
| Operating position (mm) | | 6.6 ±0.25 | 6.6 ±0.25 | 6.6 ±0.25 | 6.6 ±0.25 |
| Positive opening position (mm) | | 4.4 | 4.4 | 4.4 | 4.4 |
| Maximum total travel position (mm) | | 3.4 | 3.4 | 3.4 | 3.4 |
| Differential travel (mm) | | 1 ±0.3 | 1 ±0.3 | 1 ±0.3 | 1 ±0.3 |
| Operating temperature (°C) | | -50 → +85 | -50 → +85 | -50 → +85 | -50 → +85 |
| Mechanical life - IP40 versions (operations) | | 10 ⁷ | 10 ⁷ | 10 ⁷ | 10 ⁷ |
| Mechanical life - IP67 versions (operations) | | 4x10 ⁶ | 4 x 10 ⁶ | 4 x 10 ⁶ | 4 x 10 ⁶ |
| Contact gap (mm) | | 2 x 1 | 2 x 1 | 2 x 1 | 2 x 1 |
| Weight (g) | | 22 | 22 | 22 | 22 |

Additional characteristics

- Case: PC GF (UL 94-V2 / GWFI 960 °C / GWIT 775 °C)
- Button: PBT GF (UL 94-V0 / GWFI 960 °C)
- Membrane: silicone rubber
- Contacts: silver alloy, micro-profile
gold alloy on silver alloy, micro-profile (dual-current)
- Terminals: brass (silver-plated brass : on request)
- Screws: stainless steel
- Levers: stainless steel, polyamide roller
- Degree of protection: IP65/IP67 or IP40 (mechanism)
- Recommended min actuating speed: 0.5 mm/s
- Rated insulation voltage U_i: 400 V
- Impulse withstand voltage U_{imp}: 4 kV
- Pollution degree: 3
- Protection against electric shock: Button and actuators of IP67 versions have reinforced insulation
- Dimensional conformity: DIN 41636 F
- Fire/smoke resistance: EN 45545, NFF 16101/102-I3F1
- Approvals: cURus (A300, Q150), CCC

Product adaptations

- › IP67 wire lead or cable outputs, EN 50306 halogen-free versions
- › Special connections: W3 QC tabs with specific folding angles, double QC tabs, W5 without screws, ...
- › Special levers: special shapes and lengths
- › AgPd contacts for infrequent switching in corrosive atmospheres up to 1A (83241/83243)
- › Maintained action variant (bistable reset switch), with plunger or lever
- › Two-pole DPDT assemblies with common lever
- › IP40 protective cover/housing on connections



Standard product

Product made to order

● Contact us

Principles

Double break snap-action switch with electrically separated circuits and with positive opening action on NC contacts (21-22) according to IEC 60947-5-1 Annex K

Changeover - SPDT (form Zb)

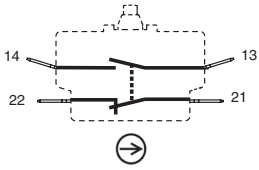

Both circuits can be used at opposite polarities

Curves

Operating curve for category AC15 Operating curve for category DC13

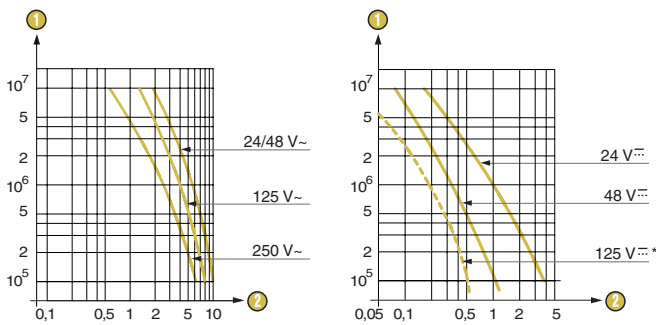

- ① Number of operations
- ② Current in Amps

For IP67 versions used in 125 V DC, please consult us.

* Models 83244 and 83245 are designed to operate equally well on low-current (1 mA 4 V minimum recommended) or medium to high current circuits. However, a given product should only be used to switch one type of circuit during its working life.

Dimensions (mm)

Product

8324

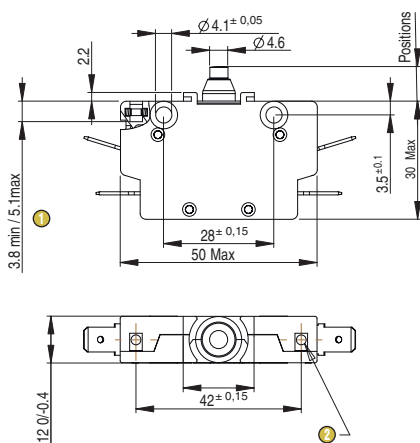

- ① Fixing screw threaded length
- ② Fixing nuts 2 x M3

Max. tightening torque of fixing screws: 1.3 N.m on $\varnothing 4.1$ holes
0.9 N.m on M3 nuts

Connections

W3 quick-connect 6.3 x 0.8

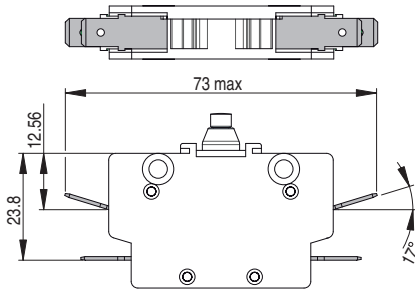

W3/90B quick-connect 6.3x0.8, 90° downward folding

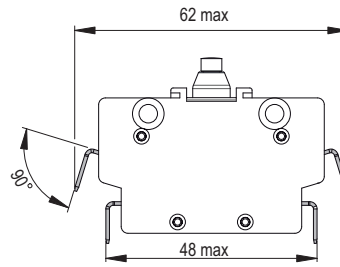

W5 screw with clamp W1 screw with washer

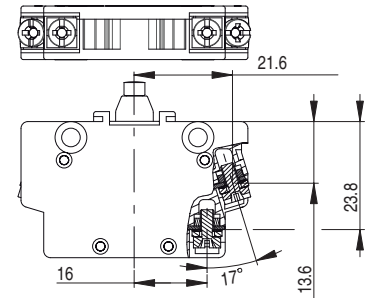

4 x M3 screws - PZ1 type

W5/IP20 screw with clamp and IP20 protection

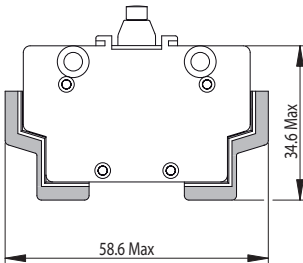
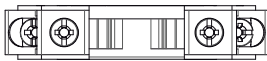

Mounting accessories

PT mounting plates with holes

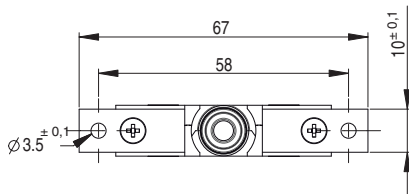

Thickness: 1 mm

PE mounting plates with notches

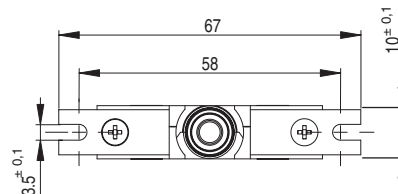

Thickness: 1 mm

Actuators

LG roller lever

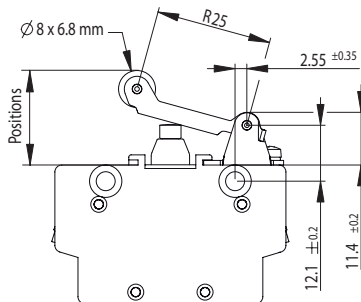

Mechanical characteristics on roller

| | 83240/83244 | 83242/83245 |
|------------------------------------|-------------|-------------|
| Maximum operating force (N) | 3 | 4 |
| Minimum release force (N) | 0.3 | 1.3 |
| Min. positive opening force (N) | 19 | 19 |
| Maximum rest position (mm) | 21 | 21 |
| Operating position (mm) | 16,6±0,5 | 16,6±0,5 |
| Positive opening position (mm) | 13,2 | 13,2 |
| Maximum total travel position (mm) | 12 | 12 |
| Differential travel (mm) | 1,8±0,55 | 1,8±0,55 |

Actuators and mounting accessories

PBX 8324 with referenced accessories

| | Roller lever | Mounting plates | Accessory kit | LG | LG | LG | - | - |
|-------|--------------|-----------------|---------------|-----------------|-----------------|-----------------|-----------------|-----------------|
| | | | | - | PT | PE | PT | PE |
| | | | | 79552456 | 79552457 | 79552458 | 79552459 | 79552460 |
| 83240 | IP40 | W3 | W3/90B | 83240003 | 83240004 | 83240005 | • | • |
| | | | W5 | 83240013 | 83240014 | 83240015 | • | • |
| | | | W5/IP20 | 83240023 | 83240024 | • | • | |
| | | | W5/IP20 | 83240033 | 83240034 | • | • | |
| | IP67 | W3 | W3/90B | 83240203 | • | • | • | • |
| | | | W5 | 83240213 | • | • | • | |
| | | | W5/IP20 | 83240223 | 83240224 | 83240225 | 83240221 | • |
| | | | W5/IP20 | • | • | • | • | |
| | | | W5/IP20 | • | • | • | • | |
| | | | W5/IP20 | • | • | • | • | |
| 83242 | IP40 | W3 | W3/90B | 83242003 | 83242004 | 83242005 | • | • |
| | | | W5 | • | 83242014 | • | 83242011 | • |
| | | | W5/IP20 | 83242023 | 83242024 | • | • | |
| | | | W5/IP20 | • | • | • | • | |
| | IP67 | W3 | W3/90B | • | • | • | • | • |
| | | | W5 | • | • | • | • | |
| | | | W5/IP20 | 83242223 | 83242224 | • | • | |
| | | | W5/IP20 | • | • | • | • | |
| | | | W5/IP20 | • | • | • | • | |
| | | | W5/IP20 | • | • | • | • | |
| 83244 | IP40 | W3 | W3/90B | 83244003 | 83244004 | • | • | |
| | | | W5 | 83244013 | 83244014 | • | • | |
| | | | W5/IP20 | 83244023 | 83244024 | • | • | |
| | | | W5/IP20 | • | 83244034 | • | • | |
| | IP67 | W3 | W3/90B | 83244203 | • | • | • | • |
| | | | W5 | 83244213 | • | • | • | |
| | | | W5/IP20 | 83244223 | • | • | • | |
| | | | W5/IP20 | • | • | • | • | |
| | | | W5/IP20 | • | • | • | • | |
| | | | W5/IP20 | • | • | • | • | |

Installation recommendations

See "Basic technical concepts"

How to order

Use the 8 digit part numbers when they are defined

Other cases, precise: Type of microswitch - Degree of protection - Connection - Actuator* - Mounting accessories* - Adaptation*
* if needed

Example: 83240 IP67 W3/90B LG PE

Examples of special adaptations

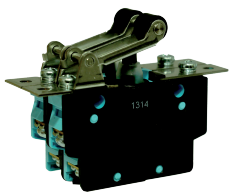

Two-pole DPDT assembly with linked levers

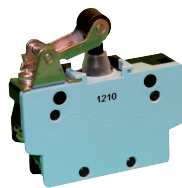

Short roller lever

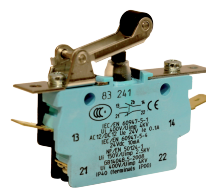

Mixed connections: NO quick-connect 6.3 x 0.8 / NC screw with clamp

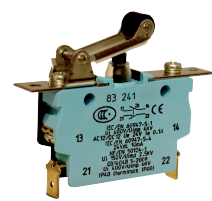

Mixed connections: NO screw with clamp / NC quick-connect 6.3 x 0.8, 90° downward folding

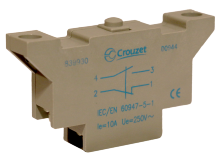

Economic version (839930): SPDT form Za without positive opening, Ø 3.2 mounting holes on top face, screw terminals

Standard product

Product made to order



Contact us