



Chipsmall Limited consists of a professional team with an average of over 10 year of expertise in the distribution of electronic components. Based in Hongkong, we have already established firm and mutual-benefit business relationships with customers from,Europe,America and south Asia,supplying obsolete and hard-to-find components to meet their specific needs.

With the principle of "Quality Parts,Customers Priority,Honest Operation,and Considerate Service",our business mainly focus on the distribution of electronic components. Line cards we deal with include Microchip,ALPS,ROHM,Xilinx,Pulse,ON,Everlight and Freescale. Main products comprise IC,Modules,Potentiometer,IC Socket,Relay,Connector.Our parts cover such applications as commercial,industrial, and automotives areas.

We are looking forward to setting up business relationship with you and hope to provide you with the best service and solution. Let us make a better world for our industry!



Contact us

Tel: +86-755-8981 8866 Fax: +86-755-8427 6832

Email & Skype: info@chipsmall.com Web: www.chipsmall.com

Address: A1208, Overseas Decoration Building, #122 Zhenhua RD., Futian, Shenzhen, China



Tous droits strictement reserves. Reproduction ou communication a des tiers interdite sous quelque forme que ce soit sans autorisation écrite du propriétaire. Propriete de c FCI. Droits de reproduction FCI.

All rights strictly reserved. Reproduction or issue to third parties in any form whatever is not permitted without written authority from the proprietor. Property of FCI. Copyright FCI.

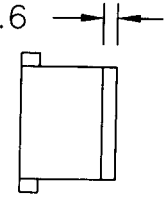

NOTES:

- SEE APPLICATION SPECIFICATION GES-20-007 FOR INSTRUCTION ON WIRE INSERTION AND ASSEMBLY OF COMPONENTS FOR CONNECTORS USING THESE LATCH FINGERS.

MATERIAL:

MAT'L: ULTEM 1010

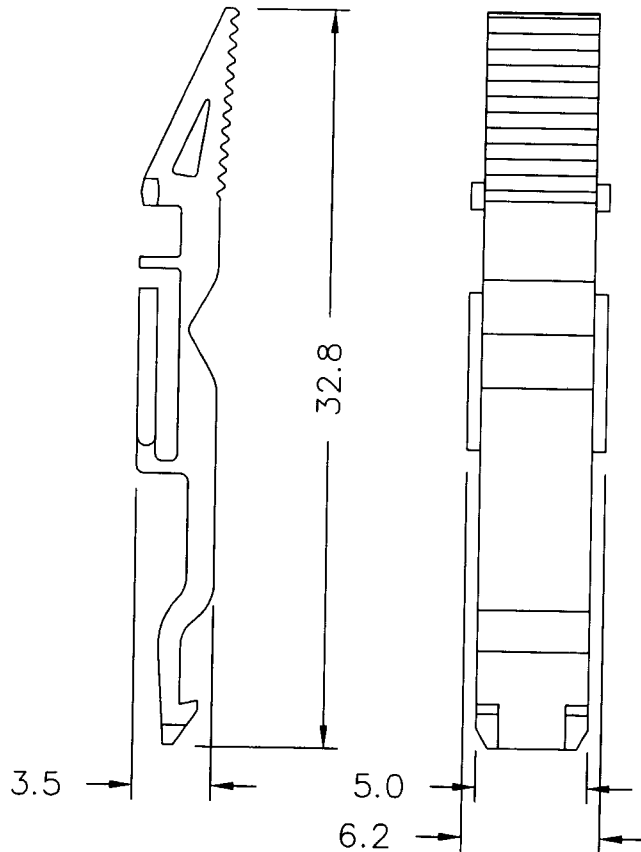

PRODUCT NUMBER	COLOR
84665-001	BLACK
84665-003	ORANGE
84665-004	GREEN
84665-005	BLUE
84665-006	BROWN

mat'l. code		tolerances unless otherwise specified		CUSTOMER COPY		 FCI Electronics www.fciconnect.com	
ltr	ecn no	dr	date	linear	.XX±.01/.X±.3	projection	title
A	VB2260	JRV	12/23/98		.XXX±.005/.XX±.13	 INCH/MM	LATCH FINGER WBWM CONNECTORS
B	V90151	JRV	2/2/99		.XXX±.0020/.XX±.051		
C	V10865	JRW	2/8/01	angles	0° ±2'	product family	METRAL
				dr	J.R. VOLSTORF	2/2/99	code
				enr	J.R. VOLSTORF	2/2/99	213
				chr	J.R. VOLSTORF	2/2/99	sheet
				appd	J.R. VOLSTORF	2/2/99	1 of 1
sheet index	revision sheet	C	1	scale		1:1	A
				product size		A	84665

cage code
22526

ACAD

PDM: Rev:C

STATUS: Released

Printed: Feb 04