



Chipsmall Limited consists of a professional team with an average of over 10 year of expertise in the distribution of electronic components. Based in Hongkong, we have already established firm and mutual-benefit business relationships with customers from,Europe,America and south Asia,supplying obsolete and hard-to-find components to meet their specific needs.

With the principle of “Quality Parts,Customers Priority,Honest Operation,and Considerate Service”,our business mainly focus on the distribution of electronic components. Line cards we deal with include Microchip,ALPS,ROHM,Xilinx,Pulse,ON,Everlight and Freescale. Main products comprise IC,Modules,Potentiometer,IC Socket,Relay,Connector.Our parts cover such applications as commercial,industrial, and automotives areas.

We are looking forward to setting up business relationship with you and hope to provide you with the best service and solution. Let us make a better world for our industry!



Contact us

Tel: +86-755-8981 8866 Fax: +86-755-8427 6832

Email & Skype: info@chipsmall.com Web: www.chipsmall.com

Address: A1208, Overseas Decoration Building, #122 Zhenhua RD., Futian, Shenzhen, China



MALE PCB PINS

SOLDER TERMINALS VARIOUS TYPES

2709

2709-X-07-XX-00-00-07-0

Swage mount in .116 hole

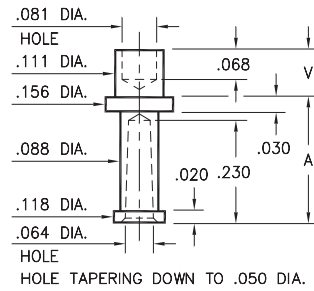

Basic Part Number	Board Thickness	Length V	Length A
2709-2	.062	.109	.281
2709-3	.094	.141	.250

8602

8602-1-00-XX-00-00-07-0

Square press-fit in .032 plated through-hole

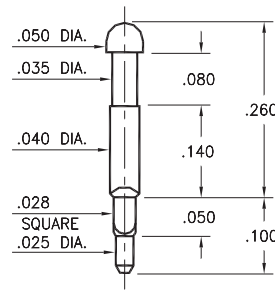

2115

2115-2-00-XX-00-00-07-0

Swage mount in .043 hole

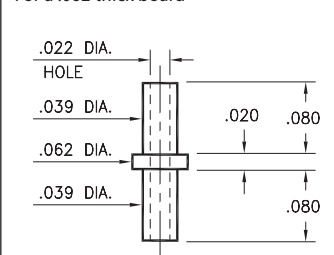

2326

2326-2-00-XX-00-00-07-0

Swage mount in .055 hole
For a .062 thick board

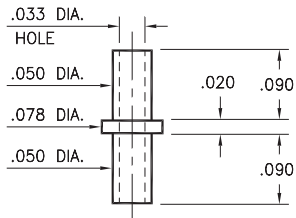

8831

8831-0-00-XX-00-00-03-0

Press-fit in .057 mounting hole

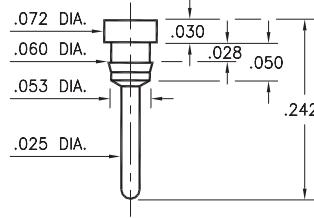

8835

8835-0-00-XX-00-00-03-0

Press-fit in .057 mounting hole

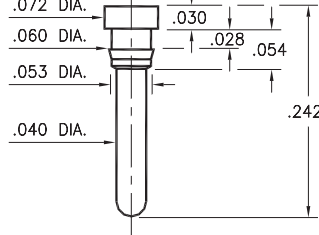

8836

8836-0-00-XX-00-00-03-0

Press-fit in .075 mounting hole

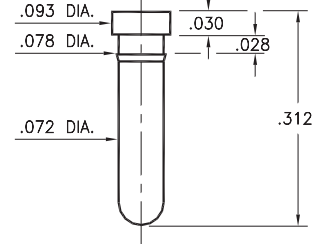

0912/7912

X912-0-00-XX-00-00-03-0

Press-fit in .057 mounting hole

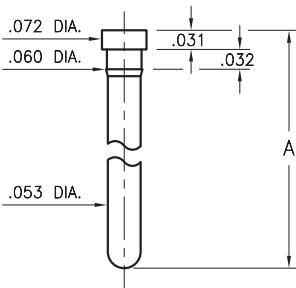

Basic Part Number	Pin Length A
0912-0	.313
7912-0	.510

SPECIFICATIONS:

Pin Material: Brass Alloy 360, 1/2 Hard
(Swage pins are annealed)

Dimensions: Inches

Tolerances On: Lengths: $\pm .005$
Diameters: $\pm .002$
Angles: $\pm 2^\circ$



ORDER CODE: XXXX - X - XX - XX - 00 - 00 - XX - 0

BASIC PART #

SPECIFY PIN FINISH:

- 01 200 μ " TIN/LEAD OVER NICKEL
- ◆ 80 200 μ " TIN OVER NICKEL (RoHS)
- ◆ 44 300 μ " SILVER OVER COPPER (RoHS)
- 50 300 μ " ELECTRO-SOLDER (60/40 SnPb)

