



Chipsmall Limited consists of a professional team with an average of over 10 year of expertise in the distribution of electronic components. Based in Hongkong, we have already established firm and mutual-benefit business relationships with customers from,Europe,America and south Asia,supplying obsolete and hard-to-find components to meet their specific needs.

With the principle of “Quality Parts,Customers Priority,Honest Operation,and Considerate Service”,our business mainly focus on the distribution of electronic components. Line cards we deal with include Microchip,ALPS,ROHM,Xilinx,Pulse,ON,Everlight and Freescale. Main products comprise IC,Modules,Potentiometer,IC Socket,Relay,Connector.Our parts cover such applications as commercial,industrial, and automotives areas.

We are looking forward to setting up business relationship with you and hope to provide you with the best service and solution. Let us make a better world for our industry!



Contact us

Tel: +86-755-8981 8866 Fax: +86-755-8427 6832

Email & Skype: info@chipsmall.com Web: www.chipsmall.com

Address: A1208, Overseas Decoration Building, #122 Zhenhua RD., Futian, Shenzhen, China



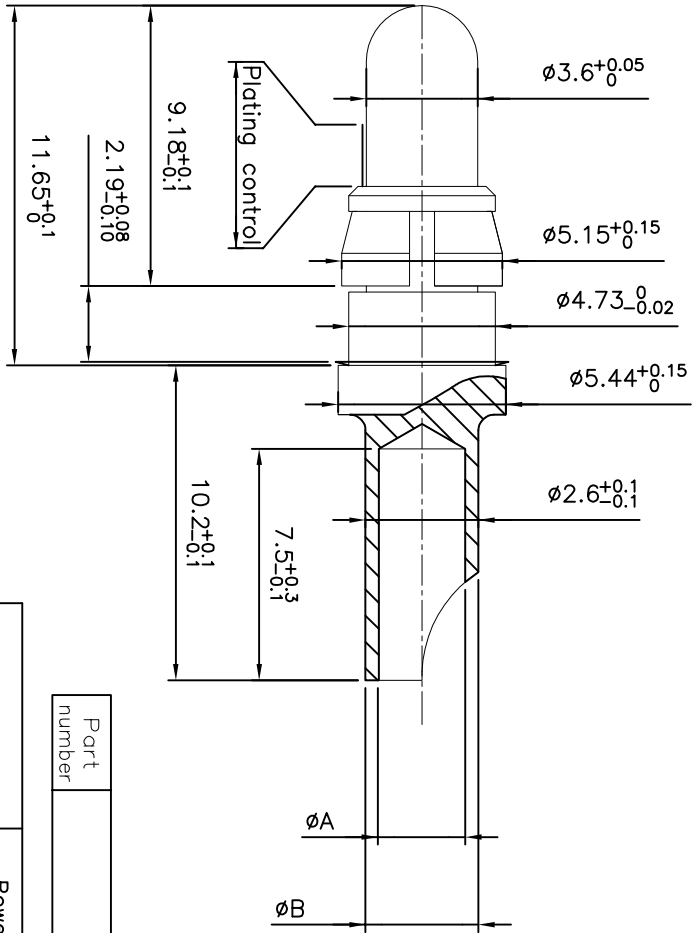

CONTACT PLATING : gold 0.40 μ over nickel 1 μ .

Part number
SEE TABLE

8630-3098NLF	Power contact #8	4.40	5.00	3.90	8.98
8630-3056NLF	Power contact #12	2.80	3.65	2.40	3.18
8630-3060NLF	Power contact #14	2.10	3.00	1.70	1.91
8630-3064NLF	Power contact #16	1.70	2.60	1.50	1.34
part numbers	Designation	$\phi A^{+0.10}_0$	$\phi B^{\pm 0.10}$	\emptyset anne mm	Section mm ² CABLE

NOTE:ROHS INFORMATIONS

- The "LF" product meets European union Directives and other country regulations as described in GS-22-008.
- The product is not intended to be exposed to a manufacturing solder process.
- Packaging spec: see GS-14-920.

mat'l. code		surface		tolerance		projection		product family	
lfr	ecm no	dr	date	ISO 1302	ISO 406	ISO 1001		D-SUB	
A	LS06-0022	MPE	2006/03/11	tolerances unless otherwise specified				PIN POWER CONTACTS	
B	LS06-0095	LCO	2006/06/23	linear	0xx	± 0.1		sheet 1 of 1	
C	F11-0326	APA	2011/10/28	0xxx	± 0.1			size	
D	F-27592	ALA	2017/07/31	M.PESSON	2006/03/11			A3	
		engr		M.PESSON	2006/03/11			Drawing	
		chr		LEGARRE	2006/03/11				
		appt		LEGARRE	2006/03/11				
sheet	revision	1							
index	sheet	1							