



Chipsmall Limited consists of a professional team with an average of over 10 year of expertise in the distribution of electronic components. Based in Hongkong, we have already established firm and mutual-benefit business relationships with customers from,Europe,America and south Asia,supplying obsolete and hard-to-find components to meet their specific needs.

With the principle of “Quality Parts,Customers Priority,Honest Operation,and Considerate Service”,our business mainly focus on the distribution of electronic components. Line cards we deal with include Microchip,ALPS,ROHM,Xilinx,Pulse,ON,Everlight and Freescale. Main products comprise IC,Modules,Potentiometer,IC Socket,Relay,Connector.Our parts cover such applications as commercial,industrial, and automotives areas.

We are looking forward to setting up business relationship with you and hope to provide you with the best service and solution. Let us make a better world for our industry!



## Contact us

Tel: +86-755-8981 8866 Fax: +86-755-8427 6832

Email & Skype: info@chipsmall.com Web: www.chipsmall.com

Address: A1208, Overseas Decoration Building, #122 Zhenhua RD., Futian, Shenzhen, China



THIS DRAWING IS UNPUBLISHED. RELEASED FOR PUBLICATION, 19 .  
 © COPYRIGHT 19 BY AMP INCORPORATED. ALL INTERNATIONAL RIGHTS RESERVED.

PROD 4092 CODE	LOC DF	DIST SO	P	F	REVISIONS					
					ZONE	LTR	DESCRIPTION	DATE	APPD	
					G		REDRAWN & ADDED 1-865765-1 & 1-865765-2 PER NPR'S 89-0342 & 89-0343	T. S.	8-18-89	WS
				✓	H		ADD -9 PER 0600-1422-93	CT	11-93	SG
				✓	J		REV PER 0600-6810-97 JB		03-98	DE

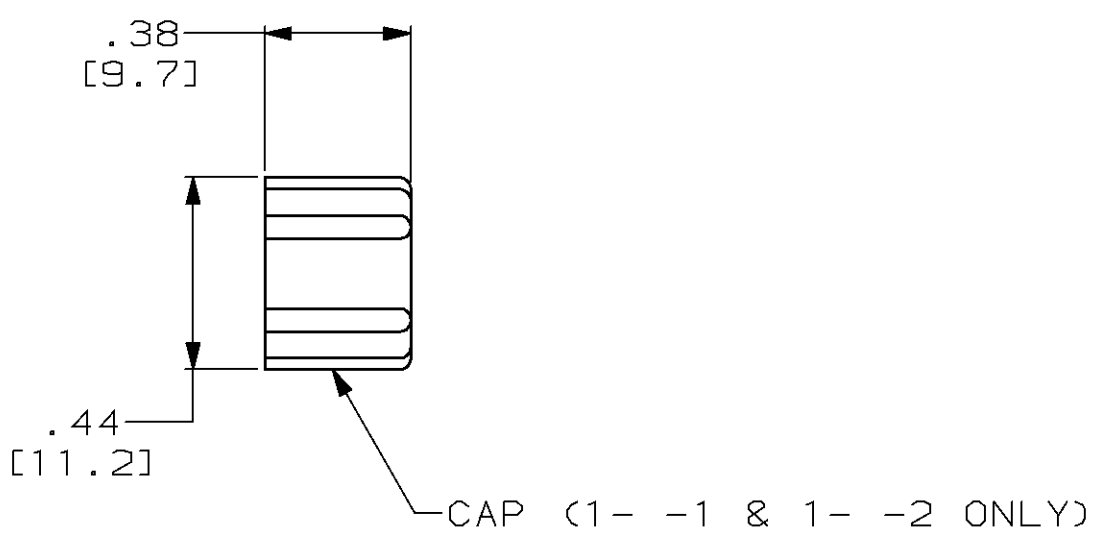
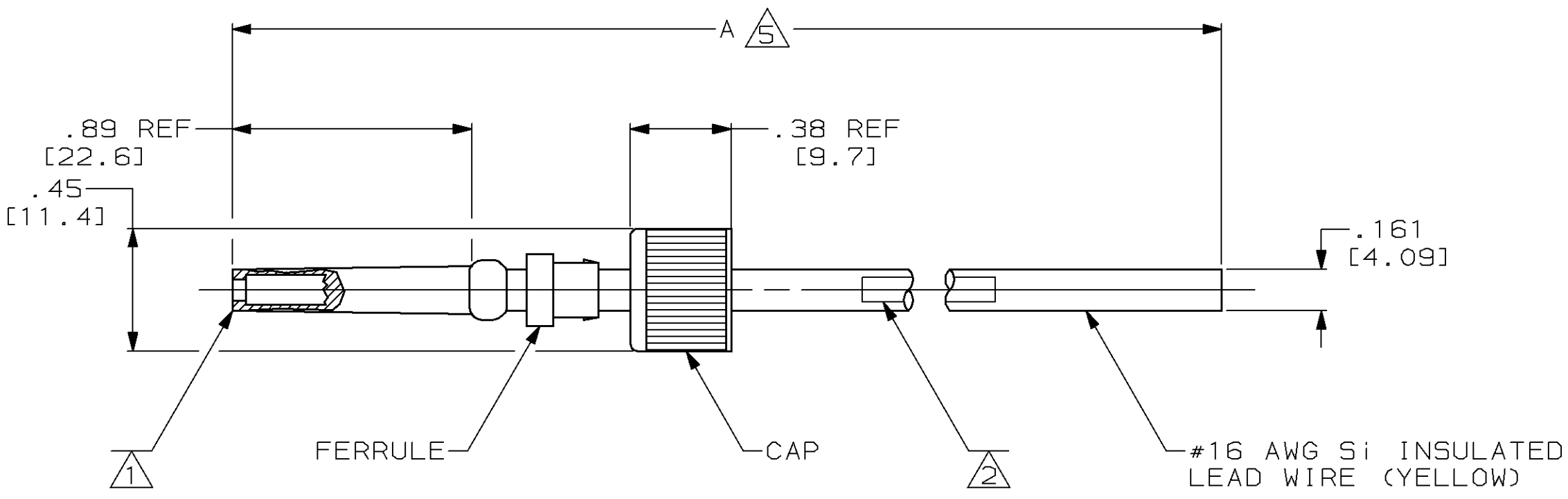

	12.00 [304.8]	1-865765-2
	18.00 [457.2]	1-865765-1
NOT RELEASED	---	1-865765-0
	36.00±.36 [914.4±9.1]	865765-9
NOT RELEASED	---	865765-8
	24.00 [609.6]	865765-7
OBSOLETE	336.00±3.36 [8534.4±85.3]	865765-6
	72.00±.72 [182.8±18.3]	865765-5
	12.00 [304.8]	865765-4
OBSOLETE	11.00 [279.4]	865765-3
OBSOLETE	240.00±2.40 [6096.±61.0]	865765-2
	48.00±.46 [1219.2±12.2]	865765-1

- ① TO MATE WITH AMP LGH 1/2L RECEPTACLE WITH A .89 BARREL LENGTH.
- ② MARK PER MIL-STD-130.
- 3. OPERATING CONDITIONS: 15KVDC TO 70,000 FEET AT -55°C TO +125°C.
- 4. DIMENSIONS IN BRACKETS ARE IN MILLIMETERS. METRIC EQUIVALENTS ARE BASED UPON 1.00 inch = 25.4 mm.
- ⑤ TOLERANCE OF LEAD LENGTH:  
UP TO 24 INCHES ±.12  
24 INCHES AND UP ±1%

DO NOT SCALE PRINT. UNLESS SPECIFIED DIMENSIONS IN INCHES [mm]		DR 8-18-89 T. SHUEY		AMP INCORPORATED Harrisburg, Pa. 17105	
TOLERANCES ON: 2 PLC DEC ± .12 [3.0] 3 PLC DEC ± .005 [0.13] ANGLES ±		CHK 9-5-89 W. SHATTO			
MATERIAL		APPD 9-5-89 W. SHATTO		NAME	
FINISH		APPD 9-5-89 T. SHUEY		LEAD ASSEMBLY, LGH 1/2L POSITIVE STOP	
WEIGHT		PRODUCT SPEC			
		APPLICATION SPEC		SIZE	CAGE CODE
				C	00779
				DRAWING NO	865765
				SCALE	2:1
				SHEET	1 OF 1