



Chipsmall Limited consists of a professional team with an average of over 10 year of expertise in the distribution of electronic components. Based in Hongkong, we have already established firm and mutual-benefit business relationships with customers from,Europe,America and south Asia,supplying obsolete and hard-to-find components to meet their specific needs.

With the principle of “Quality Parts,Customers Priority,Honest Operation,and Considerate Service”,our business mainly focus on the distribution of electronic components. Line cards we deal with include Microchip,ALPS,ROHM,Xilinx,Pulse,ON,Everlight and Freescale. Main products comprise IC,Modules,Potentiometer,IC Socket,Relay,Connector.Our parts cover such applications as commercial,industrial, and automotives areas.

We are looking forward to setting up business relationship with you and hope to provide you with the best service and solution. Let us make a better world for our industry!



## Contact us

Tel: +86-755-8981 8866 Fax: +86-755-8427 6832

Email & Skype: info@chipsmall.com Web: www.chipsmall.com

Address: A1208, Overseas Decoration Building, #122 Zhenhua RD., Futian, Shenzhen, China



THIS DRAWING IS UNPUBLISHED. RELEASED FOR PUBLICATION ,19 .  
 © COPYRIGHT 19 BY AMP INCORPORATED, HARRISBURG, PA. ALL INTERNATIONAL RIGHTS RESERVED. AMP PRODUCTS MAY BE COVERED BY U.S. AND FOREIGN PATENTS AND/OR PATENTS PENDING.

LOC		DIST		P		F		REVISIONS		
DF	SO			ZONE	LTR	DESCRIPTION		DATE	APPROVED	
					0	RLSE PR1784		8-86	MG	
					A	REV PER 0600-5062-95 CT		2-96	DE	

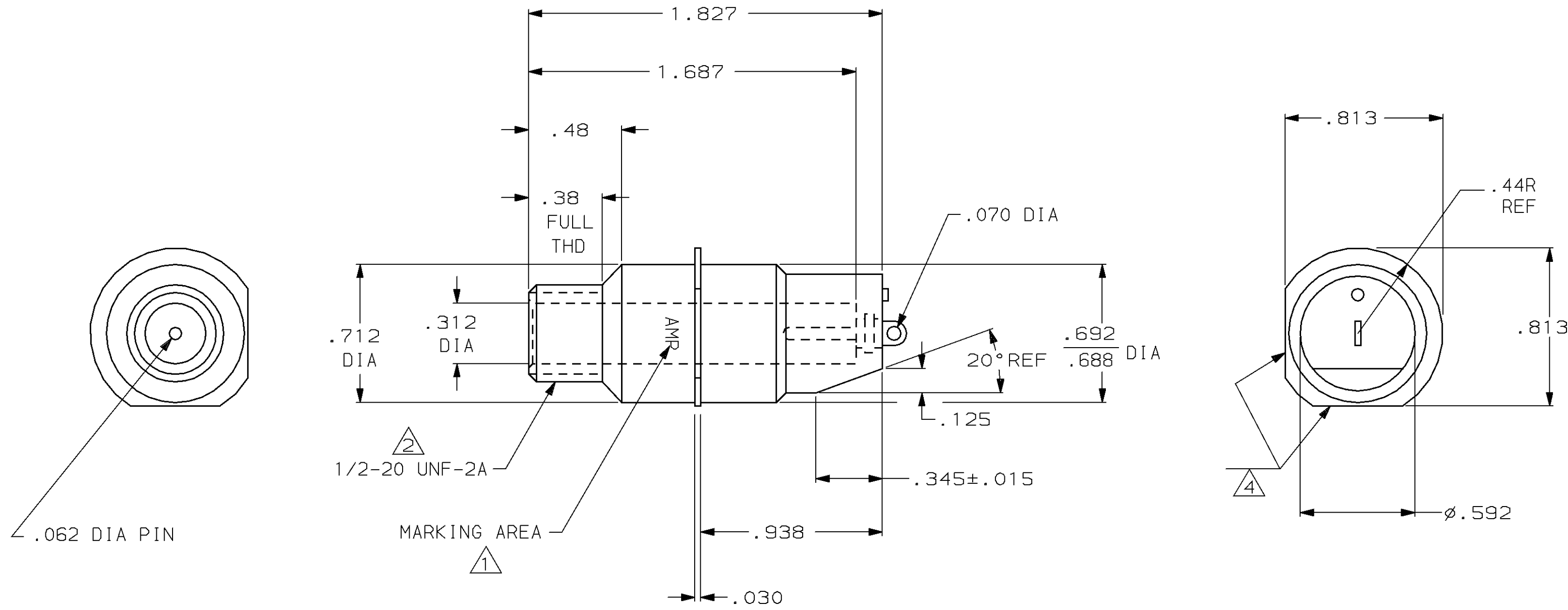

- ① MARKED PER MIL-STD-130.
- ② USING THREE WIRE METHOD; DIMENSION OVER WIRES TO BE .307/.318.
- 3. THIS RECEPTACLE IS HERMETICALLY SEALED.
- ④ EYELET PORTION OF PIN, FLATS ON FLANGE AND BEVEL TO BE ORIENTED AS SHOWN.

868850-1  
PART NO

UNLESS OTHERWISE SPECIFIED DIMENSIONS ARE IN INCHES TOLERANCES ON :		DR 8-13-86 R. HEPNER		AMP INCORPORATED Harrisburg, Pa. 17105	
2 PL DEC ± .01 3 PL DEC ± .005 ANGLES ± -		CHK 8-13-86 M. GARDNER			
MATERIAL		APPD 8-13-86 M. GARDNER		NAME RECEPTACLE, LGH 1L	
-		RLSE 8-13-86 R. HEPNER			
FINISH		PRODUCT SPEC		SIZE	FSCM NO
-		APPLICATION SPEC		<b>C</b>	00779
		WEIGHT		DRAWING NO	868850
		-		SCALE	2:1
				SHEET	1 OF 1