



Chipsmall Limited consists of a professional team with an average of over 10 year of expertise in the distribution of electronic components. Based in Hongkong, we have already established firm and mutual-benefit business relationships with customers from,Europe,America and south Asia,supplying obsolete and hard-to-find components to meet their specific needs.

With the principle of “Quality Parts,Customers Priority,Honest Operation,and Considerate Service”,our business mainly focus on the distribution of electronic components. Line cards we deal with include Microchip,ALPS,ROHM,Xilinx,Pulse,ON,Everlight and Freescale. Main products comprise IC,Modules,Potentiometer,IC Socket,Relay,Connector.Our parts cover such applications as commercial,industrial, and automotives areas.

We are looking forward to setting up business relationship with you and hope to provide you with the best service and solution. Let us make a better world for our industry!



## Contact us

Tel: +86-755-8981 8866 Fax: +86-755-8427 6832

Email & Skype: info@chipsmall.com Web: www.chipsmall.com

Address: A1208, Overseas Decoration Building, #122 Zhenhua RD., Futian, Shenzhen, China



# CAPTIVE PANEL SCREWS

MATERIAL: Stainless Steel per ASTM-A581/A-582

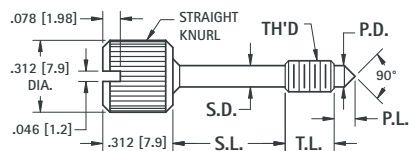
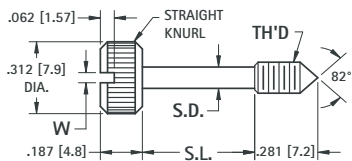

CAT. NO.	THREAD	S.D. ± .005 (.13)	S.L. ± .010 (.25)	W + .015 (+.38) -.000
8700	4-40	.078 (2.0)	.375 (9.5)	.036 (.091)
8701	4-40	.078 (2.0)	.500 (12.7)	.036 (.091)
8702	4-40	.078 (2.0)	.625 (15.9)	.036 (.091)
8703	6-32	.095 (2.41)	.375 (9.5)	.045 (1.14)
8704	6-32	.095 (2.41)	.500 (12.7)	.045 (1.14)
8705	6-32	.095 (2.41)	.625 (15.9)	.045 (1.14)

CAT. NO.	THREAD	T.L. ± .015 (.38)	S.D. ± .005 (.13)	S.L. ± .010 (.25)	P.D. +0.00, -.016 (-.40)	P.L. ± .015 (.38)
8706	4-40	.125 (3.2)	.078 (2.0)	.171 (4.3)	.078 (2.0)	.078 (2.0)
8707	4-40	.125 (3.2)	.078 (2.0)	.296 (7.5)	.078 (2.0)	.078 (2.0)
8708	4-40	.125 (3.2)	.078 (2.0)	.421 (10.7)	.078 (2.0)	.078 (2.0)
8709	6-32	.218 (5.5)	.095 (2.41)	.187 (4.7)	.095 (2.41)	.093 (2.36)
8710	6-32	.218 (5.5)	.095 (2.41)	.312 (7.9)	.095 (2.41)	.093 (2.36)
8711	6-32	.218 (5.5)	.095 (2.41)	.437 (11.1)	.095 (2.41)	.093 (2.36)

## 4-40

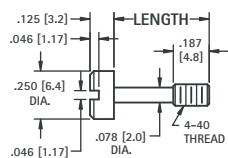

CAT. NO.	LENGTH
2413	.469 (11.9)
2414	.531 (13.4)

## 6-32

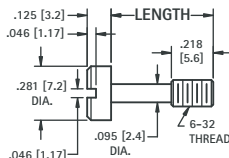
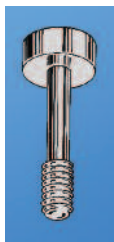

CAT. NO.	LENGTH
2415	.531 (13.5)
2416	.593 (15.1)
2417	.656 (16.7)

## 8-32

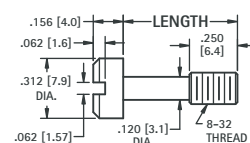
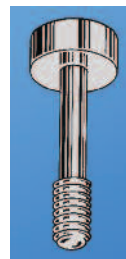

CAT. NO.	LENGTH
2418	.656 (16.7)
2419	.718 (18.2)
2420	.781 (19.8)

# THUMB SCREWS

## STAINLESS

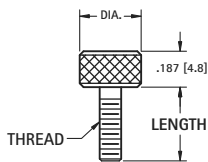

MATERIAL: Stainless Steel

CAT. NO.	LENGTH	THREAD	DIA
2400	.312 (7.9)	4-40	.312 (7.9)
2401	.375 (9.5)		
2402	.437 (11.1)		
2403	.500 (12.7)		
2404	.312 (7.9)	6-32	.312 (7.9)
2405	.375 (9.5)		
2406	.437 (11.1)		
2407	.500 (12.7)		
2408	.375 (9.5)	8-32	.375 (9.5)
2409	.437 (11.1)		
2410	.500 (12.7)		

## BRASS

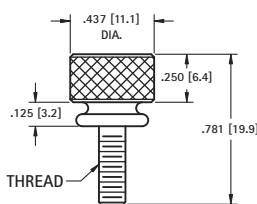

MATERIAL: Brass, Nickel Plate

CAT. NO.	THREAD
1708	6-32
1709	8-32
1710	10-32

## NYLON

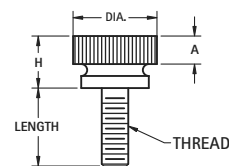

MATERIAL: Nylon 6/6, UL Rated 94V-2

CAT. NO.	LENGTH	THREAD	DIA.	H	A
2500	.250 (6.4)	4-40	.300 (7.6)	.280 (7.1)	.125 (3.2)
2501	.375 (9.5)				
2502	.500 (12.7)				
2503	.250 (6.4)	6-32	.360 (9.1)	.275 (7.0)	.125 (3.2)
2504	.375 (9.5)				
2505	.500 (12.7)				
2506	.250 (6.4)	8-32	.425 (10.8)	.305 (7.7)	.140 (3.6)
2507	.375 (9.5)				
2508	.500 (12.7)				