



Chipsmall Limited consists of a professional team with an average of over 10 year of expertise in the distribution of electronic components. Based in Hongkong, we have already established firm and mutual-benefit business relationships with customers from,Europe,America and south Asia,supplying obsolete and hard-to-find components to meet their specific needs.

With the principle of “Quality Parts,Customers Priority,Honest Operation,and Considerate Service”,our business mainly focus on the distribution of electronic components. Line cards we deal with include Microchip,ALPS,ROHM,Xilinx,Pulse,ON,Everlight and Freescale. Main products comprise IC,Modules,Potentiometer,IC Socket,Relay,Connector.Our parts cover such applications as commercial,industrial, and automotives areas.

We are looking forward to setting up business relationship with you and hope to provide you with the best service and solution. Let us make a better world for our industry!



Contact us

Tel: +86-755-8981 8866 Fax: +86-755-8427 6832

Email & Skype: info@chipsmall.com Web: www.chipsmall.com

Address: A1208, Overseas Decoration Building, #122 Zhenhua RD., Futian, Shenzhen, China



PRODUCT NUMBER
SEE TABLE

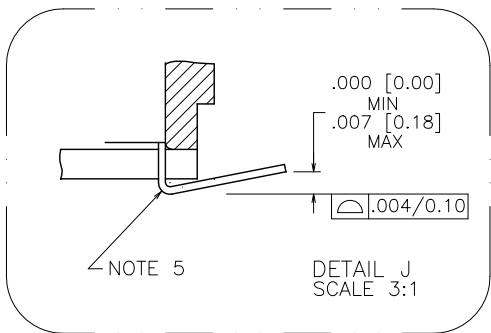
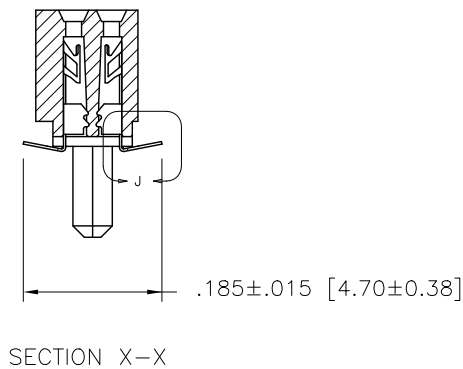
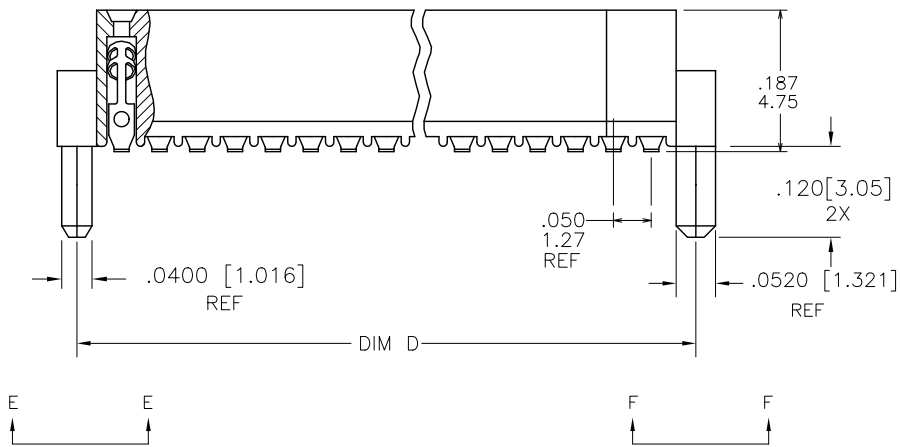
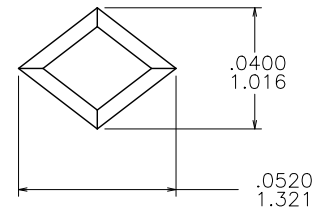
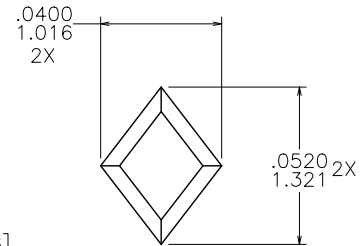
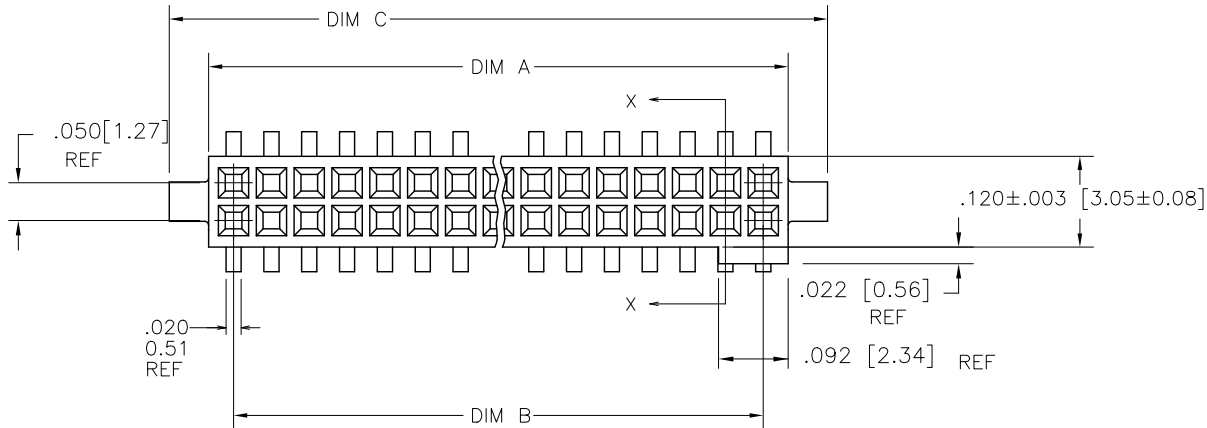

mat'l. code				surface		tolerance		projection		product family	
-				ISO 1302 ✓		ISO 406 ISO 1101				RIB CAGE	
ltr	ecn no	dr	date	tolerances unless otherwise specified						title	
T	M06-0284	ARA	7/27/06	angles	linear	xx ±.01/.3		INCH/MM		.050/1.27cc V.C.C. SURFACE	
U	M07-0053	MHT	1/22/07			xxx ±.005/.13		scale 4:1		MOUNT w/POL. HOLD DOWN	
V	M07-0267	MHT	6/28/07	σ±2'		xxxx ±.0020/.050				dwg no	
W	M07-0345	AGS	7/26/07	dr	J. MUSTARD	3/25/91				sheet 1 of 3 size	
X	M09-0058	CMR	4/06/09	enr	M. HAHN	3/25/91				87471 A3	
Y	N10-0174	YO	6/17/10	chr	G. GINGRICH	3/25/91				type Product Customer Drawing	
AA	ELX-010203	YO	2/8/12	appd	M. HAHN	3/25/91					
sheet	revision	AA	AA	AA							
index	sheet	1	2	3							

PRODUCT NO. NOTE 8	SIZE	DIM A	DIM B	DIM C	DIM D	SPECIAL PACKAGING	TAPE WIDTH
87471-605	2 X 5	.266/6.76	.200/5.08	.370/9.40	.3200/8.128	NOTE 7	24mm
-610	2 X 10	.516/13.11	.450/11.43	.620/15.75	.5700/14.478		
-615	2 X 15	.766/19.46	.700/17.78	.870/22.10	.8200/20.828		
-620	2 X 20	1.016/25.81	.950/24.13	1.120/28.45	1.0700/27.178	NOTE 7	44mm
-625	2 X 25	1.266/32.16	1.200/30.48	1.370/34.80	1.3200/33.528		
-630	2 X 30	1.516/38.51	1.450/36.83	1.620/41.15	1.5700/39.878		
-635	2 X 35	1.766/44.86	1.700/43.18	1.870/47.50	1.8200/46.228		
-640	2 X 40	2.016/51.21	1.950/49.53	2.120/53.85	2.0700/52.578		
-645	2 X 45	2.266/57.56	2.200/55.88	2.370/60.20	2.3200/58.928		
87471-650	2 X 50	2.516/63.91	2.450/62.23	2.620/66.55	2.5700/65.278	NOTE 7	88mm
87471-905	2 X 5	.266/6.76	.200/5.08	.370/9.40	.3200/8.128		
-910	2 X 10	.516/13.11	.450/11.43	.620/15.75	.5700/14.478		
-915	2 X 15	.766/19.46	.700/17.78	.870/22.10	.8200/20.828		
-920	2 X 20	1.016/25.81	.950/24.13	1.120/28.45	1.0700/27.178		
-925	2 X 25	1.266/32.16	1.200/30.48	1.370/34.80	1.3200/33.528		
-930	2 X 30	1.516/38.51	1.450/36.83	1.620/41.15	1.5700/39.878		
-935	2 X 35	1.766/44.86	1.700/43.18	1.870/47.50	1.8200/46.228		
-940	2 X 40	2.016/51.21	1.950/49.53	2.120/53.85	2.0700/52.578		
-945	2 X 45	2.266/57.56	2.200/55.88	2.370/60.20	2.3200/58.928		
87471-950	2 X 50	2.516/63.91	2.450/62.23	2.620/66.55	2.5700/65.278		

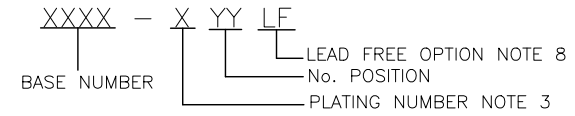

- NOTES :
- HOUSING MATERIAL :
GLASS FILLED THERMOPLASTIC FLAME RETARDANT
PER UL 94-0 COLOR : NATURAL
 - TERMINAL MATERIAL : BeCu
 - TERMINAL PLATING :
-6XXLF 30u"/.76um MIN HARD GOLD OR GXT OVER Ni ON CONTACT ZONES. 100u"/2.54um MIN Sn OVER Ni IN SOLDERING ZONES. OTHERWISE GOLD FLASH OR UNPLATED
-9XXLF 60u"/1.52um MIN HARD GOLD OVER Ni ON CONTACT ZONES. 100u"/2.54um MIN Sn OVER Ni IN SOLDERING ZONES. OTHERWISE GOLD FLASH OR UNPLATED
 - APPLICATION INFORMATION :
 - RECOMMENDED MOUNTING PAD PATTERN IS SHOWN IN FIGURE "A".
 - MATING PINS TO BE .0176/0.447 TO .0181/0.459 THICK.
 - MATING PIN TIPS TO BE IN TRUE POSITION TO MATING GRID WITHIN .008/0.20 DIA.
 - SUGGESTED MATING PIN LENGTH .130/3.30 ±.010/0.25.
 - LEAD TIPS TO BE ABOVE HEEL, UP TO .007/0.18 MAX. COPLANARITY TO BE MEASURED AT LOWEST POINT (HEEL).
 - ADD "CT" TO END OF DASH NUMBER FOR CONNECTOR WITH VACUUM CAP IN TUBE.
 - ADD "TR" TO END OF DASH NUMBER FOR TAPE AND REEL PACKAGED WITH CAP. TOOLED ONLY FOR NOTED
 - ADD "LF" SUFFIX AT THE END OF PART NUMBER FOR LEAD FREE OPTION.
 - THIS PRODUCT MEETS EUROPEAN UNION DIRECTIVES AND OTHER COUNTRY REGULATION AS DESCRIBED IN GS-22-008.
 - THE HOUSING WILL WITHSTAND EXPOSURE TO 260°C PEAK TEMPERATURE FOR 20 SECONDS IN A CONVECTION INFRA-RED OR VAPOR PHASE REFLOW OVEN. SEE APPLICATION NOTES/PROCEDURES IF THEY ARE AVAILABLE.
 - PRODUCT SPECIFICATION PER BUS-12-087.

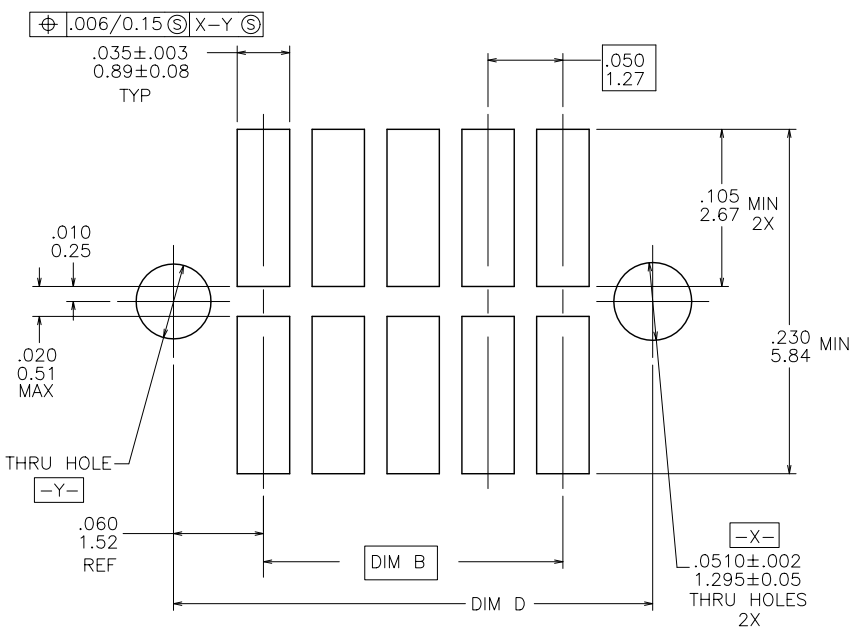

FIGURE A
RECOMMENDED
P.C.B. LAYOUT

mat'l. code -		surface ISO 1302 ✓		tolerance ISO 406 ISO 1101		projection INCH/MM		product family RIB CAGE	
ltr	ecn	no	dr	date		tolerances unless otherwise specified		title	
AA						angles	linear	.050/1.27cc V.C.C. SURFACE MOUNT w/POL. HOLD DOWN	
						σ±2'	xxx ±.005/.13	scale 8:1	
						dr	J. MUSTARD	3/25/91	
						enr	M. HAHN	3/25/91	
						chr	G. GINGRICH	3/25/91	
						appd	M. HAHN	3/25/91	
sheet index		revision sheet						dwg no 87471	
								sheet 2 of 3 size A3	
								type Product Customer Drawing	

