



Chipsmall Limited consists of a professional team with an average of over 10 year of expertise in the distribution of electronic components. Based in Hongkong, we have already established firm and mutual-benefit business relationships with customers from,Europe,America and south Asia,supplying obsolete and hard-to-find components to meet their specific needs.

With the principle of “Quality Parts,Customers Priority,Honest Operation,and Considerate Service”,our business mainly focus on the distribution of electronic components. Line cards we deal with include Microchip,ALPS,ROHM,Xilinx,Pulse,ON,Everlight and Freescale. Main products comprise IC,Modules,Potentiometer,IC Socket,Relay,Connector.Our parts cover such applications as commercial,industrial, and automotives areas.

We are looking forward to setting up business relationship with you and hope to provide you with the best service and solution. Let us make a better world for our industry!



Contact us

Tel: +86-755-8981 8866 Fax: +86-755-8427 6832

Email & Skype: info@chipsmall.com Web: www.chipsmall.com

Address: A1208, Overseas Decoration Building, #122 Zhenhua RD., Futian, Shenzhen, China



THIS DRAWING IS UNPUBLISHED. RELEASED FOR PUBLICATION
 © COPYRIGHT 19 BY AMP INCORPORATED. ALL INTERNATIONAL RIGHTS RESERVED.

MOD	LOC	DIST	P	F	ZONE	LTR	DESCRIPTION	DATE	APPD
30	AD	39				A	REDRAWN	8-10-88	-
						B	REV PER ECN AR2366	JPG 4-7-89	-
						C	REV LOC & DIST AD-4171	3-90	BF
						D	REV PER 0010-0485-96	4-19-86	PS
						E	REV PER 0310-0098-97	3-13-97	JS

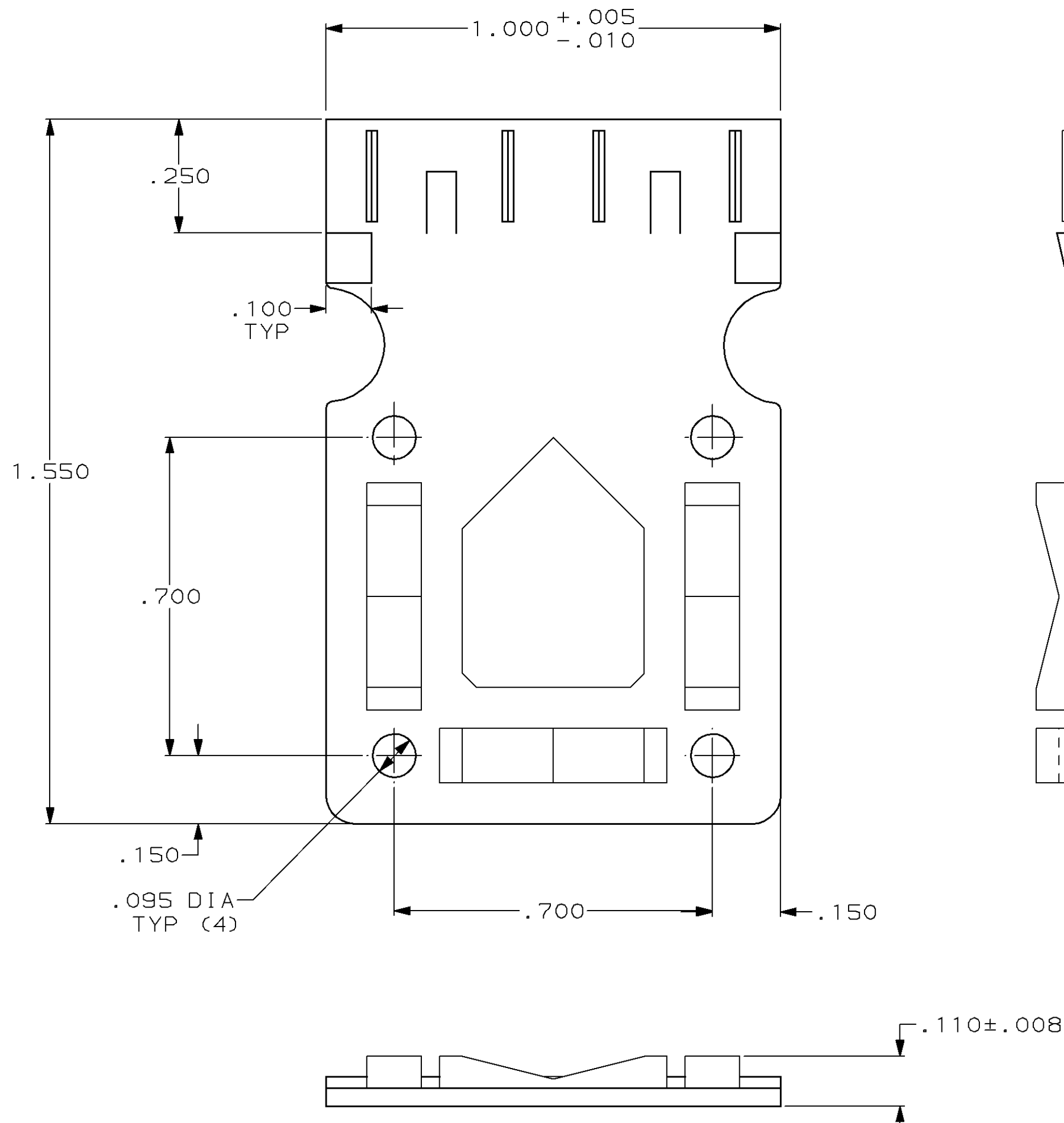

DO NOT SCALE PRINT. UNLESS SPECIFIED DIMENSIONS IN INCHES TOLERANCES ON:		DR 8-3-88 D KEITZER		87710-1	
2 PLC DEC ± -		CHK 8-15-88 S BEAM		PART NO	
3 PLC DEC ± .005		APPD 8-15-88 S BEAM		AMP INCORPORATED Harrisburg, Pa. 17105	
ANGLES ± 0°30'		APPD 8-15-88 J SCHIEFER		NAME	
MATERIAL		PRODUCT SPEC		STRAIN RELIEF, MOD IVCONNECTOR	
BLACK THERMOPLASTIC		APPLICATION SPEC		SIZE	FSCM NO
FINISH		WEIGHT		C	00779
				SCALE	DRAWING NO
				4:1	87710
					SHEET 1 OF 1