



Chipsmall Limited consists of a professional team with an average of over 10 year of expertise in the distribution of electronic components. Based in Hongkong, we have already established firm and mutual-benefit business relationships with customers from,Europe,America and south Asia,supplying obsolete and hard-to-find components to meet their specific needs.

With the principle of “Quality Parts,Customers Priority,Honest Operation,and Considerate Service”,our business mainly focus on the distribution of electronic components. Line cards we deal with include Microchip,ALPS,ROHM,Xilinx,Pulse,ON,Everlight and Freescale. Main products comprise IC,Modules,Potentiometer,IC Socket,Relay,Connector.Our parts cover such applications as commercial,industrial, and automotives areas.

We are looking forward to setting up business relationship with you and hope to provide you with the best service and solution. Let us make a better world for our industry!



Contact us

Tel: +86-755-8981 8866 Fax: +86-755-8427 6832

Email & Skype: info@chipsmall.com Web: www.chipsmall.com

Address: A1208, Overseas Decoration Building, #122 Zhenhua RD., Futian, Shenzhen, China



0040 AC Inlet with 5 x 20mm Fuseholder



Note: Not recommended for new designs. Refer to KEA (pg. 36), GSF (pg. 13/14) or 6220 (pg. 35)



Standards: UL 498; CSA C22.2/182.3; DIN/VDE 0625; SEMKO 9320; IEC 320/C14/C18; EN 60320

- Power entry module with 1-pole or 2-pole fuseholder
- For "cold" connections 70° C, Protection Class I or II
- Screw mount from front
- Single or double pole shocksafe fuseholder according to IEC 65/VDE 0860 for 5 x 20mm fuses
- Quick-connect terminals .187" x .032" (4.8 x 0.8mm)
- 0.5 Nm torque required for M3 screws
- Max. power dissipation 2.4 watts (2-pole fusing) according to IEC 127-6. For additional values P_v in function of T_{amb} , see page 5
- For materials, options and accessories please see page 30
- For inlet with piggy-back fuse clips see GSF, page 13-14

UL recognition	10A/250V	File #E93617
CSA certification	10A/250V	File #LR38456
VDE approval	6A/250V	File #19397
SEMKO approval	10A/250V	File numbers on request
SEV approval	10A/250V	

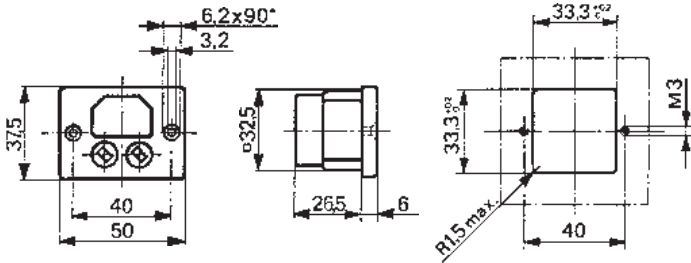

page 102.

Series 0040			
Class I	Class II	Color/Fusing	Terminal Type
0040.5000.2	0040.5015	black/2-pole	solder
8843-2.SP.FL.4/3.60	8842-2.SP.FL.4/3.60		.138" x .032" (3.5 x 0.8mm)
0040.5001.2		grey/2-pole	quick-connect
8843-2.SP.FL.4/3.64			.187" x .032" (4.8 x 0.8mm)
0040.5012		black/1-pole	quick-connect
8843-2.SP.U.FL.4/3.60			.250" x .032" (6.3 x 0.8mm)

8843 AC Inlet • Interchangeable Fuseholders for 1/4 x 1 1/4" or 5 x 20mm Fuses



Standards: UL 498; CSA C22.2/182.3; DIN/VDE 0625; SEMKO 9320; IEC 320/C14; EN 60320. U.S. Patented.

- Power entry module with 1-pole or 2-pole fuseholder
- For "cold" connections 70° C, Protection Class I.
- Screw mount from front or rear, or snap-in mount from front (0.8-3.0mm panel thickness)
- Single or double pole shocksafe fuseholder according to IEC 65/VDE 0860 for 1/4 x 1 1/4" or 5 x 20mm fuses
- Quick-connect terminals .187" x .032" (4.8 x 0.8mm) or solder .138 x .032" (3.0 x 0.8mm).
- 0.5 Nm torque required for M3 screws for screw-on type
- Max. power dissipation 5.5 watts (2 pole fusing, unfiltered) according to IEC 127-6. For additional values P_v in function of T_{amb} , see page 6
- For materials, options and accessories please see page 30
- For 8843 with line filter, please see 8843 on page 59
- For inlet with piggy-back fuse clips see GSF, page 13-14

UL recognition	10A/250V	File #E96317
CSA certification	10A/250V	File #LR38456
VDE approval	10A/250V	File #3157, expert report
SEMKO approval	10A/250V	File numbers on request
SEV approval	10A/250V	

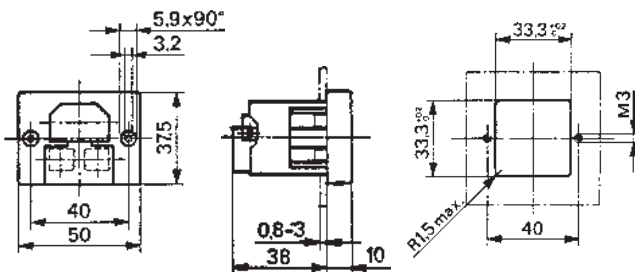

Order Numbers (type) Note: Casing and fuseholders must be ordered separately. To order fuses, please see page 102.

Casing			
1-pole fusing	2-pole fusing	Terminals	Mounting
8843.0351 (8843-351.60)	8843.0361 (8843-361.60)	Solder .138" X .032" (3.0 x 0.8mm)	Screw-on
8843.0353 (8843-353.60)	8843.0363 (8843-363.60)	Quick-connect .187" x .032" (4.8 x 0.8mm)	Screw-on
8843.0451 (8843-451.60)	8843.0461 (8843-461.60)	Solder .138" X .032" (3.0 x 0.8mm)	Snap-in, 0.8-3.0mm panel thickness
8843.0453 (8843-453.60)	8843.0463 (8843-463.60)	Quick-connect .187" x .032" (4.8 x 0.8mm)	Snap-in, 0.8-3.0mm panel thickness

Fuseholder inserts* (2 inserts must be ordered for 2-pole fusing)	
8843.0901	1/4 x 1 1/4" (6.3x32mm)
8843.0902	for 5 x 20mm
8843.902.60	