



Chipsmall Limited consists of a professional team with an average of over 10 year of expertise in the distribution of electronic components. Based in Hongkong, we have already established firm and mutual-benefit business relationships with customers from,Europe,America and south Asia,supplying obsolete and hard-to-find components to meet their specific needs.

With the principle of “Quality Parts,Customers Priority,Honest Operation,and Considerate Service”,our business mainly focus on the distribution of electronic components. Line cards we deal with include Microchip,ALPS,ROHM,Xilinx,Pulse,ON,Everlight and Freescale. Main products comprise IC,Modules,Potentiometer,IC Socket,Relay,Connector.Our parts cover such applications as commercial,industrial, and automotives areas.

We are looking forward to setting up business relationship with you and hope to provide you with the best service and solution. Let us make a better world for our industry!



Contact us

Tel: +86-755-8981 8866 Fax: +86-755-8427 6832

Email & Skype: info@chipsmall.com Web: www.chipsmall.com

Address: A1208, Overseas Decoration Building, #122 Zhenhua RD., Futian, Shenzhen, China



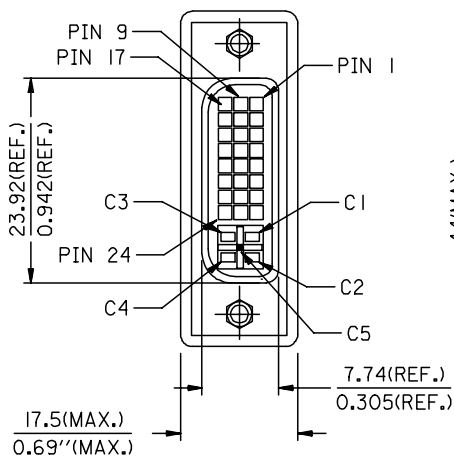

DVI-A(F)

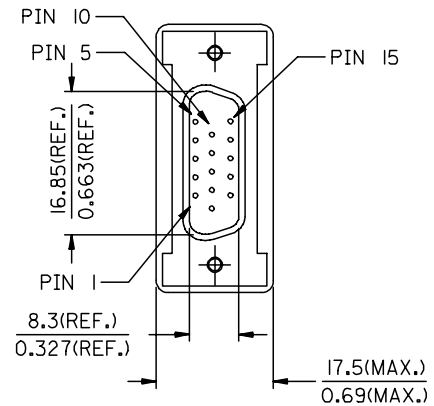
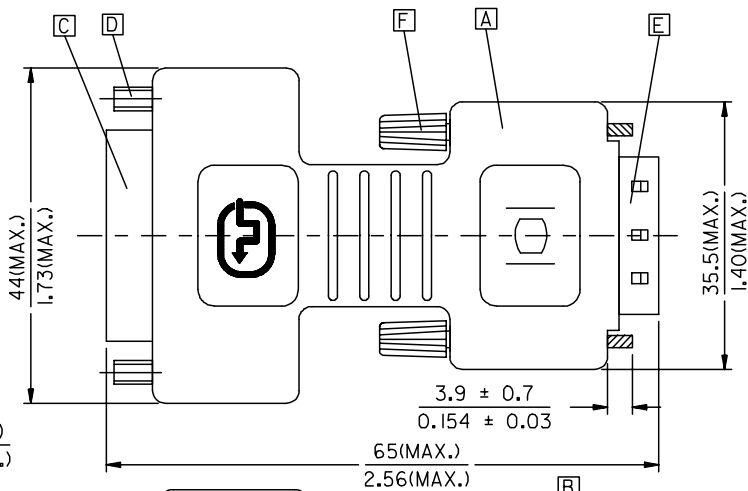

VGA(M)

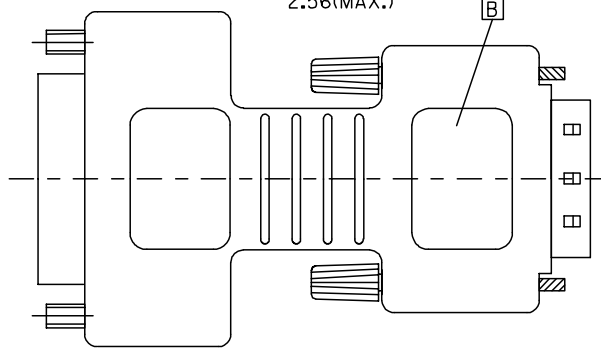

BACK SIDE

ENTER DESCRIPTION EC NO: DG2006-0186 DRWN: PDAI CHKD: APPR: TKAN 2006/03/09 2006/03/09 2006/03/10	QUALITY SYMBOLS ▽=0 □=0	GENERAL TOLERANCES (UNLESS SPECIFIED)		DIMENSION STYLE MM/IN		SCALE ---	DESIGN UNITS METRIC	THIRD ANGLE PROJECTION															
		<table border="1"> <thead> <tr> <th></th> <th>mm</th> <th>INCH</th> </tr> </thead> <tbody> <tr> <td>4 PLACES</td> <td>±---</td> <td>±---</td> </tr> <tr> <td>3 PLACES</td> <td>±---</td> <td>±---</td> </tr> <tr> <td>2 PLACES</td> <td>±---</td> <td>±---</td> </tr> <tr> <td>1 PLACE</td> <td>±---</td> <td>±---</td> </tr> </tbody> </table>		mm	INCH	4 PLACES	±---	±---	3 PLACES	±---	±---	2 PLACES	±---	±---	1 PLACE	±---	±---	DRAWN BY PDAI	DATE 2006/03/07	TITLE DVI_A(F)-VGA(M) ADAPTER			
		mm	INCH																				
	4 PLACES	±---	±---																				
	3 PLACES	±---	±---																				
2 PLACES	±---	±---																					
1 PLACE	±---	±---																					
	ANGULAR ±---°	CHECKED BY ZXDENG	DATE 2006/03/07	APPROVED BY BORON																			
	DRAFT WHERE APPLICABLE MUST REMAIN WITHIN DIMENSIONS	MATERIAL NO. 88741-9100	DOCUMENT NO. SD-88741-012	MOLEX INCORPORATED		SHEET NO. 1 OF 2																	
		THIS DRAWING CONTAINS INFORMATION THAT IS PROPRIETARY TO MOLEX INCORPORATED AND SHOULD NOT BE USED WITHOUT WRITTEN PERMISSION																					

NOTE: 1. ADAPTOR COVER MATERIAL

- 1.1 UL GRADE ABS
- 1.2 COLOR: PANTONE 661C
- 2. DVI CONNCTOR SPECIFICATION
 - 2.1 REFER TO PRODUCT SPEC. PS74320-0001.
 - 2.2 CONTACT PLATING: AU FLASH.
- 3. ELECTRICAL PERFORMANCE
 - 3.1 INSULATION RESISANCE: 20 M Ohms Min
 - 3.2 DIELECTRIC STRENGTH: 300V DC FOR 10 MILLISECONDS.
 - 3.3 IMPEDANCE: 75 ± 10% Ohms ON THE CO-AXIAL WIRES.
- 4. ADAPTOR SPECIFICATION
 - 4.1 REFER TO PRODUCT SPEC. PS88741-8700.
- 5. THIS PRODUCT MUST MEET MX RoHS COMPLIANCE.

6. CONNECTION DIAGRAM

SHIELD	SHIELD	GROUND
C 5	PIN R6,G7,B8	ANLOG GROUND
C 4	PIN 13	HORIZONTAL SYNC
C 3	PIN 3	ANLOG
C 2	PIN 2	ANLOG
C 1	PIN 1	ANLOG
PIN 15	PIN 5,10	GROUND(+5V & HV SYNC)
PIN 14,16	PIN 9	POWER +5V/HOT PLUG DETECT
PIN 8	PIN 14	VERTICAL SYNC
PIN 7	PIN 12	DDC DATA
PIN 6	PIN 15	DDC CLOCK
DVI-A(F)	VGA(M)	CABLE FUNCTION

7. MATERIAL LIST

ITEM	DESCRIPTION
F	ADAPTER SCREW 887806008
E	VGA D-SUB CONNECTOR
D	DVI_A FEMALE SCREW 887806066 887899320
C	DVI_A FEMALE CONNECTOR 743206001
B	DVI_A(F) TO VGA(M) ADAPTER BOTTOM COVER 887899313
A	DVI_A(F) TO VGA(M) ADAPTER TOP COVER 887899300

ENTER DESCRIPTION EC NO: DG2006-0186 DRWN: PDAI CHKD: APPR: TKAN	2006/03/09 2006/03/09 2006/03/10	QUALITY SYMBOLS = 0 = 0	GENERAL TOLERANCES (UNLESS SPECIFIED)		DIMENSION STYLE MM/IN		SCALE ---	DESIGN UNITS METRIC	THIRD ANGLE PROJECTION
	4 PLACES ± --- mm ± --- INCH		DRAWN BY PDAI	DATE 2006/03/07	TITLE DVI_A(F)-VGA(M) ADAPTER				
	3 PLACES ± --- mm ± --- INCH		CHECKED BY ZXDENG	DATE 2006/03/07	MOLEX INCORPORATED				
	2 PLACES ± --- mm ± --- INCH		APPROVED BY BORON	DATE 2006/03/07	MATERIAL NO. 88741-9100	DOCUMENT NO. SD-88741-012	SHEET NO. 2 OF 2		
1 PLACE ± --- mm ± --- INCH	ANGULAR ± --- °		DRAFT WHERE APPLICABLE MUST REMAIN WITHIN DIMENSIONS						
SIZE 4	THIS DRAWING CONTAINS INFORMATION THAT IS PROPRIETARY TO MOLEX INCORPORATED AND SHOULD NOT BE USED WITHOUT WRITTEN PERMISSION								