



Chipsmall Limited consists of a professional team with an average of over 10 year of expertise in the distribution of electronic components. Based in Hongkong, we have already established firm and mutual-benefit business relationships with customers from,Europe,America and south Asia,supplying obsolete and hard-to-find components to meet their specific needs.

With the principle of “Quality Parts,Customers Priority,Honest Operation,and Considerate Service”,our business mainly focus on the distribution of electronic components. Line cards we deal with include Microchip,ALPS,ROHM,Xilinx,Pulse,ON,Everlight and Freescale. Main products comprise IC,Modules,Potentiometer,IC Socket,Relay,Connector.Our parts cover such applications as commercial,industrial, and automotives areas.

We are looking forward to setting up business relationship with you and hope to provide you with the best service and solution. Let us make a better world for our industry!



Contact us

Tel: +86-755-8981 8866 Fax: +86-755-8427 6832

Email & Skype: info@chipsmall.com Web: www.chipsmall.com

Address: A1208, Overseas Decoration Building, #122 Zhenhua RD., Futian, Shenzhen, China



PRODUCT NO

88914-0XY

NOTE 5

PRODUCT NUMBER	BACKPLANE THICKNESS
	MM/IN.
88914-011	2.31-3.10/0.091-0.122
88914-012	3.10-3.89/0.122-0.153
88914-013	3.89-4.67/0.153/0.184
88914-014	4.67-5.46/0.184-0.215
88914-015	5.46-6.25/0.215-0.246
88914-016	6.25-7.06/0.246-0.278
88914-017	7.06-8.00/0.278-0.315
88914-018	8.00-11.00/0.315-0.433

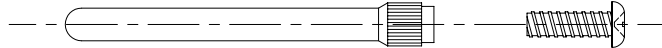

NOTES:

- ①. PIN MATERIAL:
P/N 88918-002, STAINLESS STEEL
SCREW INFORMATION:
#1-72 PHILLIPS PAN HEAD STAINLESS STEEL
2. EACH KIT INCLUDES ONE PIN AND ONE SCREW
3. SEE PAGE 2 FOR AN APPLICATION EXAMPLE
- ④. ADD "LF" SUFFIX AT THE END OF PART NUMBER FOR LEAD FREE OPTION
5. THIS PRODUCT MEETS EUROPEAN UNION DIRECTIVES AND OTHER COUNTRY REGULATION AS DESCRIBED IN GS-22-008.



Copyright FCI

mat'l. code				surface ISO 1302 <input checked="" type="checkbox"/>		tolerance ISO 406 ISO 1101		projection 		product family METRAL (tm)	
ltr				ecn no		dr		date		tolerances unless otherwise specified	
B	v51387	SAR	1/10/96	angles	linear	.0±.3				title KEYING PIN KIT	
C	v71522	MDF	10/27/97			.00±.13		scale 1:1			
D	v81338	MDF	7/22/98	0'±2'		.000±.0051					
E	v91495	MDF	7/14/99	dr	STU STONER	02/04/93				dwg no 88914	
F	v02390	JRW	10/4/00	enfr	R.DOUTRICH	02/04/93				sheet 1 of 2 size A3	
G	M06-0191	MHT	5/22/06	chr	STU STONER	02/04/93				type Product Customer Drawing	
sheet index		revision		G	G						
		sheet		1	2						

form: A3

APPLICATION EXAMPLE

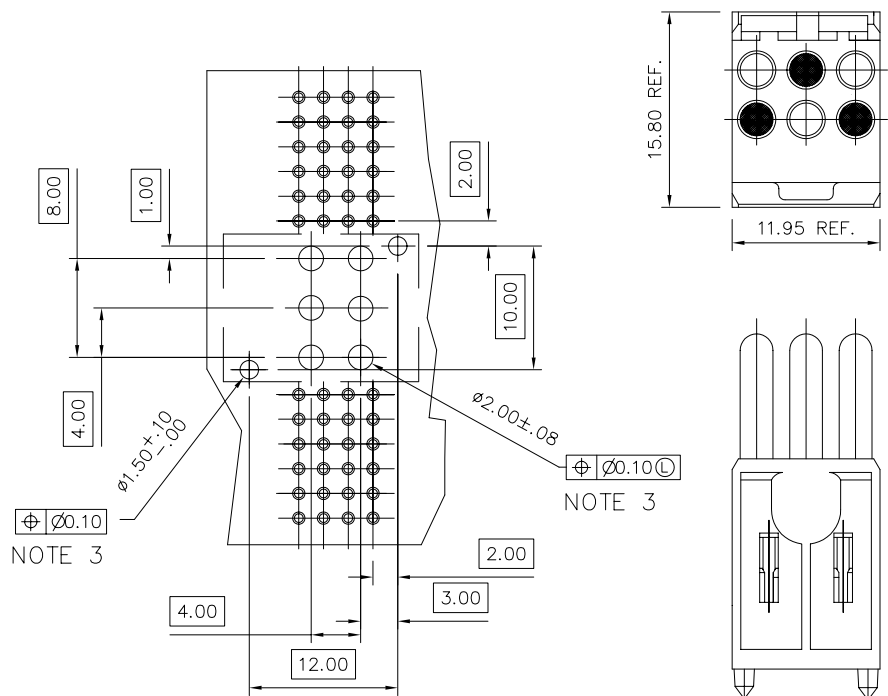

RECOMMENDED HOLE PATTERN
COMPONENT SIDE SHOWN
(2MM SIGNAL HOLE PATTERN)
(SHOWN FOR REFERENCE ONLY)

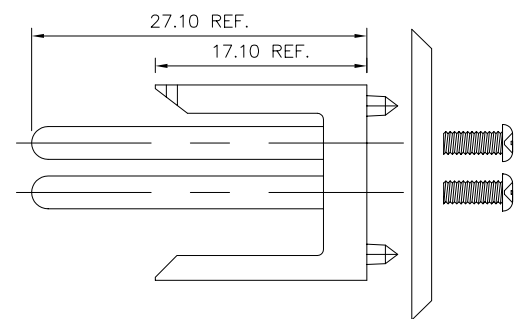
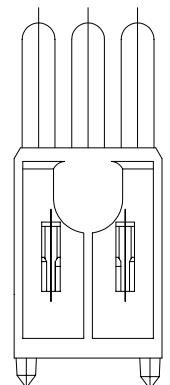
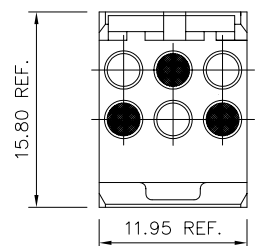

NOTES:

1. HEADER HOUSING (P.N. 88913-101) SHOWN FOR CLARITY AND DOES NOT COME WITH KEYING PIN KITS.
2. KEYING COMBINATION SHOWN WILL MATE TO RECEPTACLE 88916-X06. LOADED PIN POSITIONS ARE SHOWN SHADED.
- ③. INDICATED HOLES ARE UNPLATED



FCIconnect.com

Copyright FCI

mat'l. code		surface ISO 1302 ✓		tolerance ISO 406 ISO 1101		projection MM		product family METRAL (tm)	
ltr		ecn no dr		date		tolerances unless otherwise specified		title	
G						.0±.3 .00±.13 .000±.0051		KEYING PIN KIT	
				0'±2'		scale 1:1		sheet 2 of 2 size	
				dr		STU STONER 02/04/93		dwg no	
				enr		R.DOUTRICH 02/04/93		88914	
				chr		STU STONER 02/04/93		A3	
				appd		STU STONER 02/04/93		type Product Customer Drawing	
sheet index		revision sheet							