



Chipsmall Limited consists of a professional team with an average of over 10 year of expertise in the distribution of electronic components. Based in Hongkong, we have already established firm and mutual-benefit business relationships with customers from,Europe,America and south Asia,supplying obsolete and hard-to-find components to meet their specific needs.

With the principle of "Quality Parts,Customers Priority,Honest Operation,and Considerate Service",our business mainly focus on the distribution of electronic components. Line cards we deal with include Microchip,ALPS,ROHM,Xilinx,Pulse,ON,Everlight and Freescale. Main products comprise IC,Modules,Potentiometer,IC Socket,Relay,Connector.Our parts cover such applications as commercial,industrial, and automotives areas.

We are looking forward to setting up business relationship with you and hope to provide you with the best service and solution. Let us make a better world for our industry!



Contact us

Tel: +86-755-8981 8866 Fax: +86-755-8427 6832

Email & Skype: info@chipsmall.com Web: www.chipsmall.com

Address: A1208, Overseas Decoration Building, #122 Zhenhua RD., Futian, Shenzhen, China



PRODUCT NUMBER	REMARKS
88973-101LF	SOLDER TO BOARD
88973-111LF	PRESS FIT

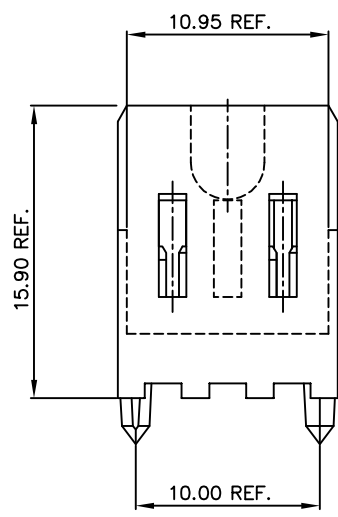
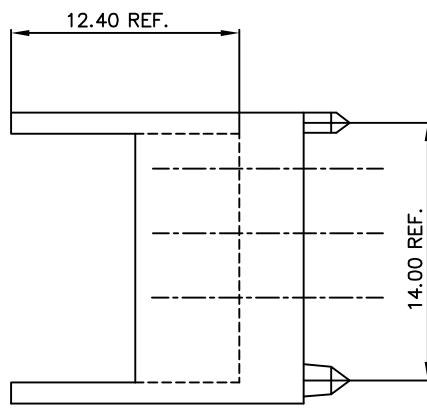
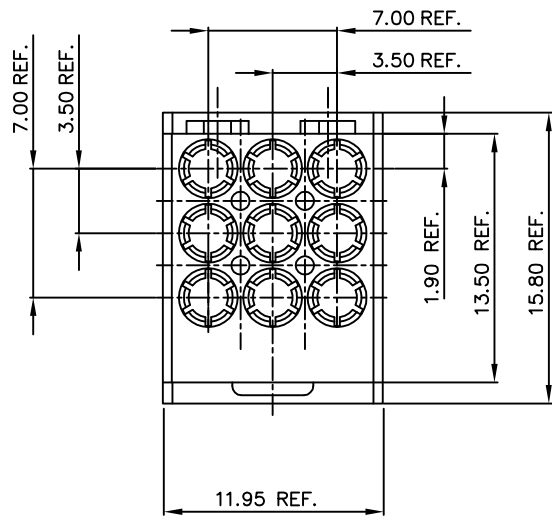

These holes are required when a shroud is used

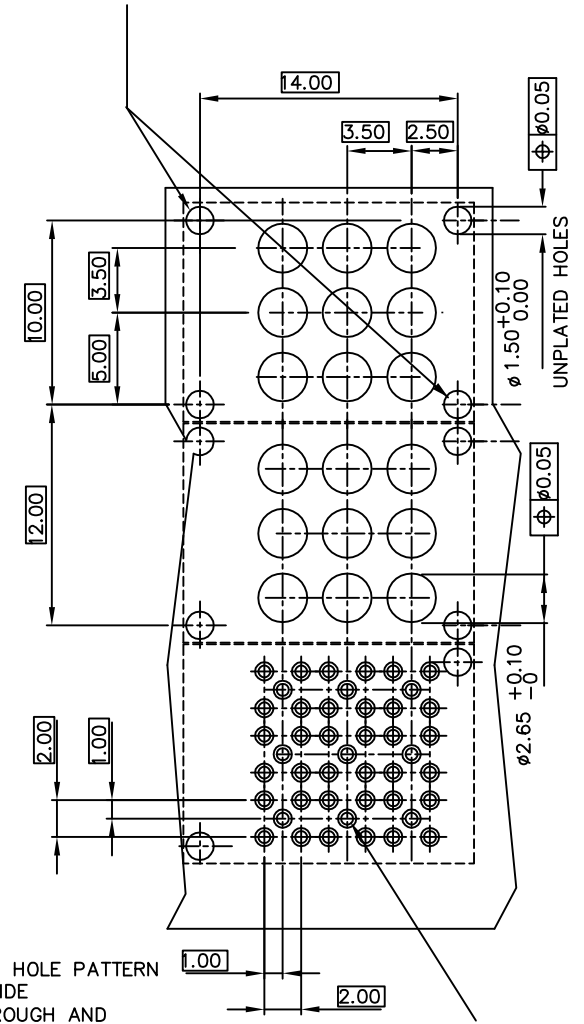

RECOMMENDED HOLE PATTERN
COMPONENT SIDE
FOR FEED THROUGH AND
SOLDER TO BOARD.

- NOTES:
- MATERIAL:
THERMOPL. POLYESTER 30% GLASS
FLAME RETARDANT ACC. UL 94-V0
COLOR NATURAL.
 - WHEN USING THIS PRODUCT IN A
STRAIGHT TO BOARD APPLICATION
THE FOLLOWING MUST BE TAKEN
INTO ACCOUNT:
-101LF HOUSING IS TO BE USED
FOR THE SOLDER TO BOARD
INSERT 88980-00ZLF.
-111LF HOUSING IS TO BE USED
FOR THE PRESS FIT TO BOARD
INSERT 88978-001LF.

- THIS PRODUCT MEETS EUROPEAN UNION DIRECTIVES AND OTHER
COUNTRY REGULATIONS AS DESCRIBED IN GS-22-008.
- THE HOUSING WILL WITHSTAND EXPOSURE TO 260 DEGREE PEAK
TEMPERATURE FOR 10 SECONDS IN A WAVE SOLDER APPLICATION.
WITH A 1.6mm MINIMUM THICK CIRCUIT BOARD.

mat'l. code		tolerances unless otherwise specified		CUSTOMER COPY		ELECTRONICS	
SEE NOTE 1				F C I		www.fciconnect.com	
ltr	ecm no	dr	date	linear	projection	title	
A	H10348	DAN	920424			HEADER MINI COAX	
B	H20755	DAN	921124			STRAIGHT 3x3	
C	H60040	RVI	960119	angles		product family	TRIAL(tm)
D	H70112	RMA	970218	dr	D Andrews	920424	code
E	H90476	DOB	990816	leng	D Andrews	920424	213
F	pc05-0438	CLU	051102	chr	P Schalk	920424	sheet
				app	H Cooljmans	960119	1 of 1
sheet	revision	F					
index	sheet	1					

All rights are reserved. Reproduction or use in other products is not permitted without written authority from the proprietor. Property of F C I Inc.