



Chipsmall Limited consists of a professional team with an average of over 10 year of expertise in the distribution of electronic components. Based in Hongkong, we have already established firm and mutual-benefit business relationships with customers from,Europe,America and south Asia,supplying obsolete and hard-to-find components to meet their specific needs.

With the principle of “Quality Parts,Customers Priority,Honest Operation,and Considerate Service”,our business mainly focus on the distribution of electronic components. Line cards we deal with include Microchip,ALPS,ROHM,Xilinx,Pulse,ON,Everlight and Freescale. Main products comprise IC,Modules,Potentiometer,IC Socket,Relay,Connector.Our parts cover such applications as commercial,industrial, and automotives areas.

We are looking forward to setting up business relationship with you and hope to provide you with the best service and solution. Let us make a better world for our industry!



Contact us

Tel: +86-755-8981 8866 Fax: +86-755-8427 6832

Email & Skype: info@chipsmall.com Web: www.chipsmall.com

Address: A1208, Overseas Decoration Building, #122 Zhenhua RD., Futian, Shenzhen, China



PRODUCT NUMBER

89361-YXXSLF

- LEAD FREE, RoHs COMPLIANT
SEE NOTE 4
- STRAIN RELIEF OPTION, NOTE 5.
- TOTAL NB OF POSITIONS, SHEET 2.
- FEATURES, SHEET 2.

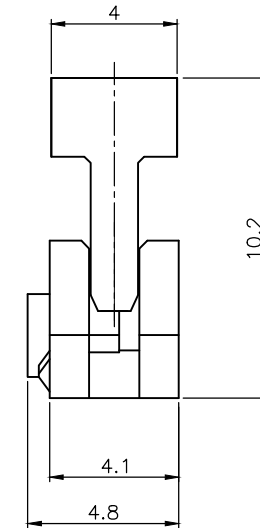
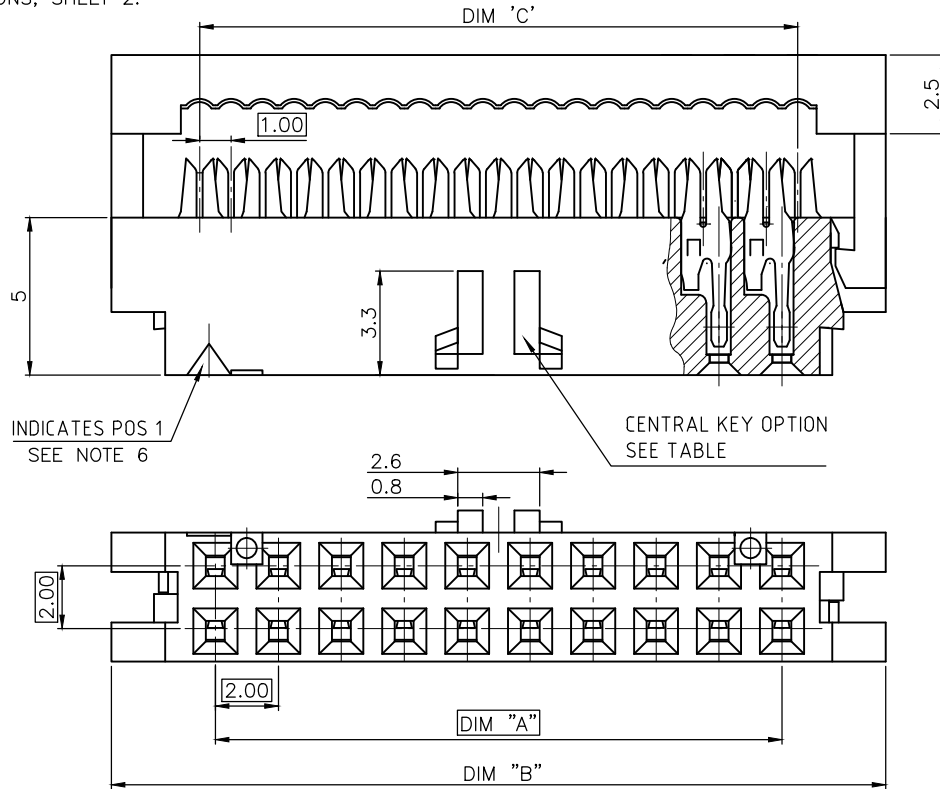

VIEW WITHOUT COVER



Copyright FCI

mat'l. code SEE NOTE		surface ISO 1302 <input checked="" type="checkbox"/> ISO 406 ISO 1101		projection 	product family MINITEK	
ltr	ecn no	dr	date	tolerances unless otherwise specified		title
K	F06-0211	LMU	06.07.03	angles	.0±.3	2.00mm IDC 0.2µm Au
L	F07-0215	LMU	07.06.12	linear	.00±.13	
M	F08-0218	JCO	08.09.09	0°±x'	.000±.05	scale 1:1
N	F09-0081	JCO	09.08.27	dr	L.MULIN	07.03.20
P	F-21434	BVE	15.07.16	enr	J.COMPAGNON	07.03.20
				chr		
				appd	JM.C	07.03.20
sheet index	revision sheet	P	P			
		1	2			



dwg no 89361 sheet 1 of 2 size A3
type Product Customer Drawing

PRODUCT SIZE	TOTAL NB OF POS	DIM "A"	DIM "B"	DIM "C"	STRAIN RELIEF OPTION
89361-X06LF	2x3	4	10.6	5	YES
-X08LF	2x4	6	12.6	7	YES
-X10LF	2x5	8	14.6	9	YES
-X12LF	2x6	10	16.6	11	YES
-X14LF	2x7	12	18.6	13	YES
-X16LF	2x8	14	20.6	15	YES
-X18LF	2x9	16	22.6	17	YES
-X20LF	2x10	18	24.6	19	YES
-X22LF	2x11	20	26.6	21	NOT TOOLED
-X24LF	2x12	22	28.6	23	YES
-X26LF	2x13	24	30.6	25	YES
-X28LF	2x14	26	32.6	27	NOT TOOLED
-X30LF	2x15	28	34.6	29	YES
-X34LF	2x17	32	38.6	33	YES
-X36LF	2x18	34	40.6	35	NOT TOOLED
-X40LF	2x20	38	44.6	39	YES
-X44LF	2x22	42	48.6	43	YES
-X48LF	2x24	46	52.6	47	YES
-X50LF	2x25	48	54.6	49	YES

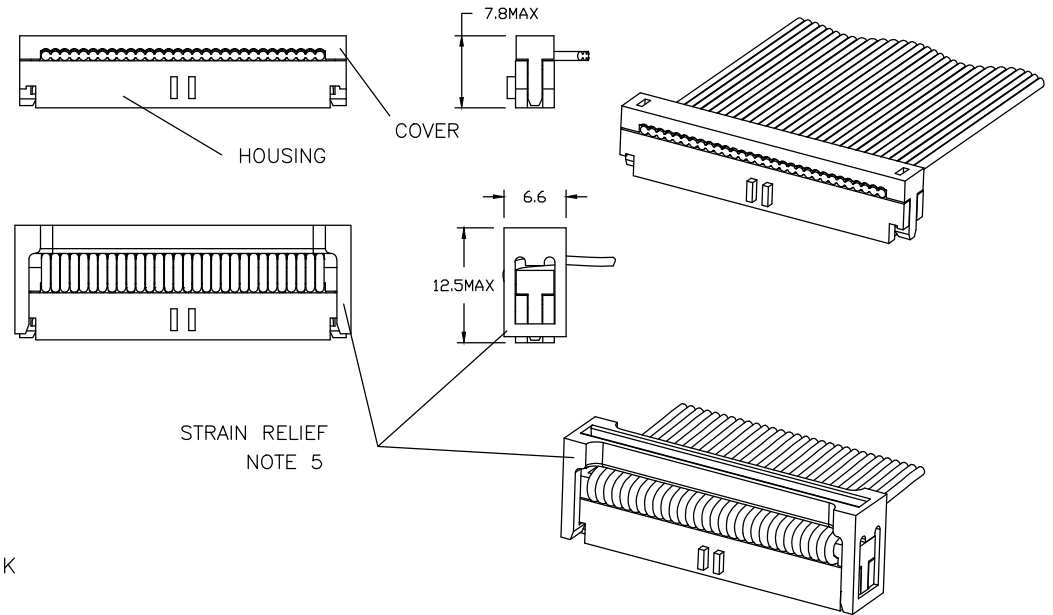

NOTES :

- MATERIAL : TERMINAL PHOSPHORE BRONZE
BASE AND COVER : PBT GLASSFILLED UL 94V-0 BLACK
- PLATING : GOLD 0.2µm Au MIN ON CONTACT AREA
NICKEL 1.27µm MIN UNDERPLATING ALL OVER
- RECOMMENDED CABLE SIZE : AWG28, STRANDED
- THIS PRODUCT MEETS EUROPEAN UNION DIRECTIVES AND OTHER COUNTRY REGULATIONS AS PER GS-22-008.
PACKAGING SPECIFICATION AS PER GS-14-920.
- S= STRAIN RELIEF ACCESSORY, SEE TABLE FOR AVAILABILITY,
OMIT LETTER FROM PARTNUMBER IF NOT APPLICABLE.
- SIZE 2 X 3 AND 2 X 4 WILL NOT HAVE POSITION #1 TRIANGLE SHOWING

				AVAILABILITY
89361-7XX			○	FROM 2X3 POS UP TO 2X17
89361-3XX		○		FROM 2x17 POS UP TO 2x25
89361-1XX	○			FROM 2x3 POS UP TO 2x25
PRODUCT CODE	WITHOUT CENTRAL KEY	WITH CENTRAL KEY	WITH CENTRAL KEY AND FRICTION LATCH BUMP	

mat'l. code SEE NOTE		surface ISO 1302 ✓	tolerance ISO 406 ISO 1101	projection mm	product family
ltr	ecn no dr date	tolerances unless otherwise specified		mm	title 2.00mm IDC 0.2µm Au
K	F06-0211LMU 06.07.03	angles	.0±.3		
L	F07-0215LMU 07.06.12	linear	.00±.13	scale 1:1	dwg no sheet 2 of 2 size 89361 A3
M	F08-0218JCO 08.09.09	0°±'	.000±.05		
N	F09-0081JCO 09.08.27	dr	L.MULIN 07.03.20		type Product Customer Drawing
P	F-21434 BVE 15.07.16	chr	J.COMPAGNON 07.03.20		
		appd	JM.C 07.03.20		
sheet index	revision sheet				