



Chipsmall Limited consists of a professional team with an average of over 10 year of expertise in the distribution of electronic components. Based in Hongkong, we have already established firm and mutual-benefit business relationships with customers from,Europe,America and south Asia,supplying obsolete and hard-to-find components to meet their specific needs.

With the principle of “Quality Parts,Customers Priority,Honest Operation,and Considerate Service”,our business mainly focus on the distribution of electronic components. Line cards we deal with include Microchip,ALPS,ROHM,Xilinx,Pulse,ON,Everlight and Freescale. Main products comprise IC,Modules,Potentiometer,IC Socket,Relay,Connector.Our parts cover such applications as commercial,industrial, and automotives areas.

We are looking forward to setting up business relationship with you and hope to provide you with the best service and solution. Let us make a better world for our industry!



Contact us

Tel: +86-755-8981 8866 Fax: +86-755-8427 6832

Email & Skype: info@chipsmall.com Web: www.chipsmall.com

Address: A1208, Overseas Decoration Building, #122 Zhenhua RD., Futian, Shenzhen, China



S-8 Double Contact Bayonet Base

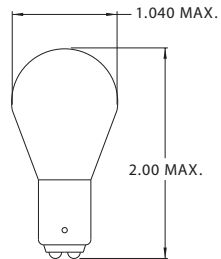

Part Number	Design Voltage	Amps	MSCP	Life Hours	Filament Type
CM1228	32.0	.45	15.0	150	C-2V
CM653	37.5	.83	32.0	500	C-2V
CM895	40.0	.53	14.0	3,800	C-13
CM1229	40.0	.38	15.0	400	C-2V
CM110	44.0	.17	6.0	200	C-7A
CM1676	45.5	.22	7.6	1,000	C-13

S-8 Double Contact Index Base

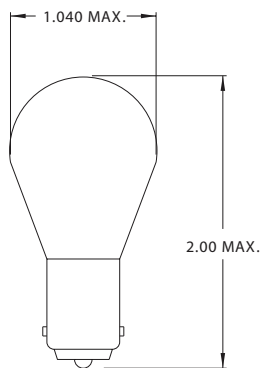

Part Number	Design Voltage	Amps	MSCP	Life Hours	Filament Type
CM1154	6.4	2.63	21.0	200	2C-6*
	7.0	.75	3.0	1,000	2C-6*
CM1606	6.4	2.69	21.0	200	C-6
CM1626	6.4	3.00	23.0	500	C-2R
CM198	12.8	2.25	32.0	1,200	C-6*
	14.0	.68	3.0	5,000	C-6*
CM1016	12.8	1.34	21.0	200	C-6*
	14.0	.59	6.0	1,000	C-6*
CM1034	12.8	1.80	32.0	200	C-6*
	14.0	.59	3.0	5,000	C-6*
CM1035	12.8	1.44	21.0	1,000	C-6*
	14.0	.59	3.0	5,000	C-6*
CM1157	12.8	2.10	32.0	600	C-6*
	14.0	.59	3.0	5,000	C-6*
CM2057	12.8	2.10	32.0	1,200	C-6*
	14.0	.48	2.0	5,000	C-6*
CM2357	12.8	2.23	40.0	400	C-6*
	14.0	.59	3.0	500	C-6*
CM1662	28.0	.93	32.0	400	CC-6*
	28.0	.94	6.0	1,000	C-2V*

* Dual Filament Lamp

S-11 Single Contact Bayonet Base

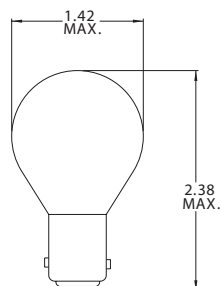

Part Number	Design Voltage	Amps	MSCP	Life Hours	Filament Type
CM1723	6.2	4.50	32.0	400	C-6
CM309	28.0	.90	32.0	300	C-2V
CM311	28.0	1.29	50.0	300	C-2V
CM3011	28.0	1.29	44.0	1,000	C-2V