



Chipsmall Limited consists of a professional team with an average of over 10 year of expertise in the distribution of electronic components. Based in Hongkong, we have already established firm and mutual-benefit business relationships with customers from,Europe,America and south Asia,supplying obsolete and hard-to-find components to meet their specific needs.

With the principle of "Quality Parts,Customers Priority,Honest Operation,and Considerate Service",our business mainly focus on the distribution of electronic components. Line cards we deal with include Microchip,ALPS,ROHM,Xilinx,Pulse,ON,Everlight and Freescale. Main products comprise IC,Modules,Potentiometer,IC Socket,Relay,Connector.Our parts cover such applications as commercial,industrial, and automotives areas.

We are looking forward to setting up business relationship with you and hope to provide you with the best service and solution. Let us make a better world for our industry!



Contact us

Tel: +86-755-8981 8866 Fax: +86-755-8427 6832

Email & Skype: info@chipsmall.com Web: www.chipsmall.com

Address: A1208, Overseas Decoration Building, #122 Zhenhua RD., Futian, Shenzhen, China



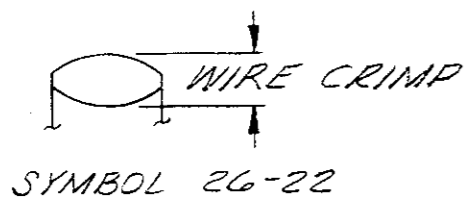
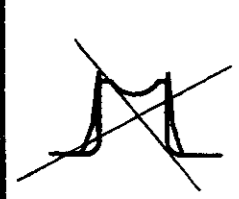
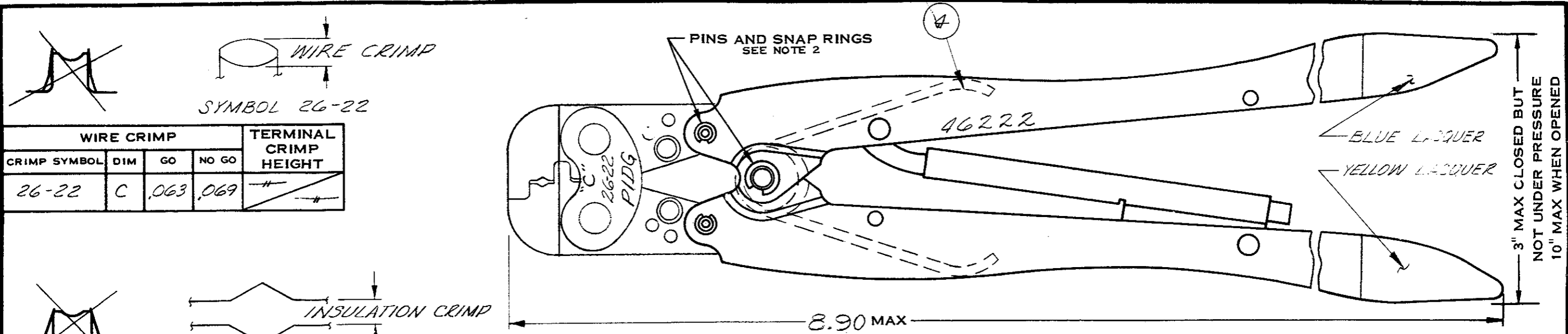

WIRE CRIMP				TERMINAL CRIMP HEIGHT
CRIMP SYMBOL	DIM	GO	NO GO	
26-22	C	.063	.069	

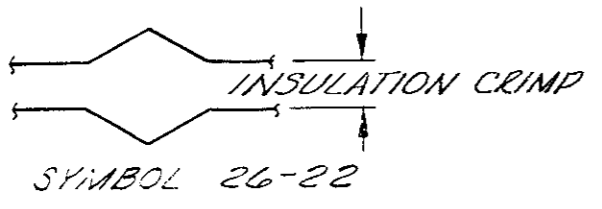
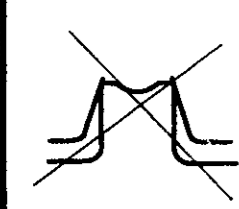

INSULATION CRIMP				TERMINAL CRIMP HEIGHT
CRIMP SYMBOL	DIM	GO	NO GO	
26-22	G	.035	.055	

AT #1 POSITION

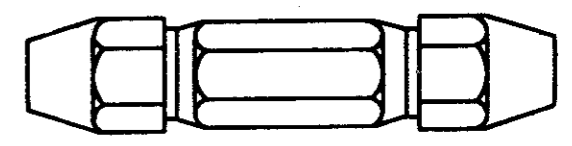
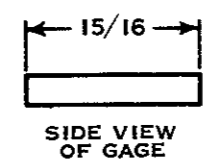
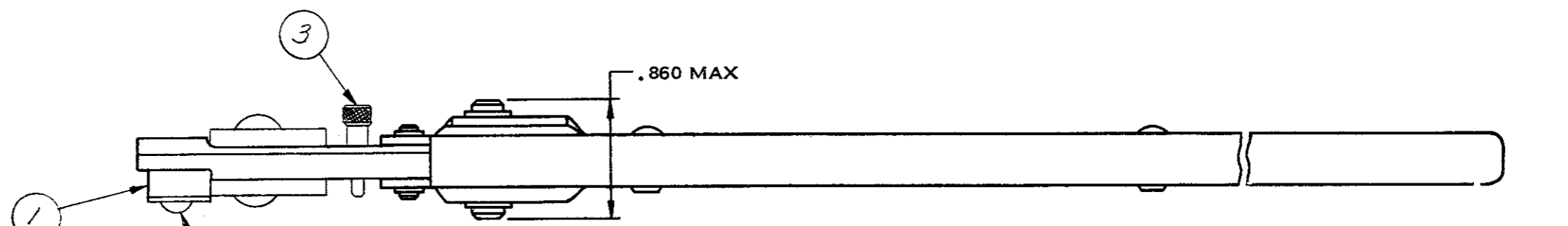

SUGGESTED DOUBLE END HANDLE A.G.D. STD.

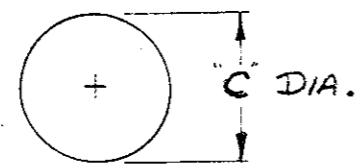
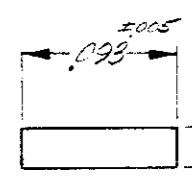

INSULATION CRIMP WIRE CRIMP
ENLARGED END VIEW OF GAGES

SUGGESTED GAGE DESIGN

- 1 CRIMP GAGE DIMENSIONS APPLY WHEN TOOL IS CLOSED OR BOTTOMED BUT NOT UNDER PRESSURE.
- 2 FOR REPLACEMENT OF PARTS SUCH AS PINS AND SNAP RINGS, ORDER REPAIR KIT NO. 12 218-4.
- 3 FOR REPLACEMENT OF PARTS OTHER THAN PINS AND SNAP RINGS, TOOL IS TO BE RETURNED TO AMP INC. HARRISBURG, PENNA. TO INSURE PROPER CERTI-CRIMP ADJUSTMENT.
- 4 FOR TOOL USAGE, SEE INSTRUCTION SHEET NO. 1538.
- 5 HAND TOOL CAN BE CHECKED BY MEASURING TERMINAL CRIMP HEIGHT.

NO.	REV.	DESCRIPTION	BY	CHK	DATE
G-1		Loc M was R	PP	PL	11/17/57
G		REV & REDRAWN	BL	DD	12/2/57
LTR		REVISION RECORD	DR	CHK	DATE

1	39364	SPRING-HANDLE	4
2	39207	PIN-ADJUSTMENT	3
1	3-21016-7	SCREW (#8-32 x 3/8 LSTH.)	2
1	125461-1	LOCATOR	1
NO. REQD	NUMBER	NAME	ITEM NO.

©1957 BY AMP INCORPORATED. ALL RIGHTS RESERVED. AMP PRODUCTS COVERED BY PATENTS AND/OR PATENTS PENDING.

CUSTOMER COPY REFERENCE ONLY

DR T.R. Williams 11/19/57	MATERIAL-STEEL	AMP AMP INCORPORATED HARRISBURG, PENNA.
CHK T. Keliagher 12/2/57	FINISH-BLACK OXIDE	
DE E.J. FINK 12-5-57	WEIGHT-1 LBS. 3 OZ.	CLASS ———
APP E.J. FINK 12-5-57	WIRE - RANGE - INSULATION ———	TYPE SHORT HANDLE TOOL
	TOLERANCE EXCEPT AS NOTED ———	LOC M B NO 46222 REV G-1
	SCALE ———	NAME DOUBLE ACTION HAND TOOL

CUSTOMER DRAWING

DIMENSIONS IN INCHES DO NOT SCALE PRINT