



Chipsmall Limited consists of a professional team with an average of over 10 year of expertise in the distribution of electronic components. Based in Hongkong, we have already established firm and mutual-benefit business relationships with customers from,Europe,America and south Asia,supplying obsolete and hard-to-find components to meet their specific needs.

With the principle of “Quality Parts,Customers Priority,Honest Operation,and Considerate Service”,our business mainly focus on the distribution of electronic components. Line cards we deal with include Microchip,ALPS,ROHM,Xilinx,Pulse,ON,Everlight and Freescale. Main products comprise IC,Modules,Potentiometer,IC Socket,Relay,Connector.Our parts cover such applications as commercial,industrial, and automotives areas.

We are looking forward to setting up business relationship with you and hope to provide you with the best service and solution. Let us make a better world for our industry!



Contact us

Tel: +86-755-8981 8866 Fax: +86-755-8427 6832

Email & Skype: info@chipsmall.com Web: www.chipsmall.com

Address: A1208, Overseas Decoration Building, #122 Zhenhua RD., Futian, Shenzhen, China



900167-1:AS SHOWN
本図

NUMBER 900167



METRIC

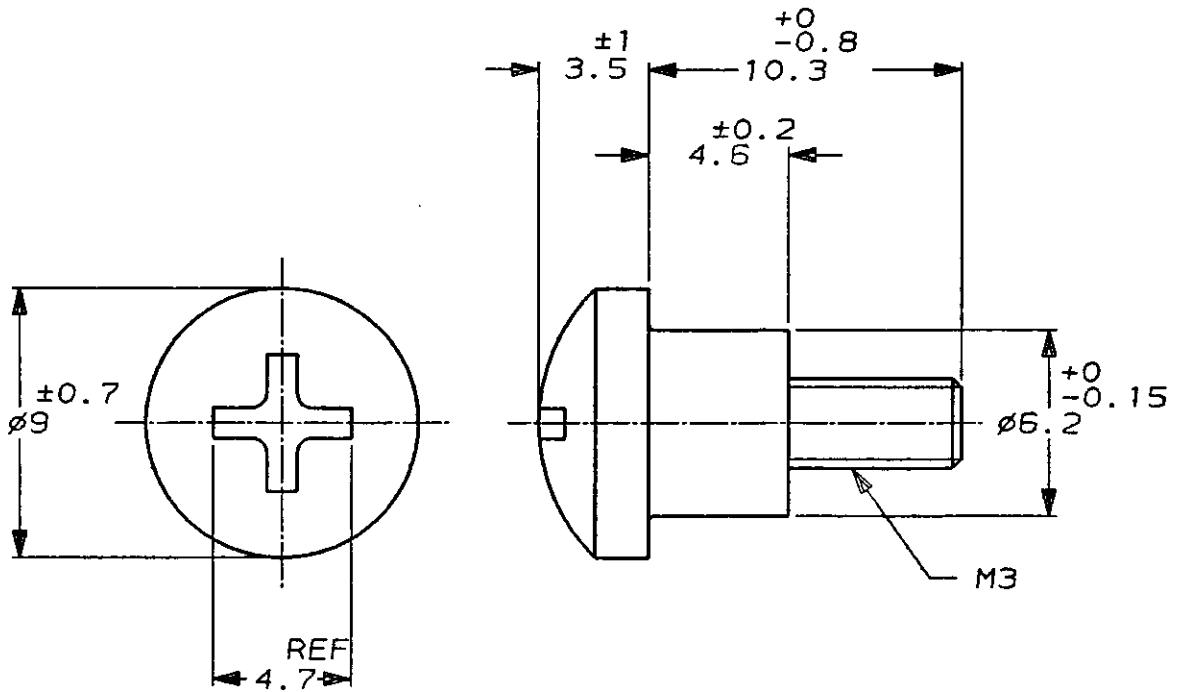

単位: 概 DIMENSIONS IN MM. DO NOT SCALE PRINT

PRINT DIST	O RELEASED FJ00-1113-94 NM S.M. 12-27-94				尺度 (SCALE)	SIZE	LOC	番号 (No.)	REV.	SHEET
	LTR 変更 (REVISION RECORD) DR CHK DATE				4/1	A	J	900167	0	1 OF 1
	DR. 20 DEC 94 N. MATSUBARA		DE. 20 DEC 94 N. MATSUBARA		名称 (NAME) CROSS-RECESSED HEAD SCREW FOR DYNAMIC PANEL MOUNT					

Copyright ©1994 年 Copyright ©1994
AMP (Japan), LTD.
ALL RIGHTS RESERVED.

AMP
日本エー・エム・ピー株式会社
Tokyo, Japan

一般公差 (GENERAL TOLERANCE)
10以下: ±0.2
10以上 30以下: ±0.25
30以上 100以下: ±0.3
角 度: ±3°

包合電線断面積 (WIRE RANGE)
mm² (AWG)

被覆外径 (INSULATOR DIA.)
mmφ

材料 (MATERIAL)
炭素鋼
CARBON STEEL

仕上 (FINISH)
ニッケルめっき
NICKEL P.L 2種