



Chipsmall Limited consists of a professional team with an average of over 10 year of expertise in the distribution of electronic components. Based in Hongkong, we have already established firm and mutual-benefit business relationships with customers from,Europe,America and south Asia,supplying obsolete and hard-to-find components to meet their specific needs.

With the principle of “Quality Parts,Customers Priority,Honest Operation,and Considerate Service”,our business mainly focus on the distribution of electronic components. Line cards we deal with include Microchip,ALPS,ROHM,Xilinx,Pulse,ON,Everlight and Freescale. Main products comprise IC,Modules,Potentiometer,IC Socket,Relay,Connector.Our parts cover such applications as commercial,industrial, and automotives areas.

We are looking forward to setting up business relationship with you and hope to provide you with the best service and solution. Let us make a better world for our industry!



Contact us

Tel: +86-755-8981 8866 Fax: +86-755-8427 6832

Email & Skype: info@chipsmall.com Web: www.chipsmall.com

Address: A1208, Overseas Decoration Building, #122 Zhenhua RD., Futian, Shenzhen, China



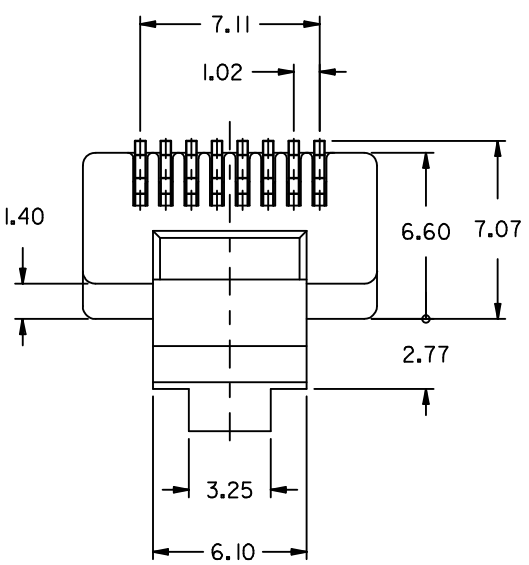
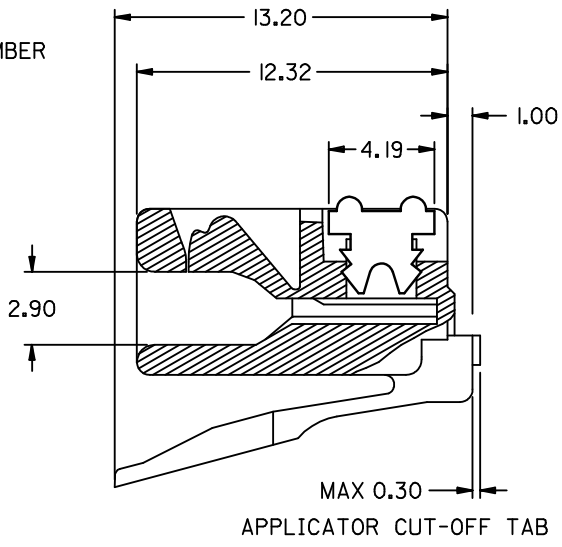
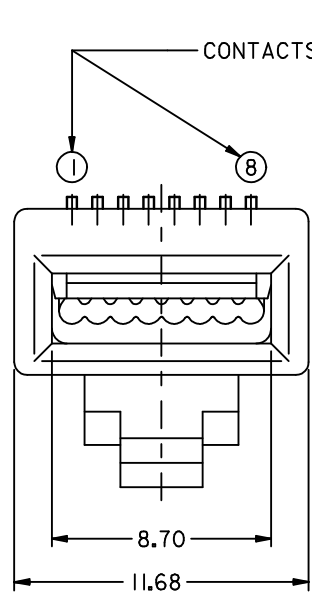

NOTES:

- 1- MATERIAL:
 HOUSING: POLYCARBONATE CLEAR.
 TERMINAL: 0.38 THICK PHOSPHOR BRONZE.
 PLATING: 1.27 MIN. GOLD IN CONTACT AREA
 0.00127 MIN. PURE TIN IN PIERCE AREA BOTH
 OVER 0.00127 MIN. NICKEL.
- 2- PRODUCT INTENDED TO TERMINATE FLAT OVAL CABLE
 HAVING
 0.94 ϕ MAXI OVER CONDUCTORS INSULATION.
- 3- PRODUCT SPECIFICATION: PS-90075
- 4- APPLICATION SPECIFICATION: AS-90075.

CKTS	NUMBER OF LOADED CONTACTS	LOOSE PIECE	
		PART NUMBER	TOOLED
8	8	90075-0141	YES

REMOVED PART 'S EC NO: E2012-0005 DRWN: JOCONNOR 2011/08/16 CHKD: APPR: STGRIFFIN 2013/01/18 REV	QUALITY SYMBOLS	GENERAL TOLERANCES (UNLESS SPECIFIED)	DIMENSION STYLE	SCALE	DESIGN UNITS	THIRD ANGLE PROJECTION
	▽=0 □=0	mm INCH 4 PLACES ± --- ± --- 3 PLACES ± --- ± .010 2 PLACES ± 0.25 ± .014 1 PLACE ± 0.35 ± --- ANGULAR ± 2 °	MM/IN	5:1	METRIC	
		DRAFT WHERE APPLICABLE MUST REMAIN WITHIN DIMENSIONS	DRAWN BY: FB DATE: CHECKED BY: TB DATE: APPROVED BY: JB DATE:	TITLE		
			MATERIAL NO. DOCUMENT NO. SHEET NO. SEE CHART SDA-90075 1 OF 2	8 POSITIONS MODULAR PLUG W.E. TYPE MOLEX INCORPORATED		