



Chipsmall Limited consists of a professional team with an average of over 10 year of expertise in the distribution of electronic components. Based in Hongkong, we have already established firm and mutual-benefit business relationships with customers from,Europe,America and south Asia,supplying obsolete and hard-to-find components to meet their specific needs.

With the principle of “Quality Parts,Customers Priority,Honest Operation,and Considerate Service”,our business mainly focus on the distribution of electronic components. Line cards we deal with include Microchip,ALPS,ROHM,Xilinx,Pulse,ON,Everlight and Freescale. Main products comprise IC,Modules,Potentiometer,IC Socket,Relay,Connector.Our parts cover such applications as commercial,industrial, and automotives areas.

We are looking forward to setting up business relationship with you and hope to provide you with the best service and solution. Let us make a better world for our industry!



## Contact us

Tel: +86-755-8981 8866 Fax: +86-755-8427 6832

Email & Skype: info@chipsmall.com Web: www.chipsmall.com

Address: A1208, Overseas Decoration Building, #122 Zhenhua RD., Futian, Shenzhen, China



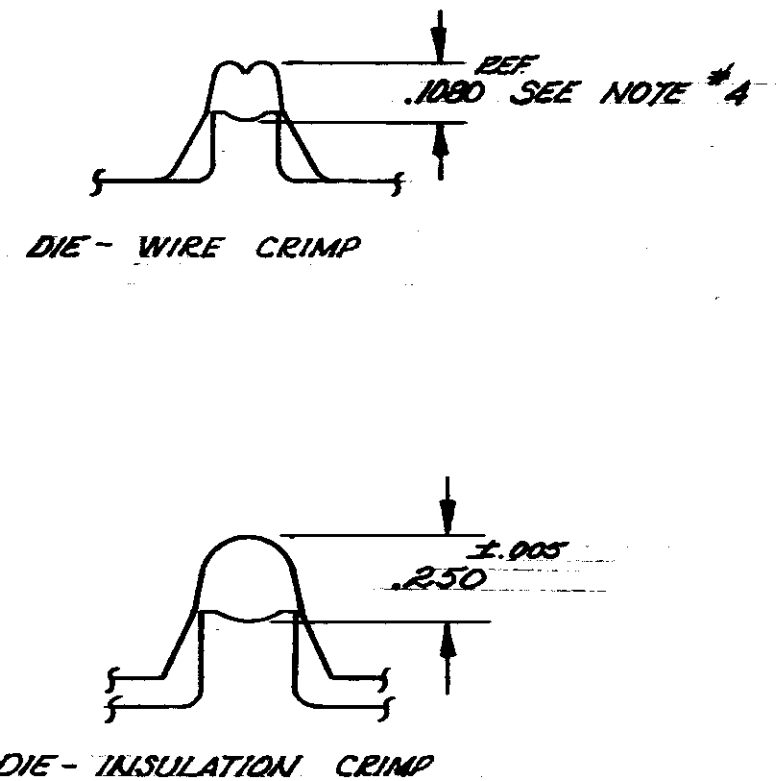
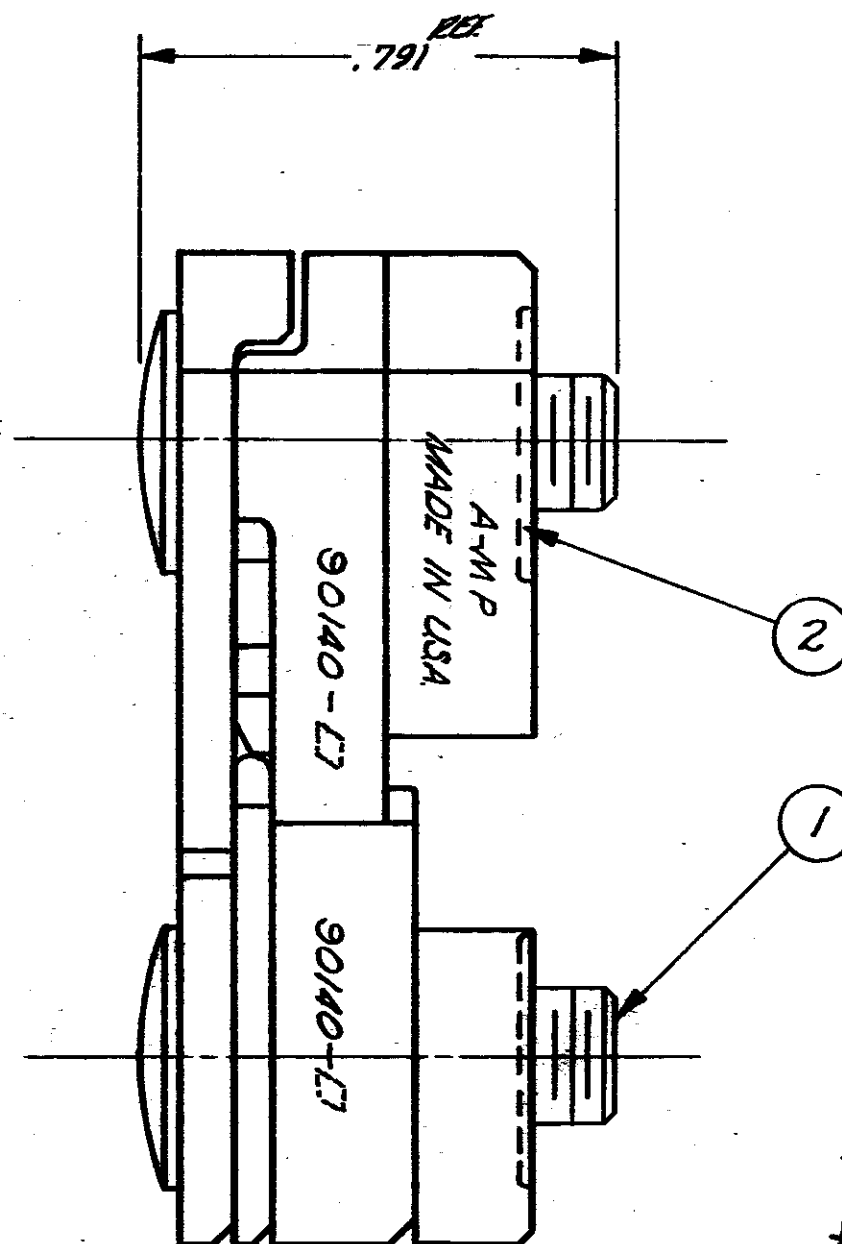
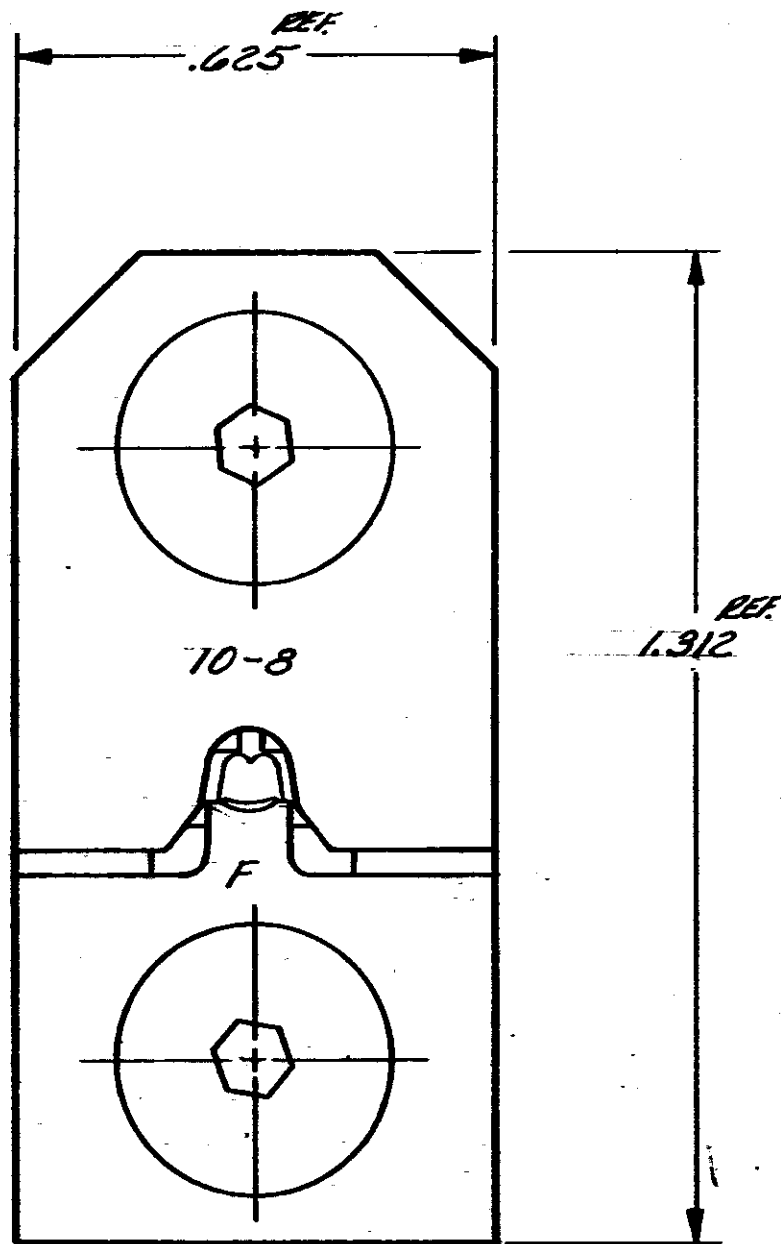

INACTIVE 11/8/77

INACTIVE,  
REFER TO IS SHEET 7175 11/8/77

2-A	1-21046-3	RING-RETAINING	IS-7175	2
2-A	306131-9	SCREEN-SPECIAL		1

1. GAGE DIMENSIONS APPLY WHEN DIES ARE BOTTOMED BUT NOT UNDER PRESSURE
2. FOR REPLACEMENT OF PARTS OTHER THAN SCREENS & RETAINING RINGS, DIES SHOULD BE RETURNED TO AMP INC HBG, PENNA.
3. FOR TOOL USAGE SEE INSTRUCTION SHEET IS-7175
4. DIE CAN BE CHECKED BY MEASURING TERM CH. .112 ± .003

REV	DESCRIPTION	DATE	BY	CHK
1	INACTIVE PER EQUIPMENT SET	11/8/77	SD	

©1965 BY AMP INCORPORATED. ALL RIGHTS RESERVED. AMP PRODUCTS COVERED BY PATENTS AND/OR PATENTS PENDING.		<b>CUSTOMER COPY REFERENCE ONLY</b>	
DR B. LUCI 6-29-65 CRK D. Drived 6-30-65 DE Blutschell 8/20/65 T.R. Long 8/21/65	MATERIAL AND FINISH STEEL: BLK. OXIDE WEIGHT: APPROX. 3oz. WIRE - RANGE - INSULATION	CLASS # TYPE #	TOLERANCE EXPERT AS NOTED ±.015 ±.004 SCALE 4:1 LOC R B NO 90140-1 NAME DIE ASSEMBLY

DIMENSIONS IN INCHES, DO NOT SCALE PRINT

53