



Chipsmall Limited consists of a professional team with an average of over 10 year of expertise in the distribution of electronic components. Based in Hongkong, we have already established firm and mutual-benefit business relationships with customers from,Europe,America and south Asia,supplying obsolete and hard-to-find components to meet their specific needs.

With the principle of “Quality Parts,Customers Priority,Honest Operation,and Considerate Service”,our business mainly focus on the distribution of electronic components. Line cards we deal with include Microchip,ALPS,ROHM,Xilinx,Pulse,ON,Everlight and Freescale. Main products comprise IC,Modules,Potentiometer,IC Socket,Relay,Connector.Our parts cover such applications as commercial,industrial, and automotives areas.

We are looking forward to setting up business relationship with you and hope to provide you with the best service and solution. Let us make a better world for our industry!



Contact us

Tel: +86-755-8981 8866 Fax: +86-755-8427 6832

Email & Skype: info@chipsmall.com Web: www.chipsmall.com

Address: A1208, Overseas Decoration Building, #122 Zhenhua RD., Futian, Shenzhen, China



| 1 | | | | 2 | | 3 | | 4 | |
|----------------|------|-------|-------|---|--|---|--|---|--|
| PRODUCT NUMBER | SIZE | DIM A | DIM B | | | | | | |
| 90312-003LF | 1x3 | 4.0 | 6.4 | | | | | | |
| 90312-004LF | 1x4 | 6.0 | 8.4 | | | | | | |
| 90312-005LF | 1x5 | 8.0 | 10.4 | | | | | | |
| 90312-006LF | 1x6 | 10.0 | 12.4 | | | | | | |
| 90312-007LF | 1x7 | 12.0 | 14.4 | | | | | | |
| 90312-008LF | 1x8 | 14.0 | 16.4 | | | | | | |
| 90312-009LF | 1x9 | 16.0 | 18.4 | | | | | | |
| 90312-010LF | 1x10 | 18.0 | 20.4 | | | | | | |
| 90312-011LF | 1x11 | 20.0 | 22.4 | | | | | | |
| 90312-012LF | 1x12 | 22.0 | 24.4 | | | | | | |
| 90312-013LF | 1x13 | 24.0 | 26.4 | | | | | | |
| 90312-014LF | 1x14 | 26.0 | 28.4 | | | | | | |
| 90312-015LF | 1x15 | 28.0 | 30.4 | | | | | | |
| 90312-016LF | 1x16 | 30.0 | 32.4 | | | | | | |
| 90312-017LF | 1x17 | 32.0 | 34.4 | | | | | | |

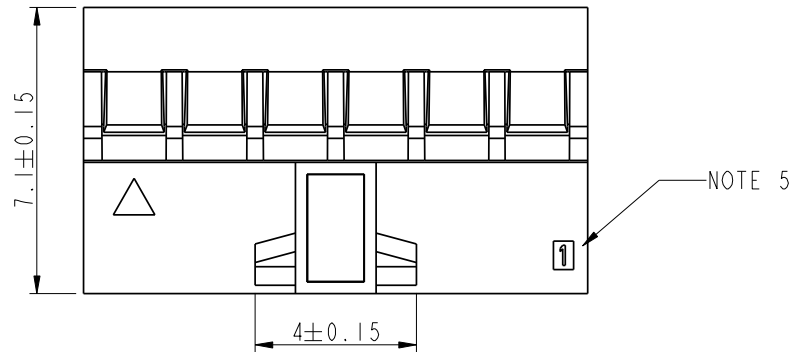
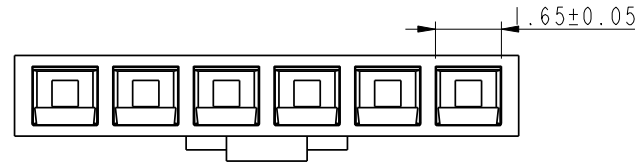

PRODUCT NUMBER

90312-0XXLF

└ TOTAL NUMBER OF POS 03 UP TO 17

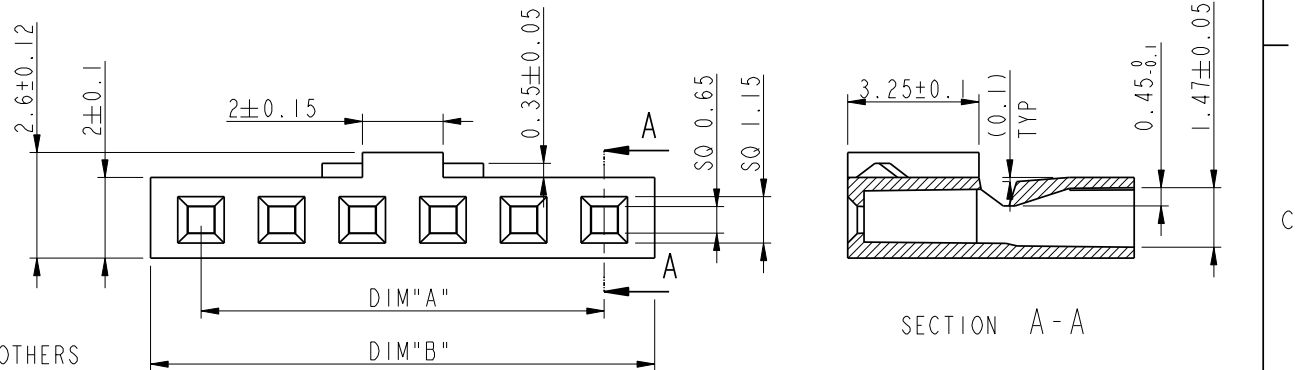

NOTES:

- MATERIAL : PA66 25% GLASSFILLED, UL94V-0 COLOR BLACK.
- PRODUCT MEETS EUROPEAN UNION DIRECTIVES AND OTHERS REGULATIONS AS DESCRIBED IN GS-47-004.
- THIS PRODUCT IS NOT INTENDED TO BE EXPOSED TO MANUFACTURING SOLDER PROCESSES.
- INDICATES POS 1, WHEN MATED WITH 95000 SERIE.
- FOR USE WITH MINITEK CRIMP TO WIRE CONTACT 77318 (26-30AWG) OR 10044403 (22-24AWG).
- PRODUCT SPECIFICATION AS PER 110-036, CRIMP RECOMMENDATIONS AS PER GS-20-058

| | | | | | | |
|----------------|-------------|-------------------------|----------------|-----------|------------------------|----|
| Material | | SEE NOTE 1 | | Spec ref | | |
| Mat code | | N/A | | tolerance | projection | |
| Heattreat | | N/A | | | | MM |
| Plating/Finish | | N/A | | | | |
| Dr | D.WHITING | 1991-02-15 | Product family | | MINITEK | |
| Eng | S.OLSON | 1991-02-15 | Model Name | | 90312 | |
| Chr | J.COMPAGNON | 11-04-04 | Model Revision | | REL Level proj_release | |
| Appr | JCO | 11-12-01 | Model Revision | | | |
| Title | | MINITEK CTW HSG.SGL ROW | | 90312 | | |
| Title | | POLARIZING & LATCHING | | T | | |
| Pro/E file | | catalog no | | CUSTOMER | | |

| TOLERANCES UNLESS OTHERWISE SPECIFIED | | | | | |
|---------------------------------------|-------|--------|---|---|---|
| | 0.X | ±0.3 | | | |
| LINEAR | 0.XX | ±0.13 | - | - | - |
| | 0.XXX | ±0.050 | - | - | - |
| ANGULAR | 0° | ±2° | - | - | - |