



Chipsmall Limited consists of a professional team with an average of over 10 year of expertise in the distribution of electronic components. Based in Hongkong, we have already established firm and mutual-benefit business relationships with customers from,Europe,America and south Asia,supplying obsolete and hard-to-find components to meet their specific needs.

With the principle of "Quality Parts,Customers Priority,Honest Operation,and Considerate Service",our business mainly focus on the distribution of electronic components. Line cards we deal with include Microchip,ALPS,ROHM,Xilinx,Pulse,ON,Everlight and Freescale. Main products comprise IC,Modules,Potentiometer,IC Socket,Relay,Connector.Our parts cover such applications as commercial,industrial, and automotives areas.

We are looking forward to setting up business relationship with you and hope to provide you with the best service and solution. Let us make a better world for our industry!



Contact us

Tel: +86-755-8981 8866 Fax: +86-755-8427 6832

Email & Skype: info@chipsmall.com Web: www.chipsmall.com

Address: A1208, Overseas Decoration Building, #122 Zhenhua RD., Futian, Shenzhen, China



PART NO	PLATING
90518-102 SEE NOTE 5	0.38um/15u" GOLD OR GXT CONTACT. OVER 1.27um/50u" Ni (NOTE 6)
90518-202 SEE NOTE 5	0.76um/30u" GOLD OR GXT ON CONTACT AREA. OVER 1.27um/50u" Ni (NOTE 6)
71363-302 SEE NOTE 5	2.54um/100u" TIN/LEAD PLATING
90518-102LF SEE NOTE 5	0.38um/15u" GOLD OR GXT CONTACT. OVER 1.27um/50u" Ni (NOTE 6)
90518-202LF SEE NOTE 5	0.76um/30u" GOLD OR GXT ON CONTACT AREA. OVER 1.27um/50u" Ni (NOTE 6)

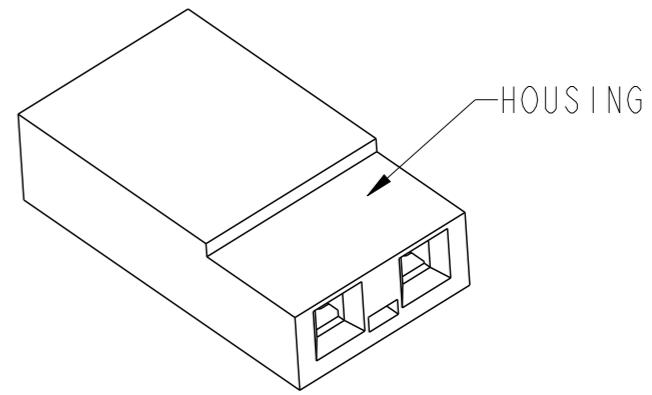

- NOTES:
- MATERIAL
HOUSING : 30% GLASS FILLED POLYESTER
FLAME RETARDANT PER UL 94V-0
COLOR : BLACK
 - TERMINAL : PHOSPHOR BRONZE
PLATING : REFER TO CHART
 - 90518-102 AND 90518-202 ARE THE SAME AS 90518-102LF AND 90518-202LF RESPECTIVELY. THE SUFFIX "LF" IS ADDED FOR EASY LEAD-FREE IDENTIFICATION.
 - THE HOUSING WILL WITHSTAND EXPOSURE TO 200°C PEAK TEMPERATURE FOR 10 SECONDS IN A CONVECTION, INFRA-RED OR VAPOR PHASE REFLOW OVEN.
 - THIS PRODUCT MEETS EUROPEAN UNION DIRECTIVES AND OTHER COUNTRY REGULATIONS AS DESCRIBED IN GS-22-008.
 - PLATING OPTION:
MAY BE EITHER GOLD OR GXT PLATED AT MANUFACTURER'S OPTION

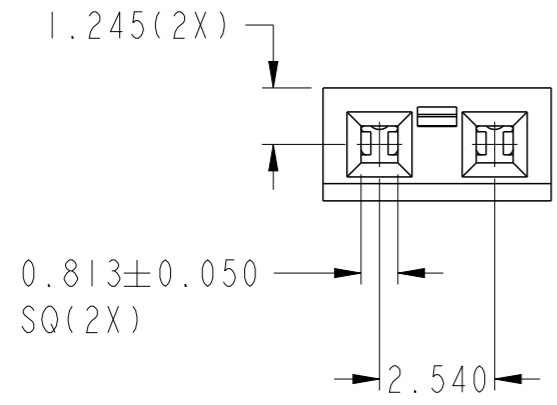
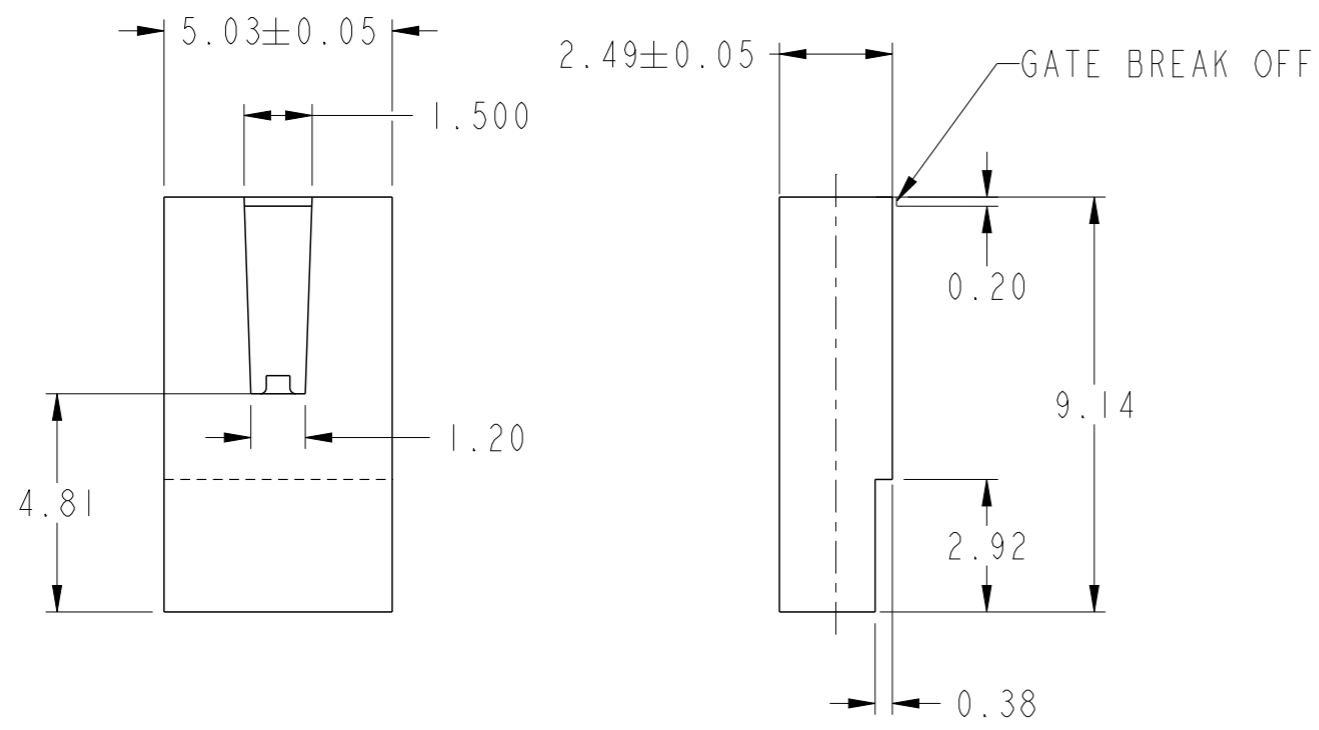

CONFIDENTIAL

spec ref	-	dr	Louis Ng	2010/10/12	projection	MM	size	A3	scale	6:1
tolerance std	ISO 406 ISO 1101	eng	Guo-Min Sun	2013/05/16			ecn no	ELX-N-14401-1		
	TOLERANCES UNLESS OTHERWISE SPECIFIED	chr	-	-			product family	JUMPER	rel level	Released
surface	ISO 1302	appr	Rick Bian	2013/05/26			dwg no	90518	rev	F
	linear	www.fci.com		cat. no.	-		-		sheet 1 of 1	
	angular	0°	±3°							

Copyright FCI.
FCI