



Chipsmall Limited consists of a professional team with an average of over 10 year of expertise in the distribution of electronic components. Based in Hongkong, we have already established firm and mutual-benefit business relationships with customers from,Europe,America and south Asia,supplying obsolete and hard-to-find components to meet their specific needs.

With the principle of “Quality Parts,Customers Priority,Honest Operation,and Considerate Service”,our business mainly focus on the distribution of electronic components. Line cards we deal with include Microchip,ALPS,ROHM,Xilinx,Pulse,ON,Everlight and Freescale. Main products comprise IC,Modules,Potentiometer,IC Socket,Relay,Connector.Our parts cover such applications as commercial,industrial, and automotives areas.

We are looking forward to setting up business relationship with you and hope to provide you with the best service and solution. Let us make a better world for our industry!



Contact us

Tel: +86-755-8981 8866 Fax: +86-755-8427 6832

Email & Skype: info@chipsmall.com Web: www.chipsmall.com

Address: A1208, Overseas Decoration Building, #122 Zhenhua RD., Futian, Shenzhen, China



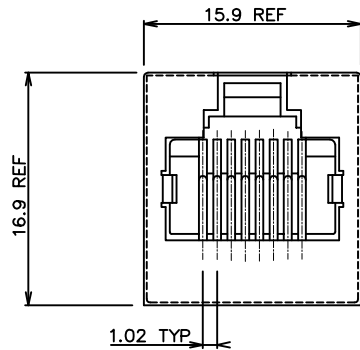

P/N	WIRE NUMBERS LOADED	PLATING	DIM A
91139-088	ALL	5u" Au + high performance lubricant	3.20±0.50
91139-588	ALL	50v" G.X.T.	3.20±0.50
91139-088LF	ALL	5u" Au + high performance lubricant	3.20±0.50
91139-588LF	ALL	50v" G.X.T.	3.20±0.50
91139-088SLF	ALL	5u" Au + high performance lubricant	1.50±0.30
91139-088SHLF	ALL	5u" Au + high performance lubricant	1.50±0.30
91139-188SHLF	ALL	15u" G.X.T.	1.50±0.30

PLATING CODE WITH MYLAR LEAD FREE PRODUCT NO. MEETS PIP PROCESS PRODUCT NO.

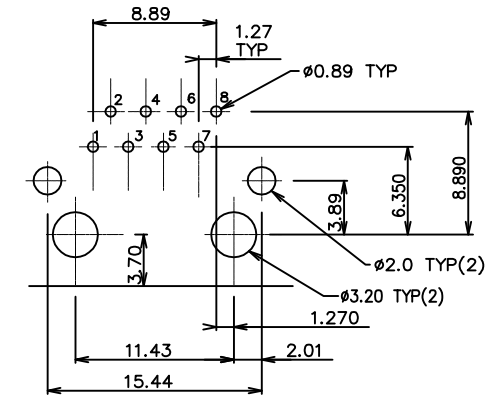

RECOMMENDED PC BOARD LAYOUT
PCB GENERALLY TOLERANCE: ±0.05

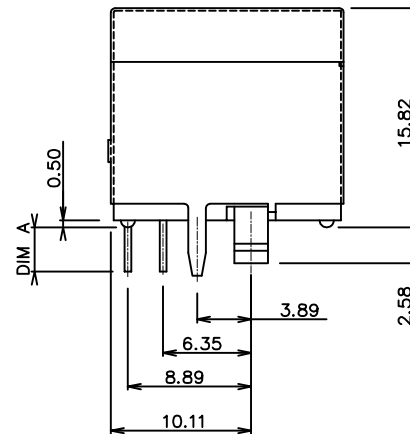
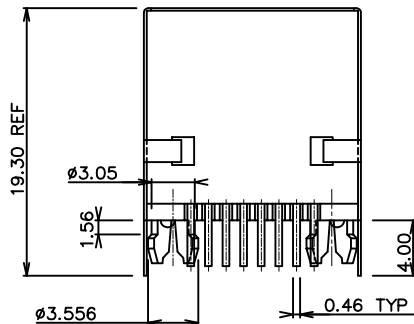
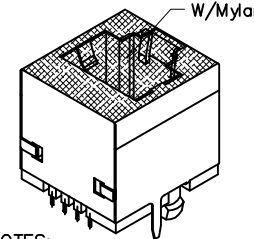

NOTES:

- RECOMMENDED P.C.B THICKNESS 1.60 MM EXCEPT -XXXSLF
- 91139 -XXXSLF & -XXXSHLF ARE CUSTOMER SPECIAL REQUIREMENT, THERE IS A MYLAR, AND CUSTOMER CHOOSES HIS OWN PCB.
- HOUSING MAT'L: NYLON UL 94V-0, BLACK.
- CONTACTS: COPPER ALLOY, PLATING SEE TABLE.
- METAL SHELL MATERIAL:
COPPER ALLOY, 0.20mm THICK.
FOR 91139-XXX: FINISH: TIN-LEAD 100u" THICK MIN.
FOR 91139-XXX(S)LF: FINISH: UNDERPLATING WITH 50u" MIN. NICKEL, OVERPLATING WITH 80u" MIN PURE BRIGHT TIN.
FOR 91139-088SHLF: FINISH: UNDERPLATING WITH 50u" MIN. NICKEL, OVERPLATING WITH 80u" MIN PURE BRIGHT TIN.
FOR 91139-188SHLF: FINISH: UNDERPLATING WITH 50u" MIN. NICKEL, SELECT PLATING MATT TIN ON METAL SHELL FEET.
- PACKAGING: GES-14-2261, USE TRAY.
- PRODUCT SPEC: GS-12-083.
- IF LF P/N THE PRODUCT MEETS EUROPEAN UNION DIRECTIVES AND OTHER COUNTRY REGULATIONS AS DESCRIBED IN GS-22-008.
- IF LF P/N THE HOUSING WILL WITHSTAND EXPOSURE TO 260°C PEAK TEMPERATURE FOR 10 SECONDS IN A WAVE SOLDER APPLICATION WITH A 1.60mm MINIMUM THICK CIRCUIT BOARD.
- IF LF P/N PACKAGING MEETS GS-14-920 SPECIFICATION.

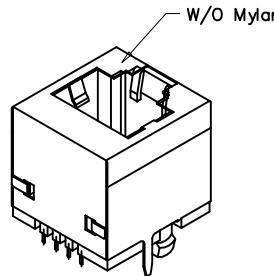
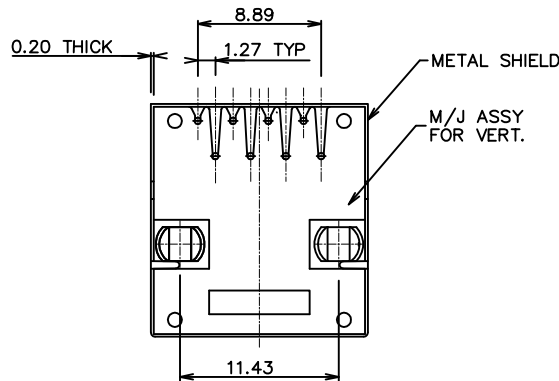

mat'l. code		surface	tolerance	projection	product family
		ISO 1302	ISO 406/ISO 1101		MJ HPL580
ltr	ecn no	dr	date	tolerances unless otherwise specified	title
F	N04-0040	ZC	08/16/04	angles	8 POS VERT PCB M/J ASSY
G	N04-0115	YS	12/06/04	0°±2'	SHIELDED,WITHOUT PANEL STOP
H	ELX-N-004620	SH MNO	07/22/11	0.00±.05	scale 2:1
J	ELX-N-010984	SH MNO	3/14/12	dr	STU STONER 921029
K	ELX-N-13758	HE	2012-12-26	engr	R.DOUTRICH 921029
L	ELX-N-21774	NICK	8/26/15	chr	STU STONER 921029
M	ELX-N-23838	NICK	4/12/16	appd	STU STONER 921029
sheet	revision	M			
index	sheet	1			