



Chipsmall Limited consists of a professional team with an average of over 10 year of expertise in the distribution of electronic components. Based in Hongkong, we have already established firm and mutual-benefit business relationships with customers from,Europe,America and south Asia,supplying obsolete and hard-to-find components to meet their specific needs.

With the principle of "Quality Parts,Customers Priority,Honest Operation,and Considerate Service",our business mainly focus on the distribution of electronic components. Line cards we deal with include Microchip,ALPS,ROHM,Xilinx,Pulse,ON,Everlight and Freescale. Main products comprise IC,Modules,Potentiometer,IC Socket,Relay,Connector.Our parts cover such applications as commercial,industrial, and automotives areas.

We are looking forward to setting up business relationship with you and hope to provide you with the best service and solution. Let us make a better world for our industry!



Contact us

Tel: +86-755-8981 8866 Fax: +86-755-8427 6832

Email & Skype: info@chipsmall.com Web: www.chipsmall.com

Address: A1208, Overseas Decoration Building, #122 Zhenhua RD., Futian, Shenzhen, China



P2-9553

4

3

2

1

Ziichnung geschutzt durch © Copyright 1983 AMP DEUTSCHLAND GmbH Alle Rechte vorbehalten	Index	Änderung	Tag	Name
	A	Einzelteile geschl. T. - 2 abh. aus. realisiert	19.3.84	Jahn
	B	12,2 ^{+0,05} auf 12,2 ^{-0,02}	1.8.84	Jahn

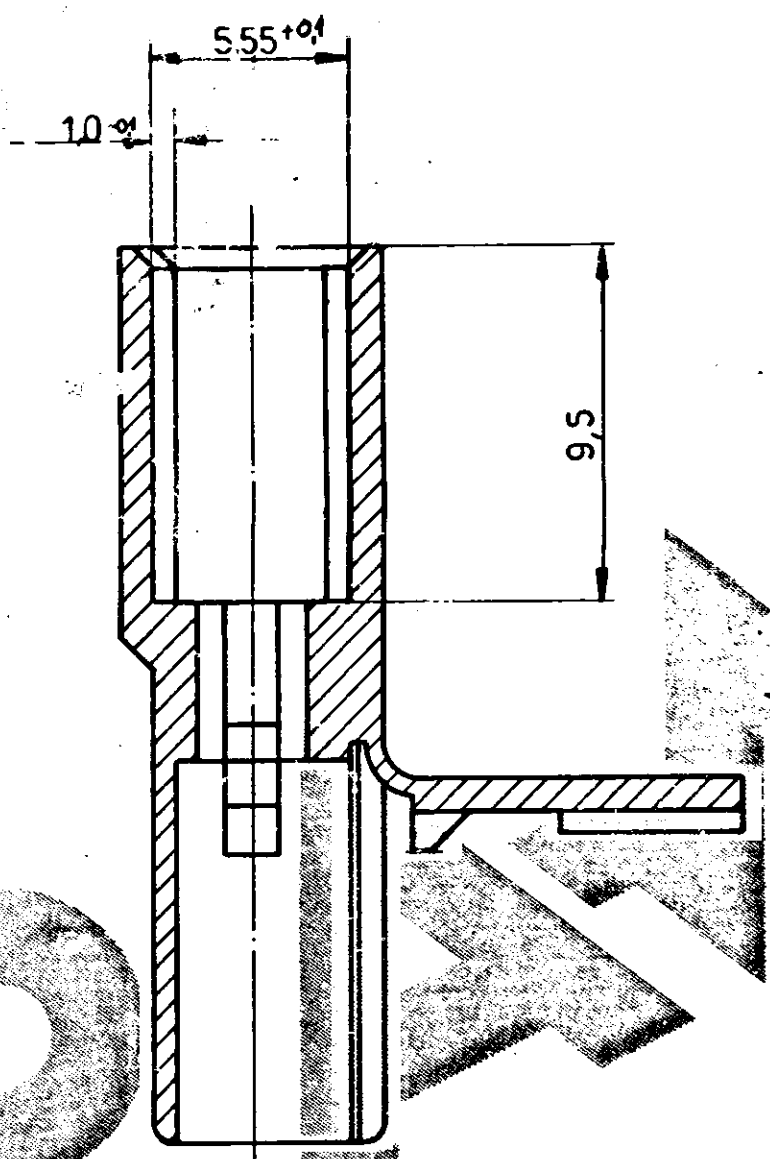
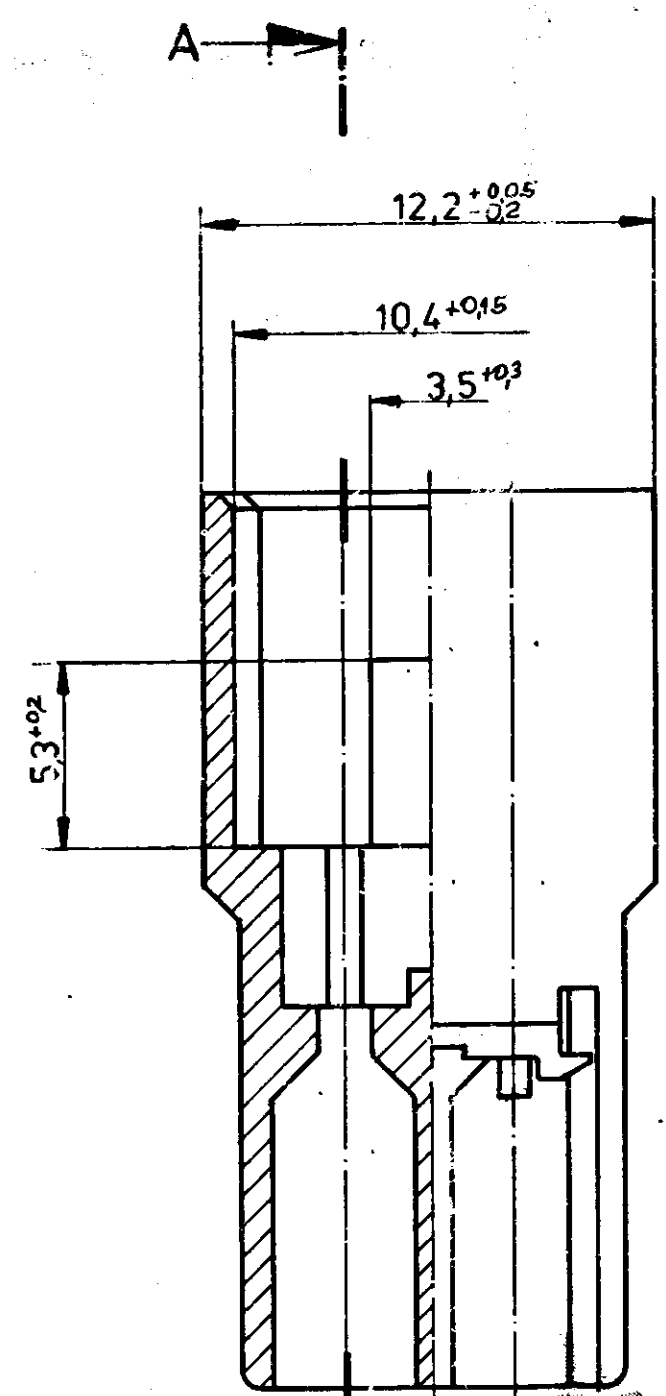
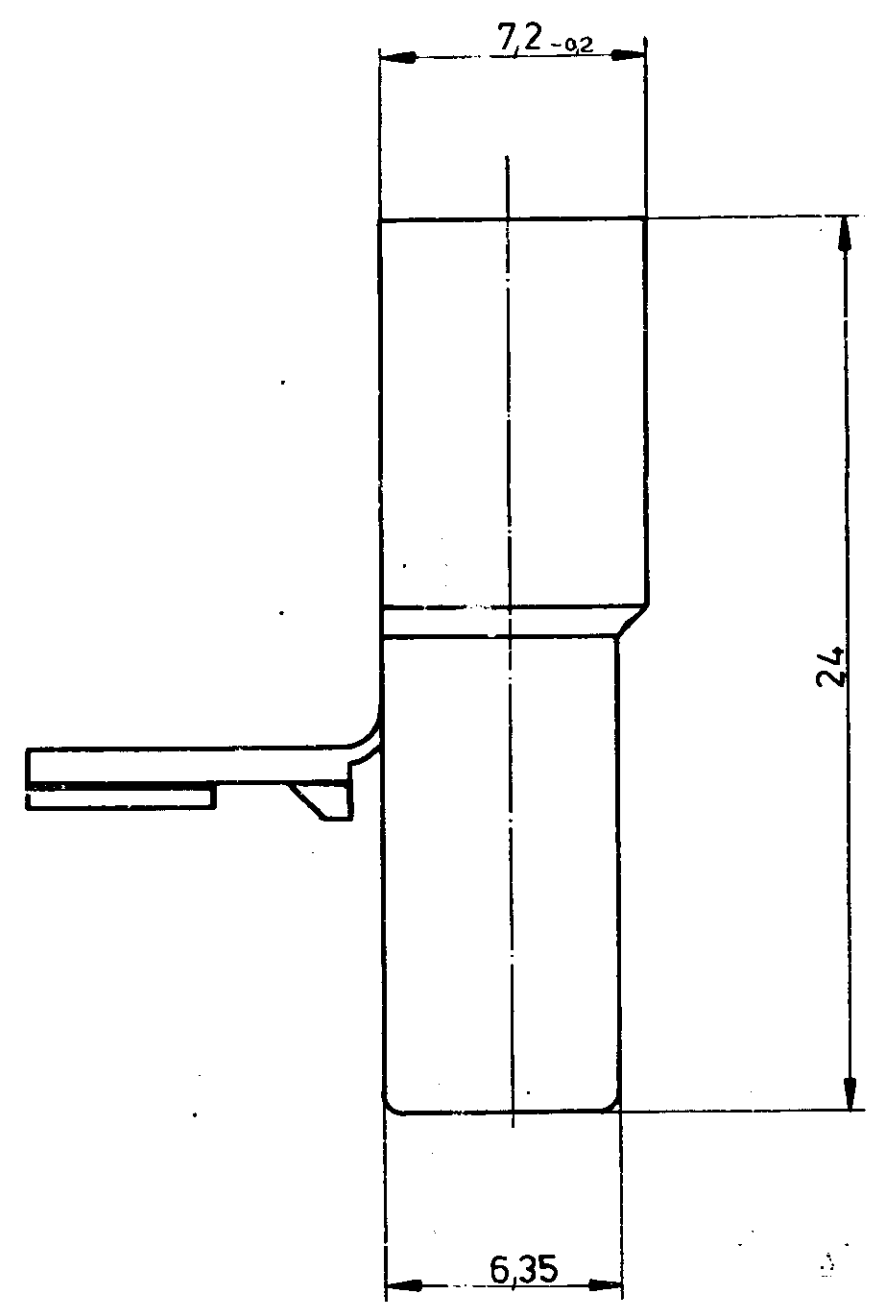

Schnitt C-D

Schnitt A-B

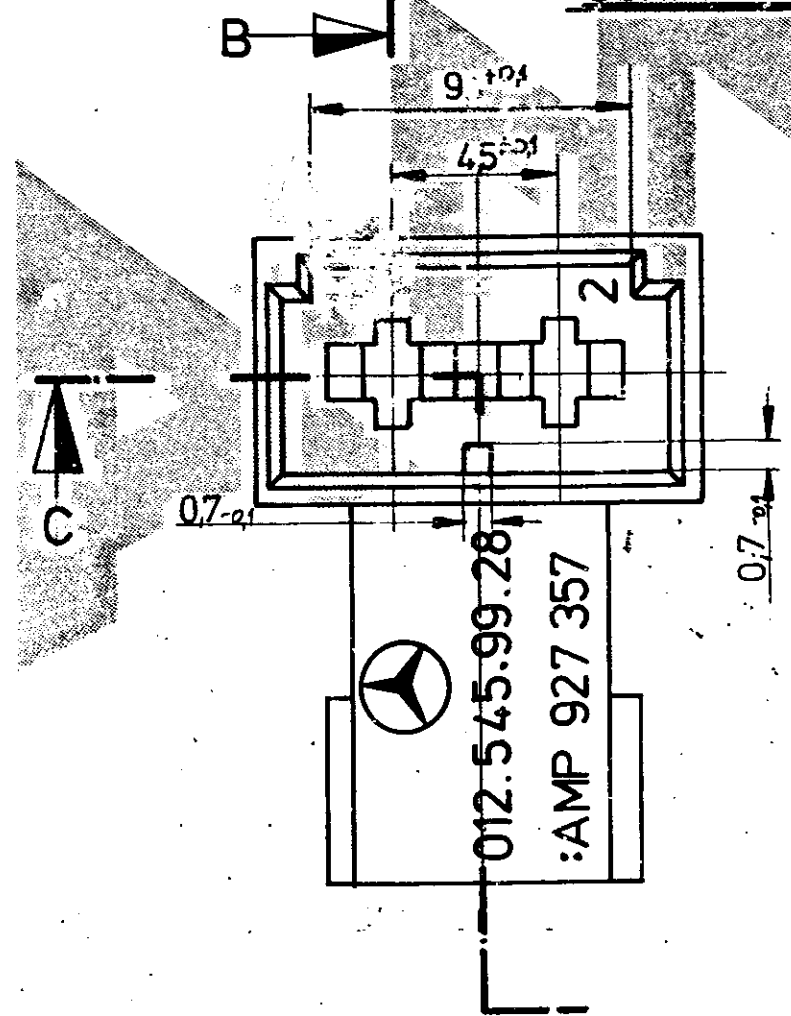

Note:

- ① Kammer ausgelegt für Flachstecker 2,8 - 1 DIN 46 343
- ② Kennzeichnung nach G 3 erhoben nach N 33 015, jedoch Schriftgröße 1 für Sach-Nr. 012.545.99.28
- ③ Fertig von AMP
- ④ Gewicht in kg: 0,001

Gegenstück 927 358

			AMP AMP DEUTSCHLAND GmbH Langen b Ffm	
			Benennung	
927 357-2	PA 66	schwarz	2 pol. Flachsteckergehäuse K (Serie 2,8)	
927 357-1	PA 6.6	natur		
Bestell-Nr.	Werkstoff	Oberfläche Farbe	Nicht tolerierte Maße ± 0,2 mm ± 1,5 °	Format C
Gez. 3.2.83 Jahn	Gepr. 11.2.83 Hohl	Gepr.	Zeichnungs-Nr. 927 357	
			Blatt-Nr.	