



Chipsmall Limited consists of a professional team with an average of over 10 year of expertise in the distribution of electronic components. Based in Hongkong, we have already established firm and mutual-benefit business relationships with customers from,Europe,America and south Asia,supplying obsolete and hard-to-find components to meet their specific needs.

With the principle of "Quality Parts,Customers Priority,Honest Operation,and Considerate Service",our business mainly focus on the distribution of electronic components. Line cards we deal with include Microchip,ALPS,ROHM,Xilinx,Pulse,ON,Everlight and Freescale. Main products comprise IC,Modules,Potentiometer,IC Socket,Relay,Connector.Our parts cover such applications as commercial,industrial, and automotives areas.

We are looking forward to setting up business relationship with you and hope to provide you with the best service and solution. Let us make a better world for our industry!



## Contact us

Tel: +86-755-8981 8866 Fax: +86-755-8427 6832

Email & Skype: info@chipsmall.com Web: www.chipsmall.com

Address: A1208, Overseas Decoration Building, #122 Zhenhua RD., Futian, Shenzhen, China



WDF 82-9167-4  
WMS STM

Zeichnung geschützt durch © Copyright 1982 AMP DEUTSCHLAND GmbH Alle Rechte vorbehalten	Index	Anderung	Tag	Name

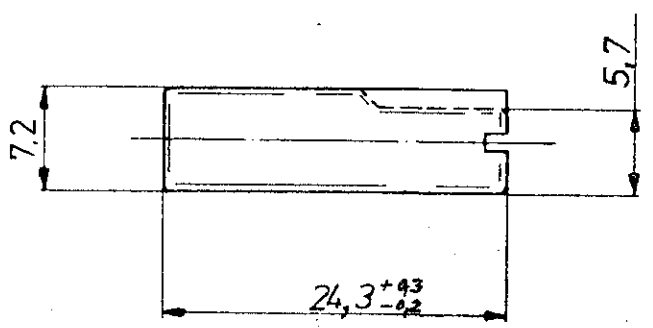
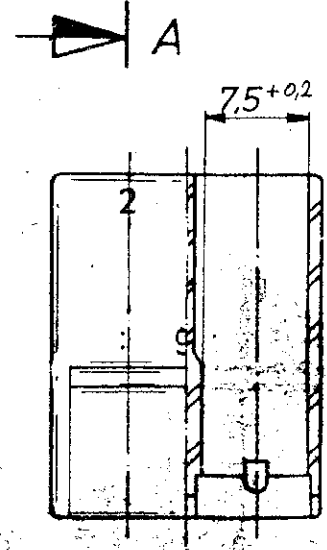
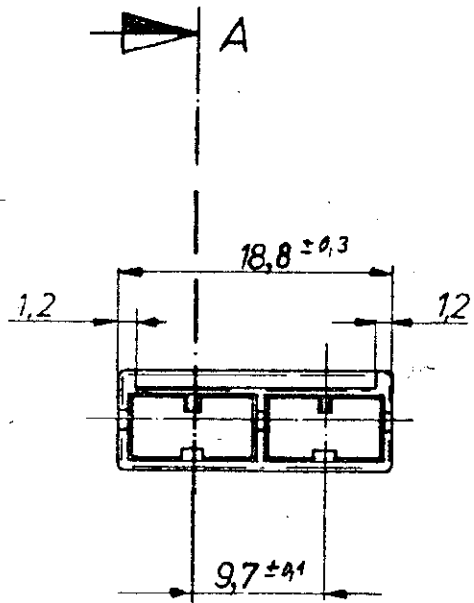

Schnitt section A-A

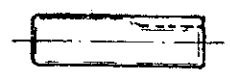
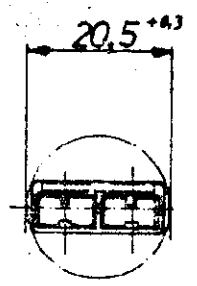
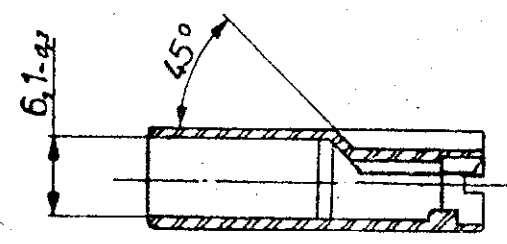

Maßstab scale 1:1

Anderungen, die dem technischen Fortschritt dienen, behalten wir uns vor.

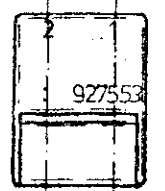

		<b>AMP</b> AMP DEUTSCHLAND GmbH Langen b Ffm	
		Benennung 2 pol. POSITIVE LOCK Gehäuse	
927 553-1	PA 6.6	schwarz	
Bestell-Nr.	Werkstoff	Oberfläche Farbe	Nicht tolerierte Maße ± 0,2 mm ± 1°-30'
Gez. 11.3.85 Druft	12.3.85 Wly	Gepr.	Format <b>B</b> Zeichnungs-Nr. 927 553
		Maßstab <b>2:1</b>	Blatt-Nr. <b>1 von 1</b>

K