



Chipsmall Limited consists of a professional team with an average of over 10 year of expertise in the distribution of electronic components. Based in Hongkong, we have already established firm and mutual-benefit business relationships with customers from,Europe,America and south Asia,supplying obsolete and hard-to-find components to meet their specific needs.

With the principle of “Quality Parts,Customers Priority,Honest Operation,and Considerate Service”,our business mainly focus on the distribution of electronic components. Line cards we deal with include Microchip,ALPS,ROHM,Xilinx,Pulse,ON,Everlight and Freescale. Main products comprise IC,Modules,Potentiometer,IC Socket,Relay,Connector.Our parts cover such applications as commercial,industrial, and automotives areas.

We are looking forward to setting up business relationship with you and hope to provide you with the best service and solution. Let us make a better world for our industry!



Contact us

Tel: +86-755-8981 8866 Fax: +86-755-8427 6832

Email & Skype: info@chipsmall.com Web: www.chipsmall.com

Address: A1208, Overseas Decoration Building, #122 Zhenhua RD., Futian, Shenzhen, China



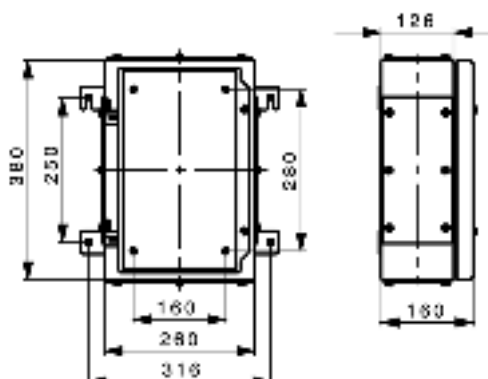

General ordering data

Order No.	9508630000
Part designation	NexT 38/26/16 4gp ss
Version	Ex enclosure, 160 mm, 380 mm, 260 mm, Stainless steel
EAN	4008190499402
Qty.	1 pc(s).

Dimensions

Fixing dimension, height	250 mm
Fixing dimension, width	316 mm
Height	160 mm
Length	380 mm
Width	260 mm

General details

Cover fixing	Removable cover + M6 screws
Enclosure fixing	Outside mounting with 10 mm holes
Integral fixing	4 x 10 mm spacers
Sealing material	Chloroprene (cover & flange)
Version cover	closed
Colour	Miscellaneous
Surface finish	polished, chemically immersed
Class of protection to EN 60529	IP 66
Weight	7,000 g
Ambient temperature, min.	-40 °C
Ambient temperature, max.	85 °C

Screwed cable glands top/bottom

M 12	38
M 16	24
M 20	14
M 25	6
M 32	4
M 40	3

Screwed cable glands top/bottom

M 50	2
Side of enclosure	Top / Bottom

Screwed cable glands, left/right

M12	38
M16	24
M20	14
M25	6
M32	4
M40	3
M50	2
On housing side	left / right

Approvals

Approvals institutes



GOSTEX ATEX ATEX

Classifications

ETIM 2.0	EC000049
ETIM 3.0	EC000049
eClass 4.1	27-14-12-06
eClass 5.0	27-18-05-02
eClass 5.1	27-18-05-02

Similar products

Order No.	Part designation	Version
9523600000	NexT 38/26/16 0gp 7032	Ex enclosure, 160 mm, 380 mm, 260 mm, Sheet steel 1.5 mm (16 SWG)
9523460000	NexT 38/26/16 0gp ss	Ex enclosure, 160 mm, 380 mm, 260 mm, Stainless steel 1.4404
9522900000	NexT 38/26/16 1gp 7032	Ex enclosure, 160 mm, 380 mm, 260 mm, Sheet steel 1.5 mm (16 SWG)
9522620000	NexT 38/26/16 1gp ss	Ex enclosure, 160 mm, 380 mm, 260 mm, Stainless steel 1.4404
9507750000	NexT 38/26/16 2gp 7032	Ex enclosure, 160 mm, 380 mm, 260 mm, Sheet steel 1.5 mm (16 SWG)
9508560000	NexT 38/26/16 2gp ss	Ex enclosure, 160 mm, 380 mm, 260 mm, Stainless steel 1.4404
9523040000	NexT 38/26/16 3gp 7032	Ex enclosure, 160 mm, 380 mm, 260 mm, Sheet steel 1.5 mm (16 SWG)
9522760000	NexT 38/26/16 3gp ss	Ex enclosure, 160 mm, 380 mm, 260 mm, Stainless steel 1.4404
9507820000	NexT 38/26/16 4gp 7032	Ex enclosure, 160 mm, 380 mm, 260 mm, Sheet steel 1.5 mm (16 SWG)