



Chipsmall Limited consists of a professional team with an average of over 10 year of expertise in the distribution of electronic components. Based in Hongkong, we have already established firm and mutual-benefit business relationships with customers from,Europe,America and south Asia,supplying obsolete and hard-to-find components to meet their specific needs.

With the principle of “Quality Parts,Customers Priority,Honest Operation,and Considerate Service”,our business mainly focus on the distribution of electronic components. Line cards we deal with include Microchip,ALPS,ROHM,Xilinx,Pulse,ON,Everlight and Freescale. Main products comprise IC,Modules,Potentiometer,IC Socket,Relay,Connector.Our parts cover such applications as commercial,industrial, and automotives areas.

We are looking forward to setting up business relationship with you and hope to provide you with the best service and solution. Let us make a better world for our industry!



## Contact us

Tel: +86-755-8981 8866 Fax: +86-755-8427 6832

Email & Skype: info@chipsmall.com Web: www.chipsmall.com

Address: A1208, Overseas Decoration Building, #122 Zhenhua RD., Futian, Shenzhen, China



PRODUCT NO.
95622-003
95622-003LF
95622-004LF

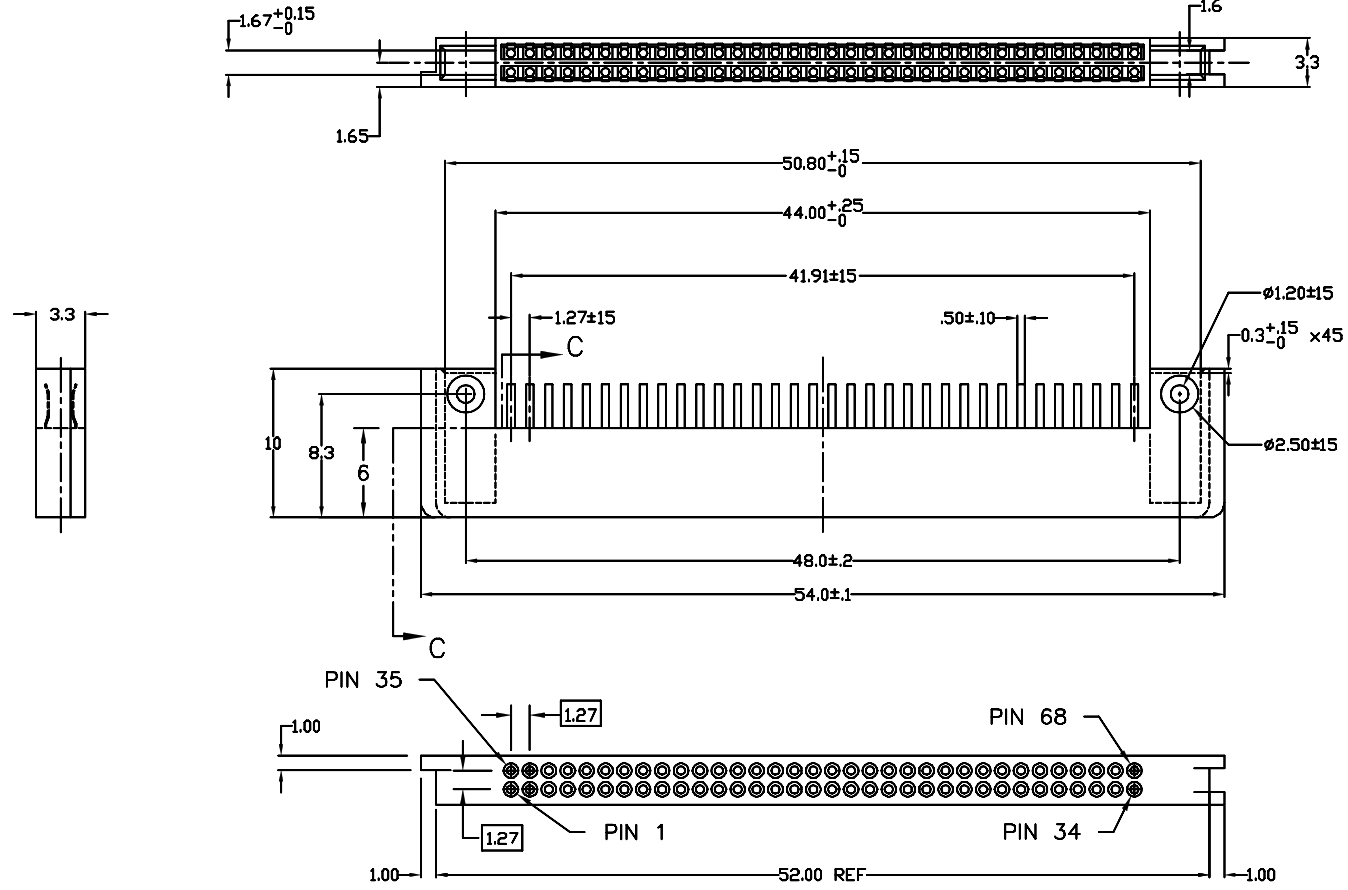

NOTES:

- MATERIAL:  
CONTACT - BeCu  
PLASTIC HOUSING - GLASS REINFORCED LCP AS PER UL-94V-0  
COLOR: BLACK
- PLATING:  
CONTACT-ALL OVER 0.5µm MIN. NICKEL UNDER PLATING  
0.1µm MIN GOLD OVER 0.5µm MIN. PALLADIUM NICKEL  
SELECTIVE PLATING ON CONTACT  
2.5µm MIN. TIN/LEAD PLATING ON SOLDER TAIL(ONLY FOR 95622-003)  
LEAD FREE SOLDER TAIL PLATING 2µm(80u") MIN MATTE TIN(ONLY FOR 95622-003LF) OR 7.6µm MIN MATTE TIN (ONLY FOR 95622-004LF )  
OVER 1.27µm(50u") MIN NICKEL UNDERPLATE.
- MATING CONNECTOR  
TO MATE WITH 68 POS. HEADER BASED ON JEIDA/PCMCIA SPECIFICATION
- PACKAGING SPECIFICATION: BUS-14-333  
PACKAGING OF LEAD FREE PRODUCTS MEETS LABELING AND PACKAGING SPECIFICATION GS-14-920.
- PRODUCT SPECIFICATION: 110-263

mat'l. code				tolerances unless otherwise specified		CUSTOMER COPY	FCI www.fciconnect.com
ltr	ecn no	dr	date	linear	.X ±.3		
H	ELX-N-14762	JOHN	05/15/13		.XX ±.13	projection	title 2 x 34 POS.PCMCIA RECEPTACLE ASSEMBLY
C	V60627	RHG	4/9/96	angles	.XXX ±.051	MM	
D	V61473	RHG	10/10/96	dr	0' ±2'	scale	product family PC CARD
E	V03-1287	PJ	12/09/03	enrg		1:1	code 213
F	V05-0791	DAI	08/22/05	chr			size dwg no
G	pg06-0352	P M	08/22/06	appd			95622
sheet	revision	H	H				sheet 1 of 2
index	sheet	1	2				

Tous droits strictement reserves. Reproduction ou communication a des tiers interdite sous quelque forme que ce soit sans autorisation ecrite du proprietaire. Propriete de c FCI. Droits de reproduction FCI.



All rights strictly reserved. Reproduction or issue to third parties in any form whatever is not permitted without written authority from the proprietor. Property of FCI. Copyright FCI.

PRODUCT NO.
95622-003
95622-003LF
95622-004LF

Tous droits strictement reserves. Reproduction ou communication a des tiers interdite sous quelque forme que ce soit sans autorisation ecrite du proprietaire. Propriete de c FCI. Droits de reproduction FCI.

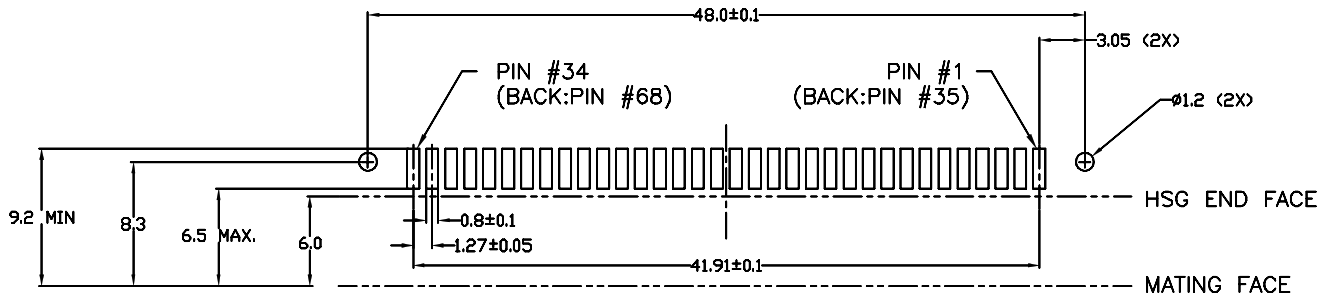
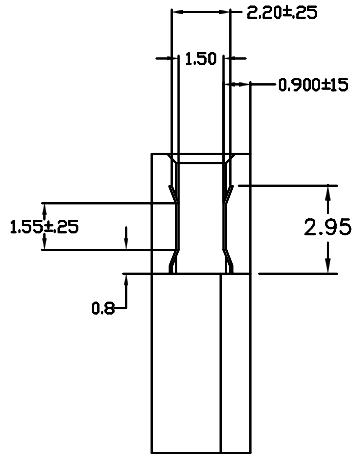

RECOMMENDED PWB FOOTPRINT LAYOUT

SECTION C-C  
SCALE 4:1

LEAD FREE NOTES:

1. IF LEAD FREE PART NUMBER, THE HOUSING WILL WITHSTAND EXPOSURE TO 260°C PEAK TEMPERATURE FOR 10 SECONDS IN A REFLOW SOLDER APPLICATION WITH A 1.60mm MIN THICK CIRCUIT BOARD.
2. LEAD FREE PRODUCTS MEET EUROPEAN UNION DIRECTIVES AND OTHER COUNTRY REGULATIONS AS DESCRIBED IN GS-22-008.

mat'l. code		tolerances unless otherwise specified		CUSTOMER COPY		FCI www.fciconnect.com	
ltr	ecn no	dr	date	linear	.X ±.3	projection	title 2 x 34 POS.PCMCIA RECEPTACLE ASSEMBLY
H					.XX ±.13		
					.XXX ±.051		
				angles	0° ±2°	MM ← → scale 1:1	product family PC CARD code 213 sheet 2 of 2
				dr	R.GRAPE 10/11/96		
				enr	D.BRANN 10/11/96		
				chr	D.BRANN 10/11/96		
				appd	D.BRANN 10/11/96		
sheet index	revision	sheet					



All rights strictly reserved. Reproduction or issue to third parties in any form whatever is not permitted without written authority from the proprietor. Property of FCI. Copyright FCI.