



Chipsmall Limited consists of a professional team with an average of over 10 year of expertise in the distribution of electronic components. Based in Hongkong, we have already established firm and mutual-benefit business relationships with customers from,Europe,America and south Asia,supplying obsolete and hard-to-find components to meet their specific needs.

With the principle of “Quality Parts,Customers Priority,Honest Operation,and Considerate Service”,our business mainly focus on the distribution of electronic components. Line cards we deal with include Microchip,ALPS,ROHM,Xilinx,Pulse,ON,Everlight and Freescale. Main products comprise IC,Modules,Potentiometer,IC Socket,Relay,Connector.Our parts cover such applications as commercial,industrial, and automotives areas.

We are looking forward to setting up business relationship with you and hope to provide you with the best service and solution. Let us make a better world for our industry!



Contact us

Tel: +86-755-8981 8866 Fax: +86-755-8427 6832

Email & Skype: info@chipsmall.com Web: www.chipsmall.com

Address: A1208, Overseas Decoration Building, #122 Zhenhua RD., Futian, Shenzhen, China



DESCRIPTION: **975 SERIES D-SUB BACKSHELL**

BACKSHELL KIT INCLUDES:

- (2) BACKSHELL HAVLES
- (2) 4-40 THUMBSCREWS
- (2) HOUSING SCREWS
- (1) STRAIN RELIEF CLAMP
- (2) STRAIN RELIEF SCREWS
- (2) CABLE SLOT SHUT-OFFS(9 POS HAS NONE)

975-YYY-010R011

SERIES _____

POSITIONS _____

009 _____

015 _____

025 _____

037 _____

MATERIAL _____

010 = PLASTIC

COLOR: _____

01 = BLACK

PUT-UPS _____

1 = KIT

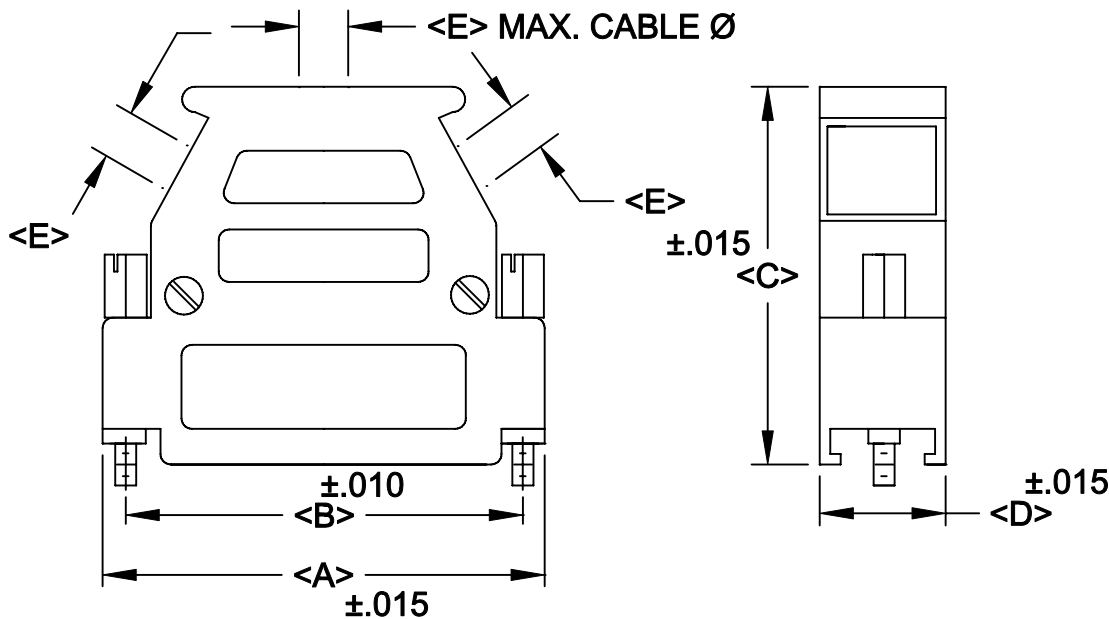

(9 POS DOES NOT HAVE SIDE ENTRIES)

POS.	A	B	C	D	E
9	1.213	.984	1.800	.600	.300
	30.81	24.99	45.72	15.24	7.62
15	1.541	1.312	1.800	.600	.335
	39.14	33.32	45.72	15.24	8.51
25	2.088	1.852	1.800	.600	.375
	53.04	47.04	45.72	15.24	9.53
37	2.735	2.500	1.800	.600	.400
	69.47	63.50	45.72	15.24	10.16

PLASTIC: ABS POLYLAC U.L. 94V-0
 THUMBSCREWS: STEEL
 HOUSING SCREWS: STEEL
 OPERATING TEMP: -30°C TO +90°C

RoHS COMPLIANT

	THESE DRAWINGS AND SPECIFICATIONS ARE THE PROPERTY OF NorComp AND SHALL NOT BE REPRODUCED, COPIED OR USED AS THE BASIS FOR THE MANUFACTURE OR SALE OF APPARATUS WITHOUT WRITTEN PERMISSION.		DRAWN: PAM JENKINS	DATE: 6-10-05
			CHECKED:	DATE:
NorComp	SCALE	SHEET	OF	REV 1
	DWG NO. 975-YYY-010R011			