



Chipsmall Limited consists of a professional team with an average of over 10 year of expertise in the distribution of electronic components. Based in Hongkong, we have already established firm and mutual-benefit business relationships with customers from,Europe,America and south Asia,supplying obsolete and hard-to-find components to meet their specific needs.

With the principle of “Quality Parts,Customers Priority,Honest Operation,and Considerate Service”,our business mainly focus on the distribution of electronic components. Line cards we deal with include Microchip,ALPS,ROHM,Xilinx,Pulse,ON,Everlight and Freescale. Main products comprise IC,Modules,Potentiometer,IC Socket,Relay,Connector.Our parts cover such applications as commercial,industrial, and automotives areas.

We are looking forward to setting up business relationship with you and hope to provide you with the best service and solution. Let us make a better world for our industry!



## Contact us

Tel: +86-755-8981 8866 Fax: +86-755-8427 6832

Email & Skype: info@chipsmall.com Web: www.chipsmall.com

Address: A1208, Overseas Decoration Building, #122 Zhenhua RD., Futian, Shenzhen, China



# Wave Distortion Monitor Verification Tester Operation Instructions



Made in the  
United States of America



Figure 1. Desco [98221](#) Wave Distortion Monitor Verification Tester

## Description

The Desco [98221](#) Wave Distortion Monitor Verification Tester is used to perform periodic test limit verification of [Desco Wave Distortion Monitors](#). Verification may be accomplished without removing the monitor from its workstation. The Wave Distortion Monitor Verification Tester is National Institute of Standards and Technology ([NIST](#)) traceable. Frequency of verification is based on the critical nature of the ESD susceptible items handled. Desco recommends annual calibration of workstation monitors and the Wave Distortion Monitor Verification Tester.

Desco Single-Wire Wave Distortion Continuous Monitors are defined in ESD TR1.0-01-01 as impedance continuous monitors. Most metrology departments or companies specializing in calibration will not have the specialized test equipment needed for the calibration or verification of wave distortion continuous monitors. The Desco [98221](#) Wave Distortion Monitor Verification Tester meets ANSI/ESD S20.20 and Compliance Verification ESD TR53.

The Desco [98221](#) Wave Distortion Monitor Verification Tester can be used with the following items:

Item	Description
<a href="#">19239</a>	Mini Monitor
<a href="#">19242</a>	Mini Monitor
<a href="#">19243</a>	Mini Monitor
<a href="#">19651</a>	Multi-Mount Monitor
<a href="#">19652</a>	Multi-Mount Monitor
<a href="#">19246</a>	Dual Operator Continuous Monitor
<a href="#">19247</a>	Dual Operator Continuous Monitor
<a href="#">19325</a>	Full-Time Continuous Monitor
<a href="#">50543</a>	Full-Time Continuous Monitor
<a href="#">50544</a>	Full-Time Continuous Monitor

## Packaging

- 1 Wave Distortion Monitor Verification Tester
- 1 [09700](#) Alligator Clip
- 1 [09782](#) 10mm Stacking Snap
- 1 [09838](#) Ground Plug Adapter
- 1 Banana Plug Wire Adapter, 5"
- 1 Ground Extension Cord, 5'
- 1 Certificate of Calibration



## Features and Components

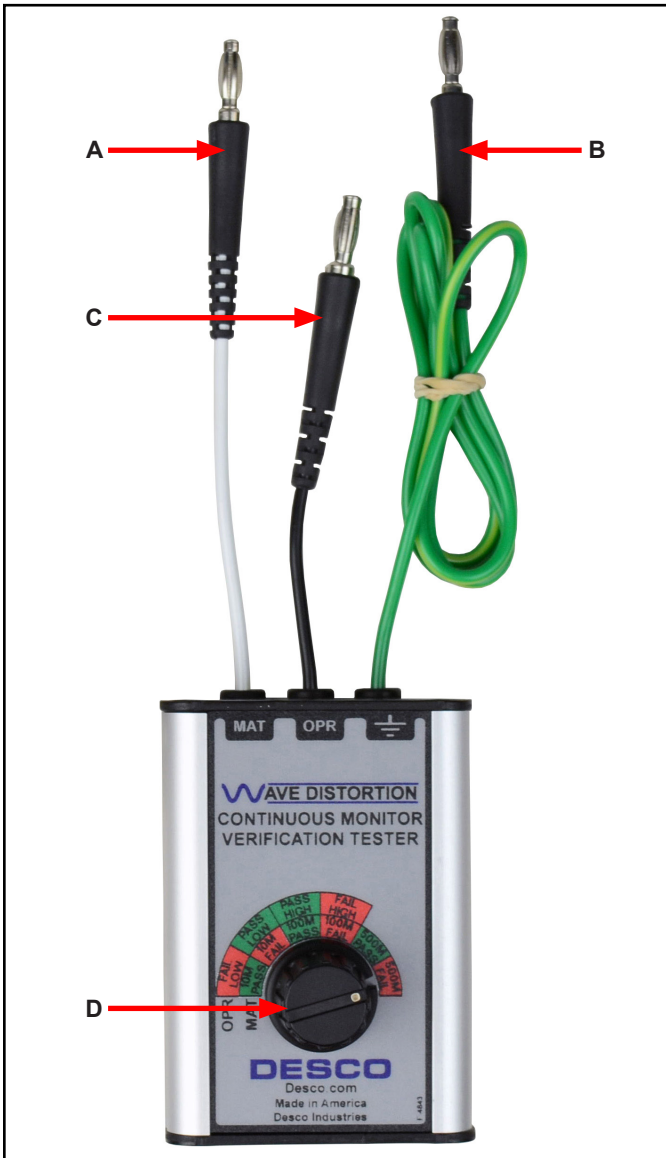

Figure 2. Wave Distortion Monitor Verification Tester features and components

- A. Mat Test Lead:** Connect to the monitor's mat terminal to verify its mat test circuit.
- B. Ground Lead:** Connect to equipment ground to provide a ground reference for the Wave Distortion Monitor Verification Tester.
- C. Operator Test Lead:** Insert into the monitor's operator jack to verify its operator test circuit.
- D. Rotary Switch:** Selects the various pass and fail load values needed to verify the monitor's operator and mat test circuits.

## Operation

### Mini Monitor

#### VERIFYING THE OPERATOR CIRCUIT

1. Connect the Wave Distortion Monitor Verification Tester's green ground lead to equipment ground. This may be done using the included Ground Plug Adapter or alligator clip.

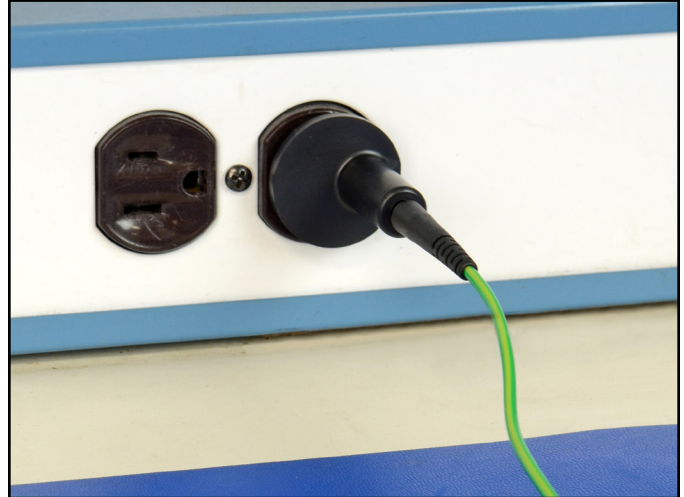

Figure 3. Using the Ground Plug Adapter to ground the Wave Distortion Monitor Verification Tester

2. Insert the verification tester's black operator test lead into the Mini Monitor's operator jack.



Figure 4. Connecting the Wave Distortion Monitor Verification Tester to the Mini Monitor's operator jack

3. Set the rotary switch to OPERATOR FAIL LOW. The monitor's red operator LED should illuminate, and its audible alarm should sound.
4. Set the rotary switch to OPERATOR PASS LOW. The monitor's green operator LED should illuminate.
5. Set the rotary switch to OPERATOR PASS HIGH. The monitor's green operator LED should illuminate.
6. Set the rotary switch to OPERATOR FAIL HIGH. The monitor's red operator LED should illuminate, and its audible alarm should sound.
7. Disconnect the operator test lead from the monitor.

#### VERIFYING THE MAT CIRCUIT

8. Connect the included stacking snap to the verification tester's white mat test lead.
9. Disconnect the monitor from its worksurface mat and turn it over to expose its 10mm snaps.
10. Connect the verification tester's white mat test lead to the monitor's 10mm mat snap.

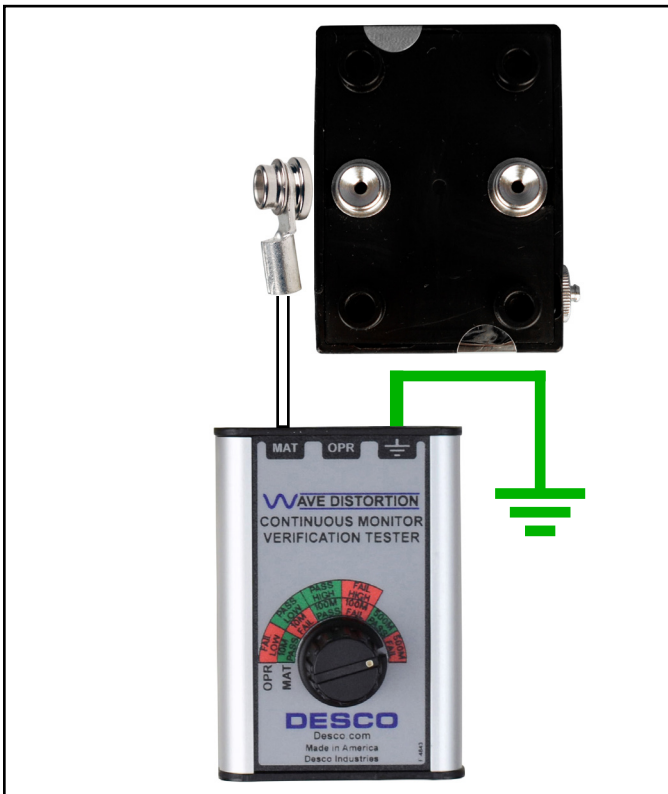

Figure 5. Connecting the Wave Distortion Monitor Verification Tester to the Mini Monitor's 10mm mat snap

11. Set the rotary switch to MAT 500M PASS. The monitor's green operator LED should illuminate.
12. Set the rotary switch to MAT 500M FAIL. The monitor's red operator LED should illuminate, and its audible alarm should sound.

## Multi-Mount Monitor

#### VERIFYING THE OPERATOR CIRCUIT

1. Connect the Wave Distortion Monitor Verification Tester's green ground lead to equipment ground. This may be done using the included Ground Plug Adapter or alligator clip. See Figure 3.
2. Insert the verification tester's black operator test lead into the Multi-Mount Monitor's operator jack.



Figure 6. Connecting the Wave Distortion Monitor Verification Tester to the Mini Monitor's operator jack

3. Set the rotary switch to OPERATOR FAIL LOW. The monitor's red operator LED should illuminate, and its audible alarm should sound.
4. Set the rotary switch to OPERATOR PASS LOW. The monitor's green operator LED should illuminate.
5. Set the rotary switch to OPERATOR PASS HIGH. The monitor's green operator LED should illuminate.
6. Set the rotary switch to OPERATOR FAIL HIGH. The monitor's red operator LED should illuminate, and its audible alarm should sound.
7. Disconnect the operator test lead from the monitor.

#### VERIFYING THE MAT CIRCUIT

8. Connect the included stacking snap to the verification tester's white mat test lead.
9. Disconnect the monitor's white mat monitor cord from its worksurface mat and turn it over to expose its 10mm snap.
10. Connect the verification tester's white mat test lead to the mat monitor cord's 10mm snap.

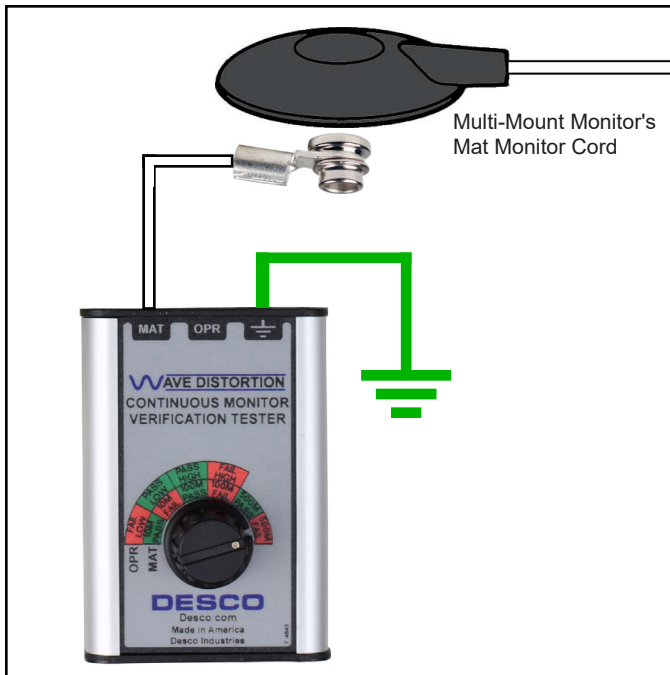

Figure 7. Connecting the Wave Distortion Monitor Verification Tester to the Multi-Mount Monitor's mat monitor cord

11. Set the rotary switch to MAT 10M PASS. The monitor's green operator LED should illuminate.
12. Set the rotary switch to MAT 10M FAIL. The monitor's red operator LED should illuminate, and its audible alarm should sound.

## Dual Operator Continuous Monitor

### VERIFYING THE OPERATOR CIRCUIT

1. Connect the Wave Distortion Monitor Verification Tester's green ground lead to equipment ground. This may be done using the included Ground Plug Adapter or alligator clip. See Figure 3.
2. Insert the verification tester's black operator test lead into the satellite remote's operator jack.



Figure 8. Connecting the Wave Distortion Monitor Verification Tester to the satellite remote's operator jack

3. Set the rotary switch to OPERATOR FAIL LOW. The monitor's red operator LED should illuminate, and its audible alarm should sound.
4. Set the rotary switch to OPERATOR PASS LOW. The monitor's green operator LED should illuminate.
5. Set the rotary switch to OPERATOR PASS HIGH. The monitor's green operator LED should illuminate.
6. Set the rotary switch to OPERATOR FAIL HIGH. The monitor's red operator LED should illuminate, and its audible alarm should sound.
7. Disconnect the operator test lead from the monitor.

### VERIFYING THE MAT CIRCUIT

8. Connect the included stacking snap to the verification tester's white mat test lead.
9. Disconnect the satellite remote's black mat monitor cord from its worksurface mat and turn it over to expose its 10mm snap.
10. Connect the verification tester's white mat test lead to the mat monitor cord's 10mm snap.



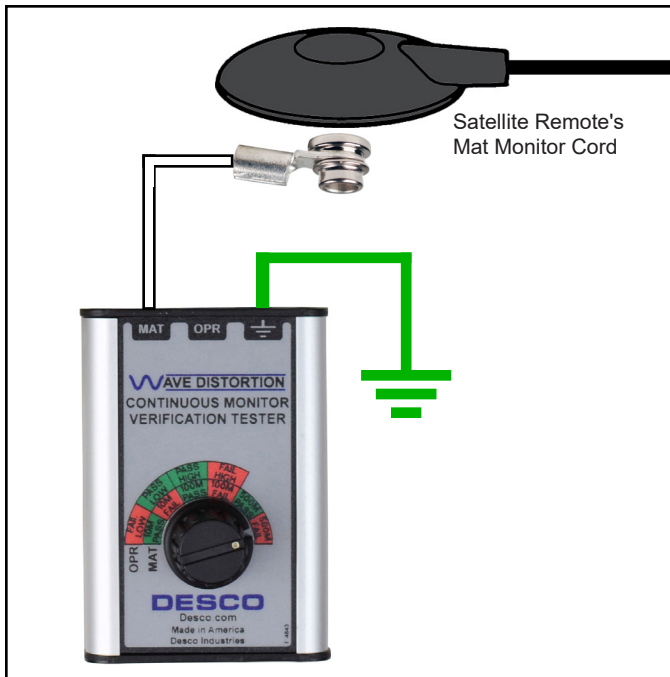

Figure 9. Connecting the Wave Distortion Monitor Verification Tester to the satellite remote's mat monitor cord

11. Set the rotary switch to MAT 10M PASS. The monitor's green operator LED should illuminate.
12. Set the rotary switch to MAT 10M FAIL. The monitor's red operator LED should illuminate, and its audible alarm should sound.
13. Repeat steps 1-12 for the second satellite remote.

## Full-Time Continuous Monitor

### VERIFYING THE OPERATOR CIRCUIT

1. Connect the Wave Distortion Monitor Verification Tester's green ground lead to equipment ground. This may be done using the included Ground Plug Adapter or alligator clip. See Figure 3.
2. Insert the verification tester's black operator test lead into the Full-Time Continuous Monitor's operator jack.

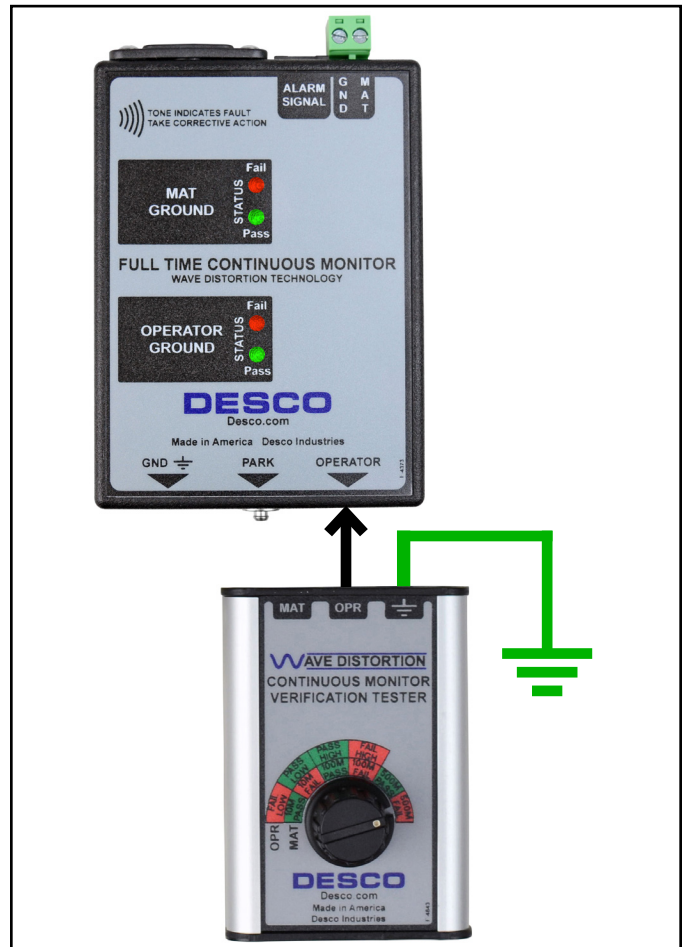

Figure 10. Connecting the Wave Distortion Monitor Verification Tester to the Full-Time Continuous Monitor's operator jack

3. Set the rotary switch to OPERATOR FAIL LOW. The monitor's red operator LED should illuminate, and its audible alarm should sound.
4. Set the rotary switch to OPERATOR PASS LOW. The monitor's green operator LED should illuminate.
5. Set the rotary switch to OPERATOR PASS HIGH. The monitor's green operator LED should illuminate.
6. Set the rotary switch to OPERATOR FAIL HIGH. The monitor's red operator LED should illuminate, and its audible alarm should sound.
7. Disconnect the operator test lead from the monitor.

## VERIFYING THE MAT CIRCUIT

8. Connect the included stacking snap to the verification tester's white mat test lead.
9. Disconnect the monitor's black mat monitor cord from its worksurface mat and turn it over to expose its 10mm snap.
10. Connect the verification tester's white mat test lead to the mat monitor cord's 10mm snap.



Figure 11. Connecting the Wave Distortion Monitor Verification Tester to the Full-Time Continuous Monitor's mat monitor cord

11. Set the rotary switch to MAT 10M PASS. The monitor's green operator LED should illuminate.
12. Set the rotary switch to MAT 10M FAIL. The monitor's red operator LED should illuminate, and its audible alarm should sound.

## Calibration

Frequency of recalibration should be based on the critical nature of those ESD sensitive items handled and the risk of failure for the ESD protective equipment and materials. In general, Desco recommends that calibration be performed annually.

Use the information below to verify if the Wave Distortion Monitor Verification Tester operates within its specifications.

### EQUIPMENT NEEDED

- RLC Bridge for testing operator circuit
- Digital Multimeter with 50-100V power supply for testing mat circuit

### SETTINGS

- @ 50 Hz  
Frequency = 1,000 Hz (20 x 50), 20th harmonic
- @ 60 Hz  
Frequency = 1,020 Hz (17 x 60), 17th harmonic
- Set function switch to read "Equivalent Parallel Circuit"

### RECORD THE FOLLOWING DATA

Operator Rotary Switch Setting	Equivalent Parallel Capacitance	Targeted Specification ( $\pm 10\%$ )
Fail Low		138.9 pF
Pass Low		118.6 pF
Pass High		49.0 pF
Fail High		44.7 pF

Operator Rotary Switch Setting	Dissipation Factor	Targeted Specification ( $\pm 10\%$ )
Fail Low		.158
Pass Low		.367
Pass High		.445
Fail High		.192

Mat Rotary Switch Setting	Resistance @ 50V	Targeted Specification ( $\pm 4\%$ )
10M Pass		8 megohms
10M Fail		12 megohms
100M Pass		80 megohms
100M Fail		120 megohms
500M Pass		400 megohms
500M Fail		600 megohms

## Specifications

Operating Temperature	50 to 95°F (10 to 35°C)
Environmental Requirements	Indoor use only at altitudes less than 6500 ft. (2 km) Maximum relative humidity of 80% up to 85°F (30°C) decreasing linearly to 50% @ 85°F (30°C)
Dimensions	3.17" L x 2.25" W x 1.26" H (81 mm x 57 mm x 32 mm)
Weight	0.3 lbs. (0.15 kg)
Country of Origin	United States of America

The Desco [98221](#) Wave Distortion Monitor Verification Tester may also be used with the following discontinued items:

Jewel® Workstation Continuous Mini Monitor	19212, 19213, 19214, 19215, 19216, 19217, 19218
Multi-Mount Continuous Monitor	19220, 19221, 19222, 19223, 19226, 19227, 19228, 19229, 19234, 19236, 98225, 98226, 98227, 98228
Dual Operator Continuous Monitor	19208, 19209, 19230, 19231, 19232, 19233, 19237, 19238, 98207, 98208
Full-Time Continuous Monitor	19210, 19211, 19225, 98210, 98211

### Limited Warranty, Warranty Exclusions, Limit of Liability and RMA Request Instructions

See the Desco Warranty -

<http://desco.descoindustries.com/Limited-Warranty.aspx>