



Chipsmall Limited consists of a professional team with an average of over 10 year of expertise in the distribution of electronic components. Based in Hongkong, we have already established firm and mutual-benefit business relationships with customers from,Europe,America and south Asia,supplying obsolete and hard-to-find components to meet their specific needs.

With the principle of “Quality Parts,Customers Priority,Honest Operation,and Considerate Service”,our business mainly focus on the distribution of electronic components. Line cards we deal with include Microchip,ALPS,ROHM,Xilinx,Pulse,ON,Everlight and Freescale. Main products comprise IC,Modules,Potentiometer,IC Socket,Relay,Connector.Our parts cover such applications as commercial,industrial, and automotives areas.

We are looking forward to setting up business relationship with you and hope to provide you with the best service and solution. Let us make a better world for our industry!



Contact us

Tel: +86-755-8981 8866 Fax: +86-755-8427 6832

Email & Skype: info@chipsmall.com Web: www.chipsmall.com

Address: A1208, Overseas Decoration Building, #122 Zhenhua RD., Futian, Shenzhen, China



Electro-mechanical impulse counters totalizing - 24 x 48

- Front panel 24 x 48 mm
- 6 or 5 digits, 4 mm in height
- With or without manual zero reset
- White digits on black background

Characteristics

Counting capacity	999 999 imp without zero reset 99 999 imp with zero reset
Height of digits	4 mm
Max. count rate	~ 18 imp/s --- 25 imp/s
Min. count rate	~ 28 ms --- 20 ms
Min. pause time between 2 pulses	~ 28 ms --- 20 ms
Max. pulse length (count coil)	No limit
Voltage variation	+10% / -15% from Un
Operation factor	100%
Absorbed power	24 V~ / 115 V~ 1.1 VA 230 V~ 2.1 VA 24 V--- 0.8 W
Mechanical life (count function)	> 50 x 10 ⁶ operations
Voltage tests to IEC 255 100	U ≤ 60 V : 500 V U > 60 V : 2000 V
Protection	Case IP 40 Terminal IP 00
Environmental protection	Metal parts protected (by surface treatment) or non-corroding
Maintenance	None
Operates in any position	Yes
Temperature limits	Use - 10 + 60 °C Stored - 40 + 80 °C
Connections	6.35 faston connectors or link screws
Mounting	2 x M3 screws - F90° on front panel
Weight	50 g

Other voltages : please consult us

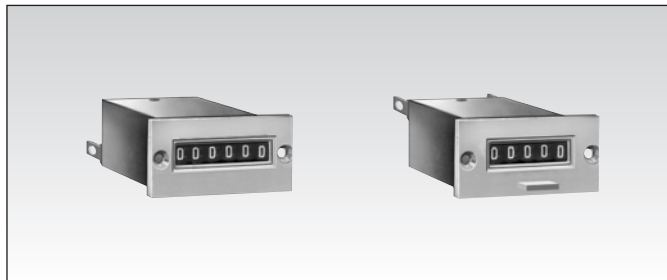

Part numbers (and voltages)

Reset	Without (A)	Manual (B)
230 V - 50 • 60 Hz	99 766 901	99 766 921
115 V - 50 • 60 Hz	99 766 902	99 766 922
24 V - 50 • 60 Hz	99 766 904	99 766 924
24 V ---	99 766 907	99 766 927

N.B.

No count pulse must be received during the zero reset time. If a pulse is received damage may be caused.

Dimensions

24 x 48 - 5 decades **99 766 92●**

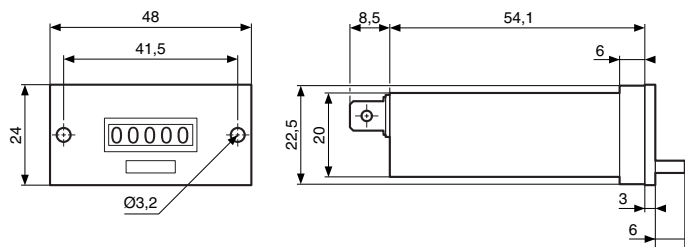

24 x 48 - 6 decades **99 766 90●**

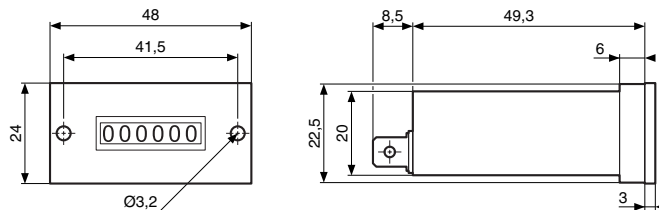

Rear panels

99 766 92●

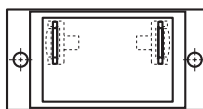

99 766 90●

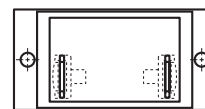

Panel cut-out **99 766 9●●**

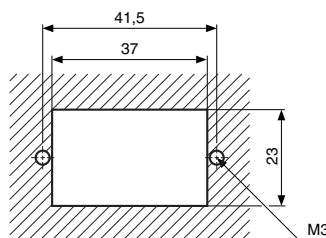

To order, specify :

1

Part number

Example : Electro-mechanical impulse counters totalizing - 6 decades - 99 766 901

Products and specifications subject to change without notice.

Consult factory for application assistance.