



Chipsmall Limited consists of a professional team with an average of over 10 year of expertise in the distribution of electronic components. Based in Hongkong, we have already established firm and mutual-benefit business relationships with customers from,Europe,America and south Asia,supplying obsolete and hard-to-find components to meet their specific needs.

With the principle of "Quality Parts,Customers Priority,Honest Operation,and Considerate Service",our business mainly focus on the distribution of electronic components. Line cards we deal with include Microchip,ALPS,ROHM,Xilinx,Pulse,ON,Everlight and Freescale. Main products comprise IC,Modules,Potentiometer,IC Socket,Relay,Connector.Our parts cover such applications as commercial,industrial, and automotives areas.

We are looking forward to setting up business relationship with you and hope to provide you with the best service and solution. Let us make a better world for our industry!



## Contact us

Tel: +86-755-8981 8866 Fax: +86-755-8427 6832

Email & Skype: info@chipsmall.com Web: www.chipsmall.com

Address: A1208, Overseas Decoration Building, #122 Zhenhua RD., Futian, Shenzhen, China



1

2

3

4

5

6

7

Male

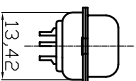
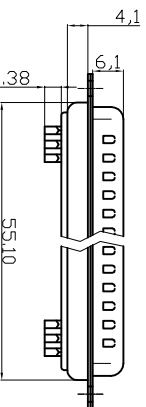
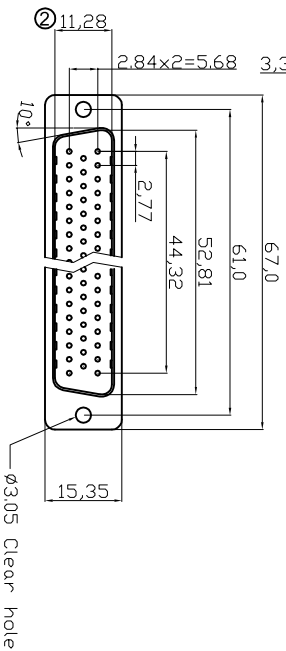
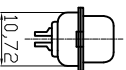
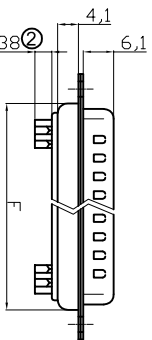
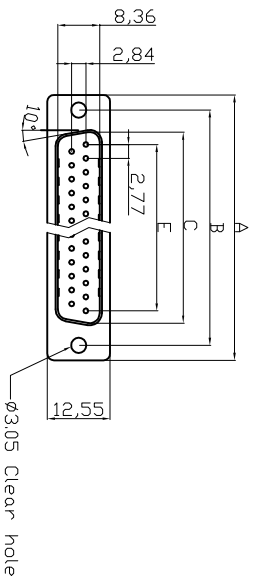

50 Positions

Dimensions	A	B	C	E	F
9	30.81	24.99	16.92	11.08	19.20
15	39.20	33.30	25.25	19.39	27.70
25	53.04	47.04	38.96	33.24	41.10
37	69.40	63.50	55.42	49.86	57.30

**Electrical**  
 Contact Resistance : 20 milliohms Max at 1 AMP DC.  
 Insulation Resistance : 1000 megohms at 500 VDC  
 Dielectric Withstanding Voltage : 1000 VAC/rms 60Hz for 1 minute  
 Current Rating : 3 AMP  
 Voltage Rating : 250 VAC/rms 60Hz  
 ① OPERATING TEMPERATURE:-55°C+105°C  
 Order Code:

A-Dx xx LLZ  
 Contact style: LLZ - Selective gold\*  
 F - Female  
 S - Male  
 No. of Contacts 09 / 19 / 29 / 37  
 \* Quality class III



RoHS compliant

Unit: mm

Scale	Free	
TOLERANCE		
X.	±0.38	② Cancel "Cinch Nut" & "Screwlock"
X.X	±0.25	③ Add the UL number
X.XX	±0.13	② Update the dimension
DIM	TOL	① Update operation temperature range
X.°	±3°	① Drawn
X.X°	±1.0°	
Angle	TOL	Id.

Date	Name
17.06.2016	Winnie
03.04.2015	Winnie
27.02.2015	Winnie
13.05.2014	Winnie
15.08.2012	Lucas

Customer-No.	ASSMANN WSW-No.	Drawing-No.	Replace
		A-Dx xx LLZ	ASS 4884 CO
			rev04

1

2

3

4

5

6

7

H

G

H

H

H

H

H

H

1

2

3

4

5

6

7

Female

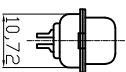
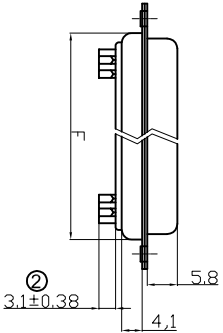
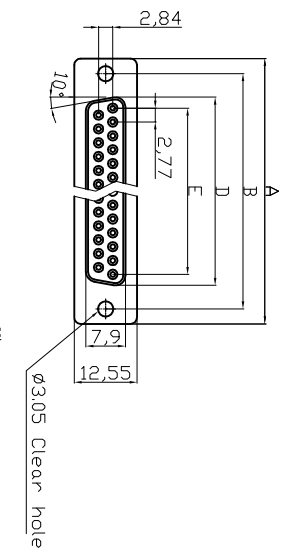

Electrical

- Contact Resistance : 20 milliohms Max at 1 AMP DC.
- Insulation Resistance : 1000 mohms at 500 VDC
- Dielectric Withstanding Voltage :1000 VAC/rms 60Hz for 1 minute
- Current Rating : 3 AMP
- Voltage Rating : 250 VAC/rms 60Hz
- Operating Temperature : -55°C+105°C

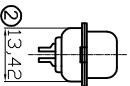
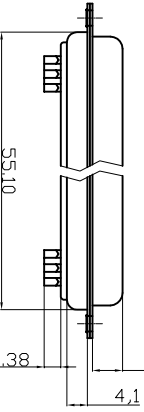
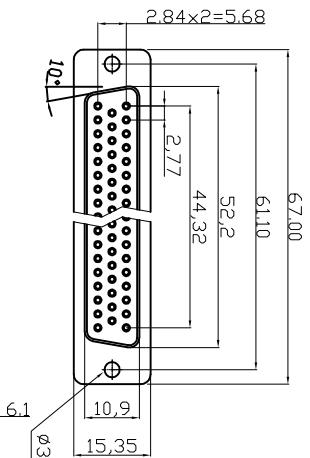

Dimensions Positions	A	B	D	E	F
9	30.81	24.99	16.33	11.08	19.20
15	39.20	33.30	24.70	19.39	27.70
25	53.05	47.04	38.40	33.24	41.10
37	69.40	63.50	54.84	49.86	57.30

50 Positions

RoHS compliant

Unit:mm



File No.: E198287

Scale	Free				
TOLERANCE					
X.	±0.38	④ Cancel "Clinch Nut "&"Screwlock"	17.06.2016	Winnie	Drawn
X.X	±0.25	③ Add the UL number	03.04.2015	Winnie	Approved
X.XX	±0.13	② Update the dimension	27.02.2015	Winnie	
DIM	TOL	① Update operation temperature range	13.05.2014	Winnie	
X.°	±3°	① Drawn	15.08.2012	Lucas	
X.X°	±1.0°				
Angle	TOL	Id.	Modification	Date	Name

Product Specification

- Material
- Insulator : Glass-Filled Thermoplastic PBT UL94V-0,White
- Contact : Brass or Phosphor Bronze, Gold flash selective gold plating
- Shell : Steel, refer to ordering information for plating
- Boardlock : Brass, Nickel Plated

Customer-No.

ASSMANN WSW-No.

A-Dx XX LL/Z

Drawing-No.

ASS 4884 CO

rev04



Replace

Sheet 2/2

1

2

3

4

5

6

7

H

G

F

E

D

C

B

A

H

G

F

E

D

C

B

A