



Chipsmall Limited consists of a professional team with an average of over 10 year of expertise in the distribution of electronic components. Based in Hongkong, we have already established firm and mutual-benefit business relationships with customers from,Europe,America and south Asia,supplying obsolete and hard-to-find components to meet their specific needs.

With the principle of “Quality Parts,Customers Priority,Honest Operation,and Considerate Service”,our business mainly focus on the distribution of electronic components. Line cards we deal with include Microchip,ALPS,ROHM,Xilinx,Pulse,ON,Everlight and Freescale. Main products comprise IC,Modules,Potentiometer,IC Socket,Relay,Connector.Our parts cover such applications as commercial,industrial, and automotives areas.

We are looking forward to setting up business relationship with you and hope to provide you with the best service and solution. Let us make a better world for our industry!



## Contact us

Tel: +86-755-8981 8866 Fax: +86-755-8427 6832

Email & Skype: info@chipsmall.com Web: www.chipsmall.com

Address: A1208, Overseas Decoration Building, #122 Zhenhua RD., Futian, Shenzhen, China



THIS IS A CAD GENERATED DRAWING  
DO NOT MAKE MANUAL REVISIONS TO MASTER.

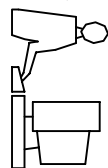

ISSUE NUMBER	7
UPDATE DRAWING	R.STAMONICA JUN.27/2012
ADD PCB TOLERANCE	DIM 03.30 WAS 03.20
R.STAMONICA	OCT.20/2015

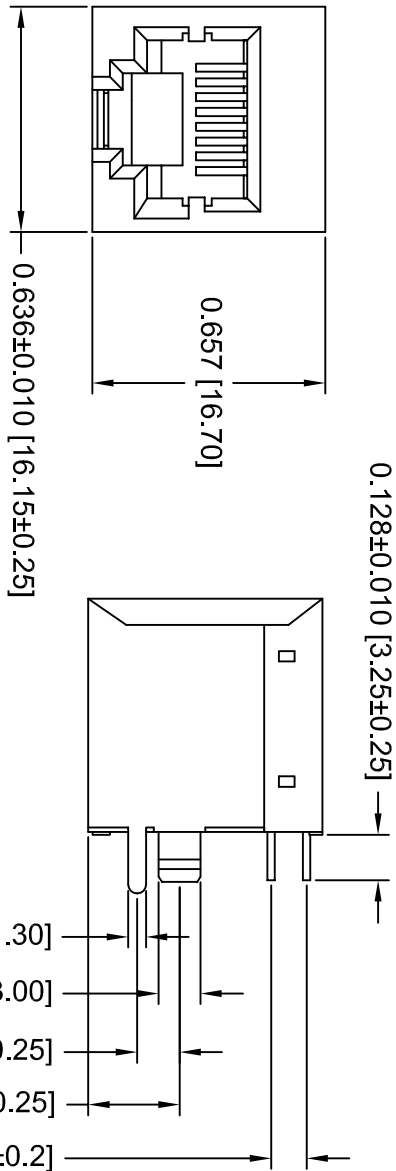

**NOTE:**  
1. CAVITY CONFORMS TO FCC RULES REGULATIONS PART 68, SUBPART F.

**2. MATERIALS:**

HOUSING: PBT POLYESTER UL 94V-0  
MIXED GLASS FIBER  
STANDARD COLOR: BLACK  
SHIELD: 0.25MM THICK COPPER ALLOY,  
NICKEL PLATED  
CONTACTS: 0.35MM THICK PHOSPHOR  
BRONZE, WITH SELECTIVE  
GOLD PLATING ON CONTACT  
AREA AND GOLD FLASH  
PLATING AT SOLDER AREA

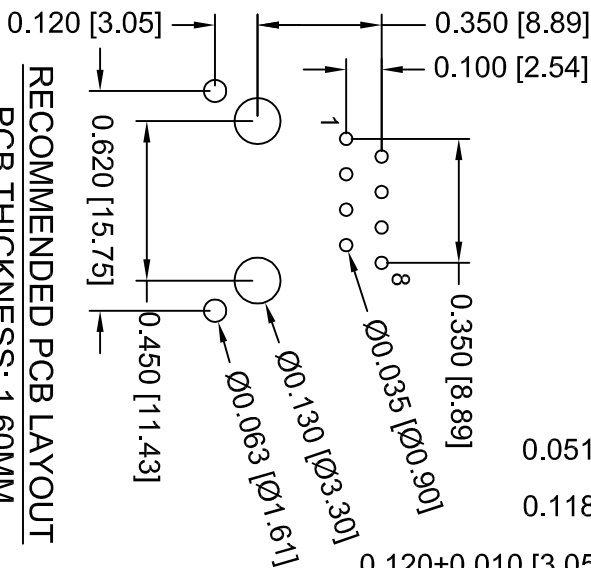
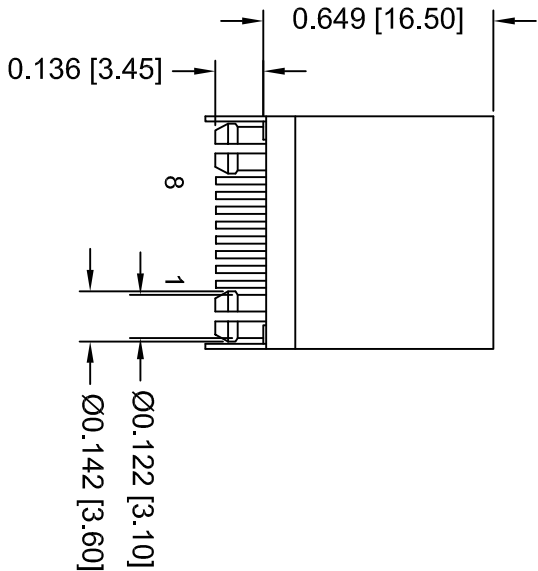

**RECOMMENDED PCB LAYOUT**  
PCB THICKNESS: 1.60MM  
TOLERANCE: ±0.05 [.002]

<b>PART NO.</b>	<b>GOLD PLATING</b>
A00-108-222-450	GOLD FLASH
A00-108-322-450	15 MICRONS OF GOLD
A00-108-622-450	30 MICRONS OF GOLD
A00-108-922-450	50 MICRONS OF GOLD

**SHIELDED RJ45  
TOP ENTRY P.C.B MODULAR JACK**

ACAD REF. DWG.: A00-108-222-450

DRAWN: F.JAWDI DATE: FEB. 11/03

CHECKED: DATE:

SCALE: 1:1 SHEET 1 OF 2

DRAWING NUMBER A00-108-222-450 ISSUE 8

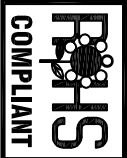

THIS SERIES FULLY CONFORMS TO THE  
EUROPEAN UNION DIRECTIVES AND  
2011/65/EU FOR ROHS COMPLIANCY.

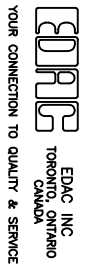

TOLERANCE UNLESS NOTED  
.00 mm ± 0.15  
.000 inch ± .006

ARE THE PROPERTY OF EDAC INC. AND  
SHALL NOT BE REPRODUCED OR COPIED  
OR USED AS THE BASIS FOR THE  
MANUFACTURE OR SALE OF APPARATUS  
WITHOUT WRITTEN PERMISSION.

YOUR CONNECTION TO QUALITY & SERVICE

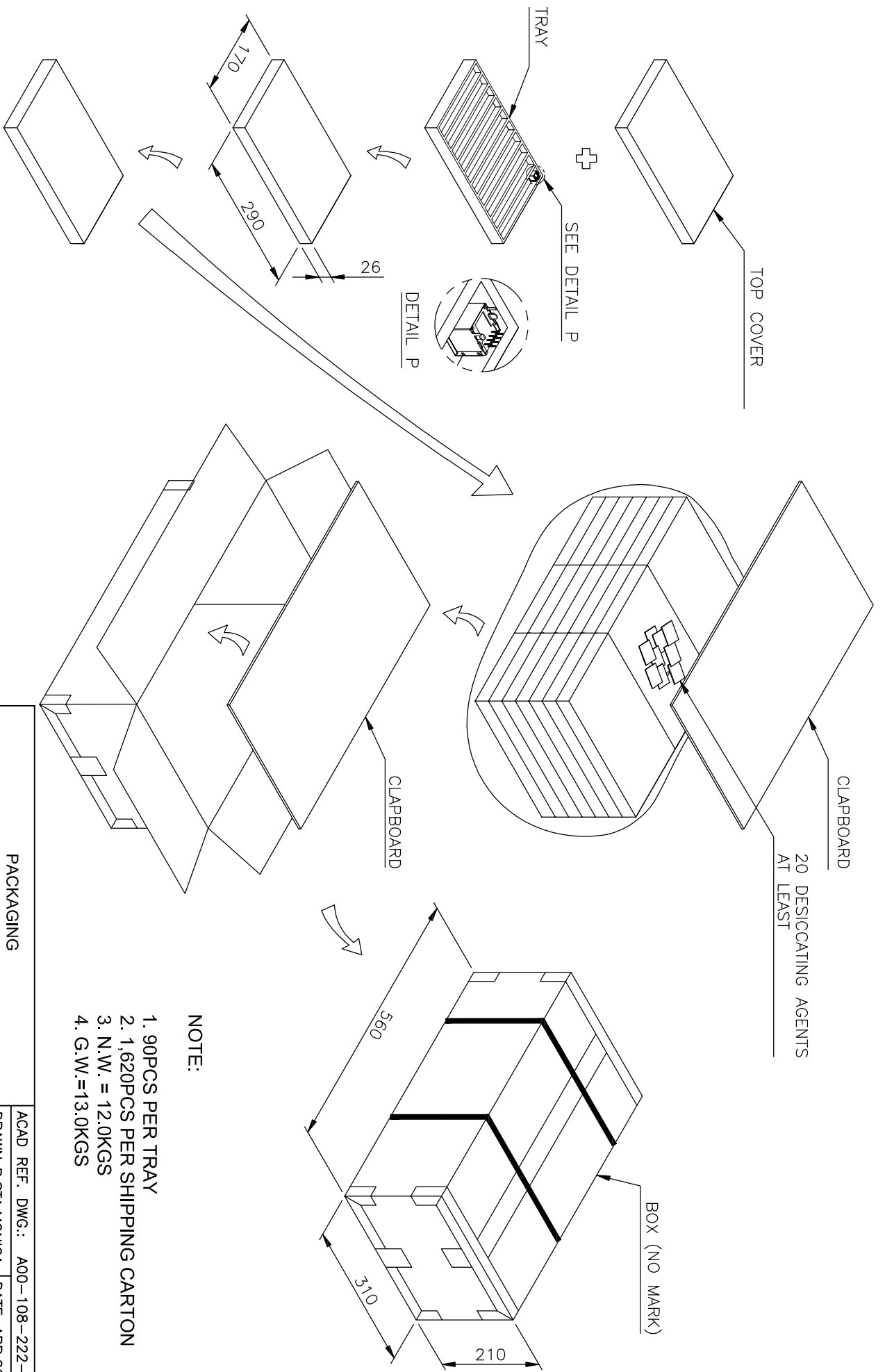

- NOTE:**
1. 90PCS PER TRAY
  2. 1,620PCS PER SHIPPING CARTON
  3. N.W. = 12.0KGS
  4. G.W.=13.0KGS



THIS SERIES FULLY CONFORMS TO THE EUROPEAN UNION DIRECTIVES AND 2011/65/EU FOR ROHS COMPLIANCY.

<b>PACKAGING</b>		<b>TOP ENTRY P.C.B MODULAR JACK</b>	
		TOLERANCE UNLESS NOTED .003 mm ± 0.15 .000 inch ± .006	
ARE THE PROPERTY OF EDAC INC. AND SHALL NOT BE REPRODUCED OR COPIED OR USED AS THE BASIS FOR THE MANUFACTURE OF ANY PRODUCT WITHOUT WRITTEN PERMISSION.		SCALE: 1:1 DRAWING NUMBER: A00-108-222-450	
ACAD REF. DWG.:	A00-108-222-450	DATE:	APR.22/14
DRAWN:	R.STA.MONICA	CHECKED:	DATE:
SHEET 2 OF 2		ISSUE 8	