



Chipsmall Limited consists of a professional team with an average of over 10 year of expertise in the distribution of electronic components. Based in Hongkong, we have already established firm and mutual-benefit business relationships with customers from,Europe,America and south Asia,supplying obsolete and hard-to-find components to meet their specific needs.

With the principle of “Quality Parts,Customers Priority,Honest Operation,and Considerate Service”,our business mainly focus on the distribution of electronic components. Line cards we deal with include Microchip,ALPS,ROHM,Xilinx,Pulse,ON,Everlight and Freescale. Main products comprise IC,Modules,Potentiometer,IC Socket,Relay,Connector.Our parts cover such applications as commercial,industrial, and automotives areas.

We are looking forward to setting up business relationship with you and hope to provide you with the best service and solution. Let us make a better world for our industry!



Contact us

Tel: +86-755-8981 8866 Fax: +86-755-8427 6832

Email & Skype: info@chipsmall.com Web: www.chipsmall.com

Address: A1208, Overseas Decoration Building, #122 Zhenhua RD., Futian, Shenzhen, China



TOLERANCE UNLESS OTHERWISE SPECIFIED IN MM:	ANGLE	X°
0		
0.00	± 0.38	
0.00	± 0.25	
0.00	± 0.10	

THIS IS A C.A.D. GENERATED DRAWING
DO NOT MAKE MANUAL REVISIONS TO MASTER.

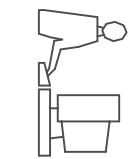

ISSUE NUMBER	1
ORIGINAL	

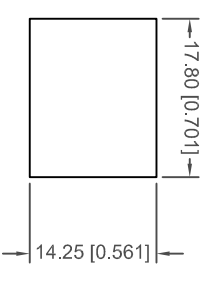
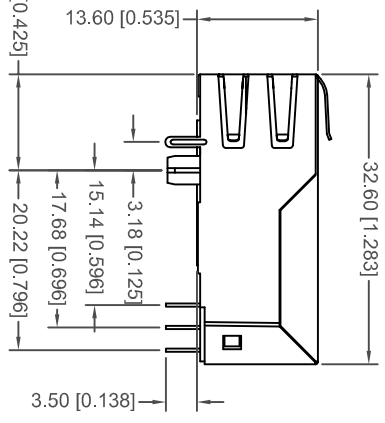
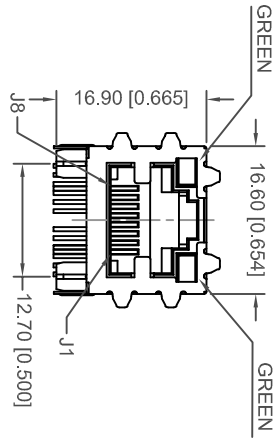

RECOMMENDED PANEL OPENING

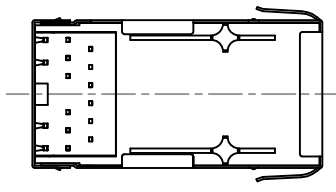

- NOTES:
1. MATERIALS:
HOUSING: THERMOPLASTIC, UL 94V-0, COLOR: BLACK
SHIELD: BRASS WITH NICKEL PLATING
CONTACTS: COPPER ALLOY PLATED WITH GOLD PLATING AND TIN IN SOLDER AREA

PART NO	GOLD PLATING THICKNESS
A60-112-233P471	GOLD FLASH PLATING
A60-113-233P471	15 MICRO INCHES OF GOLD
A60-114-233P471	30 MICRO INCHES OF GOLD
A60-115-233P471	50 MICRO INCHES OF GOLD

2. OPERATING TEMPERATURE: 0°C TO +70°C
3. STORAGE TEMPERATURE: -40°C TO +85°C
4. MATE WITH MODULAR PLUG CONFORMING TO FCC PART 68, SUBPART F.
5. RECOMMENDED TEMPERATURE FOR WAVE SOLDERING IS 260°C MAX, 10 SEC MAX
6. DIMENSION: MM [INCHES]

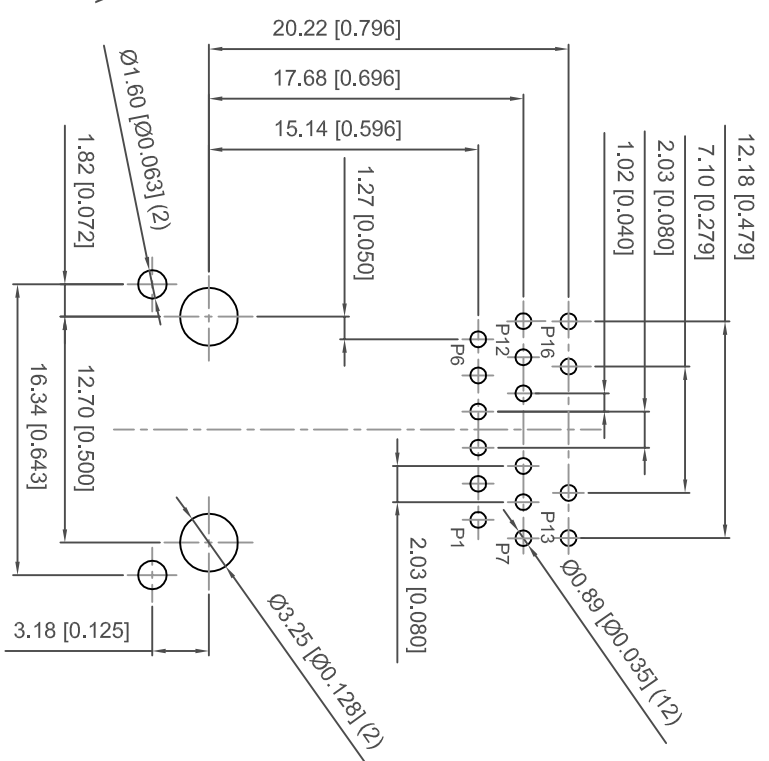

RECOMMENDED P.C.B. LAYOUT
TOLERANCE: ±0.08[±0.003]

RJ45 MAGNETIC JACK WITH LED, 12P, 8C SHIELDED, 10/100/1000 Mbps- FILTER

ACAD REFERENCE NO.: A60-112-233P471

DRAWN: R.STA.MONICA DATE: MAR.23/2012

CHECKED: DATE:

PART NUMBER SEE NOTE SHEET 1 OF 2

DRAWING NUMBER A60-112-233P471 ISSUE 1



THIS SERIES FULLY CONFORMS TO THE EUROPEAN UNION DIRECTIVES 2002/95/EC AND 2002/96/EC FOR ROHS COMPLIANCY.

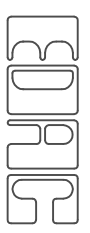

EDAC INC
TORONTO, ONTARIO
CANADA
YOUR CONNECTION TO QUALITY & SERVICE

THESE DRAWINGS AND SPECIFICATIONS ARE THE PROPERTY OF EDAC INC. AND SHALL NOT BE REPRODUCED OR COPIED OR USED AS THE BASIS FOR THE MANUFACTURE OR SALE OF APPARATUS WITHOUT WRITTEN PERMISSION.

ELECTRICAL CIRCUIT:

TOLERANCE UNLESS OTHERWISE SPECIFIED IN MM:		ANGLE	X°
0	± 0.38		
0.00	± 0.25		
0.000	± 0.10		

THIS IS A C.A.D. GENERATED DRAWING
DO NOT MAKE MANUAL REVISIONS TO MASTER.

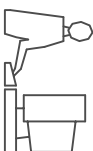

CONNECTOR SOLDER SIDE

RJ45 CONTACT SIDE

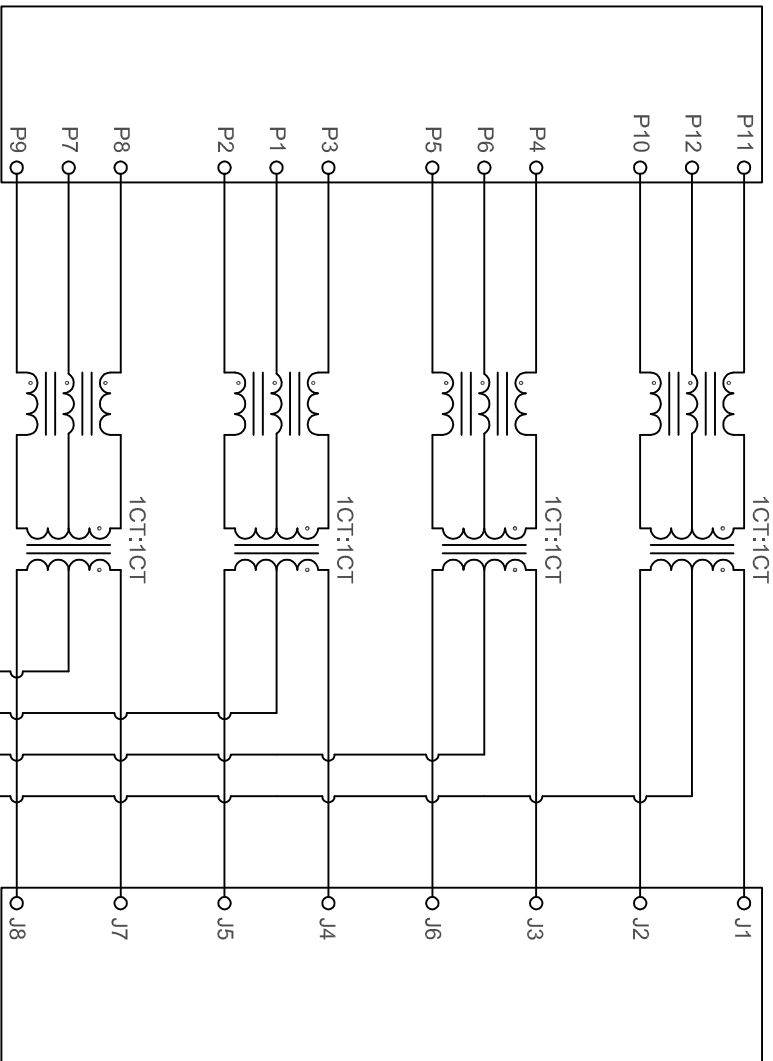

TEST NOTES:(25°±5°C)

- TR:(100KHz,0.1V): 100%
PINS:(P8,P9):(J7,J8)=1:1±3%;(P3,P2):(J4,J5)=1:1±5%
PINS:(P4,P5):(J3,J6)=1:1±5%;(P1,P10):(J1,J2)=1:1±5%
- LX:(100KHz,100mV,8mA, DC Bias) 100%
PINS:(P8,P9),(P3,P2),(P4,P5),(P1,P10)=350uH MINIMUM
- DC RESISTANCE: 1.2 OHMS MAXIMUM
- INSERTION LOSS:
-1.0 dB MINIMUM AT 1MHZ TO 100MHZ;
-1.2 dB MINIMUM AT 100MHZ TO 125MHZ;
- RETURN LOSS:
-16dB MAXIMUM AT 1MHZ TO 40MHZ;
-12dB MAXIMUM AT 40MHZ TO 60MHZ
-10dB MAXIMUM AT 60MHZ TO 80MHZ
-8dB MAXIMUM AT 80MHZ TO 100MHZ
- CROSS TALK:
-30dB MINIMUM AT 1MHZ TO 100MHZ
- COMMON TO COMMON MODE ATTENUATION:
-30dB MINIMUM AT 1MHZ TO 100MHZ
- ISOLATION PHY SIDE TO LINE SIDE: 2250 VDC



LED SPECIFICATIONS (WITH FORWARD CURRENT OF 20 mA)			
STANDARD LED	WAVELENGTH	FORWARD V (MAX)	TYP
GREEN	565 nm	2.4 V	2.2 V

**RJ45 MAGNETIC JACK WITH LED, 12P, 8C
SHIELDED, 10/100/1000 Mbps- FILTER**

ACAD REFERENCE NO.:	A60-112-233P471
DRAWN: R.STA.MONICA	DATE: MAR.23/2012
CHECKED:	DATE:

PART NUMBER	SEE NOTE	SHEET 2 OF 2
DRAWING NUMBER	A60-112-233P471	ISSUE
		1



THIS SERIES FULLY CONFORMS TO THE EUROPEAN UNION DIRECTIVES 2002/95/EC AND 2002/96/EC FOR ROHS COMPLIANCY.



EDAC INC
TORONTO, ONTARIO
CANADA

YOUR CONNECTION TO QUALITY & SERVICE

THESE DRAWINGS AND SPECIFICATIONS ARE THE PROPERTY OF EDAC INC. AND SHALL NOT BE REPRODUCED OR COPIED OR USED AS THE BASIS FOR THE MANUFACTURE OR SALE OF APPARATUS WITHOUT WRITTEN PERMISSION.