



Chipsmall Limited consists of a professional team with an average of over 10 year of expertise in the distribution of electronic components. Based in Hongkong, we have already established firm and mutual-benefit business relationships with customers from,Europe,America and south Asia,supplying obsolete and hard-to-find components to meet their specific needs.

With the principle of “Quality Parts,Customers Priority,Honest Operation,and Considerate Service”,our business mainly focus on the distribution of electronic components. Line cards we deal with include Microchip,ALPS,ROHM,Xilinx,Pulse,ON,Everlight and Freescale. Main products comprise IC,Modules,Potentiometer,IC Socket,Relay,Connector.Our parts cover such applications as commercial,industrial, and automotives areas.

We are looking forward to setting up business relationship with you and hope to provide you with the best service and solution. Let us make a better world for our industry!



Contact us

Tel: +86-755-8981 8866 Fax: +86-755-8427 6832

Email & Skype: info@chipsmall.com Web: www.chipsmall.com

Address: A1208, Overseas Decoration Building, #122 Zhenhua RD., Futian, Shenzhen, China



THIS COPY IS PROVIDED ON A RESTRICTED BASIS AND IS NOT TO BE USED IN ANY WAY DETRIMENTAL TO THE INTERESTS OF PANDUIT CORPORATION.

PANDUIT PART NUMBER	DIMENSIONS				MAXIMUM CABLE DIA. in. (mm)	ADHESIVE BACKING	WEIGHT lbs/100 pcs (g)/100 pcs
	A	B	C	D			
ACC38-A	1.00 (25.4)	1.00 (25.4)	0.49 (12.4)	0.40 (10.2) (REF)	0.380 (9.6)	RUBBER	0.40 (181)
ACC38-AT						ACRYLIC	
ACC38-AV						HIGH BOND ACRYLIC	

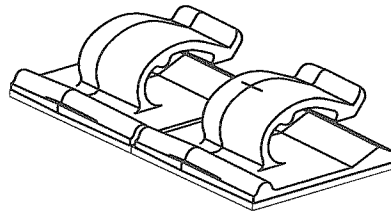
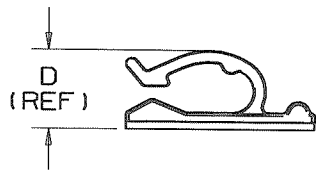
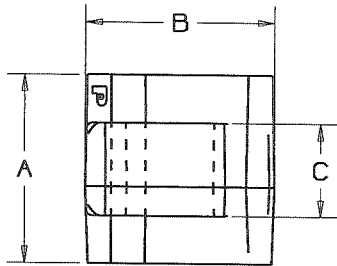

TWO UP CONFIGURATION
(AS SUPPLIED TO CUSTOMER)

NOTES:

- SEE CURRENT PRICE SHEET FOR PART NUMBER SUFFIX DESIGNATION FOR PACKAGE SIZE.

CAD FILENAME/LAYERS: G03597BB_DC_GB0239DY/00C

PANDUIT CORP.

TINLEY PARK, ILLINOIS

ACC38-A, ACC38-AT, ACC38-AV
ADHESIVE CORD CLIP

UNLESS OTHERWISE SPECIFIED,
DIMENSIONAL TOLERANCES ARE:
(.X) ±0.05 (1.3) (.XXX) ±0.010 (0.25)
(.XX) ±0.02 (.5) ANGLES ±5°

UNLESS OTHERWISE SPECIFIED,
ALL DIMENSIONS ARE GIVEN
IN INCHES, THIRD ANGLE PROJECTION

DRAWN BY
MLD

MAT'L:

SCALE
FULL

DATE
8-8-96

NYLON 6/6

DRAWING NO.

GB0239DY

DWG

A
SIZE

00C	11-6-09	TMSA	SMY	ADDED ACC38-AV PART NUMBER	GB0239DY	00C	KEN		
00B	6/23/08	DJSM		REVISED AND RE-RELEASED TO TEAMCENTER REV HISTORY; TABULARIZED DIMS, REMOVED .45 AND .27 DIMS, REVISED .38 DIM TO INCLUDE TAPE, TIGHTENED TOLERANCES, REMOVED APPLICATION, TAPE, AND WARRANTY NOTES	GB0239DY	00B			
I	10/30/00	CGSM		CHANGED DIMS TO REF, REMOVED .03 DIM, CHANGED APPLICATION NOTE 1	GB0239DY	I			
R	8-8-96	MLD		INITIAL RELEASE	GB0239DY	R			
REV	DATE	BY	CHK	DESCRIPTION	ECN	R	CUST	SUP	

CHK'D
KEN