



Chipsmall Limited consists of a professional team with an average of over 10 year of expertise in the distribution of electronic components. Based in Hongkong, we have already established firm and mutual-benefit business relationships with customers from,Europe,America and south Asia,supplying obsolete and hard-to-find components to meet their specific needs.

With the principle of “Quality Parts,Customers Priority,Honest Operation,and Considerate Service”,our business mainly focus on the distribution of electronic components. Line cards we deal with include Microchip,ALPS,ROHM,Xilinx,Pulse,ON,Everlight and Freescale. Main products comprise IC,Modules,Potentiometer,IC Socket,Relay,Connector.Our parts cover such applications as commercial,industrial, and automotives areas.

We are looking forward to setting up business relationship with you and hope to provide you with the best service and solution. Let us make a better world for our industry!



## Contact us

Tel: +86-755-8981 8866 Fax: +86-755-8427 6832

Email & Skype: [info@chipsmall.com](mailto:info@chipsmall.com) Web: [www.chipsmall.com](http://www.chipsmall.com)

Address: A1208, Overseas Decoration Building, #122 Zhenhua RD., Futian, Shenzhen, China



THIS DOCUMENT IS THE PROPERTY OF APDM COMPONENTS AND SHALL NOT BE COPIED, REPRODUCED, DISCLOSED OR USED AS THE BASIS FOR MANUFACTURING OR SALE WITHOUT PERMISSION OF A DUTY AUTHORIZED REPRESENTATIVE OF APDM COMPONENTS INC.

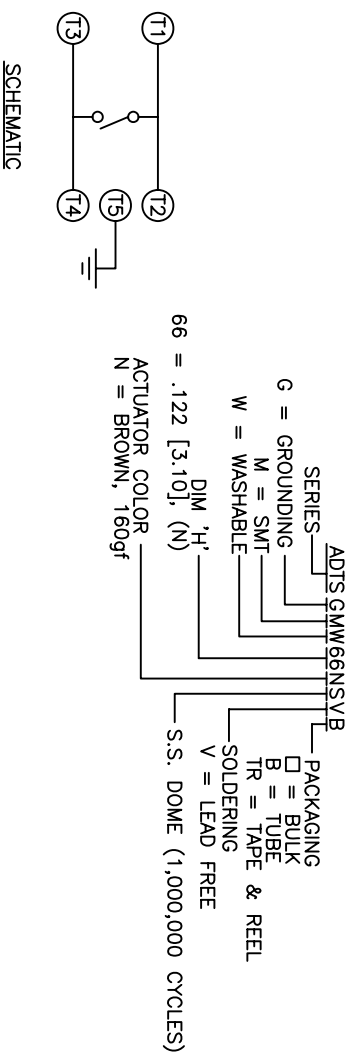
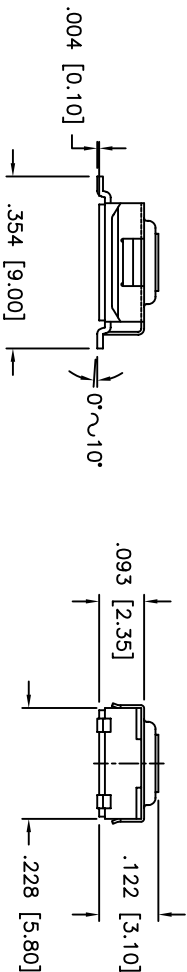
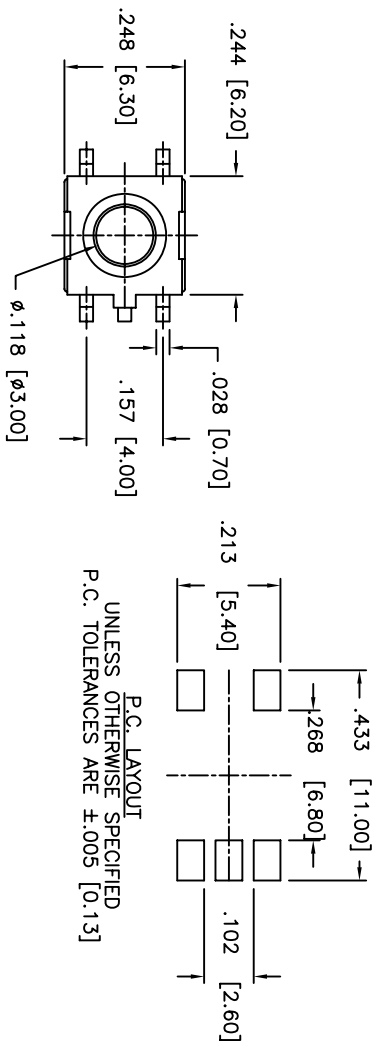

DESCRIPTION: SPST, NORMALLY OPEN, MOMENTARY, 6mm X 6mm, SURFACE MOUNT, WASHABLE, TACT SWITCH WITH GROUNDING PIN

SPECIFICATIONS:

CONTACT RATING: 50mA @ 12VDC

CONTACT RESISTANCE: 100mOHMS MAX.

INITIAL: 100 MOHMS MAX.

AFTER CYCLING: 10 OHMS MAX.

INSULATION RESISTANCE: 100MOHMS MIN. @ 500VDC

DIELECTRIC STRENGTH: 250VAC FOR 1 MINUTE

ELECTRICAL LIFE: 1,000,000 CYCLES MIN.

OPERATING TEMPERATURE RANGE: -25°C to +70°C

STOP STRENGTH: MAX 3kgf VERTICAL STATIC LOAD

CONT. FOR 15 SEC.

ACTION FORCE: SEE P/N DESCRIPTION

STORAGE TEMPERATURE RANGE: -30°C TO +80°C FOR 96 HRS

SHOCK RESISTANCE: 50G PER METHOD 213B, MIL-STD-202F

VIBRATION RESISTANCE: PASSES METHOD 201A, MIL-STD-202F

SOLDERING:

IR REFLOW: 255°C MAX.

HAND SOLDERING: 350°C MAX. FOR 5 SECONDS MAX.

LEAD FREE PROCESS COMPATIBLE

MATERIALS:

BASE: THERMOPLASTIC UL94V-0, COLOR BLACK

ACTUATOR: THERMOPLASTIC UL94V-0

COVER: NICKEL SILVER

TERMINALS: SILVER PLATED BRASS

SHORTING CONTACT: STAINLESS STEEL WITH SILVER CLADDING

ROHS COMPLIANT

NOTE:

1. AFTER SOLDERING, RETURN SWITCHES TO NORMAL TEMPERATURE BEFORE WASHING.

DATE	SYM	REVISION RECORD	DWN.	CK.
7/05	A	ECO# 443	PD	
7/05	B	ECO# 447	PD	
1/06	C	ECO# 526	CD	
3/06	D	ECO# 555	CD	PD

Q.A. INSECT.	DESIGNER'S INITIAL	INCH	SHEET	SIZE	SCALE	THIRD ANGLE PROJECTION
APDM	1 OF 2	B	4:1			
TITLE: WASHABLE TACT SWITCH, SMT, GROUNDING						
DATE: 7/8/05	DRAWING NO. ADTSMW66NSV*	REV. D				

THIS DOCUMENT IS THE PROPERTY OF APEM COMPONENTS AND SHALL NOT BE COPIED, REPRODUCED, DISCLOSED OR USED AS THE BASIS FOR MANUFACTURING OR SALE WITHOUT PERMISSION OF A DULY AUTHORIZED REPRESENTATIVE OF APEM COMPONENTS INC.

DATE	SYM	REVISION RECORD	DWN.	CK.

SPEC.	P/N	DTSMW-66
W	+ .012 [0.30] - .004 [0.10]	.630 [16.00]
P	+ .004 [0.10] - .004 [0.10]	.315 [8.00]
E	+ .004 [0.10] - .004 [0.10]	.069 [1.75]
F	+ .004 [0.10] - .004 [0.10]	.295 [7.50]
D	+ .004 [0.10] - .000 [0.00]	.059 [1.50]
D <sub>1</sub>	+ .010 [0.25] - .000 [0.00]	.059 [1.50]
P <sub>0</sub>	+ .004 [0.10] - .004 [0.10]	.157 [4.00]
P <sub>0</sub> 10	+ .008 [0.20] - .008 [0.20]	1.575 [40.00]
P <sub>2</sub>	+ .004 [0.10] - .004 [0.10]	.079 [2.00]
A <sub>0</sub>	+ .004 [0.10] - .004 [0.10]	.270 [6.78]
B <sub>0</sub>	+ .004 [0.10] - .004 [0.10]	.373 [9.47]
K <sub>0</sub>	+ .004 [0.10] - .004 [0.10]	.158 [4.01]
T	+ .0005 [0.013] - .0005 [0.013]	.013 [0.33]

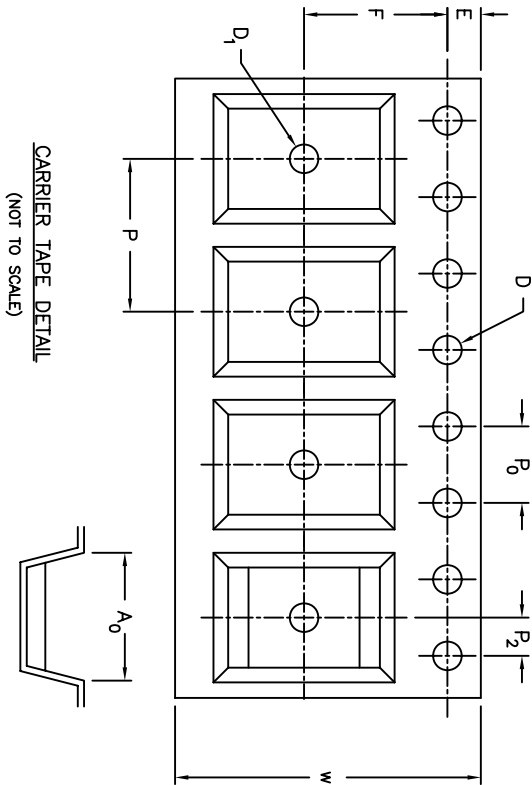

QA. INSPECT.	DESIGNATES CRITICAL DIMENSION	TOLERANCES (DRAWN AS NOTED) XX=±.02[0.05] XXX=±.008[0.20] XXXX=±.0008[0.02] ANGLE = ±0.5°	DATE	DRAWING NO.	REV
7/8/05	ADTSMW66NSV*	D			