



Chipsmall Limited consists of a professional team with an average of over 10 year of expertise in the distribution of electronic components. Based in Hongkong, we have already established firm and mutual-benefit business relationships with customers from,Europe,America and south Asia,supplying obsolete and hard-to-find components to meet their specific needs.

With the principle of “Quality Parts,Customers Priority,Honest Operation,and Considerate Service”,our business mainly focus on the distribution of electronic components. Line cards we deal with include Microchip,ALPS,ROHM,Xilinx,Pulse,ON,Everlight and Freescale. Main products comprise IC,Modules,Potentiometer,IC Socket,Relay,Connector.Our parts cover such applications as commercial,industrial, and automotives areas.

We are looking forward to setting up business relationship with you and hope to provide you with the best service and solution. Let us make a better world for our industry!



Contact us

Tel: +86-755-8981 8866 Fax: +86-755-8427 6832

Email & Skype: info@chipsmall.com Web: www.chipsmall.com

Address: A1208, Overseas Decoration Building, #122 Zhenhua RD., Futian, Shenzhen, China



High Voltage Solid Aluminum Conductive Polymer Surface Mount Capacitors

Sample Kit Contents

KEMET Part Number	VDC	VDC Surge Voltage	Rated Capacitance 120 Hz 20°C (µF)	Case Size D x L (mm)	ESR 100 kHz 20°C (mΩ)	RC 100 kHz 105°C (mA)	LC 20°C 2 Minutes (µA)	Quantity
A767KN476M1VLAE031	35	40.2	47	8 x 9.7	31	1,900	329	5
A767MU107M1VLAE029	35	40.2	100	10 x 12.6	29	2500	700	5
A767MU187M1VLAE028	35	40.2	180	10 x 12.6	28	2600	1260	5
A767MU227M1VLAE028	35	40.2	220	10 x 12.6	28	2600	1540	5
A767KN226M1HLAE050	50	57.5	22	8 x 9.7	50	1500	300	5
A767KN336M1HLAE045	50	57.5	33	8 x 9.7	45	1800	330	5
A767KN476M1HLAE029	50	57.5	47	8 x 9.7	29	3300	470	5
A767KN566M1HLAE029	50	57.5	56	8 x 9.7	29	2800	560	5
A767KN226M1JLAE045	63	72	22	8 x 9.7	45	1800	300	5
A767KN336M1JLAE042	63	72	33	8 x 9.7	42	1950	415	5
A767KS476M1JLAE036	63	72	47	8 x 12	36	2200	592	5
A767KN226M1KLA045	80	92	22	8 x 9.7	45	2100	352	5
A767MU476M1KLA040	80	92	47	10 x 12.6	40	2500	752	5
A767KS106M2ALAE045	100	115	10	8 x 12	45	1700	300	5
A767MU226M2ALAE038	100	115	22	10 x 12.6	38	2250	440	5

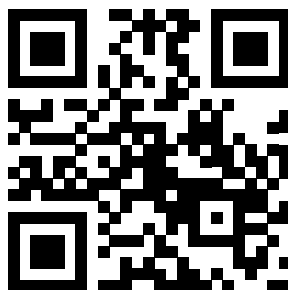

www.kemet.com/A767

Dimensions – Millimeters

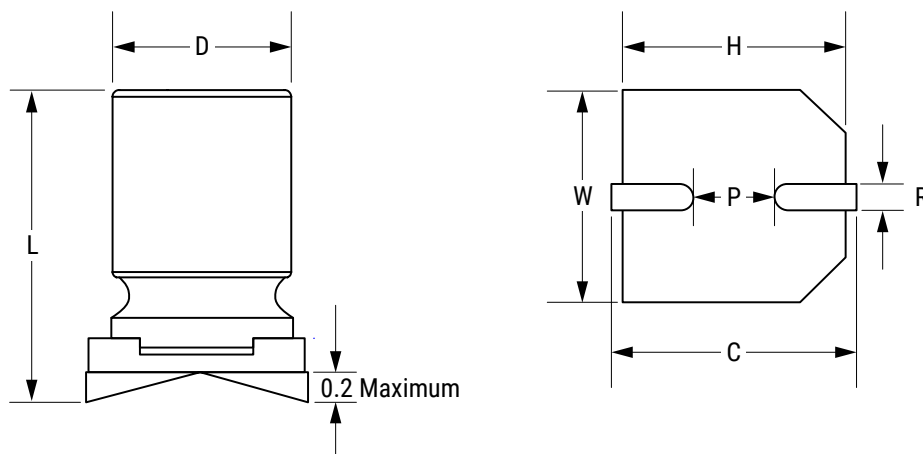

Size Code	D		L		W		H		C		R	P
	Nominal	Tolerance	Nominal	Tolerance	Nominal	Tolerance	Nominal	Tolerance	Nominal	Tolerance	Nominal	Nominal
EB	6.3	±0.5	5.7	±0.3	6.6	±0.2	6.6	±0.2	7.3	±0.2	0.5 – 0.9	2.1
KN	8	±0.5	9.7	±0.3	8.3	±0.2	8.3	±0.2	9.0	±0.2	0.8 – 1.1	3.2
KU	8	±0.5	12.6	±0.3	8.3	±0.2	8.3	±0.2	9.0	±0.2	0.8 – 1.1	3.2
MU	10	±0.5	12.6	±0.3	10.3	±0.2	10.3	±0.2	11.0	±0.2	0.8 – 1.1	4.6