



Chipsmall Limited consists of a professional team with an average of over 10 year of expertise in the distribution of electronic components. Based in Hongkong, we have already established firm and mutual-benefit business relationships with customers from,Europe,America and south Asia,supplying obsolete and hard-to-find components to meet their specific needs.

With the principle of "Quality Parts,Customers Priority,Honest Operation,and Considerate Service",our business mainly focus on the distribution of electronic components. Line cards we deal with include Microchip,ALPS,ROHM,Xilinx,Pulse,ON,Everlight and Freescale. Main products comprise IC,Modules,Potentiometer,IC Socket,Relay,Connector.Our parts cover such applications as commercial,industrial, and automotives areas.

We are looking forward to setting up business relationship with you and hope to provide you with the best service and solution. Let us make a better world for our industry!



Contact us

Tel: +86-755-8981 8866 Fax: +86-755-8427 6832

Email & Skype: info@chipsmall.com Web: www.chipsmall.com

Address: A1208, Overseas Decoration Building, #122 Zhenhua RD., Futian, Shenzhen, China



RoHS Compliant

Commercial USB Flash Drive

AH162-A Product Specification

February 11, 2015

Version 1.2



Apacer Technology Inc.

1F, No.32, Zhongcheng Rd., Tucheng Dist., New Taipei City, Taiwan, R.O.C

Tel: +886-2-2267-8000 Fax: +886-2-2267-2261

www.apacer.com

Table of Contents

1. General Descriptions	2
2. Features	2
3. Performance.....	3
4. Power consumption.....	3
5. Operating Range	4
6. Dimensions.....	4
7. Product Ordering Information	5
7.1 Product Code Designations.....	5
7.2 Valid Combinations	6
7.2.1 AH162-A (SLC).....	6
7.2.2 AH162-A (MLC).....	6

1. General Descriptions

Apacer AH162-A is a removable flash disk drive with USB interface and capabilities of supporting various storage capacities. Compatible with both USB 1.1 and 2.0 specifications with its plug-and-play nature, AH162-A is can be easily adopted in any computing system with an available USB port. The device can be automatically detected by the host computer so that users can access data to read, write, copy, or move data between host system drive and AH162-A. No battery, cable, or software driver is required, AH162-A is widely compatible with mainstream computer platforms, no matter desktop or laptops, as long as there is an available USB port. AH162-A makes data transfer easy, fast and handy.

2. Features

- Compatible with USB 1.1 and 2.0 specifications
- Capacity: SLC – 2, 4 GB
MLC – 4, 8, 16 GB
- Operating system support:
 - Windows: 2000 SP4, XP, Vista, and 7. (note: no device driver is necessary for Windows starting from XP).
 - Mac OS 8.1 or later (for USB 1.1 interface speed)
 - Mac OS X 10.2.8 or later (for USB 2.0 interface speed)
 - Linux Kernel: version 2.4.0 or above (for USB 1.1 interface speed)
 - Linux Kernel: version 2.4.10 or above (for USB 2.0 interface speed)
- Plug & Play
- Data retention up to 10 years
- Operating voltage: DC 4.5 ~ 5.5V from USB port (no external power is required)
- Interface transfer rate:
 - High speed: up to 480Mbits/sec for USB 2.0
 - Full speed: up to 12Mbits/sec for USB 1.1
- Low power consumption
- Altitude: 80,000 feet (relative to sea level)
- Acoustic noise: 0 dB (at one meter)
- Vibration: 15G peak to peak (max)
- Operating temperature: 0-70°C
- Humidity: 20% to 90%

3. Performance

Table 3-1 Performance (SLC)

Capacity Performance	2 GB	4 GB
Sustained read (MB/s)	22	24
Sustained write (MB/s)	19	21

Table 3-2 Performance (MLC)

Capacity Performance	4 GB	8 GB	16 GB
Sustained read (MB/s)	26	26	26
Sustained write (MB/s)	10	10	10

Note: Results may differ from various flash configurations or host system setting

4. Power consumption

Table 4-1: Typical power consumption (SLC)

Capacity Modes	2 GB	4 GB
Active (mA)	75	70
Idle (mA)	40	40

Table4-2: Typical power consumption (MLC)

Capacity Modes	4 GB	8 GB	16 GB
Active (mA)	70	70	80
Idle (mA)	40	40	40

Note: Results may differ from various flash configurations or host system setting

5. Operating Range

Items	Range
Supply Voltage	5.0V±10% (4.5-5.5V)
Operating temperature	0°C to +70°C
Storage temperature	-25°C to +85°C

6. Dimensions

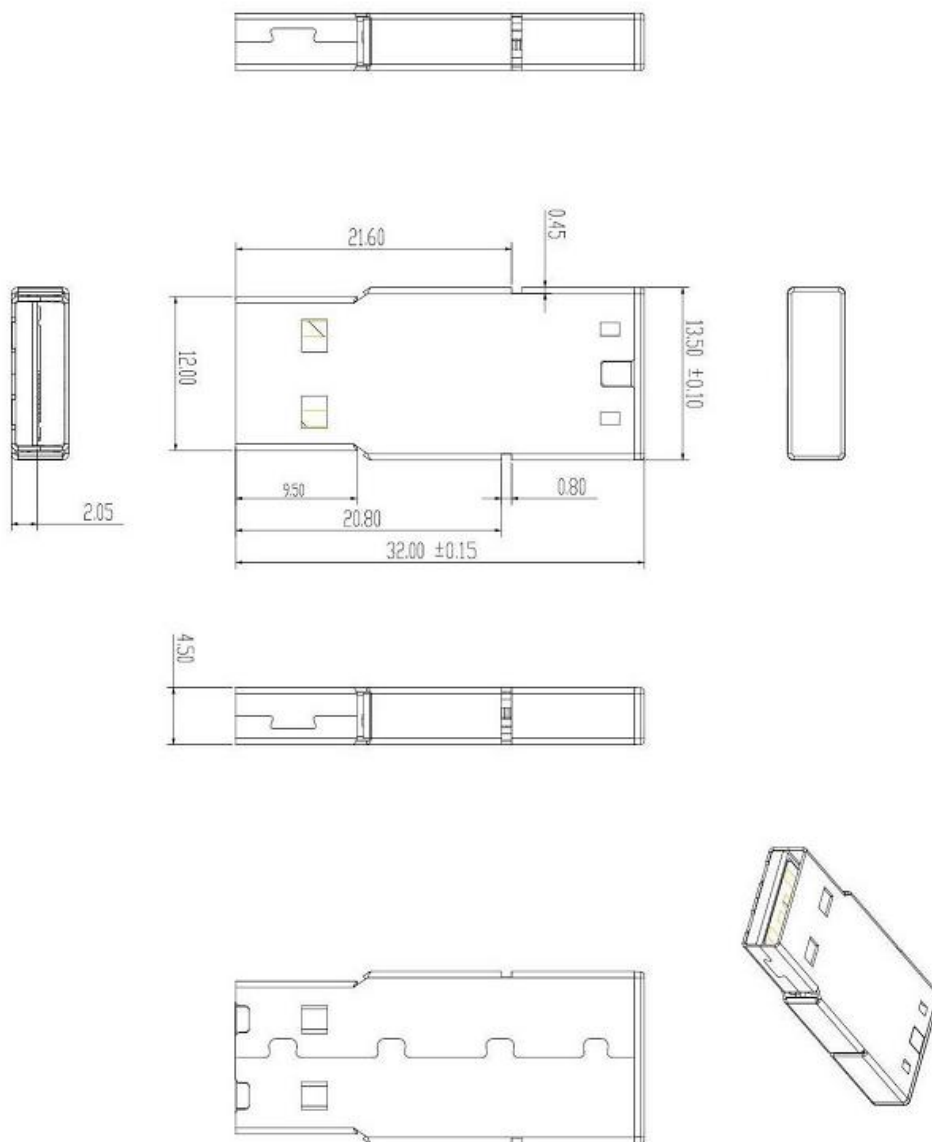

Unit: mm

Tolerance: ± 0.2

7. Product Ordering Information

7.1 Product Code Designations

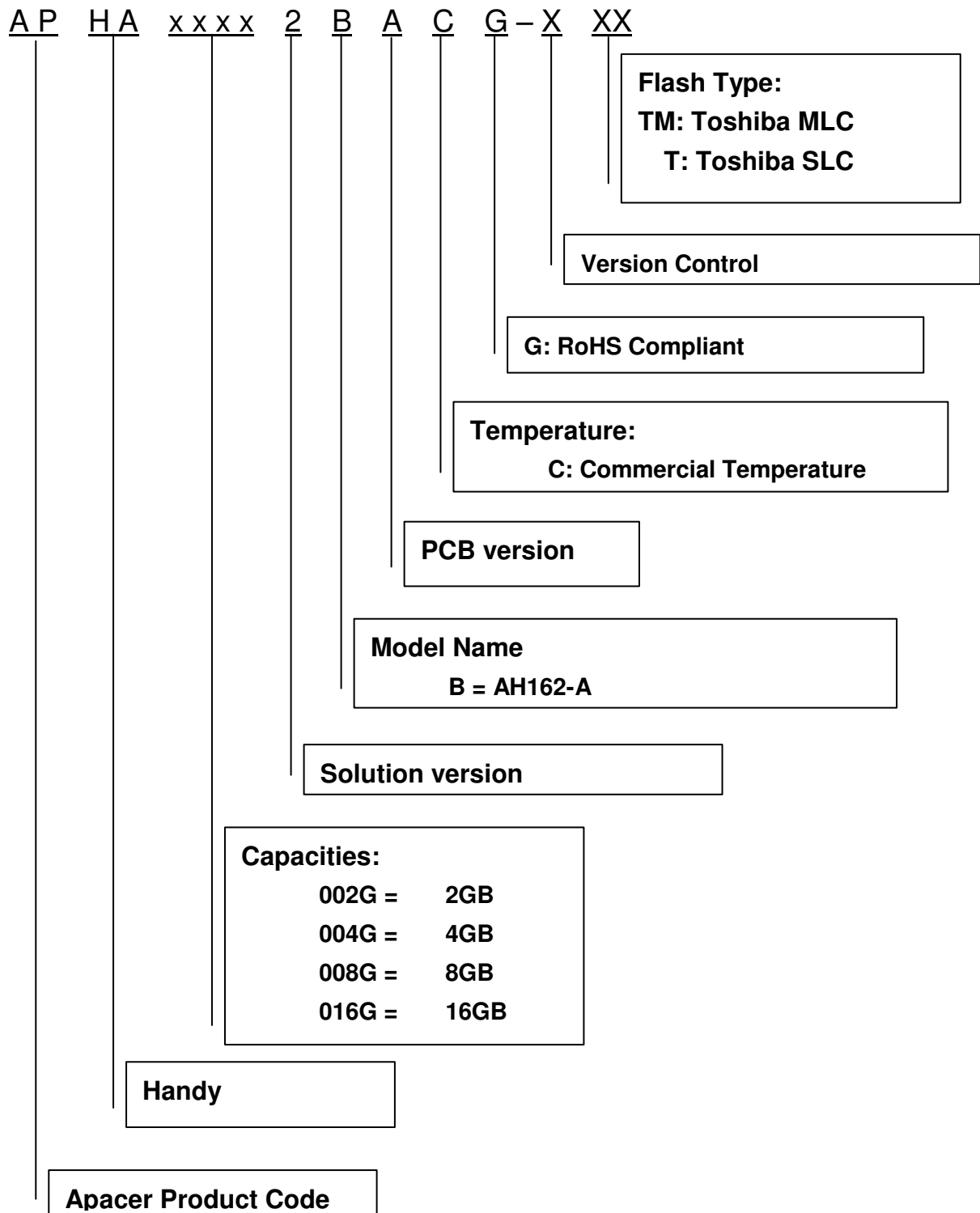

7.2 Valid Combinations

7.2.1 AH162-A (SLC)

Capacity	Standard
2 GB	APHA002G2BACG-CT
4 GB	APHA004G2BACG-CT

7.2.2 AH162-A (MLC)

Capacity	Standard
4 GB	APHA004G2BACG-BTM
8 GB	APHA008G2BACG-BTM
16 GB	APHA016G2BACG-BTM

Revision History

Revision	Date	Description	Remark
1.0	11/04/2014	Official release	
1.1	11/06/2014	Revised the label photo of cover page	
1.2	02/11/2015	Added 4 GB SLG information	

Global Presence

- Taiwan (Headquarters)** **Apacer Technology Inc.**
1F., No.32, Zhongcheng Rd., Tucheng Dist.,
New Taipei City 236, Taiwan R.O.C.
Tel: 886-2-2267-8000
Fax: 886-2-2267-2261
amtsales@apacer.com
- U.S.A.** **Apacer Memory America, Inc.**
386 Fairview Way, Suite102,
Milpitas, CA 95035
Tel: 1-408-518-8699
Fax: 1-408-935-9611
sa@apacerus.com
- Japan** **Apacer Technology Corp.**
5F, Matsura Bldg., Shiba, Minato-Ku
Tokyo, 105-0014, Japan
Tel: 81-3-5419-2668
Fax: 81-3-5419-0018
jpservices@apacer.com
- Europe** **Apacer Technology B.V.**
Science Park Eindhoven 5051 5692 EB Son,
The Netherlands
Tel: 31-40-267-0000
Fax: 31-40-267-0000#6199
sales@apacer.nl
- China** **Apacer Electronic (Shanghai) Co., Ltd**
1301, No.251,Xiaomujiao Road, Shanghai,
200032, China
Tel: 86-21-5529-0222
Fax: 86-21-5206-6939
sales@apacer.com.cn
- India** **Apacer Technologies Pvt Ltd,**
535, 1st Floor, 8th cross, JP Nagar 3rd Phase,
Bangalore – 560078, India
Tel: 91-80-4152-9061
sales_india@apacer.com