



Chipsmall Limited consists of a professional team with an average of over 10 year of expertise in the distribution of electronic components. Based in Hongkong, we have already established firm and mutual-benefit business relationships with customers from,Europe,America and south Asia,supplying obsolete and hard-to-find components to meet their specific needs.

With the principle of “Quality Parts,Customers Priority,Honest Operation,and Considerate Service”,our business mainly focus on the distribution of electronic components. Line cards we deal with include Microchip,ALPS,ROHM,Xilinx,Pulse,ON,Everlight and Freescale. Main products comprise IC,Modules,Potentiometer,IC Socket,Relay,Connector.Our parts cover such applications as commercial,industrial, and automotives areas.

We are looking forward to setting up business relationship with you and hope to provide you with the best service and solution. Let us make a better world for our industry!



Contact us

Tel: +86-755-8981 8866 Fax: +86-755-8427 6832

Email & Skype: info@chipsmall.com Web: www.chipsmall.com

Address: A1208, Overseas Decoration Building, #122 Zhenhua RD., Futian, Shenzhen, China



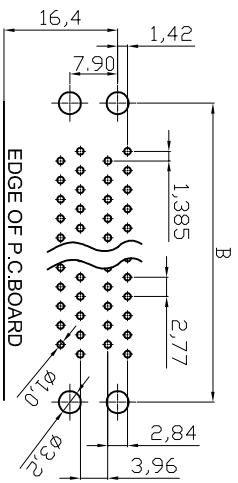
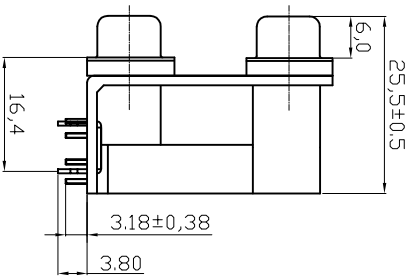
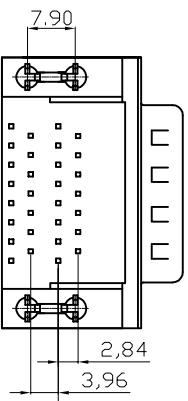
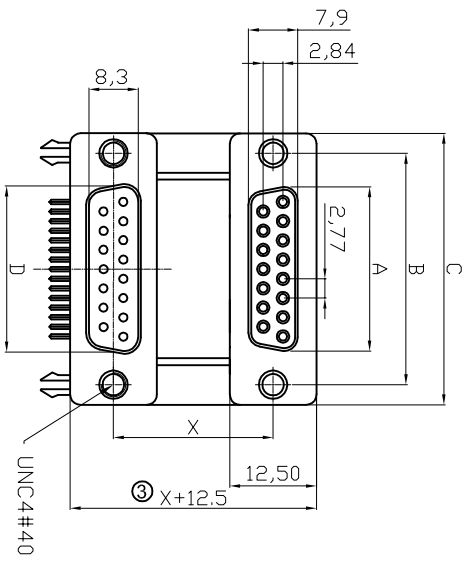

RECOMMENDED P.C.B LAYOUT (TOP VIEW)
TOLERANCES: ±0.10mm

SPECIFICATION
MATERIAL
 Insulator: PBT, rated UL94V-0, black
 Contactors: Copper alloy
 Shell: Steel : 7439-89-6
 Rivet/Boardlock: Copper alloy

CONTACT PLATING
 Contact area: Gold flash
 Solder tails: 100µ" Tin over 40µ" Nickel
 Shell plating: Tin plated
 Underplate: 50µ" Nickel

ELECTRICAL
 Operation voltage: 250 VAC max.
 Current rating: 3 Amps max.
 Contact resistance: 25 mohms max.
 Insulation resistance: 3000 Mohms min @ 500 VDC
 Dielectric withstanding voltage: 1000 VAC / minute
 Operating temperature: -55°C ~ +105°C

① Order Code: ASUB-277-xx TP xx
 No. of Contacts: 09 / 15 / 25 / 37

Dimensions

POSITION	A	B	C	D
9	16.30	25.00	30.8	16.92
15	24.60	33.30	39.2	25.25
25	38.30	47.10	53.1	38.96
37	54.80	63.50	69.4	55.42

ROHS compliant
Unit: mm

Scale	Free TOLERANCE
X.	±0.50
X.X	±0.30
X.XX	±0.20
DIM	TOL
Angle	±5°

Id.	Modification	Date	Name
①	Add the order code	18.08.2014	Winnie
②	Drawn	18.08.2014	Winnie

Date	Name
18.08.2014	Winnie
14.01.2017	Winnie

Without Screw	
ASSMANN WSW-No.	ASUB-277-xxTPxx
Drawing-No.	ASS 6549 CO
Replace	rev03
Sheet	1/2

1

2

3

4

5

6

7

SV3644
CON0396

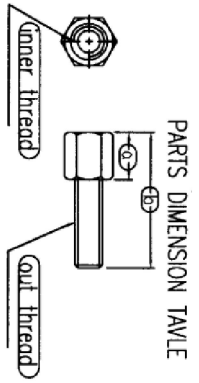
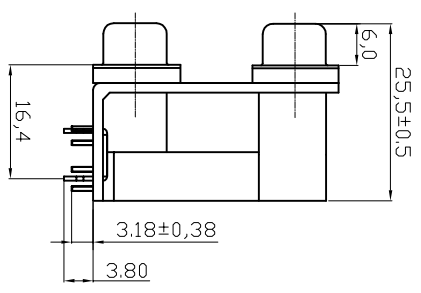
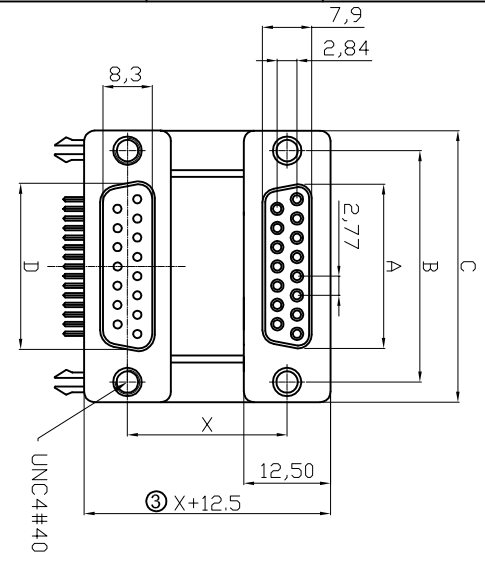

DIM.	DIM.	inner thread	out thread
a	b		
4.8	11.8	4#40	4#40

PARTS DIMENSION TABLE

SPECIFICATION

MATERIAL
 Insulator: PBT, rated UL94V-0, black
 Contacts: Copper alloy
 Shell: Steel : 7439-89-6
 Rivet/Boardlock: Copper alloy

CONTACT PLATING
 Contact area: Gold flash
 Solder tails: 100u" Tin over 40u" Nickel
 Shell plating: Tin plated
 Underplate: 50u" Nickel

ELECTRICAL
 Operation voltage: 250 VAC max.
 Current rating: 3 Amps max.
 Contact resistance: 25 mohms max.
 Insulation resistance: 3000 Mohms min @ 500 VDC
 Dielectric withstanding voltage: 1000 VAC / minute
 Operating temperature: -55°C ~ +105°C

① Order Code:

Order Code: ASUB-277-xx TP xx

No. of Contacts
 08 / 15 / 25 / 37

Dimensions

② Part Spacing Dim. of X=15.875 or 16.0mm

POSITION	A	B	C	D
9	16.30	25.00	30.8	16.92
15	24.60	33.30	39.2	25.25
25	38.30	47.10	53.1	38.96
37	54.80	63.50	69.4	55.42

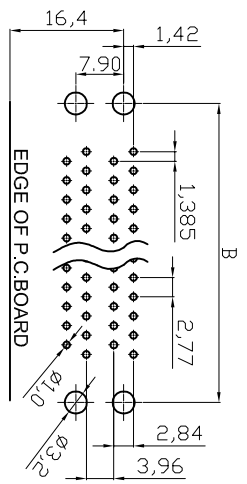

RECOMMENDED P.C.B LAYOUT (TOP VIEW)
 TOLERANCES: ±0.10mm

ROHS compliant
 Unit: mm

Scale	Free									
TOLERANCE										
X.	±0.50	③	Add the extra dimension&description	14.01.2017	Winnie	Drawn	18.08.2014	Winnie		
X.X	±0.30	②	Add page 2	21.08.2014	Winnie	Approved	14.01.2017	Winnie		
X.XX	±0.20	①	Add the order code	18.08.2014	Winnie					
DIM	TOL	①	Drawn	18.08.2014	Winnie					
Angle	±5°	Id.	Modification							

Customer-No. **With Hex Screw**

ASSMANN WSW-No. **ASUB-277-XXTPXX**

Drawing-No. **ASS 6549 CO rev03**



Replace

Sheet 2/2