



Chipsmall Limited consists of a professional team with an average of over 10 year of expertise in the distribution of electronic components. Based in Hongkong, we have already established firm and mutual-benefit business relationships with customers from,Europe,America and south Asia,supplying obsolete and hard-to-find components to meet their specific needs.

With the principle of “Quality Parts,Customers Priority,Honest Operation,and Considerate Service”,our business mainly focus on the distribution of electronic components. Line cards we deal with include Microchip,ALPS,ROHM,Xilinx,Pulse,ON,Everlight and Freescale. Main products comprise IC,Modules,Potentiometer,IC Socket,Relay,Connector.Our parts cover such applications as commercial,industrial, and automotives areas.

We are looking forward to setting up business relationship with you and hope to provide you with the best service and solution. Let us make a better world for our industry!



## Contact us

Tel: +86-755-8981 8866 Fax: +86-755-8427 6832

Email & Skype: info@chipsmall.com Web: www.chipsmall.com

Address: A1208, Overseas Decoration Building, #122 Zhenhua RD., Futian, Shenzhen, China



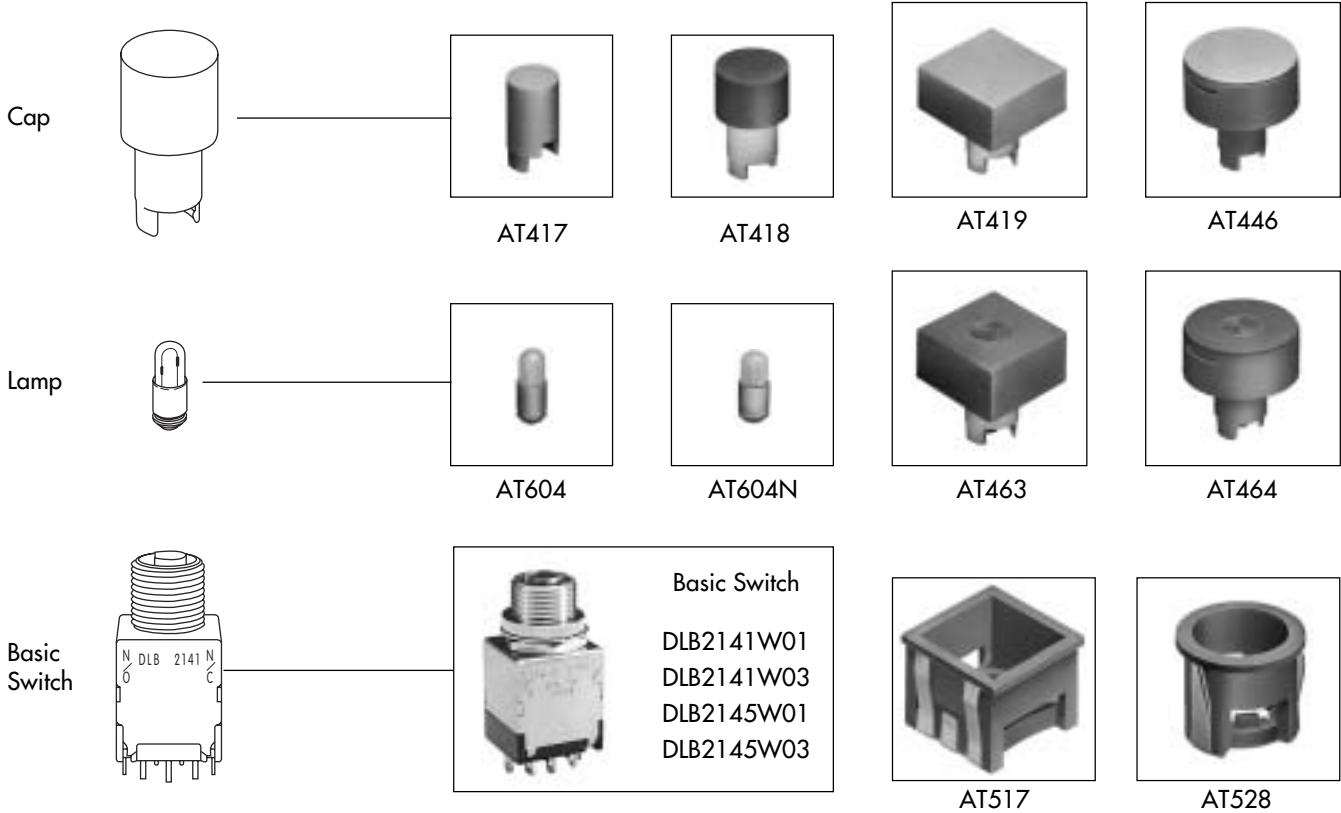

## GENERAL SPECIFICATIONS

### Electrical Capacity (Resistive Load)

**Power Level (Silver Contacts):** 5A @ 125V AC or 3A @ 250V AC or 30V DC

### Other Ratings

**Contact Resistance:** 10 milliohms maximum  
**Insulation Resistance:** 200 megohms minimum @ 500V DC  
**Dielectric Strength:** 1,000V AC minimum between contacts; 1,500V AC minimum between contacts & case  
**Mechanical Life:** 30,000 operations minimum  
**Electrical Life:** 10,000 operations minimum  
**Nominal Operating Force:** 1,300 grams for momentary; 1,200 grams for alternate action  
**Travel:** 1.0mm (.039") pretravel; 4.0mm (.157") overtravel; 5.0mm (.196") total travel





### Materials & Finishes

**Caps:** Polycarbonate  
**Plunger:** Polyacetal resin  
**Bushing:** Brass with chrome plating  
**Housing:** Steel, chromate over zinc  
**Movable Contact:** Silver  
**Stationary Contacts:** Silver with silver plating  
**Base:** Phenolic resin  
**Common Terminals:** Copper with silver plating  
**End Terminals:** Copper with silver plating  
**Lamp Terminals:** Brass with nickel plating

### Standards & Certifications

**UL Recognized:** All models recognized at 5A @ 125V AC; UL File No. E44145  
 Add "/U" to end of part number to order UL mark on switch.

### BASIC SWITCH

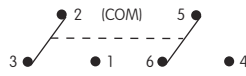
		Plunger Position ( ) = Momentary		Connected Terminals		Terminals
Model	Pole	Normal  Keyway	Down 	Normal  Keyway	Down 	Terminal numbers are not actually on the switch.
DLB2141W01 DLB2141W03 DLB2145W01 DLB2145W03	DP	ON ON ON ON	(ON) (ON) ON ON	2-3 5-6	2-1 5-4	Solder Lug Straight PC Solder Lug Straight PC
<b>Throw &amp; Power/Lamp Schematics</b>						Lamp circuit is isolated and requires external power source.

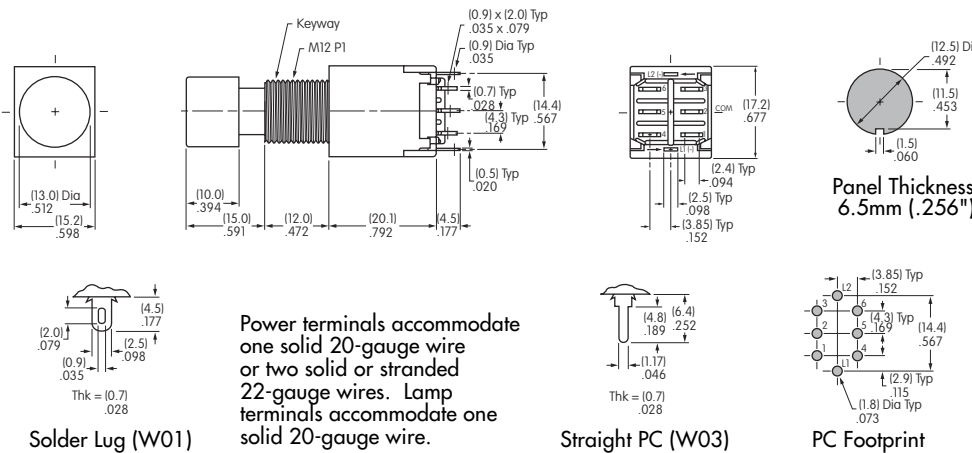

**DLB2145W01 with Cap AT418**

Standard Hardware:  
AT504  
Knurled Face Nut, AT508  
Lockwasher, AT527  
Hex Nut.  
Detail in Accessories & Hardware section (see Index page Y1).



### LAMPS & ELECTRICAL SPECIFICATIONS

Electrical specifications are determined at a basic temperature of 25°C. Lamp circuit is independent of switch operation. The ballast resistor calculation and more lamp detail are shown in the Supplement; see Supplement Index (page Z1).

#### Incandescent & Neon Lamps for Caps AT419, AT417, AT418, & AT446

Part Number	Lamp Type	Voltage	Current	Endurance	
AT604-6V	Incandescent	6V	200mA	1,000 hours	
AT604-14V	Incandescent	14V	80mA	750 hours	
AT604-28V	Incandescent	28V	40mA	1,000 hours	
AT604N	Neon	110V	1.5mA	10,000 hours	

Use Neon with AT417 & AT418 white caps only. Recommended Resistors: 33K ohms for 110V AC; 100K ohms for 220V AC

#### Single Element LED in Spot Illuminated Black Opaque Cap

Part Number	LED Color & Cap Description	Forward Peak Current	Continuous Fwd Current	Forward Voltage	Reverse Peak Voltage	Current Reduction Above 25°C
AT463C	Red LED in Square Cap	35mA	25mA	1.65V	3V	0.57mA/°C
AT463F	Green LED in Square Cap	30mA	20mA	2V	3V	0.43mA/°C
AT464C	Red LED in Round Cap	35mA	25mA	1.65V	3V	0.57mA/°C
AT464F	Green LED in Round Cap	30mA	20mA	2V	3V	0.43mA/°C

**AT463**

Can be combined with Square Mounter AT517.

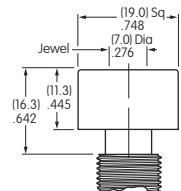



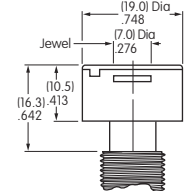

**AT464**

Can be combined with Round Mounter AT528.

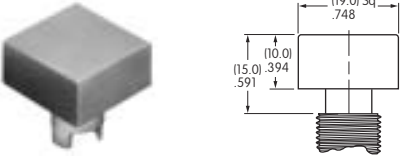
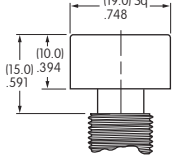

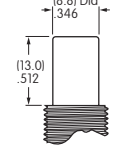
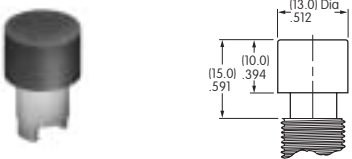
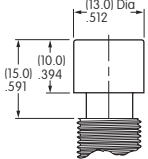
### CAP TYPES & COLORS

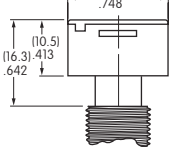
			Part Number	Cap	Color
<b>AT419</b> 	Can be used with Square Mounter		<b>AT419B</b>	.748" Square	White
			<b>AT419C</b>	.748" Square	Red
			<b>AT419D</b>	.748" Square	Orange
			<b>AT419E</b>	.748" Square	Yellow
			<b>AT419F</b>	.748" Square	Green
			<b>AT419G</b>	.748" Square	Blue
<b>AT417</b> 	Can be used with Round Mounter		<b>AT417B</b>	.346" Diameter	White
			<b>AT417C</b>	.346" Diameter	Red
			<b>AT417D</b>	.346" Diameter	Orange
			<b>AT417E</b>	.346" Diameter	Yellow
			<b>AT417F</b>	.346" Diameter	Green
			<b>AT417G</b>	.346" Diameter	Blue
<b>AT418</b> 	Can be used with Round Mounter		<b>AT418B</b>	.512" Diameter	White
			<b>AT418C</b>	.512" Diameter	Red
			<b>AT418D</b>	.512" Diameter	Orange
			<b>AT418E</b>	.512" Diameter	Yellow
			<b>AT418F</b>	.512" Diameter	Green
			<b>AT418G</b>	.512" Diameter	Blue
<b>AT446</b> Lens Holder 	Can be used with Round Mounter		<b>AT446</b>	.748" Diameter	
Black opaque holder; white, red, green, & blue translucent lenses are provided.					

### OPTIONAL SNAP-IN MOUNTERS

#### AT517A

#### Mounter for Square Caps

Provided with assembly instructions

Material: Fiberglass reinforced nylon

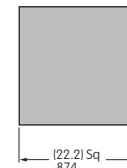
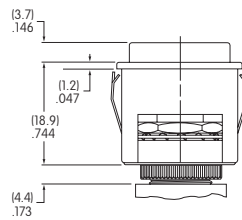

Panel Cutout



**DLB2145W01**  
with Cap AT419 & Square Mounter

Panel Thickness: 1.0 ~ 4.0mm (.039 ~ .157")

#### AT528A

#### Mounter for .748" Round Caps

Provided with assembly hardware and instructions

Material: Fiberglass reinforced nylon

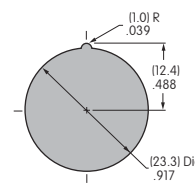
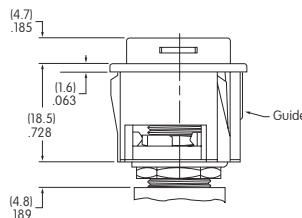

Panel Cutout



**DLB2145W01**  
with Cap AT446 & Round Mounter

Panel Thickness: 1.0 ~ 4.0mm (.039 ~ .157")