



Chipsmall Limited consists of a professional team with an average of over 10 year of expertise in the distribution of electronic components. Based in Hongkong, we have already established firm and mutual-benefit business relationships with customers from,Europe,America and south Asia,supplying obsolete and hard-to-find components to meet their specific needs.

With the principle of "Quality Parts,Customers Priority,Honest Operation,and Considerate Service",our business mainly focus on the distribution of electronic components. Line cards we deal with include Microchip,ALPS,ROHM,Xilinx,Pulse,ON,Everlight and Freescale. Main products comprise IC,Modules,Potentiometer,IC Socket,Relay,Connector.Our parts cover such applications as commercial,industrial, and automotives areas.

We are looking forward to setting up business relationship with you and hope to provide you with the best service and solution. Let us make a better world for our industry!



Contact us

Tel: +86-755-8981 8866 Fax: +86-755-8427 6832

Email & Skype: info@chipsmall.com Web: www.chipsmall.com

Address: A1208, Overseas Decoration Building, #122 Zhenhua RD., Futian, Shenzhen, China





Re-circulating Chillers

PORTABLE CHILLER SYSTEM

ATS' portable chiller series, the ATS-Chill150V, ATS-Chill300V and ATS-Chill600V are refrigeration-based systems that provide chilled water for cooling purposes. The chilled water can be sent to a cold plate, a submersible heat exchanger or any other system that needs to be cooled. The temperature of the chilled water can be easily set from the front panel. The front panel also shows the pressure drop between inlet and outlet. These chillers are air cooled, eliminating costly water cooling circuits.

ATS-Chill series are for cooling only and because of its vapor compression based refrigeration, they do not provide any heating of the coolant. These are portable systems and are ideal for laboratory applications, laser cooling, micro molding and other industrial applications. The water temperature can be maintained from 0 - 40°C from 150W to 600W depending on the model.



FEATURES

- » **SYSTEM OPERATIONS**
Front panel LED display shows water level, pressure and temperature during chiller's operation
- » **THERMOSTATIC CONTROL**
Equipped with thermostat, cooling, circulation functions for small laboratory analytical instruments
- » **FAST RESPONSE**
Fast response time because of PID control system with small temperature fluctuations
- » **TEMPERATURE CONTROL**
Control temperature with the three functions of the thermostat, cooling and circulation
- » **MOBILITY**
ATS-Chill Series are lightweight and portable, and are easily moved to the application site
- » **RELIABILITY**
Proven technology for refrigeration – a highly reliable technology. Key components of refrigeration system such as compressor and circulation fans use high quality brands
- » **COOLING CAPACITY**
Up to 600W (recirculating series)
- » **SAFETY FEATURE**
Protects against over pressure and compressor overload, with automatic shut off when ventilation is poor

APPLICATIONS

- » Laboratory Testing
- » Industrial Processing
- » Sensor Calibrations
- » Bio-Medical Testing
- » Laser Thermal Management
- » Component Characterization

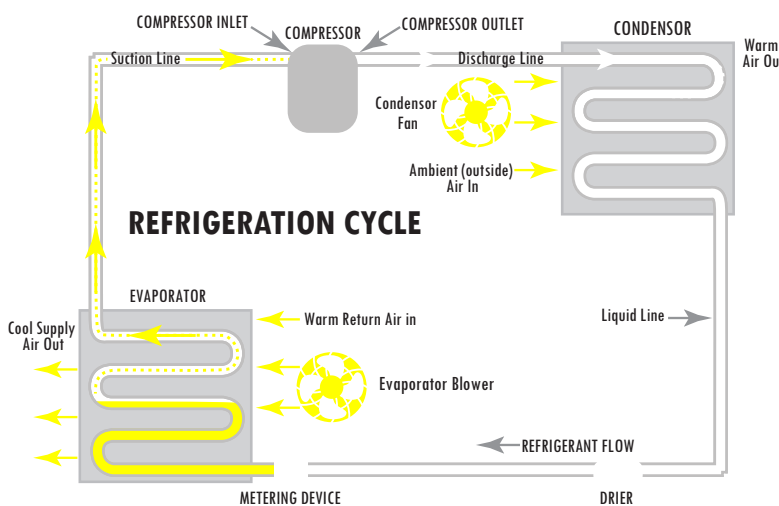

Part Number	Temp Range 25°C	Temp Stability	Cooling Capacity Q _{max}	Pump Pressure	Pump Flow Rate	Water Tank Capacity	Overall Dimension (W x D x H)	AC Input	Weight
ATS-Chill150V	0–40°C	±0.1°C	150W	0.4 BAR	7-10 L/MIN	1.0 L	230 x 260 x 380 mm (9.06 x 10.24 x 14.9")	AC 220V	10 kg (22.05 lbs)
ATS-Chill300V	5–35°C	±0.1°C	300W	0.6 BAR	15 L/MIN	4.5 L	235 x 475 x 490 mm (9.25 x 18.7 x 19.3")	Switch Selectable 120/220Vac	23 kg (50.71 lbs)
ATS-Chill600V	5–35°C	±0.1°C	600W	0.6 BAR	15 L/MIN	4.5 L	235 x 475 x 490 mm (9.25 x 18.7 x 19.3")	Switch Selectable 120/220Vac	23 kg (50.71 lbs)

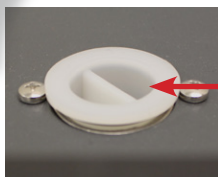

Water Tank Filler

Back View ATS-Chill150V



Power Supply Connection

RETURN

Quick Connect Fluid Output

SUPPLY

Quick Connect Fluid Input

Drain Attachment

DRAIN

Front View ATS-Chill150V



PID Controller (Proportional Integral Derivative Controller)

On/Off Switch

Low Fluid Indicator

CHILLV SERIES
ATS-Chill150V

Front View ATS-Chill600V



PID Controller (Proportional Integral Derivative Controller)

Pressure Gauge

On/Off Switch

Power Supply Connection

Switch Selectable Input Range

Drain Connection

Back View ATS-Chill600V



Quick Connect Fluid Input

ON/OFF

RETURN

SUPPLY

Quick Connect Fluid Output

DRAIN

EASY TO USE INSTRUCTIONS

1. Install ATS chiller on a level surface capable of supporting the weight of the unit.
2. Allow 30cm (12") clearance around the air inlet and discharge areas to insure proper air circulation.
3. Fill the reservoir with fluid (water or mixture of water and glycol).
4. Connect the unit to a power outlet.
5. Connect the unit to the liquid lines of your system using the input and output quick connections on the back of the unit.
6. Turn the power switch on.
7. Check fluid level in the reservoir and add more, if needed.
8. Set digital controller from Front Panel to the desired temperature.
9. The unit is ready for continuous cooling operation.

For further information, please contact Advanced Thermal Solutions, Inc. at 1-781-769-2800 or www.qats.com