



Chipsmall Limited consists of a professional team with an average of over 10 year of expertise in the distribution of electronic components. Based in Hongkong, we have already established firm and mutual-benefit business relationships with customers from,Europe,America and south Asia,supplying obsolete and hard-to-find components to meet their specific needs.

With the principle of “Quality Parts,Customers Priority,Honest Operation,and Considerate Service”,our business mainly focus on the distribution of electronic components. Line cards we deal with include Microchip,ALPS,ROHM,Xilinx,Pulse,ON,Everlight and Freescale. Main products comprise IC,Modules,Potentiometer,IC Socket,Relay,Connector.Our parts cover such applications as commercial,industrial, and automotives areas.

We are looking forward to setting up business relationship with you and hope to provide you with the best service and solution. Let us make a better world for our industry!



Contact us

Tel: +86-755-8981 8866 Fax: +86-755-8427 6832

Email & Skype: info@chipsmall.com Web: www.chipsmall.com

Address: A1208, Overseas Decoration Building, #122 Zhenhua RD., Futian, Shenzhen, China



REV	ECN.NO:	B Y	DATE
.

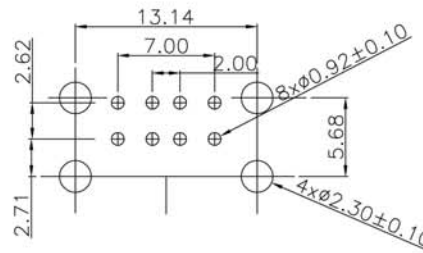
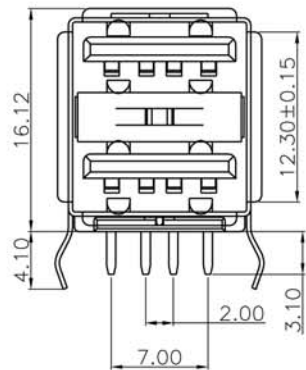
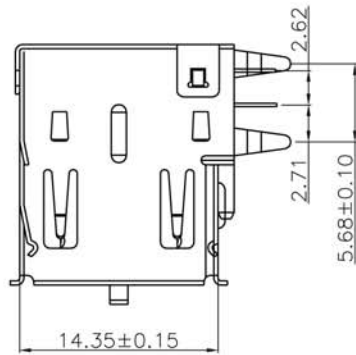
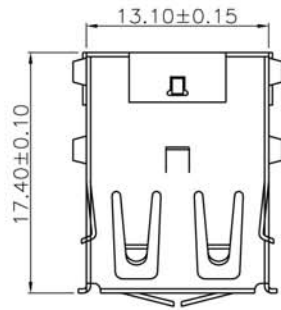

RECOMMENDED P.C.B. PATTERN LAYOUT

MATERIAL
 INSULATOR:PBT+30%G.F
 COLOR:BLACK/WHITE/BROWN/BEIGE-----
 CONTACT:BRASS
 SHELL:BRASS
 MECHANICAL
 MATING:35N MAX.
 WITHDRAWAL FORCE:10N MIN.
 DURAL LITY:1500 CYCLES MIN.
 ELECTRICAL
 CURENT-MAX[AMPS]:1.0A
 VOLTAGE-MAX[VOLTS]:30V
 WITHSTANDING VOLTAGE:100V AC.
 CONTACT RESISTANCE [OHMS]:50mΩ MAX.
 INSULATION RESISTANCE [OHMS]:1000MΩ MIN.
 PLATING
 CONTACT: GOLD PLATING CORD: 5u"
 SHELL:Nickel(Tin) OVER ALL PLATING
 ENVIRONMENTAL
 TEMPERATURE RANGE:-55°C to +85°C

RoHS
Compliant

-TOLERANCES- UNLESS OTHERWISE SPECIFIED		ASSMANN Electronics, Inc.	
		⊕ ▱	TITLE: USB, VERSION A, 2-PORT
X.X ±0.30	X.X" ±3"	APPD:	PRODUCT NO: AU-Y1008-R
X.XX ±0.15	X.XX" ±1"	CHECK:	DATE SCALE UNIT TYPE PAGE
X.XXX ±0.10	X.XXX" ±0.5"	DRAW:	FREE MM