



Chipsmall Limited consists of a professional team with an average of over 10 year of expertise in the distribution of electronic components. Based in Hongkong, we have already established firm and mutual-benefit business relationships with customers from,Europe,America and south Asia,supplying obsolete and hard-to-find components to meet their specific needs.

With the principle of “Quality Parts,Customers Priority,Honest Operation,and Considerate Service”,our business mainly focus on the distribution of electronic components. Line cards we deal with include Microchip,ALPS,ROHM,Xilinx,Pulse,ON,Everlight and Freescale. Main products comprise IC,Modules,Potentiometer,IC Socket,Relay,Connector.Our parts cover such applications as commercial,industrial, and automotives areas.

We are looking forward to setting up business relationship with you and hope to provide you with the best service and solution. Let us make a better world for our industry!



Contact us

Tel: +86-755-8981 8866 Fax: +86-755-8427 6832

Email & Skype: info@chipsmall.com Web: www.chipsmall.com

Address: A1208, Overseas Decoration Building, #122 Zhenhua RD., Futian, Shenzhen, China



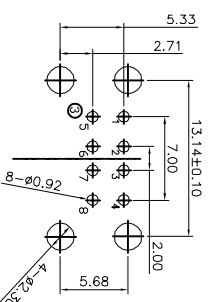
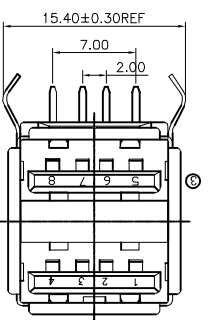
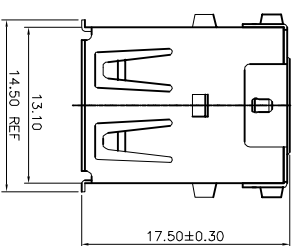
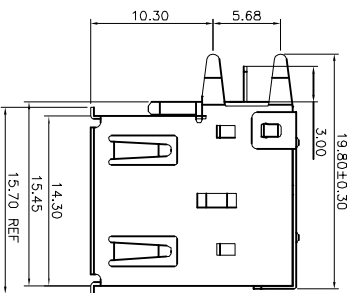

NOTES:

1. Material:

- 1.1 Housing: PBT+30%GF UL94V-0, Color Black
- 1.2 Shell: SPCC
- 1.3 Contact :Brass

2. FINISH:

- 2.1 Contact Area: Selective 5u"Au
- Solder Area: Tin Plated

Under: Ni Plated

3. MECHANICAL:

- 3.1 Mating Force: 3.57kgf Max.
- 3.2 Unmating Force: 1.02kgf Min
- 3.3 Durability: 1500 cycles Min

4. ELECTRICAL:

- 4.1 Current Rating: 1.5A
- 4.2 Dielectric Strength: 500V AC FOR 1 MINUTE
- 4.3 Contact Resistance: 30mΩ Max
- 4.4 Insulation Resistance: 1000 MΩ Min
- 5. Operating temperature: -55°C TO +85°C
- ② 6. Soldering temperature: 245°C±5°C for 3~5 Sec
- 7. PACKING: Tray

RoHS compliant

Scale	Free				
TOLERANCE					
.X	±0.30	③	Change the Pin number	03.04.2014	Winnie
.XX	±0.20				
.XXX	±0.10	②	Add the soldering temperature	27.12.2013	Winnie
DIM					
X.°	±5°	①	Update the P/N	10.12.2013	Winnie
Angle	TOL	①	Drawn	07.06.2013	Winnie
UNIT	mm	Id.	Modification	Date	Name

ASSMANN
WSW components

Date	Name	Customer-No.	Drawing-No.	Replace
07.06.2013	Winnie		ASSMANN WSW-No. ① AU-Y1008	ASS 5781 CO
03.04.2014	Winnie			rev03
				SHEET

1

2

3

4

5

6

7

A

B

C

D

E

F

G

H

1

2

3

4

5

6

7