



Chipsmall Limited consists of a professional team with an average of over 10 year of expertise in the distribution of electronic components. Based in Hongkong, we have already established firm and mutual-benefit business relationships with customers from,Europe,America and south Asia,supplying obsolete and hard-to-find components to meet their specific needs.

With the principle of "Quality Parts,Customers Priority,Honest Operation,and Considerate Service",our business mainly focus on the distribution of electronic components. Line cards we deal with include Microchip,ALPS,ROHM,Xilinx,Pulse,ON,Everlight and Freescale. Main products comprise IC,Modules,Potentiometer,IC Socket,Relay,Connector.Our parts cover such applications as commercial,industrial, and automotives areas.

We are looking forward to setting up business relationship with you and hope to provide you with the best service and solution. Let us make a better world for our industry!



Contact us

Tel: +86-755-8981 8866 Fax: +86-755-8427 6832

Email & Skype: info@chipsmall.com Web: www.chipsmall.com

Address: A1208, Overseas Decoration Building, #122 Zhenhua RD., Futian, Shenzhen, China



1

2

3

4

5

6

7

Dim A=2,54xNo. of Positions±0,40

Dim B=2,54xNo. of Contacts-2,54±0,20④

2,54±0,10

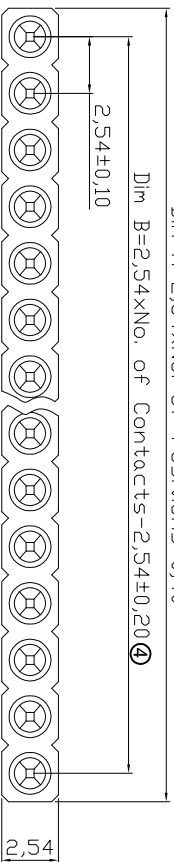

Technical Data

Material:

Pin(outer sleeve): Brass, machined, CuZn38Pb2

④ Clip(contact 4 finger): Beryllium copper, heat treated

Plating Pin(outer sleeve): 2um/80u" nickel, 5um/200u" Tin

Plating Clip(contact 4 finger): 2um/80u" nickel, Gold flash

④ Insulator body(housing): PPS UL94V-0 Black

Electrical

Current rating: 3 Amps/contact max.

Contact resistance: $\leq 4m\Omega$ /contact

Insulation resistance: $\geq 1000M\Omega$ at V=100V

Operating voltage: 60VAC/DC

Mechanical

Average insertion force with steel pin of

$\varnothing 0,43mm/0,017''$: <250g

Average withdrawal force with steel pin of

$\varnothing 0,43mm/0,017''$: >90g

Mechanical life cycle: min. 200

Operating temperature: -40°C to +105°C

Soldering temperature: +260°C, 10s max.

Package: PE bag

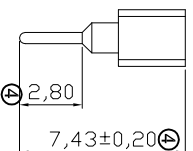
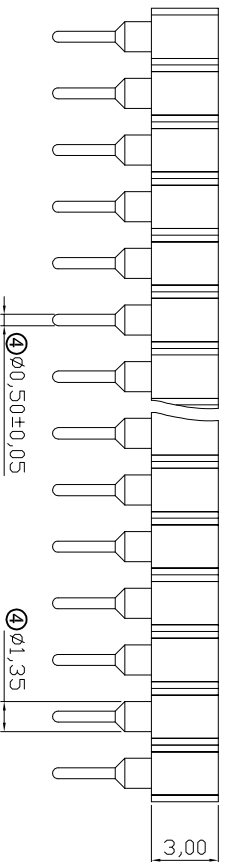

Contact	Dim A	Dim B	Contact	Dim A	Dim B	Contact	Dim A	Dim B
01	2,54	—	15	38,10	35,56	29	73,66	71,12
02	5,08	2,54	16	40,64	38,10	30	76,20	73,66
03	7,62	5,08	17	43,18	40,64	31	78,74	76,20
04	10,16	7,62	18	45,72	43,18	32	81,28	78,74
05	12,70	10,16	19	48,26	45,72	33	83,82	81,28
06	15,24	12,70	20	50,80	48,26	34	86,36	83,82
07	17,78	15,24	21	53,34	50,80	35	88,90	86,36
08	20,32	17,78	22	55,88	53,34	36	91,44	88,90
09	22,86	20,32	23	58,42	55,88	37	93,98	91,44
10	25,40	22,86	24	60,96	58,42	38	96,52	93,98
11	27,94	25,40	25	63,50	60,96	39	99,06	96,52
12	30,48	27,94	26	66,04	63,50	40	101,60	99,06
13	33,02	30,48	27	68,58	66,04			
14	35,56	33,02	28	71,12	68,58			

Dim B=2,54xNo. of Contacts-2,54±0,20

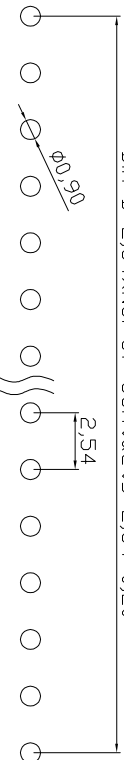

P.C.B. LAYOUT

ROHS compliant

Unit: mm

Scale Free

TOLERANCE

X. ±0.50

X.X ±0.30

X.XX ±0.20

DIM TOL

Angle ±5°

Angle

Angle

Customer-No.

ASSMANN WSW-No. AW 127-XX/Z-T ③

Drawing-No.

ASS 0212 CO rev04

Replace

Sheet

1

2

3

4

5

6

7

SV313