



Chipsmall Limited consists of a professional team with an average of over 10 year of expertise in the distribution of electronic components. Based in Hongkong, we have already established firm and mutual-benefit business relationships with customers from,Europe,America and south Asia,supplying obsolete and hard-to-find components to meet their specific needs.

With the principle of “Quality Parts,Customers Priority,Honest Operation,and Considerate Service”,our business mainly focus on the distribution of electronic components. Line cards we deal with include Microchip,ALPS,ROHM,Xilinx,Pulse,ON,Everlight and Freescale. Main products comprise IC,Modules,Potentiometer,IC Socket,Relay,Connector.Our parts cover such applications as commercial,industrial, and automotives areas.

We are looking forward to setting up business relationship with you and hope to provide you with the best service and solution. Let us make a better world for our industry!



Contact us

Tel: +86-755-8981 8866 Fax: +86-755-8427 6832

Email & Skype: info@chipsmall.com Web: www.chipsmall.com

Address: A1208, Overseas Decoration Building, #122 Zhenhua RD., Futian, Shenzhen, China



1

2

3

4

5

6

7

A

B

C

D

E

F

A

B

C

D

E

F

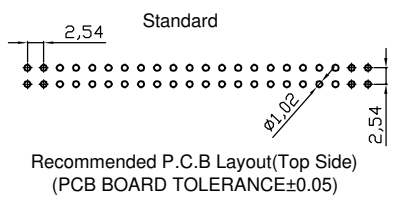
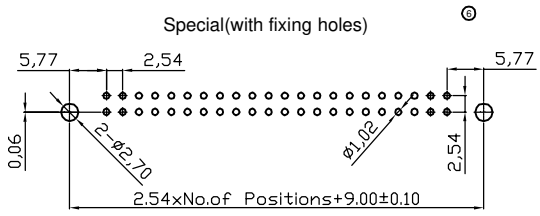
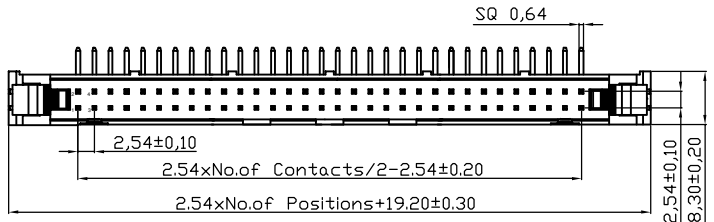

NOTES:

MATERIAL

- 1. Insulator Material: PBT+30%G.F.(UL94V-0), Grey
- 2. Contact Material : Brass
- 3. Contact Plating : Gold Flash / Tin or Full Tinned Over Ni

ELECTRICAL

- 1. Current Rating : 3.0AMP
- 2. Withstand Voltage : 1000V AC/minute
- 3. Contact Resistance : 20mΩ max
- 4. Insulation Resistance: 1000MΩ min

ENVIRONMENTAL

- 1. Operation Temperature: -40°C to +105°C
- 2. Packing : Tray
- 3. No side slot "A" and "B" from 6 to 16 pin
No side slot "A" from 18 to 58 pin

Ordering Information

AWH xxA-0 2x2-T

No. of Contacts	Latch Type
06 08	0(w/o latch)
10 12	2(with short latch)
14 16	3(with long latch)
18 20	
24 26	
30 34	
40 50	
60 64	

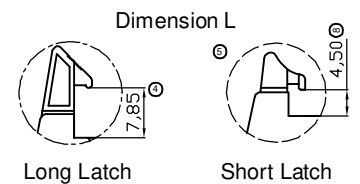
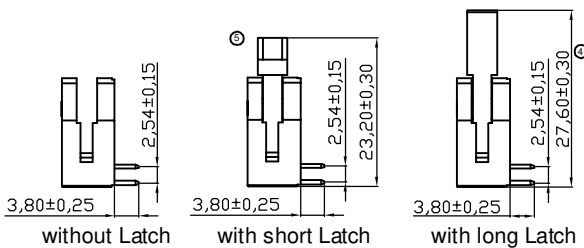
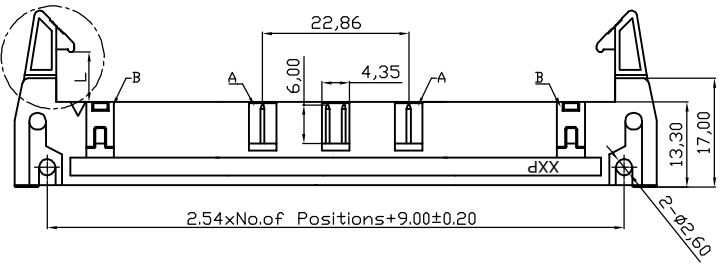

RoHS compliant



Scale	1:1	⑨	Add UL file no.	12.12.2013	Amy	Date	Name	Customer-No.
TOLERANCE		⑧	Add the fulled Tinned version	11.11.2013	Winnie	Drawn	Alex	ASSMANN WSW-No. AWH xxA-02x2-T
X.X	±0.40	⑦	Update	29.03.2013	Winnie	Approved	Winnie	
X.XX	±0.25	⑥	Add special PCB layout	07.12.2010	Alex			Drawing-No.
X.XXX	±0.15	⑤	Correct drawing of short latch	05.05.2010	Dean			ASS 2311 CO rev09
Angle	±3°	④	Change dimension	27.10.2009	Dean			
		Id.	Modification	Date	Name			Replace
								Sheet

1

2

3

4

5

6

7

SV79